

Clădire District - Băneasa - Plan parter
District building - Baneasa - Ground floor

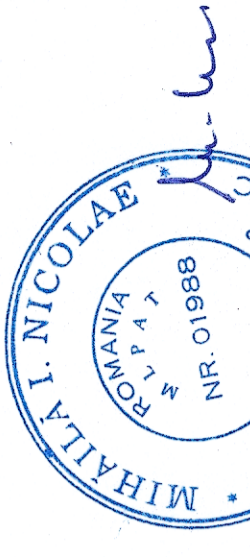
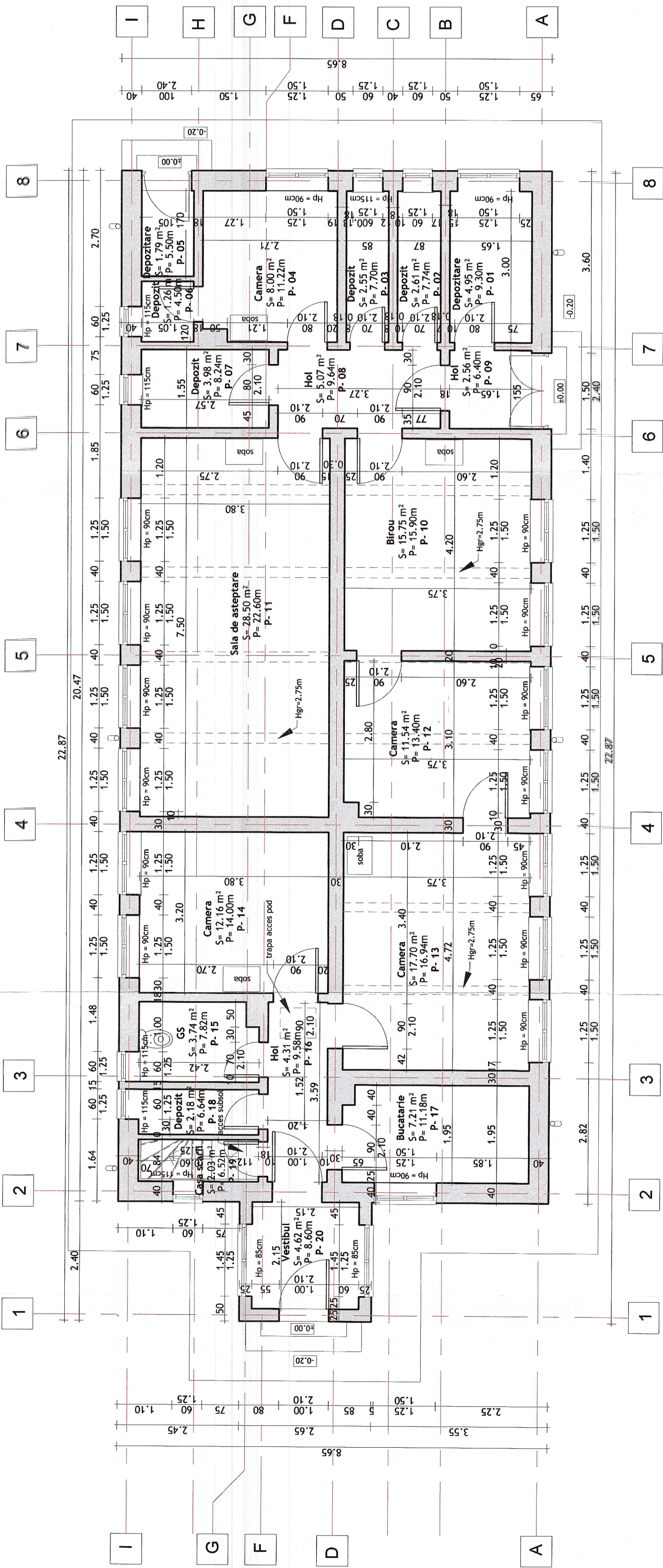

<p>GUVERNUL ROMÂNIEI GOVERNMENT OF ROMANIA</p>		<p>PROIECT FINANȚAT DE UNIUNEA EUROPEANĂ EUROPEAN UNION FINANCED PROJECT</p>		<p>BENEFICIAR: ROMANIAN RAILWAY NATIONAL COMPANY</p>	
<p>PROIECTANT/ DESIGNER: ASOCIEREA/ JOINT VENTURE: 340/9877/2001</p>		<p>PROIECT/ PROJECT: DENUMIRE/ DENUNIRE: LUCRARE/ WORKS TITLE: Lot 2 - MODERNIZAREA LINIEI CF BUCUREȘTI NORD-JILAVA-GIURGIU NORD - GIURGIU NORD FRONTIERA Lot 2 - MODERNIZATION OF THE RAILWAY BUCHAREST NORTH - GIURGIU NORTH BORDER</p>		<p>DENUMIRE/ DENUNIRE: LUCRARE/ WORKS TITLE: Lot 2 - MODERNIZAREA LINIEI CF BUCUREȘTI NORD-JILAVA-GIURGIU NORD - GIURGIU NORD FRONTIERA Lot 2 - MODERNIZATION OF THE RAILWAY BUCHAREST NORTH - GIURGIU NORTH BORDER</p>	
<p>PROIECTANT/ DESIGNER: arh. Liviu Baicu</p>		<p>SPECIALTATE/ SPECIALITY: CONSTRUCTII CIVILE CIVIL WORKS</p>		<p>DENUMIRE/ DENUNIRE: LUCRARE/ WORKS TITLE: Lot 2 - MODERNIZAREA LINIEI CF BUCUREȘTI NORD-JILAVA-GIURGIU NORD - GIURGIU NORD FRONTIERA Lot 2 - MODERNIZATION OF THE RAILWAY BUCHAREST NORTH - GIURGIU NORTH BORDER</p>	
<p>EXPERT CHEF/ KEY EXPERT: Ing. Mihaela Stănicu</p>		<p>RELEVU - PLAN PARTER - CLĂDIRI DISTRICT L - STATIA BĂNEASA</p>		<p>DENUMIRE/ DENUNIRE: LUCRARE/ WORKS TITLE: Lot 2 - MODERNIZAREA LINIEI CF BUCUREȘTI NORD-JILAVA-GIURGIU NORD - GIURGIU NORD FRONTIERA Lot 2 - MODERNIZATION OF THE RAILWAY BUCHAREST NORTH - GIURGIU NORTH BORDER</p>	
<p>M/PM: Ing. Marin Baicu</p>		<p>SEMNATURA/ SIGNATURE: Ing. Marin Baicu</p>		<p>DENUMIRE/ DENUNIRE: LUCRARE/ WORKS TITLE: Lot 2 - MODERNIZAREA LINIEI CF BUCUREȘTI NORD-JILAVA-GIURGIU NORD - GIURGIU NORD FRONTIERA Lot 2 - MODERNIZATION OF THE RAILWAY BUCHAREST NORTH - GIURGIU NORTH BORDER</p>	
<p>DATA/DATE: 04.2018</p>		<p>SCALA/SCALE: 1:100</p>		<p>EXEMPLAR NR./ EXEMPLAR NO.: 1</p>	
				<p>ET 207 Lot 2 18 Ah03 02 00</p>	