

Plan parter cladire calatori Progresu - variantele I si II de interventii
Progresu Trainstation building Ground floor - I and II interventions versions
Sc: 100

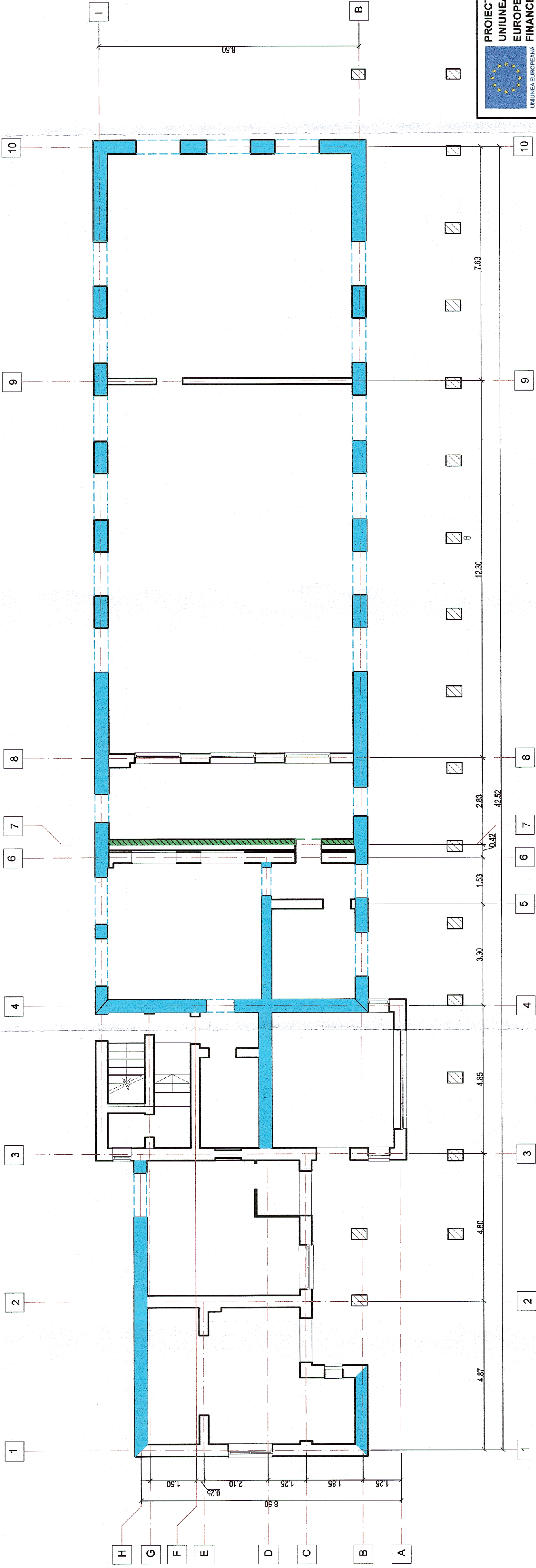

LEGENDA

- camasaire pe ambele fețe cu plase sudate Ø 4/100/100 mm și mortar ciment M10-T(M100 T) de 3.5 cm grosime
- camasaire pe o parte (spre interiorul incaperilor), cu plase sudate Ø 6/100/100 mm și mortar ciment M10-T(M100 T) de 4.5 cm grosime
- camasaire a zonelor cu goluri, cu aceleși dimensiuni a mortarului/betonului și a plaseilor precum suprafețele învecinate

DESIGNATION

- coating on both sides, with Ø4/100/100mm welded netting and 3.5cm thick M10-T(M100 T) grout
- coating on one side (towards the inside of the rooms), with Ø6/100/100mm welded netting and 4.5 cm thick M10-T(M100 T)
- coating of gap areas, with the same dimensions of the grout/concrete and welded nettings as neighboring surfaces

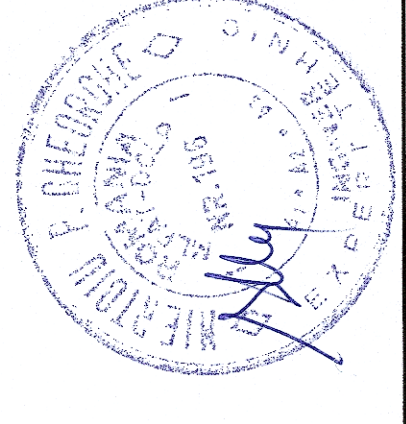

PROIECT FINANȚAT DE UNIUNEA EUROPEANĂ EUROPEAN UNION FINANCED PROJECT		GUVERNUL ROMÂNIEI GOVERNMENT OF ROMANIA	COMPANIA NAȚIONALĂ DE CĂI FERATE "C.F.R." S.A. ROMANIAN RAILWAY NATIONAL COMPANY
PROIECTANT/ DESIGNER ASOCIEREA/ JOINT VENTURE B & acciona <small>ingineria</small> 340/5877/2001 J40/20534/2004	DENUMIRE PROIECT/ DENUMIRE LUCRARE PROJECT TITLE/ WORKS TITLE: Lot 2 - MODERNIZAREA INFRASTRUCTURII DE CĂLE FERATE DINTRE STAȚIILE CF BUCUREȘTI NORD - GIURGIU NORD - GIURGIU NORD FRONTIERA Lot 2 - MODERNIZATION OF THE RAILWAY BUCHAREST NORTH - JILAVA - GIURGIU NORT - GIURGIU NORTH BORDER Lot 2 - MODERNIZATION OF THE RAILWAY INFRASTRUCTURE BUCHAREST NORTH - GIURGIU NORTH - GIURGIU NORTH BORDER	SEMNATURA/ SIGNATURE Ing. Sonia Petrea Ing. Mihaela Staicu Ing. Marin Baicu	SPECIALITATE/ SPECIALITY DENUMIRE PLAN/ DRAWING TITLE COD PLAN/ CODIFICATION SYSTEM: EXEMPLAR NR./ EXEMPLARY NO.: 1 SCALA/SCALE: 1:100
BENEFICIAR BENEFICIARY:		CONSTRUCTII CIVILE CIVIL WORKS	
DATA/DATE: 04.2018		Plan parter cladire calatori Progresu - variantele I si II de interventii Progresu Trainstation building Ground floor - I and II interventions versions	
		ET 207 Lot 2 28 R01 01 00	