

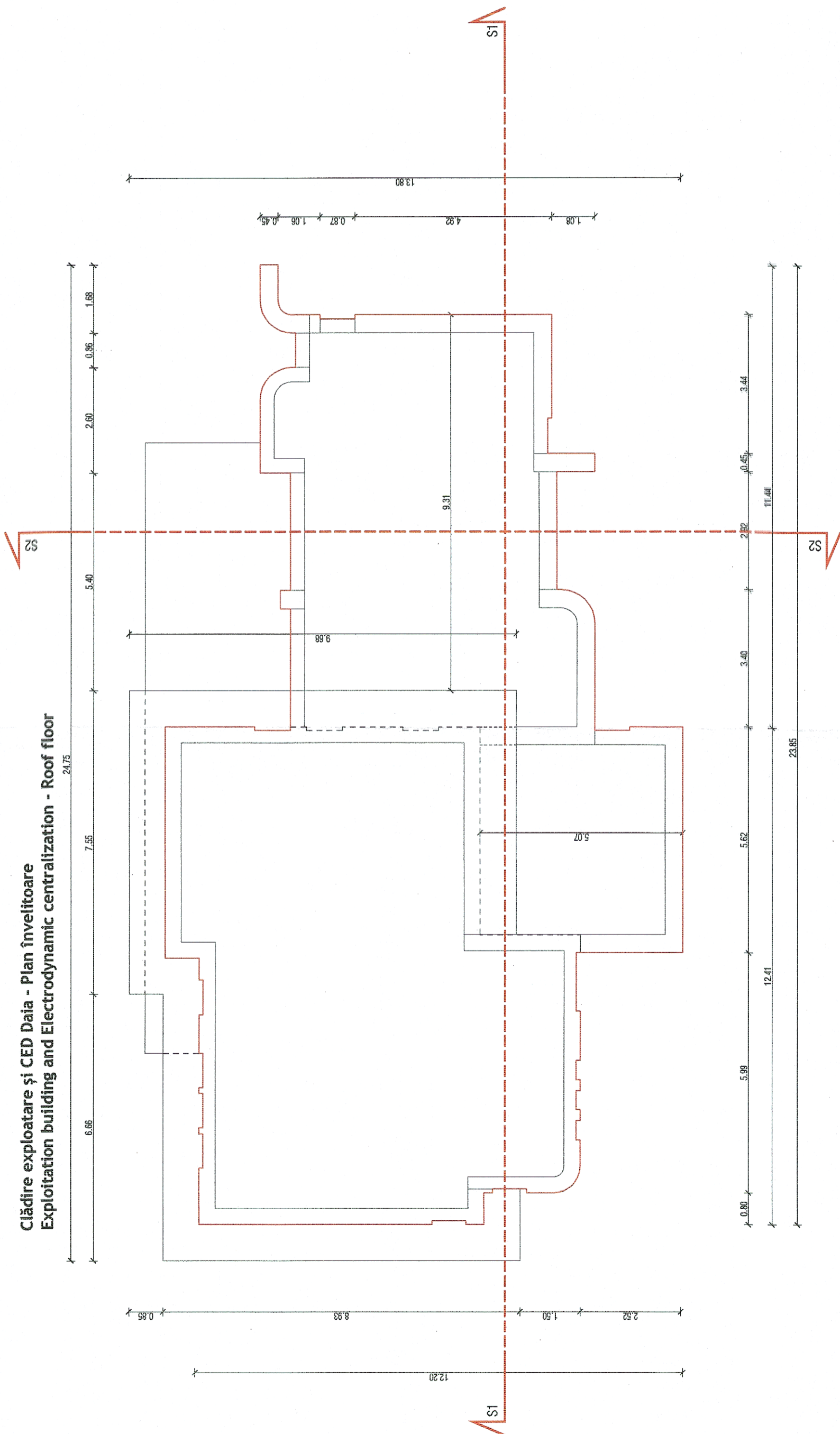

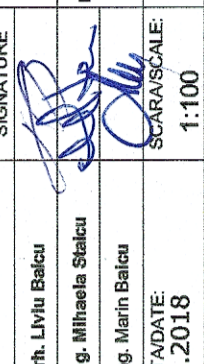

Clădire exploatare și CED Daia - Plan învelitoare
Exploitation building and Electrodynamic centralization - Roof floor



 GVERNUL ROMÂNIEI GOVERNMENT OF ROMANIA		 <small>Ministerul Infrastructurii</small> <small>2018-2020</small>	
 PROIECT FINANȚAT DE UNIUNEA EUROPEANĂ EUROPEAN UNION FINANCED PROJECT		COMPANIA NAȚIONALĂ DE CĂI FERATE "C.F.R." S.A. ROMANIAN RAILWAY NATIONAL COMPANY	
BENEFICIAR BENEFICIARY: 		PROIECTANT/ DESIGNER: ASOCIEREA/ JOINT VENTURE: SUBCONTRACTANT / S.C. LGB TRANSARY S.R.L. SUBCONTRACTOR: J/40/2566/2002	
DENUMIRE PROIECT/ DENUMIRE LUCRARE: "MODERNIZAREA LINIEI CF BUCUREȘTI NORD-JILAVA-GIURGIU NORD - GIURGIU NORD FRONTIERĂ" "MODERNIZAREA INFRASTRUCTURII DE CĂLE FERATE ÎNTR-ȘTAȚILE CF BUCUREȘTI NORD - GIURGIU NORD - GIURGIU NORD FRONTIERĂ" "MODERNIZATION OF THE RAILWAY BUCHAREST NORTH JILAVA - GIURGIU NORTH - GIURGIU NORTH BORDER" "MODERNIZATION OF THE RAILWAY INFRASTRUCTURE BUCHAREST NORTH - GIURGIU NORTH - GIURGIU NORTH BORDER"		DENUMIRE PROIECT/ DENUMIRE LUCRARE: "MODERNIZAREA LINIEI CF BUCUREȘTI NORD-JILAVA-GIURGIU NORD - GIURGIU NORD FRONTIERĂ" "MODERNIZAREA INFRASTRUCTURII DE CĂLE FERATE ÎNTR-ȘTAȚILE CF BUCUREȘTI NORD - GIURGIU NORD - GIURGIU NORD FRONTIERĂ" "MODERNIZATION OF THE RAILWAY BUCHAREST NORTH JILAVA - GIURGIU NORTH - GIURGIU NORTH BORDER" "MODERNIZATION OF THE RAILWAY INFRASTRUCTURE BUCHAREST NORTH - GIURGIU NORTH - GIURGIU NORTH BORDER"	
NUME/NOME: art. Liviu Balciu Ing. Mihaela Stalciu Ing. Marin Balciu		SEMINTURĂ/ SIGNATURE: 	
PROIECTANT/ DESIGNER: EXPERT CHEF/ KEY EXPERT: IMP/PM:		SPECIALITATE/ SPECIALITY: DENUMIRE PLAN/ DRAWING TITLE: EXEMPLAR NR./ EXEMPLARY NO.:	
DATA/DATE: 04.2018		SCARA/SCALE: 1:100	
		CONSTRUCȚII CIVILE CIVIL WORKS	
		RELEVU - PLAN ÎNVELITOARE - CLĂDIRE EXPLOATARE ȘI CED - HALTA MISCARE DAIA EXISTING - ROOF FLOOR - EXPLOITATION BUILDING AND ELECTRODYNAMIC CENTRALIZATION DATA	
		COD PLAN/ CODIFICATION SYSTEM:	
		ET 207 Lot 2 20 Ah01 03 00	