

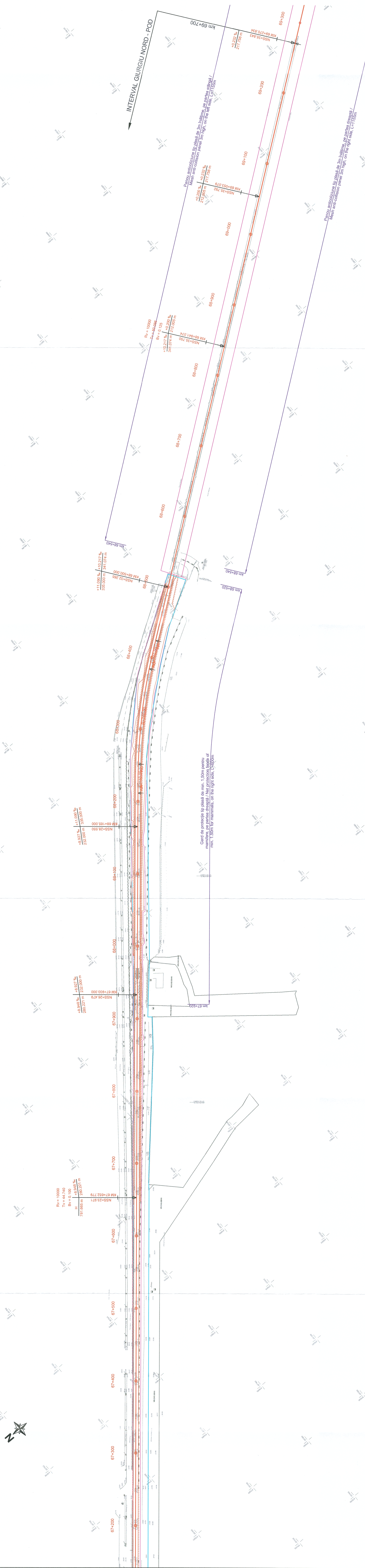





BUCUREȘTI







RUSSE



LEGENDA / LEGEND

-  Podet protectat / Designed culvert
-  Sanctiun protectat / Designed concrete ditch/drainage
-  Coridor expropriat / Expropriation corridor
-  Zona CFR existenta / Existing CFR area
-  Limita existenta UAT / Existing UAT limit

 <b>PROIECT FINANȚAT DE UNIUNEA EUROPEANĂ</b> EUROPEAN UNION FINANCED PROJECT	 <b>GUVERNUL ROMÂNIEI</b> GOVERNMENT OF ROMANIA
 <b>COMPANIA NAȚIONALĂ DE CĂI FERATE "C.F.R." S.A.</b> ROMANIAN RAILWAY NATIONAL COMPANY	 <b>INGENIERIA ESPECIALIZADA</b> SPECIALIZED ENGINEERING S.A. BUCUREȘTI, ROMANIA CUIA C/LE 1806/2001 SA PANTOU/POD 4008/17201
<b>PROIECTANT / DESIGNER:</b> ACCIONA <b>ASOCIEREA / JOINT VENTURE:</b> ACCIONA & C.F.R.	<b>PROIECTUL / PROJECT DENUMIRE / LUCRARE:</b> MODERNIZAREA INFRASTRUCTURII DE CALE FERATE ÎN DINTRE STAȚIILE CF BUCUREȘTI NORD - JILAVA - GIURGIU NORD - GIURGIU NORD FRONTIERĂ <b>PROIECTUL / PROJECT DENUMIRE / LUCRARE:</b> MODERNIZATION OF THE RAILWAY INFRASTRUCTURE BUCHAREST NORTH - JILAVA - GIURGIU NORTH - GIURGIU NORTH BORDER
<b>PROIECTANT / DESIGNER:</b> ACCIONA & C.F.R. <b>EXPERTS / EXPERTS:</b> ACCIONA & C.F.R. <b>MPRM:</b> ACCIONA & C.F.R.	<b>SPECIALITATE / SPECIALITY:</b> INFRASTRUCTURA SI SUPRASTRUCTURA CF <b>PROIECTANT / DESIGNER:</b> ACCIONA & C.F.R. <b>EXPERTS / EXPERTS:</b> ACCIONA & C.F.R. <b>MPRM:</b> ACCIONA & C.F.R.
<b>DATA / DATE:</b> 06.2023	<b>SCALA / SCALE:</b> 1:2000 <b>EXEMPLAR NR / EXEMPLARY NO.:</b> 1