

VEDERE PLANA A-A/A-A PLAN VIEW
Sc. 1:100

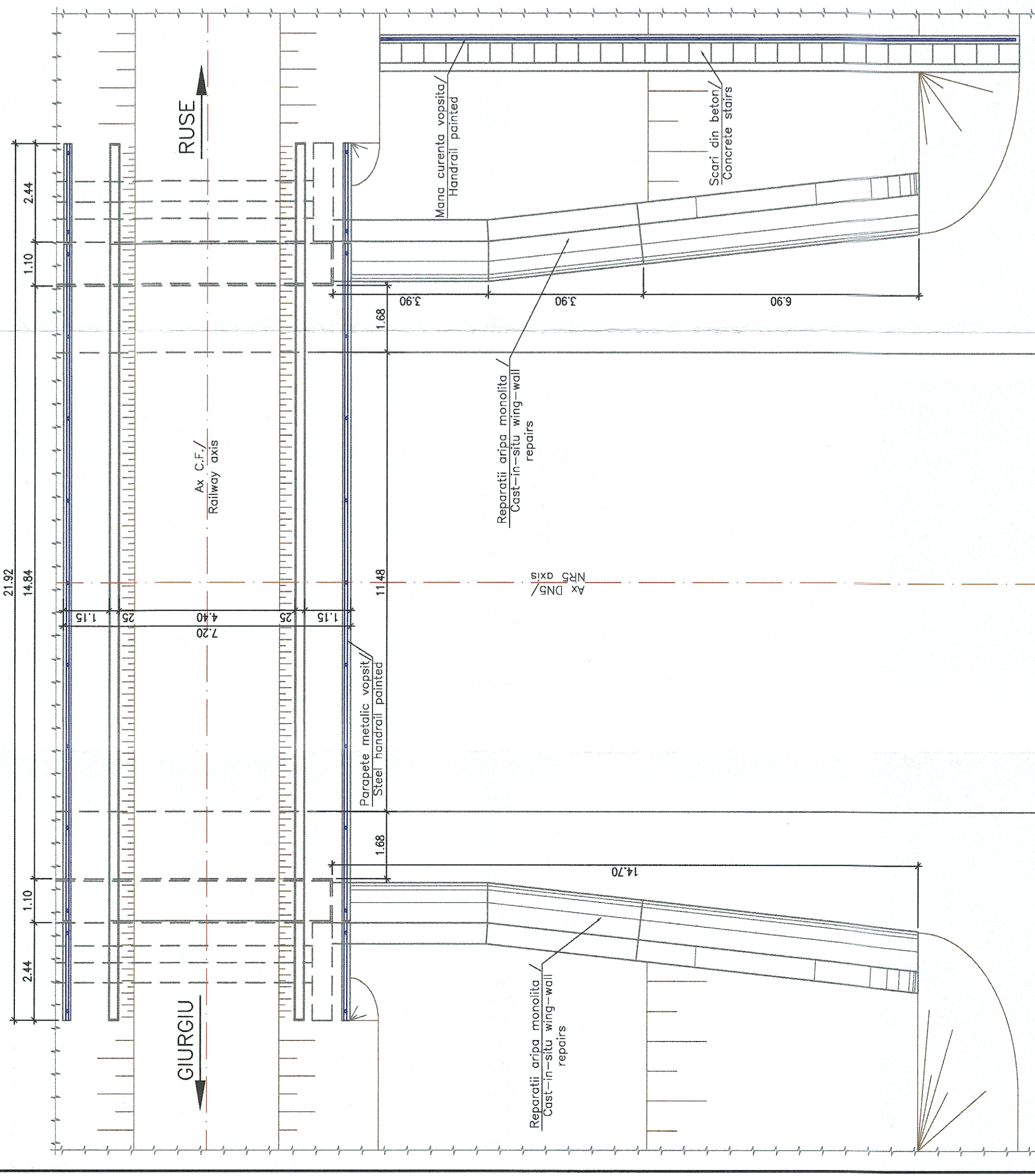

VEDERE B-B / B-B VIEW
Sc. 1:100

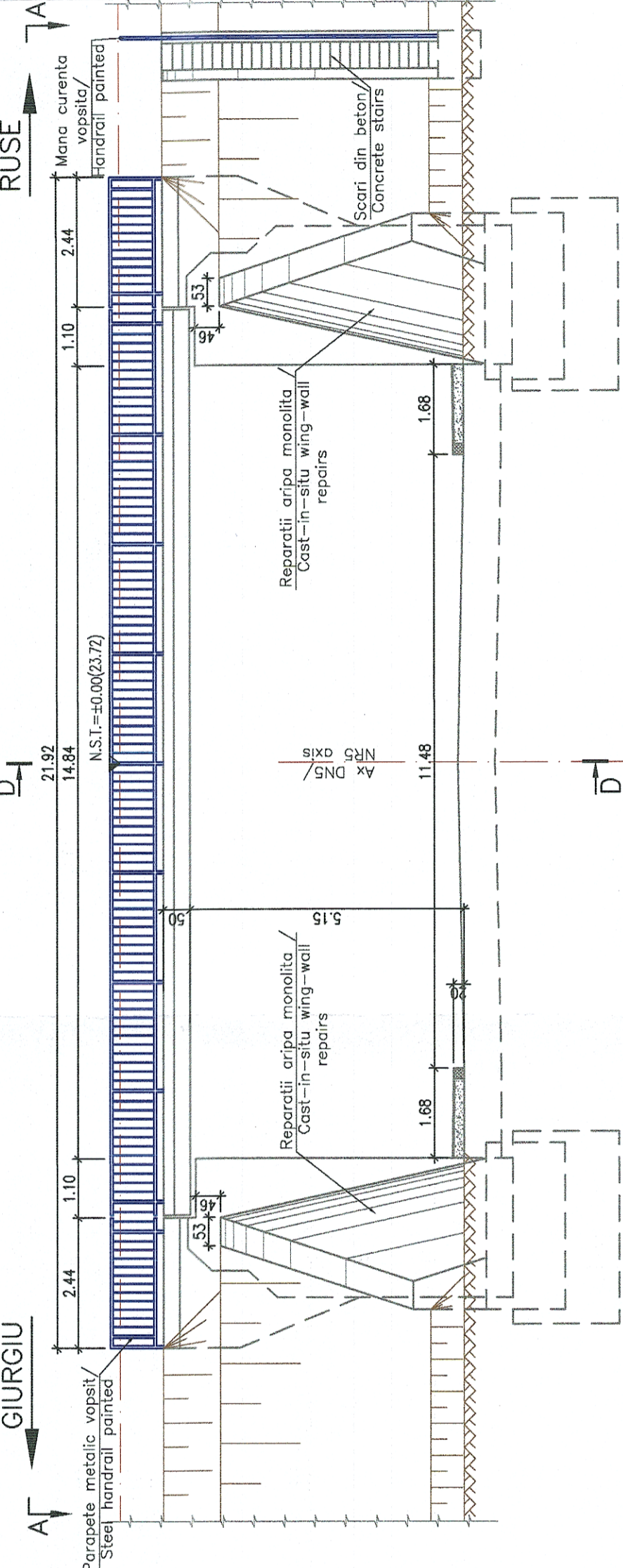

SECTIUNE TRANSVERSALA D-D/D-D CROSS SECTION
Sc. 1:100

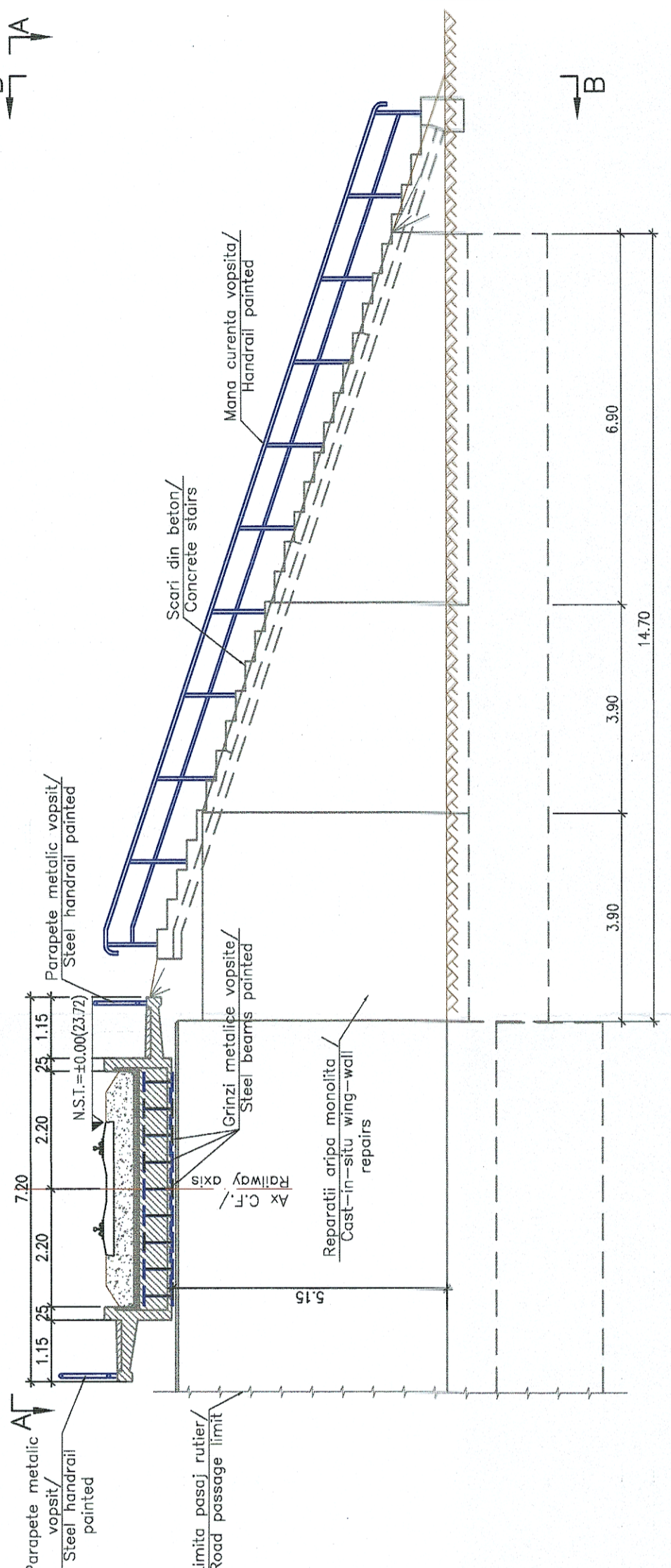

NOTA:
Se vor executa urmatoarele lucrari:
• Se vor curata si se vor vopsi talpile inferioare ale profilurilor metalice;
• Se vor realiza reparatii la fetele vazute ale elevatiilor cu mortare speciale;
• Se vor curata terasamentele de la capetele pasajului de vegetatie;
• Se va completa prismul de piatra sparta;
• Se vor realiza reparatii la fetele vazute ale arilor monolite cu mortare speciale.
• Suprafetele din beton vizibile se vor impermeabiliza.

NOTE:
The following works will be performed:
• The cleaning and painting of the metallic flanges of the profiles;
• Repairs at the visible faces of the elevations with special mortars;
• The cleaning from vegetation of the embankment at the ends of the undercrossing;
• The restoring and completion of the crushed stone prism;
• Repairs at the visible faces of the cast-in-situ wing-walls with special mortars.
• All the visible concrete surfaces shall be waterproofed.

		PROIECT FINANȚAT DE UNIUNEA EUROPEANĂ EUROPEAN UNION FINANCED PROJECT	GUVERNUL ROMÂNIEI GOVERNMENT OF ROMANIA COMPANIA NAȚIONALĂ DE CĂI FERATE "C.F.R." S.A. ROMANIAN RAILWAY NATIONAL COMPANY
PROIECTANT/ DESIGNER: ASOCIEREA JOINT VENTURE: BAICONS INGEN. SRL 4009877/2801 INGINERIEA ESPECIALIZATA IN OBRAZARITATE INDUSTRIALA SA 4002639/2004	SEMNATURA/ SIGNATURE Nume/Nume Ing. Madalin MUTU Ing. Felicia IOANID Ing. Marin BAICU MPP/M	DENUMIRE PROIECT/ DENUMIRE LUCRARE: MODERNIZAREA INFRASTRUCTURII DE CALE FERATA DINTRE STATILE CF BUCHAREST-NORTH - JILAVA - GIURGIU-INDRAB - GIURGIU-INDRAB-PRONITARA MODERNIZATION OF THE RAILWAY INFRASTRUCTURE BUCHAREST NORTH - JILAVA - GIURGIU NORTH - GIURGIU NORTH / BORDER	SPECIALITATE/ SPECIALITY PODURI BRIDGES DISPOZITIE GENERALA PASAJ KM FISA 66+800 (KM EXISTENT 66+652) / KM PROIECTAT 66+800 SCENARIU 1a GENERAL LAYOUT WALKWAY INVENTORY TABLE KM 66+800 SCENARIU 1a COD PLAN/ CODIFICATION SYSTEM: / DESIGNED ON 66+800 SCENARIU 1a
DATA/DATE: 06.2023	SCALA/SCALE: 1:100	EXEMPLAR NR. EXEMPLARY NO. 1	SF 207 002 25 Ps02 01 04