

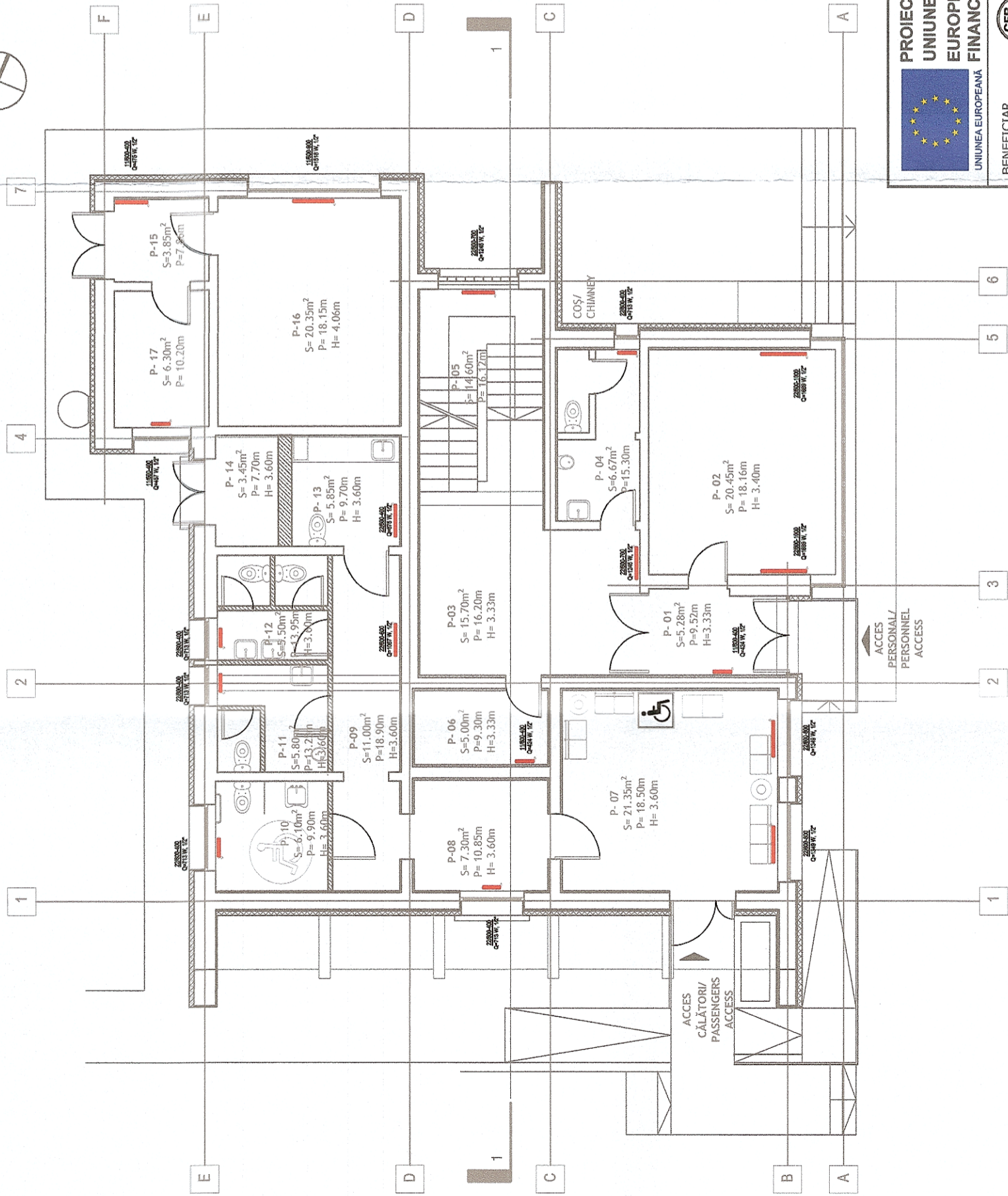



Plan parter/ Ground Floor



 GUVERNUL ROMÂNIEI GOVERNMENT OF ROMANIA		 COMPANIA NAȚIONALĂ DE CĂI FERATE "C.F.R." S.A. ROMANIAN RAILWAY NATIONAL COMPANY	
 PROIECT FINANȚAT DE UNIUNEA EUROPEANĂ EUROPEAN UNION FINANCED PROJECT		 acciona INGENIERIA ESPECIALIZADA OBRA CIVIL E INDUSTRIAL SA 140/20534/2004	
BENEFICIAR: UNIUNEA EUROPEANĂ		BENEFICIAR: ROMANIAN RAILWAY NATIONAL COMPANY	
PROIECTANT/ DESIGNER: ASOCIETATEA JOINT VENTURE: BALCONS Impex SRL 140/9877/2001		DENUMIRE PROIECT/ DENUMIRE LUCRARE: MODERNIZAREA INFRASTRUCTURII DE CALE FERATĂ DINTRE STĂTILE DE BUCUREȘTI NORD - JILAVA - GIURGIU NORD - GIURGIU NORD FRONTIERĂ MODERNIZATION OF THE RAILWAY INFRASTRUCTURE BUCHAREST NORTH - JILAVA - GIURGIU NORTH - GIURGIU NORTH BORDER	
PROIECTANT/ DESIGNER: ing. Vladimir DINU		SPECIALITATE/ SPECIALITY: THERMOVENTILATION INSTALLATIONS	
EXPERT CHEIE/ KEY EXPERT: ing. Marin BAICU		DENUMIRE PLAN/ DRAWING TITLE: PROIECT SCENARIU 1a - CLĂDIRE MIXTĂ (fostă CED) - JILAVA - SCHEMA INSTALAȚII TERMICE/ PROPOSAL SCENARIO 1a - MIXED (ex. CED) BUILDING - JILAVA - THERMOTECNOLOGICAL INSTALLATIONS LAYOUT	
DATA/DATE: 06.2023		EXEMPLAR NR./ EXEMPLARY NO.: 1	
SCARA/SCALE: 1:100		COD PLAN/ CODIFICATION SYSTEM: SF 207 002 10 It01 02 04	

CALEA FERATĂ / RAILWAY