

NOTA:

I. Prezentul plan a fost realizat avand la baza urmatoarele date:

- date puse la dispozitie de Beneficiar;
- date culesse de pe teren cu ocazia vizitarii obiectivului (masuratori, fotografii relevante, etc.);
- studiu topografic realizat in anul 2018;
- studiu geotehnic realizat in anul 2018;

Forajele geotehnice trecute pe plan sunt preluate din studiul geotehnic actual.

II. Constatari:

- Conform datelor culesse de pe teren se constata urmatoarele:
  - ciobituri ale muchiilor, crapaturi, zone cu segregari ale betonului, zone de carbonatari ca urmare a infiltratiei apei la cele doua culci;
  - zone cu crapaturi, zone de carbonatari ca urmare a infiltratiei apei la intradosul dalelor, zone cu armaturi descoperite si ruginite;
  - parapetele de protectie de pe partea dreapta lipseste;
  - degradarea aripilor monolite;
  - scările pe taluzuri lipsesc sau sunt acoperite, lipsesc parapetele de siguranta;
  - strada pe care o supratraverseaza este degradata.
- III. Anii constructiei: 1966; 1979

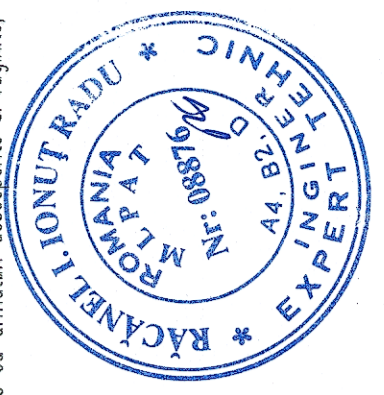

NOTE:

- I. The present drawing was drafted based on the following data:
- data provided by the Beneficiary;
  - data collected on site with the occasion of visiting the objective (measurements, relevant pictures, etc.);
  - topographic study realised in 2018;
  - geotechnical study realised in 2018;
- The geotechnical drilling presented on this drawing is taken from the actual geotechnical study.
- II. In-situ findings:

- According to the data collected on site we acknowledge the following:
- cracks of the edges, cracks, concrete segregated areas, the carbonation areas as a result of water infiltration at the abutments;
  - cracks, the carbonation areas at the soffit of the deck as a result of water infiltration, the expose corroded reinforcement areas;
  - the pedestrian guardrail are missing on the right side;
  - the cast-in-situ wing-walls damaged;
  - the stairs on the embankments are missing or are covered, the safety handrails are missing;
  - the street (under the culvert) is damaged.
- III. Construction years: 1966; 1979

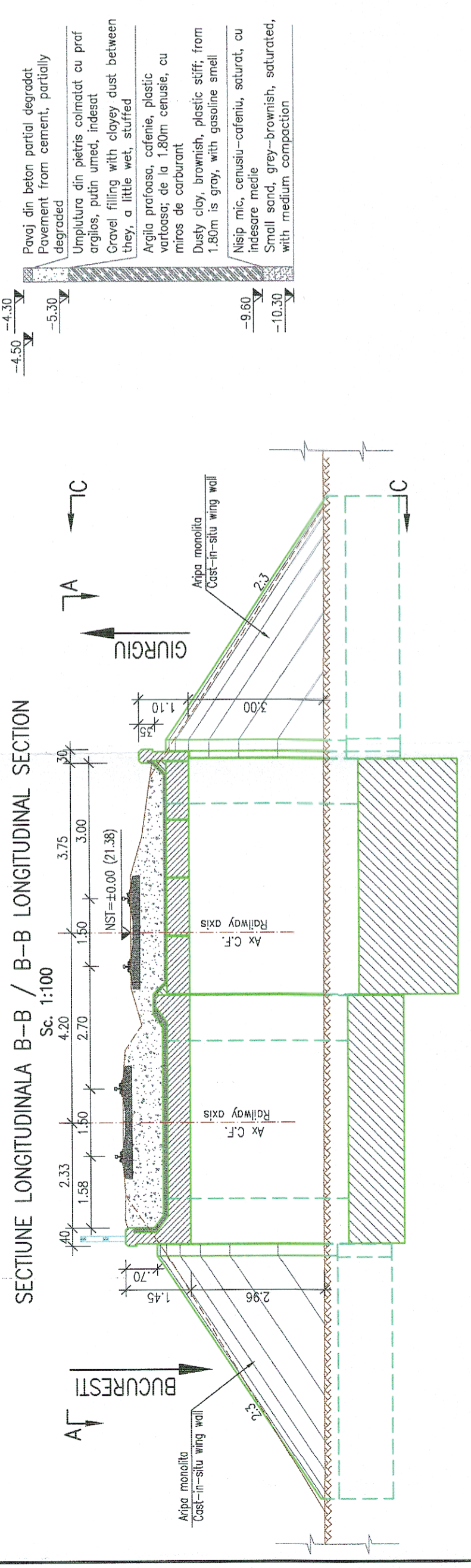
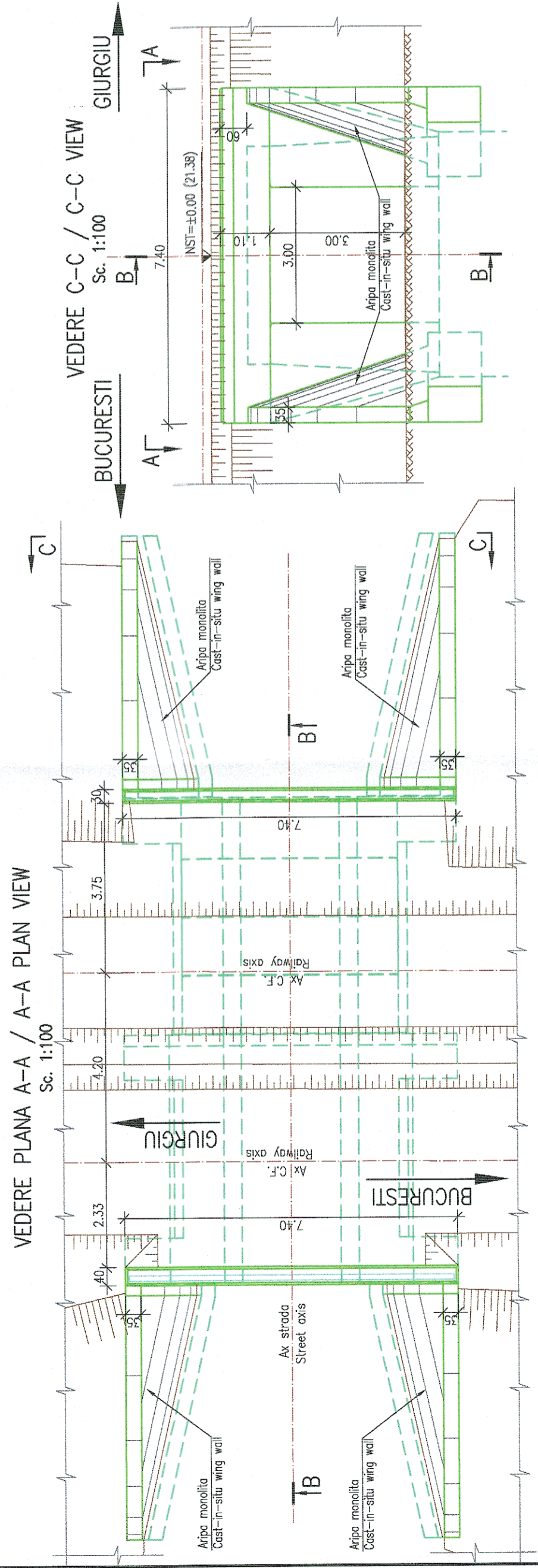

 <b>PROIECT FINANȚAT DE UNIUNEA EUROPEANĂ EUROPEAN UNION FINANCED PROJECT</b>		 <b>GUVERNUL ROMÂNIEI GOVERNMENT OF ROMANIA</b>	
 <b>BENEFICIAR BENEFICIARY:</b>		 <b>COMPANIA NAȚIONALĂ DE CĂI FERATE "C.F.R." S.A. ROMANIAN RAILWAY NATIONAL COMPANY</b>	
<b>PROIECTANT/ DESIGNER:</b> ASOCIEREA/ JOINT VENTURE:		<b>DENUMIRE PROJECT/ DENUMIRE LUCRARE:</b> "MODERNIZAREA LINIEI CF BUCUREȘTI NORD-JILAVA-GIURGIU NORD-GIURGIU NORD FRONTIERĂ" Lot 2 - MODERNIZAREA INFRASTRUCTURII DE CĂLE FERATE DIN TRECEREA STĂTILE CF BUCUREȘTI NORD - GIURGIU NORD - GIURGIU NORD FRONTIERA Lot 2 - MODERNIZATION OF THE RAILWAY BUCHAREST NORTH - JILAVA - GIURGIU NORTH - GIURGIU NORTH BORDER Lot 2 - MODERNIZATION OF THE RAILWAY INFRASTRUCTURE BUCHAREST NORTH - GIURGIU NORTH - GIURGIU NORTH BORDER	
<b>ASOCIEREA/ JOINT VENTURE:</b> J40/96877/2001 & J40/20534/2004		<b>SEMNAȚURA/ SIGNATURE:</b>  <b>NUME/NOME:</b> Ing. Madalin Mutu	
<b>PROIECTANT/ DESIGNER:</b> EXPERT CHEIE/ KEY EXPERT M/PM		<b>SPECIALTATE/ SPECIALITY:</b> PODURI BRIDGES	
<b>DATA/DATE:</b> 04.2018		<b>DENUMIRE PLAN/ DRAWING TITLE:</b> RELEVU PODET KM 65+816 CULTVERT SURVEY KM 65+816	
<b>SCALA/SCALE:</b> 1:100		<b>EXEMPLAR NR./ EXEMPLARY NO.:</b> 1	
<b>COD PLAN/ CODIFICATION SYSTEM:</b>		<b>ET 207 Lot 2 33 Pd02 01 00</b>	