

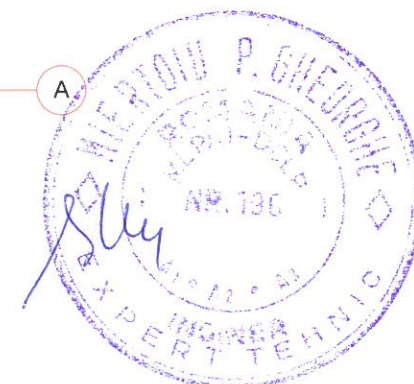

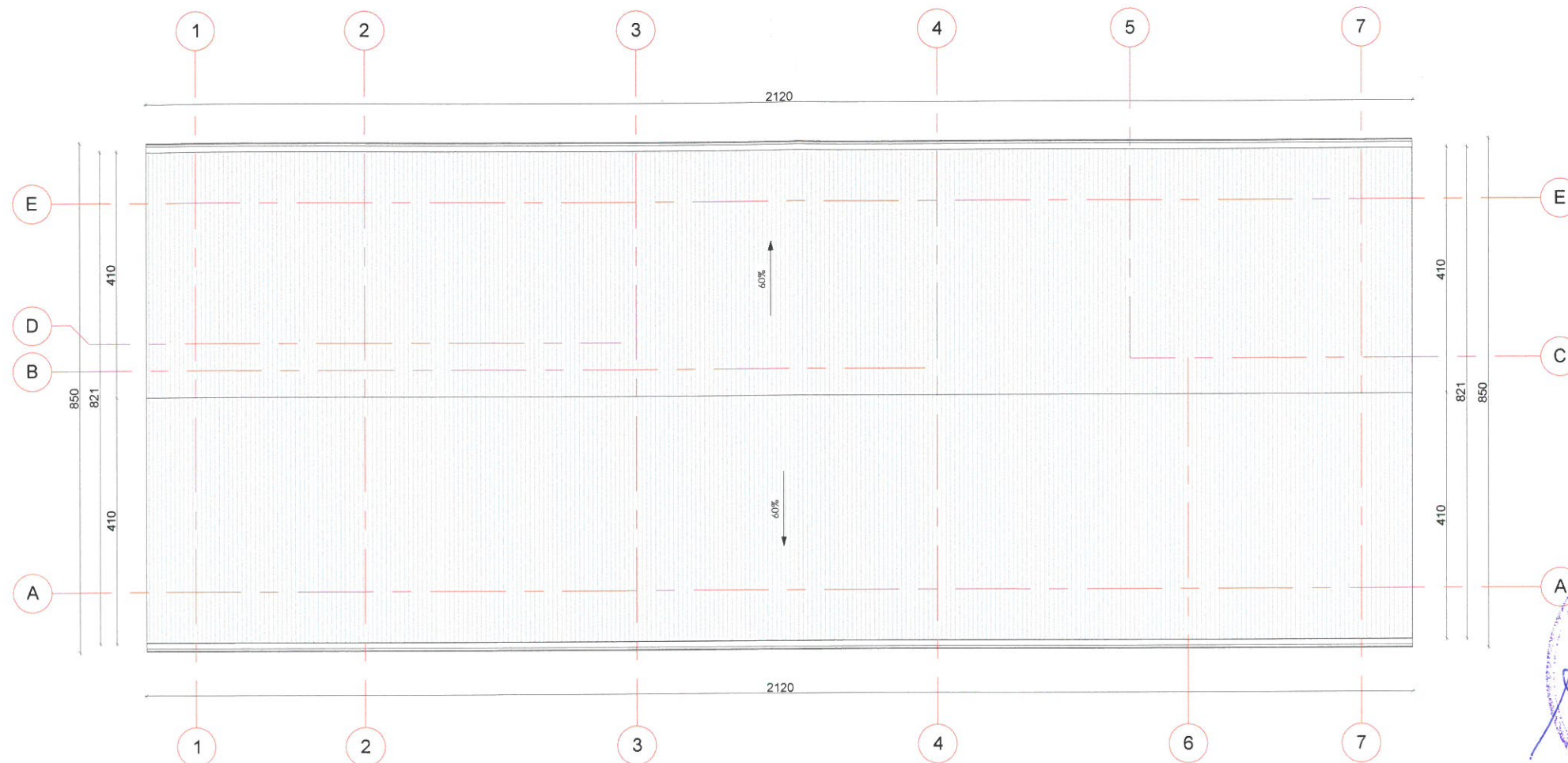
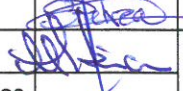

Haltă Aghireș - Plan învelitoare

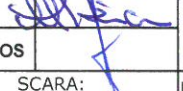

 GUVERNUL ROMÂNIEI		P.O.I.M.		 PROIECT FINANȚAT DE UNIUNEA EUROPEANĂ	
BENEFICIAR:  COMPANIA NAȚIONALĂ DE CĂI FERATE C.N.C.F. "C.F.R." S.A.					
PROIECTANT:			DENUMIRE PROIECT:		
ASOCIEREA:  acciona &  BALCONS			REACTUALIZARE STUDIU DE FEZABILITATE PENTRU "ELECTRIFICAREA ȘI REABILITAREA LINIEI DE CALE FERATĂ CLUJ - ORADEA - EPISCOPIA BIHOR"		
EXPERT SECUNDAR		NUME	SEMNATURA	OBIECT:	
EXPERT PRINCIPAL		ing. Sonia PETREA		LUCRĂRI CIVILE ÎN STAȚII	
CEC/MP		ing. Mihaela STAICU		JUDEȚUL CLUJ	
DATA:		SCARA:	EXEMPLAR NR.:	COD PLAN:	
08.2017		1:100		ET 36 LO 10 R001 002 000	