

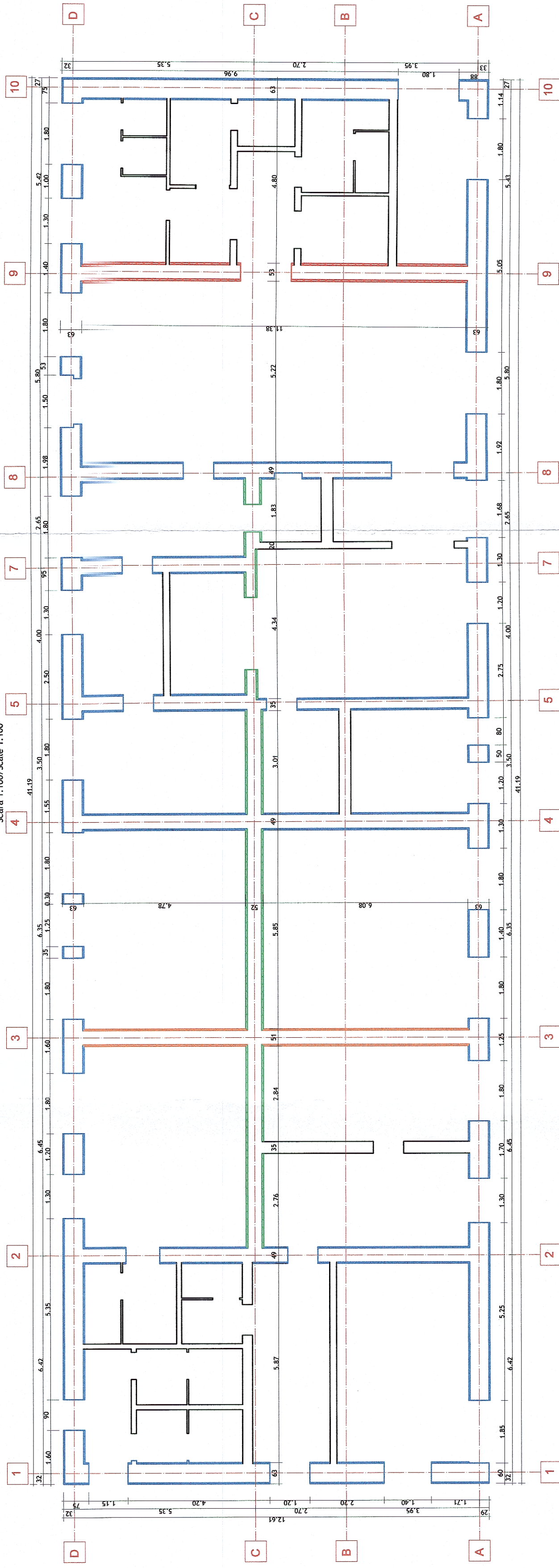

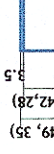

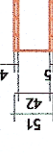

Plan parter Cladire Calatori Hueidin/Huedin Train  
Station Building- Ground floor  
Scara 1:100/Scale 1:100



LEGENDA/DESIGNATION

-  camasaire pe ambele fete, cu plase sudate Ø 4/100/100 mm si mortar ciment M10-T(M100 T) de 3.5 cm grosime/coating on both sides, with Ø4/100/100mm welded netting and 3.5cm thick M10-T(M100 T) grout
-  camasaire pe ambele fete, cu plase sudate Ø 4/100/100 mm si mortar ciment M10-T(M100 T) de 4.5 cm grosime//coating on both sides, with Ø4/100/100mm welded netting and 4.5 cm thick M10-T(M100 T) grout
-  camasaire pe ambele fete, cu plase sudate Ø 4/100/100 mm si mortar ciment M10-T(M100 T) de 5 cm grosime//coating on both sides, with Ø4/100/100mm welded netting and 5 cm thick M10-T(M100 T) grout
-  camasaire pe ambele fete, plase sudate Ø 6/100/100 mm si mortar ciment M10-T(M100 T) de 5.5 cm grosime/coating on both sides, with Ø6/100/100mm welded netting and 5.5 cm thick M10-T(M100 T) grout

 <b>GUVERNUL ROMÂNIEI</b>		<b>P.O.I.M.</b>		 <b>PROIECT FINANȚAT DE UNIUNEA EUROPEANĂ</b>	
 <b>BENEFICIAR:</b>		<b>COMPANIA NAȚIONALĂ DE CĂI FERATE C.N.C.F. "C.F.R." S.A.</b>			
<b>PROIECTANT:</b>					
<b>ASOCIEREA:</b>		<b>ACCIONA &amp; B</b>			
<b>EXPERT SECUNDAR</b> ing. Sonia TIU	<b>NUME</b> SEMNAȚURA	<b>DENUMIRE PROIECT:</b>	<b>REACTUALIZARE STUDIU DE FEZABILITATE PENTRU "ELECTRIFICAREA ȘI REABILITAREA LINIEI DE CALE FERATĂ CLUJ - ORADEA - EPISCOPIA BIHOR"</b>		
<b>EXPERT PRINCIPAL</b> ing. Mihaela STAIUCU	<b>OBIECT:</b>	<b>LUCRĂRI CIVILE</b>			
<b>CEC/MP</b> ing. Stelian VARĂ-OROS	<b>DENUMIRE PLAN:</b>	<b>PLAN PARTER CLĂDIRI CĂLĂTORI HUEDIN/HUEDIN TRAIN STATION BUILDING- GROUND FLOOR</b>			
<b>DATA:</b> 07.2021	<b>SCARA:</b> 1:100	<b>EXEMPLAR NR.:</b> 1	<b>JUDEȚUL CLUJ/ CLUJ DISTRICT</b>		
		<b>SFF</b>		<b>36</b>	<b>L0</b>
		<b>11</b>		<b>R001</b>	<b>001003</b>