

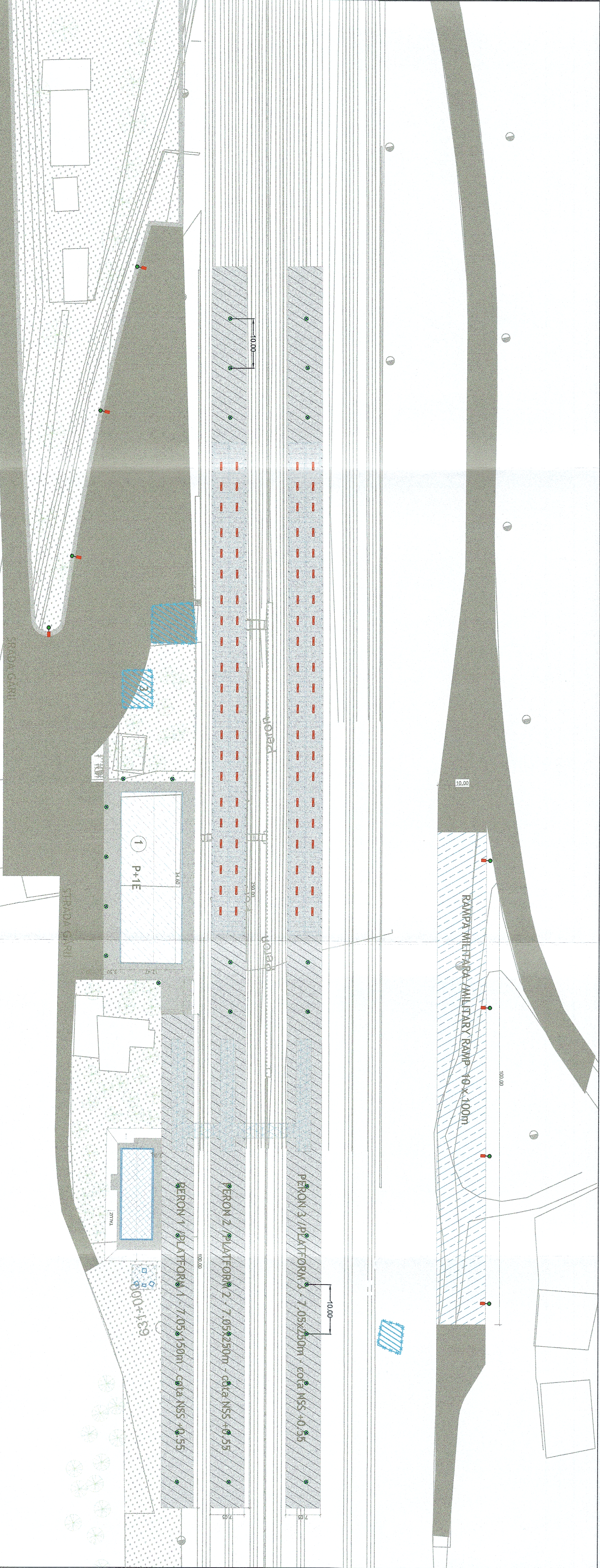









GARA TIGLEAD



LEGENDĂ

-  Stâlp de iluminat metalic, h=6m, prevăzut cu corp de iluminat tip LED, 100W
-  Stâlp metalic tubular, dotat cu corp iluminat LED, 100W, panou fotovoltaic
-  Corp de iluminat echipat cu LED, 53W, montat sub copertină

 GVERNUL ROMÂNIEI ROMANIAN GOVERNMENT		 P.O.I.M. O.H.I.P.		 PROIECT FINANȚAT DE UNIUNEA EUROPEANĂ EUROPEAN UNION FINANCED PROJECT	
 COMPANIA NAȚIONALĂ DE CĂI FERATE "C.N.F.R." S.A. ROMANIAN RAILWAY NATIONAL COMPANY		 acciona Ingineria		 B. PROIECT	
PROIECTANT/ DESIGNER/ ASOCIEREA/ JOINT VENTURE:		DENUMIRE/ PROJECT TITLE:		REACTUALIZARE STUDIU DE FEZABILITATE PENTRU "ELECTRIFICAREA ȘI REABILITAREA LINIEI DE CĂLE FERATĂ CLUJ - ORADEA - EPIȘCOPIA BIHOR" REVIEW OF "CLUJ - ORADEA - EPIȘCOPIA BIHOR RAILWAY LINE ELECTRIFICATION AND REHABILITATION" FEASIBILITY STUDY	
EXPERT SECUNDA/ SECONDARY EXPERT:		NUME/ NAME:		SPECIALITATE/ SPECIALITY:	
EXPERT PRINCIPAL/ MAIN EXPERT:		Ing. Ionel VĂLU		Ing. Ionel VĂLU	
MP/PM:		Ing. Mihaela STACU		Ing. Mihaela STACU	
DATA:		SCARA:		LUCRĂRI CIVILE / CIVIL WORK	
07.2021		1:500		PROPUNERE - STATA CF TIGLEAD PLAN SITUATIE ILLUMINAT EXTERIOR	
07.2021		1:500		EXEMPLAR NR/ COPY NO.:	
07.2021		1:500		SCARA/ COORDINATION SYSTEM:	
07.2021		1:500		SFF 36 LO 35 le000 001 003	