

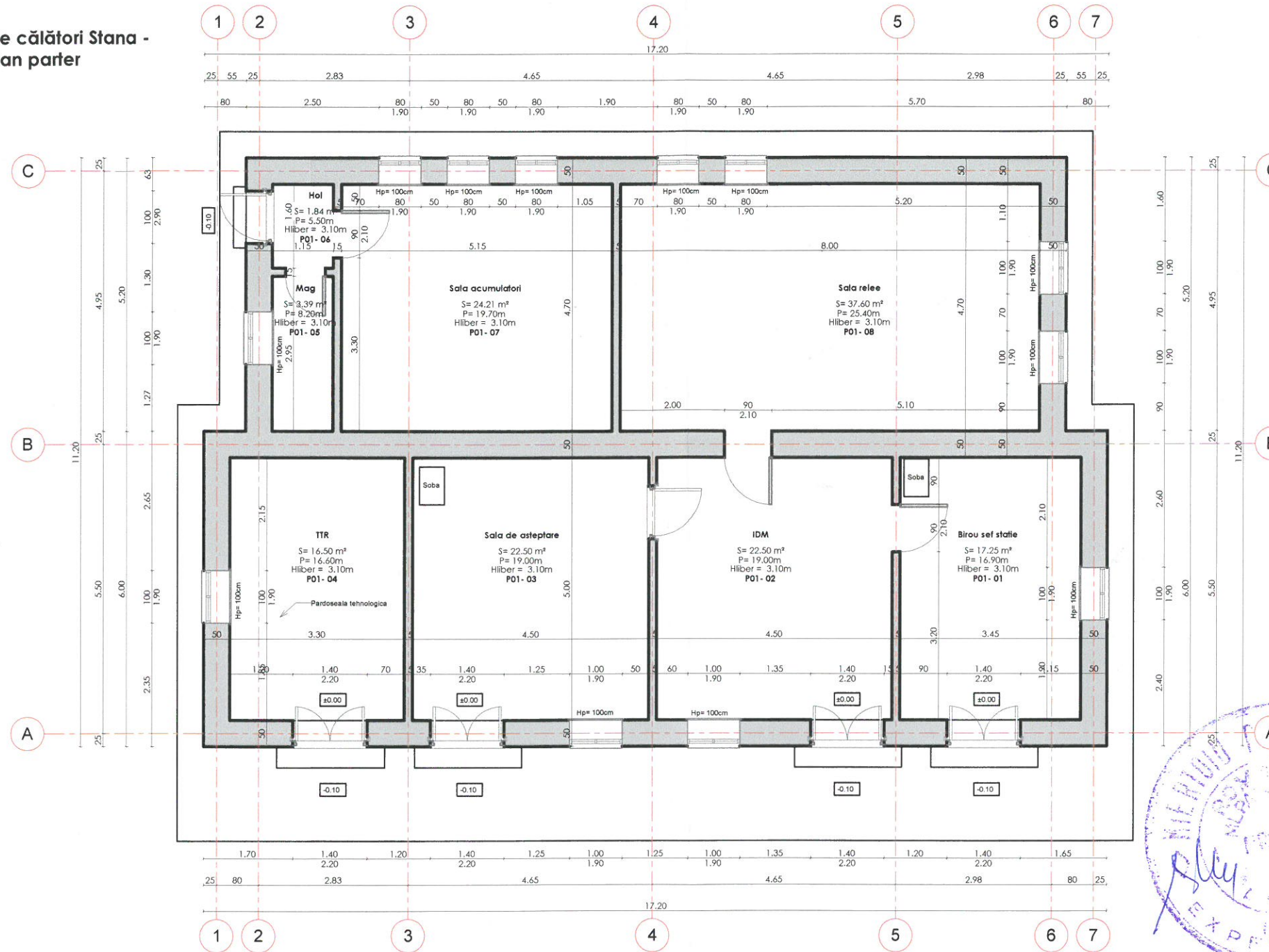







Clădire de călători Stana -
Plan parter

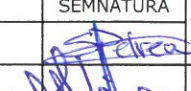
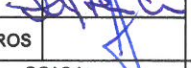

 GUVERNUL ROMÂNIEI		P.O.I.M.		 PROIECT FINANȚAT DE UNIUNEA EUROPEANĂ	
BENEFICIAR:  COMPANIA NAȚIONALĂ DE CĂI FERATE C.N.C.F. "C.F.R." S.A.					
PROIECTANT:			DENUMIRE PROIECT:		
ASOCIEREA:  			REACTUALIZARE STUDIU DE FEZABILITATE PENTRU "ELECTRIFICAREA ȘI REABILITAREA LINIEI DE CALE FERATĂ CLUJ - ORADEA - EPISCOPIA BIHOR"		
EXPERT SECUNDAR		NUME	SEMNATURA	OBIECT:	
		ing. Sonia PETREA		LUCRĂRI CIVILE ÎN STAȚII	
EXPERT PRINCIPAL		ing. Mihaela STAIU		DENUMIRE PLAN:	
CEC/MP		ing. Stelian VARĂ-OROS		JUDEȚUL SĂLAJ CLĂDIRE DE CALĂTORI STANA - RELEVU - PLAN PARTER	
DATA:		SCARA:		EXEMPLAR NR.:	
08.2017		1:100		COD PLAN:	
				ET 36 L0 11 R001 001 000	