

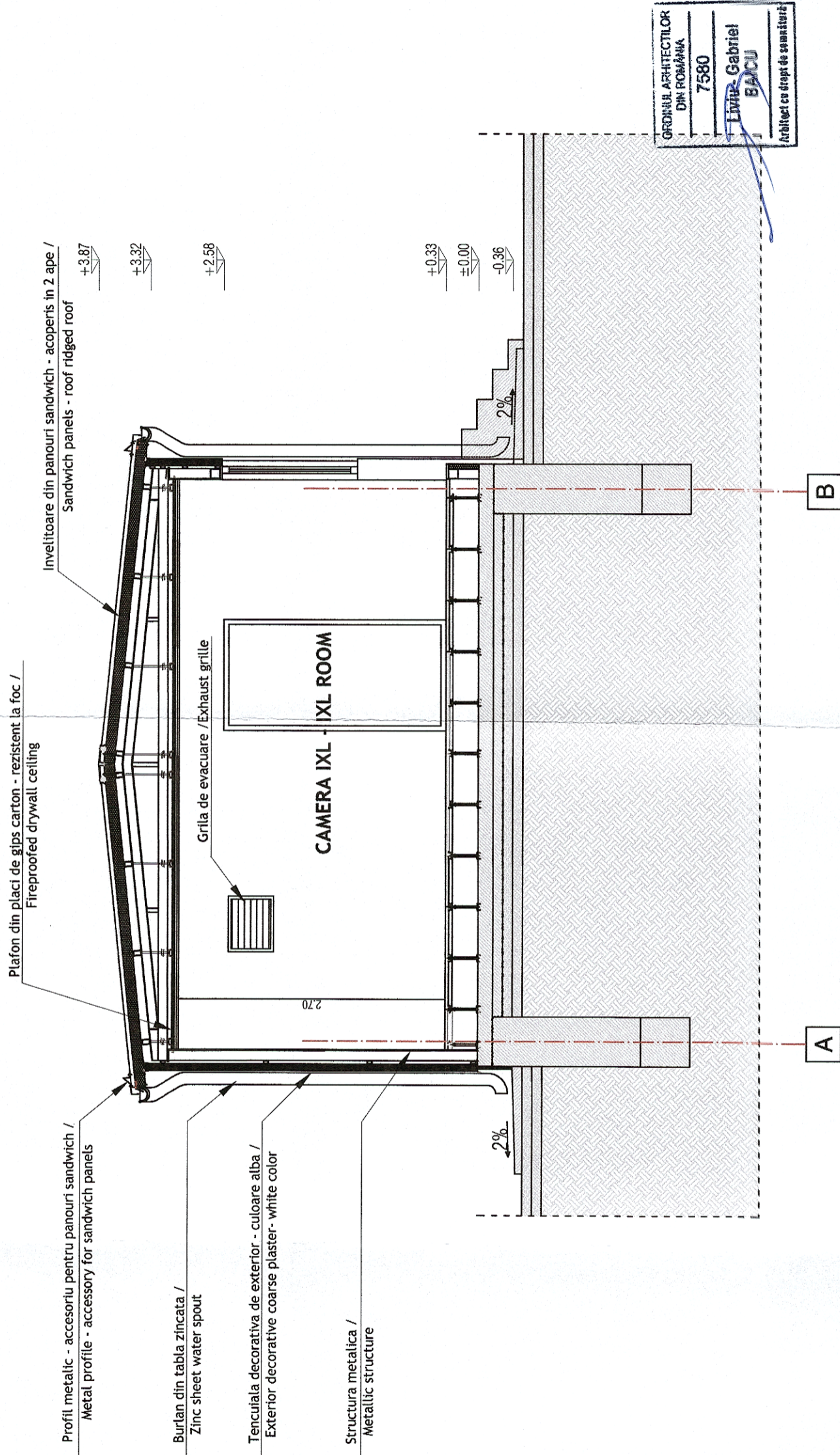







# Clădire container CED - Tip - Secțiune 2-2/

## Electrodinamic centralization container building - Model - Section 2-2

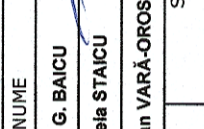
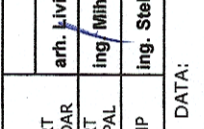

ORDINEA ARHITECTILOR  
DIN ROMANIA  
7580  
Liviu Gabriel  
BAICU  
Arhitect cu drept de semnătură

 <b>GUVERNUL ROMÂNIEI</b>		 <b>P.O.I.M.</b>		 <b>PROIECT FINANȚAT DE UNIUNEA EUROPEANĂ</b>	
		<b>COMPANIA NAȚIONALĂ DE CĂI FERATE C.N.C.F. "C.F.R." S.A.</b>			
<b>PROIECTANT:</b> ASOCIEREA:  &  ing. Mihaela STAIU ing. Stelian VARĂ-OROS		<b>DENUMIRE PROIECT:</b> REACTUALIZARE STUDIU DE FEZABILITATE PENTRU "ELECTRIFICAREA ȘI REABILITAREA LINIEI DE CALE FERATĂ CLUJ - ORADEA - EPISCOPIA BIHOR"		<b>OBIECT:</b> LUCRĂRI CIVILE	
<b>EXPERT SECUNDAR</b> arh. Liviu G. BAICU <b>EXPERT PRINCIPAL</b> ing. Mihaela STAIU <b>CEC/MP</b> ing. Stelian VARĂ-OROS		<b>SEMNAȚURA</b>   		<b>DENUMIRE PLAN:</b> PROPUNERE - SECȚIUNE 2-2 - CLĂDIRE CONTAINER CED -TIP	
<b>DATA:</b> 07.2021		<b>SCARA:</b> 1:50		<b>EXEMPLAR NR.:</b> 1	
<b>BENEFICIAR:</b>		<b>COD PLAN:</b> SFF 36 L0 00 Ah002 004 003			