

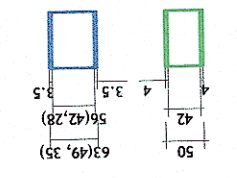

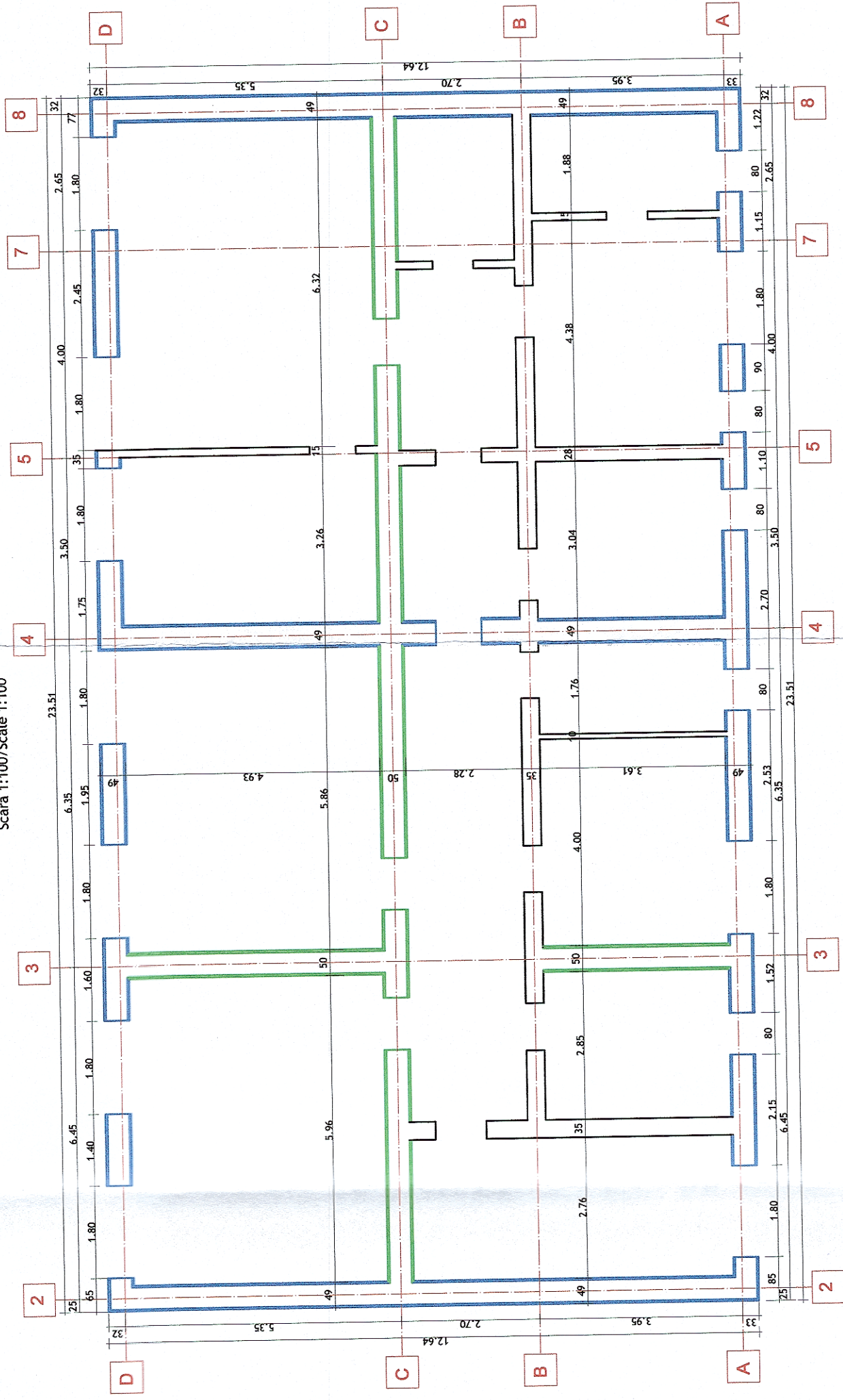

Plan etaj Cladire Calatori Huedin/Huedin Train
 Station Building- First floor
 Scara 1:100/Scale 1:100

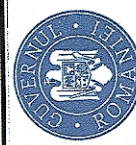
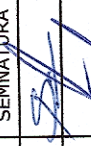

LEGENDA/DESIGNATION
 camasuire pe ambele fete, cu plase sudate Ø 4/100/100 mm si mortar ciment M10-T(M100 T) de 3.5 cm grosime/coating on both sides, with Ø4/100/100mm welded netting and 3.5cm thick M10-T(M100 T) grout
 camasuire pe ambele fete, cu plase sudate Ø 4/100/100 mm si mortar ciment M10-T(M100 T) de 4 cm grosime/coating on both sides, with Ø4/100/100mm welded netting and 4 cm thick M10-T(M100 T) grout

 GUVERNUL ROMÂNIEI		P.O.I.M.		 PROIECT FINANȚAT DE UNIUNEA EUROPEANĂ	
		COMPANIA NAȚIONALĂ DE CĂI FERATE C.N.C.F. "C.F.R." S.A.			
BENEFICIAR:		REACTUALIZARE STUDIU DE FEZABILITATE PENTRU "ELECTRIFICAREA ȘI REABILITAREA LINIEI DE CALE FERATĂ CLUJ - ORADEA - EPISCOPIA BIHOR"			
PROIECTANT: ASOCIEREA:		 & 		DENUMIRE PROIECT:	
EXPERT SECUNDAR ing. Sonia TIU		NUME ing. Sonia TIU		OBIECT:	
EXPERT PRINCIPAL ing. Mihaela STAIUCU		SEMNATURA 		JUDEȚUL CLUJ/ CLUJ DISTRICT	
CEC/MP ing. Stelian VARĂ-OROS		SCARA 1:100		DENUMIRE PLAN:	
DATA: 07.2021		EXEMPLAR NR.: 1		PLAN ETAJ CLĂDIRI CĂLĂTORI HUEDIN/HUEDIN TRAIN STATION BUILDING- FIRST FLOOR	
COD PLAN:		SFF 36 L0 11 R001 002 003			