

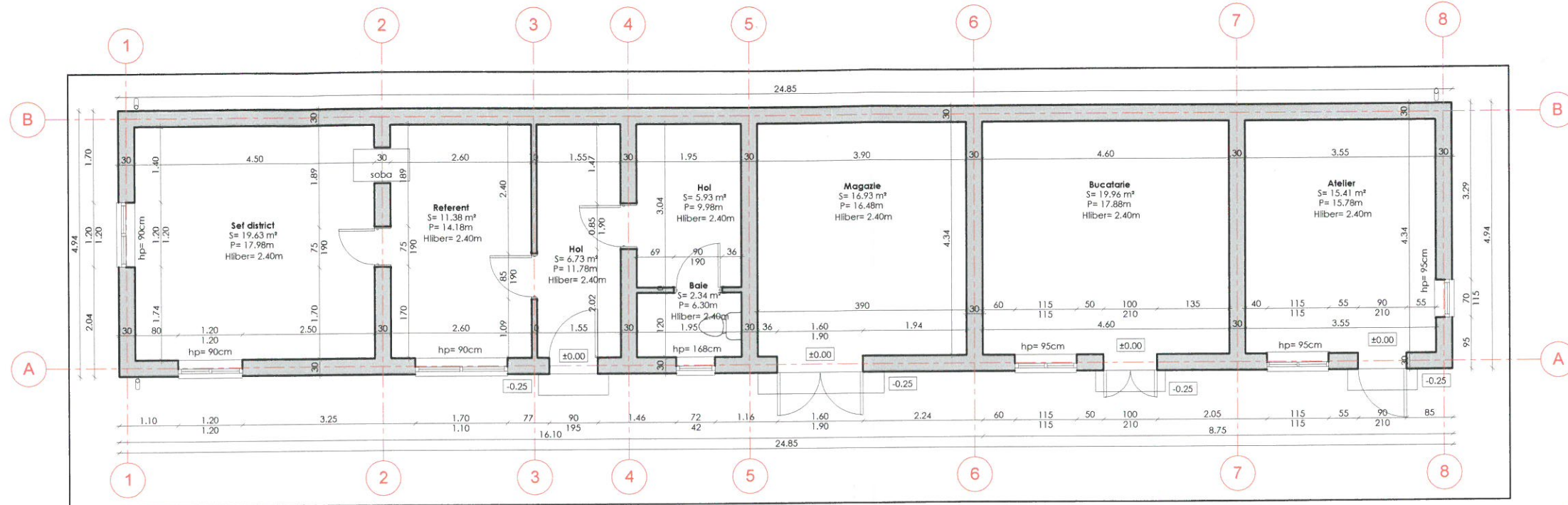







Clădire district L10 Ciucea L3D10 și Clădire district Ciucea L3D10 -
Plan parter



 GUVERNUL ROMÂNIEI		P.O.I.M.		 PROIECT FINANȚAT DE UNIUNEA EUROPEANĂ	
 COMPANIA NAȚIONALĂ DE CĂI FERATE C.N.C.F. "C.F.R." S.A.					
PROIECTANT: ASOCIEREA:  & 			DENUMIRE PROIECT: REACTUALIZARE STUDIU DE FEZABILITATE PENTRU "ELECTRIFICAREA ȘI REABILITAREA LINIEI DE CALE FERATĂ CLUJ - ORADEA - EPISCOPIA BIHOR"		
EXPERT SECUNDAR ing. Sonia PETREA		NUME ing. Sonia PETREA		SEMNATURA 	
EXPERT PRINCIPAL ing. Mihaela STAIU		NOME ing. Mihaela STAIU		SEMNATURA 	
CEC/MP ing. Stelian VARĂ-OROS		NOME ing. Stelian VARĂ-OROS		SEMNATURA 	
DATA: 08.2017		SCARA: 1:100		EXEMPLAR NR.: COD PLAN:	
				ET 36 LO 19 R005 001 000	