

SUSPENSIE CATENARA COMPLET COMPENSATA

Linii secundare si abatute

FULL COMPENSATED CATENARY

Turnouts and secondary Tracks

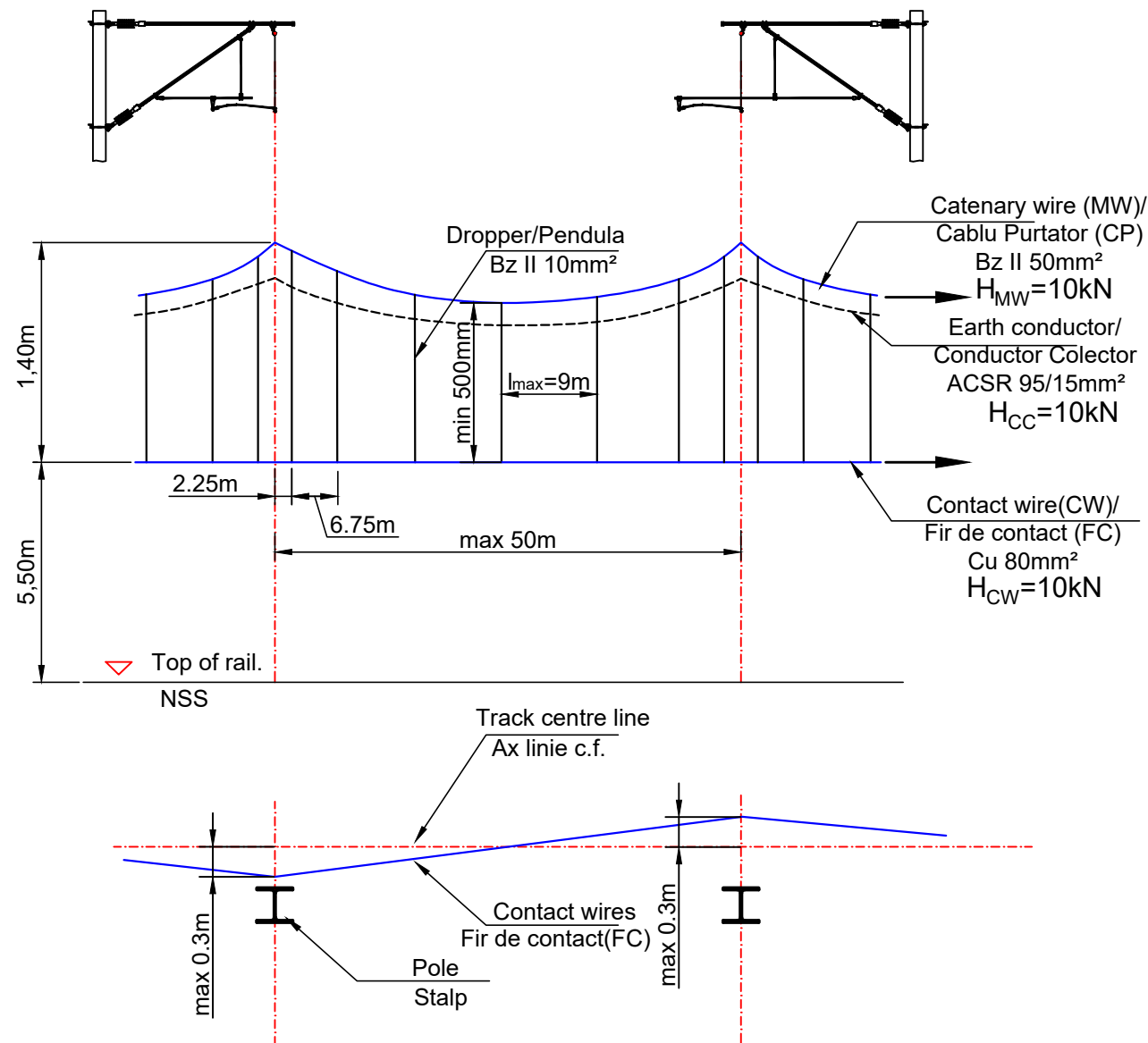

CATENARY CHARACTERISTICS

CATENARA PENTRU LINIILE SECUNDARE SI DIAGONALELE DIN STATIILE c.f CONSTITUTION OF OVERHEAD SYSTEM FOR SECONDARY LINE				
Descriere Description	Tip conductor Type	Sectiunea nominala Nominal cross sect	Fora intindere Tension applied	Tip ancorare Method of tensioning
Cablu purtator Messenger cable	Bz 50	48,35mm ²	1000daN	ancorare compensata auto tensioning
Fir de contact Contact wire	Cu 80	80mm ²	1000daN	ancorare compensata auto tensioning
Conductor colector Earthing conductor	95/15 ACSR	105mm ²	1000daN	ancorare rigida fixed tensioning



ENTITATE CONTRACTANTA
CONTRACTING ENTITY

C.N.C.F. "C.F.R." - S.A.



CONTRACTANT
CONTRACTOR

Asocierea S.C. ISPCF S.A. - S.C. BAICONS IMPEX SRL

	Nume Name	Data Date	Semnatura Signature
Şef Proiect Project Manager	Gorgonetu Viorel	11.2024	
Verificat Checked	Spack Cristina	11.2024	
Proiectat Designed	Spack Cristina	11.2024	

"Modernizarea liniilor și instalațiilor din
Complexul Feroviar București"
Studiu de fezabilitate

Proiect / Project
38 / 2022

"Modernization lines and installations in the
Bucharest Railway Complex
Feasibility Study

Faza / Phase
S.F.
F.S.

Denumire / Title

Criteria generale LC pentru secundara
Contact line general criteria for secondary line

Scara / Scale

Codificare / Codification System

COBU SF LLC DPA 00 01 011 R00

Istoricul reviziilor / Revision History

Rev.	Data/Date	Descriere Modificare / Modification description
1		
2		
3		
4		