

**PLAN PLATFORMA PENTRU SEPARATOR
PLATFORM PLAN FOR SEPARATOR**
Scara / Scale 1:25

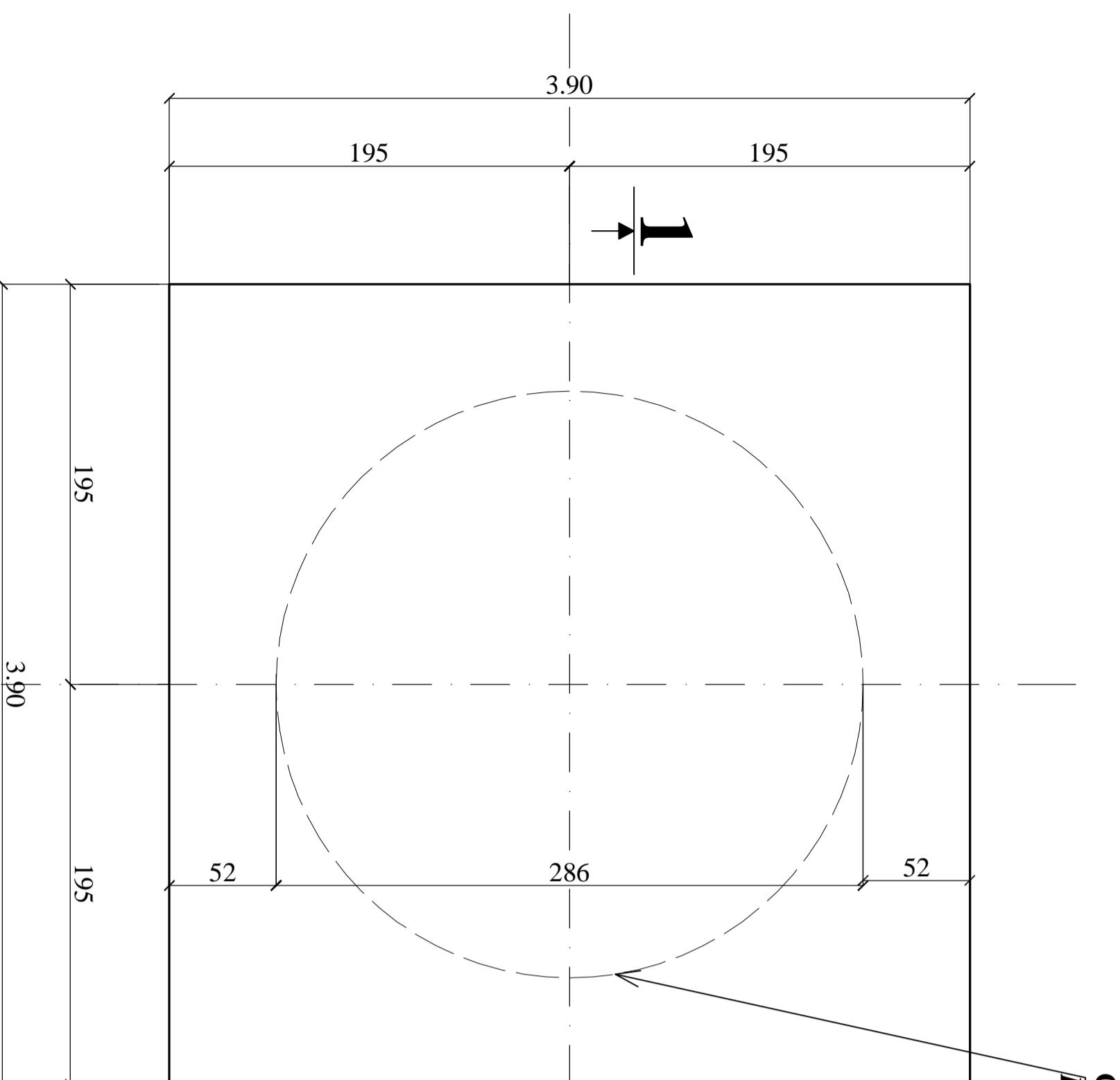

SECTIUNEA / SECTION "1" - "1"
Scara / Scale 1:25

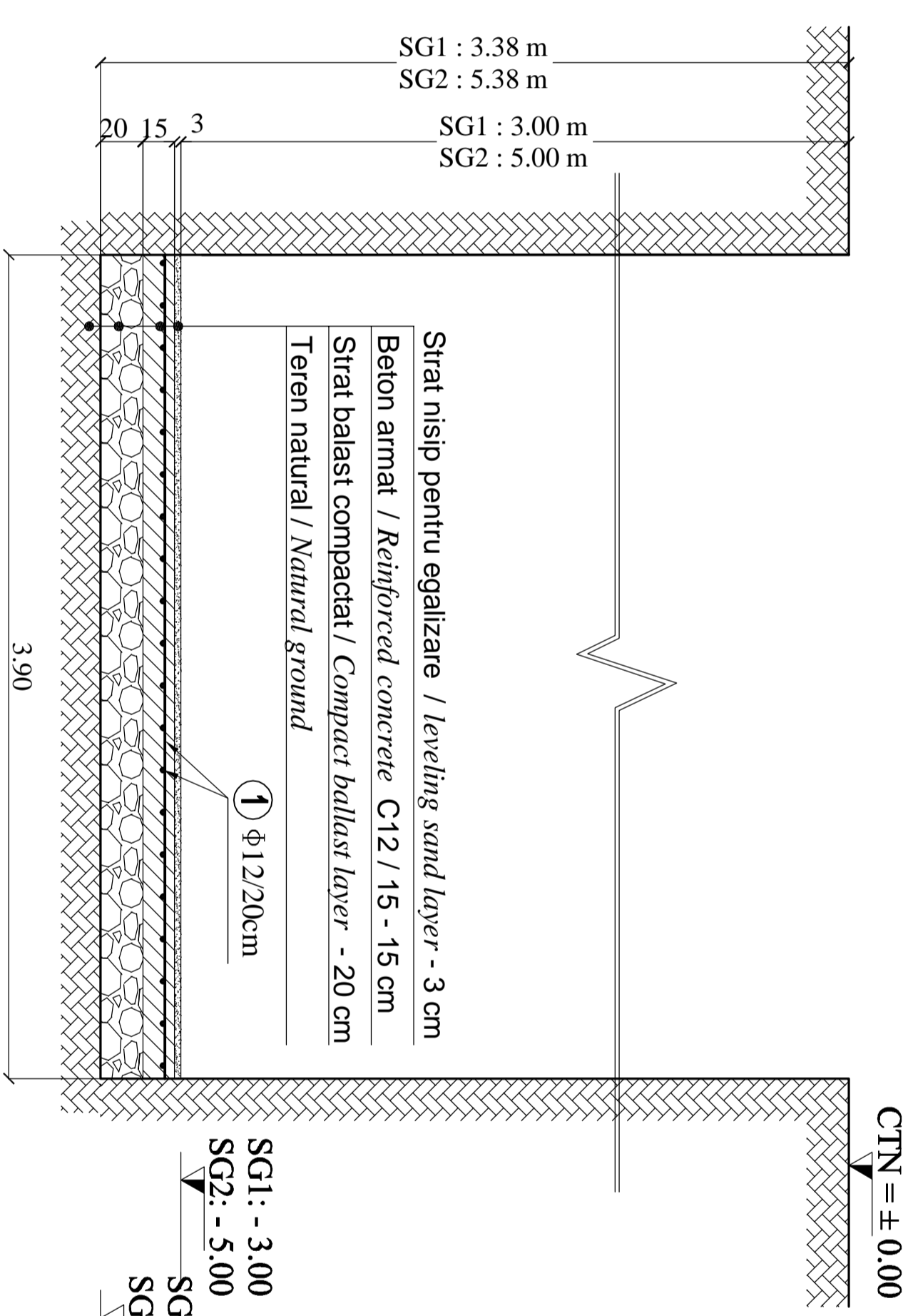

± 0.00 = NSS proiectat / Superior level of the railway track

SG1 = Separatorul de grasimi 1, pentru care adancimea de montaj este -3.00 m de la Cota NSS proiectata / Oil separator 1, for which the fitting depth is -3.00 m from the superior level of the railway track

SG2 = Separatorul de grasimi 2, pentru care adancimea de montaj este -5.00 m de la Cota NSS proiectata / Oil separator 2, for which the fitting depth is -5.00 m from the superior level of the railway track

EXTRAS ARMATURA - BILL OF REINFORCEMENT

Marca	Φ	buc	lung (m)	PC 52 Φ 12
1	12	40	3.81	152.40
Total m/Φ				152.40
Kg/ m/Φ				0.898
Kg /Φ				135.33
TOTAL KG				135.33

MATERIALE - MATERIALS
BETON ARMAT : C 6/7.5
CONCRETE : C 6/7.5

Index	Date	Modification/Revision	Projectant Designer	Approved Consultant	Approved CFR
D					
C					
B					
A					

GUVERNUL ROMANIEI / ROMANIAN GOVERNMENT

PROIECT FINANȚAT DE UNIUNEA EUROPEANĂ A EUROPEAN UNION FINANCED PROJECT

C.N.C.F. "C.F.R." - S.A.
CLIENT / CLIENT
 **TALFER**
 GRUPPO FERROVIE DELLO STATO
 Joint Venture leader
 **SCOTT WILSON**
 **OBERMEYER**
 PLANET + BERATEN GmbH
TECNIC
 Consulting Engineers

CONSULTANT / CONSULTANT

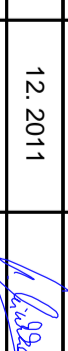
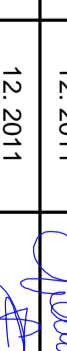
Approbat / Approved	Set proiect / Project manager	R. Luizza	Data / Date	Semnatura / Signature
Approbat / Approved	Coordonator Sectiune 1 / Section 1 Coordinator	C. Gambelli	12.2011	
Verificat / Checked	Verificator / Verifier	Giuseppe Fioravanti	12.2011	

SUBCONTRACTANT / SUBCONTRACTOR

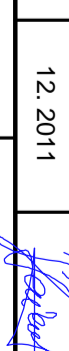
Approbat / Approved	Responsabil Subcontractant / Subcontractant Responsible	A. Stanoiu - Dinulescu	Data / Date	Semnatura / Signature
Elaborat / Elaborated	Proiectant / Designer	Andreea Statcu	12.2011	

Reabilitarea liniei de cale ferata Brasov - Simeria, parte componenta a coridorului IV Pan European, pentru circulatia trenurilor cu viteza maxima de 160 km/h, Tronsoanel : Brasov - Sighisoara
 Rehabilitation of the railway line Brasov - Simeria, component Part of the IV Pan-European Corridor, for the trains circulation with maximum speed of 160 km/h, Section : Brasov - Sighisoara

2004/RO/16/PP/PA/003
 Project/Project
 Faza / Phase:
 P.Th. / T.D.

Denumire desen / Drawing Title :
PLATFORMA BETON PENTRU SEPARATOR DE GRASIMI - PLAN PLATFORMA CONCRETE PLATFORM FOR OIL SEPARATOR - PLATFORM PLAN

Scara / Scale 1:25

Codificare / Codification System

E	A	S	1	0	1	C	0	0	P	Z	C	C	0	0	0	0	X	0	0	1	1
---	---	---	---	---	---	---	---	---	---	---	---	---	---	---	---	---	---	---	---	---	---

Nr. / No 01 / 01