

NOTA

- Prezentul plan s-a intocmit in conformitate cu planul de cofraj EA5101E11BPPV02120121
- Armarea coloanelor este cuprinsa in planul EA5101E11BCPV02120200
- Betonul din radier se va turna prin pompare.
- La punerea in opera a betonului turnat prin pompare se vor lua toate masurile:
 - procesul de pompare sa se desfasoare continuu fara intreruperi;
 - turnarea sa se faca in 3(trei) puncte si sa dureze max 6 ore;
 - inaltimea libera de cadere a betonului sa fie de max 0.5m;
 - betonul se va turna in straturi de max. 40cm grosime, pentru a permite o buna vibrare.
 - betonul sa fie bine compactat prin vibrare.

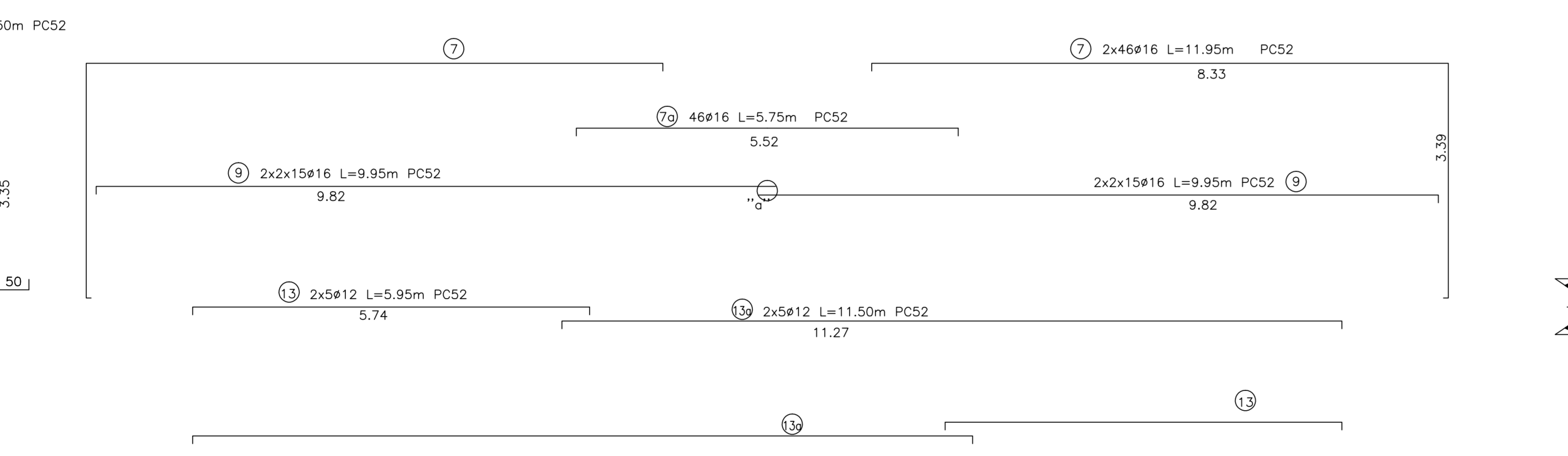
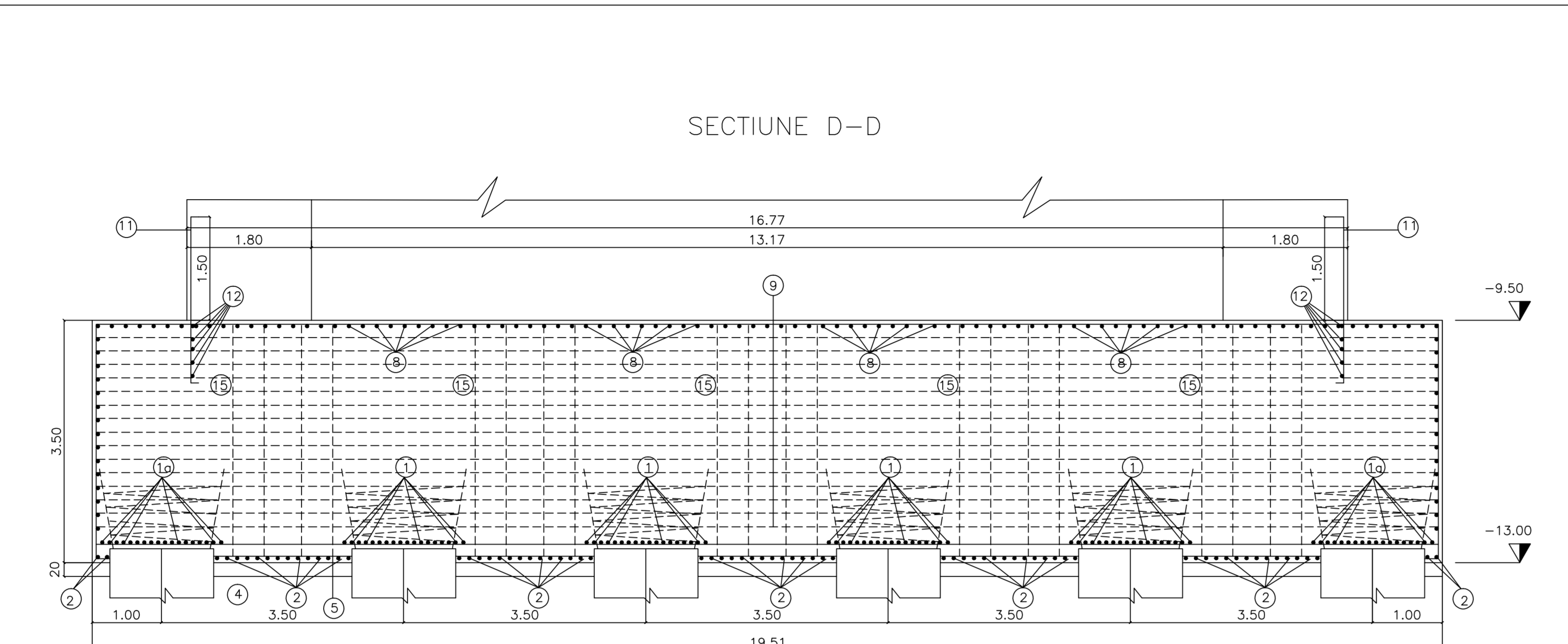

NOTE:

- This drawing was drawn up according to the shuttering plan EA5101E11BPPV02120121
- The column reinforcing can be found in drawing EA5101E11BCPV02120200
- The concrete in the raft will be cast by pumping.
- During pumped concrete placement, all measures will be taken so that:
 - the pumping process will be continuous, without any interruption;
 - the concrete will be cast in 3 (three) points and will last max. 6 hours;
 - the free falling height of concrete will be max. 0.5m;
 - the concrete will be cast in max. 40 cm thick layers to allow good vibration;
 - the concrete will be well-compacted by vibration.

LEGENDA:

- BETON - C25/30
- CONCRETE - S255, S335
- ARMATURA - S255, S335
- REINFORCING BAR - S255, S335
- ACOPERIRE - min. 5cm
- COVERING - min. 5cm

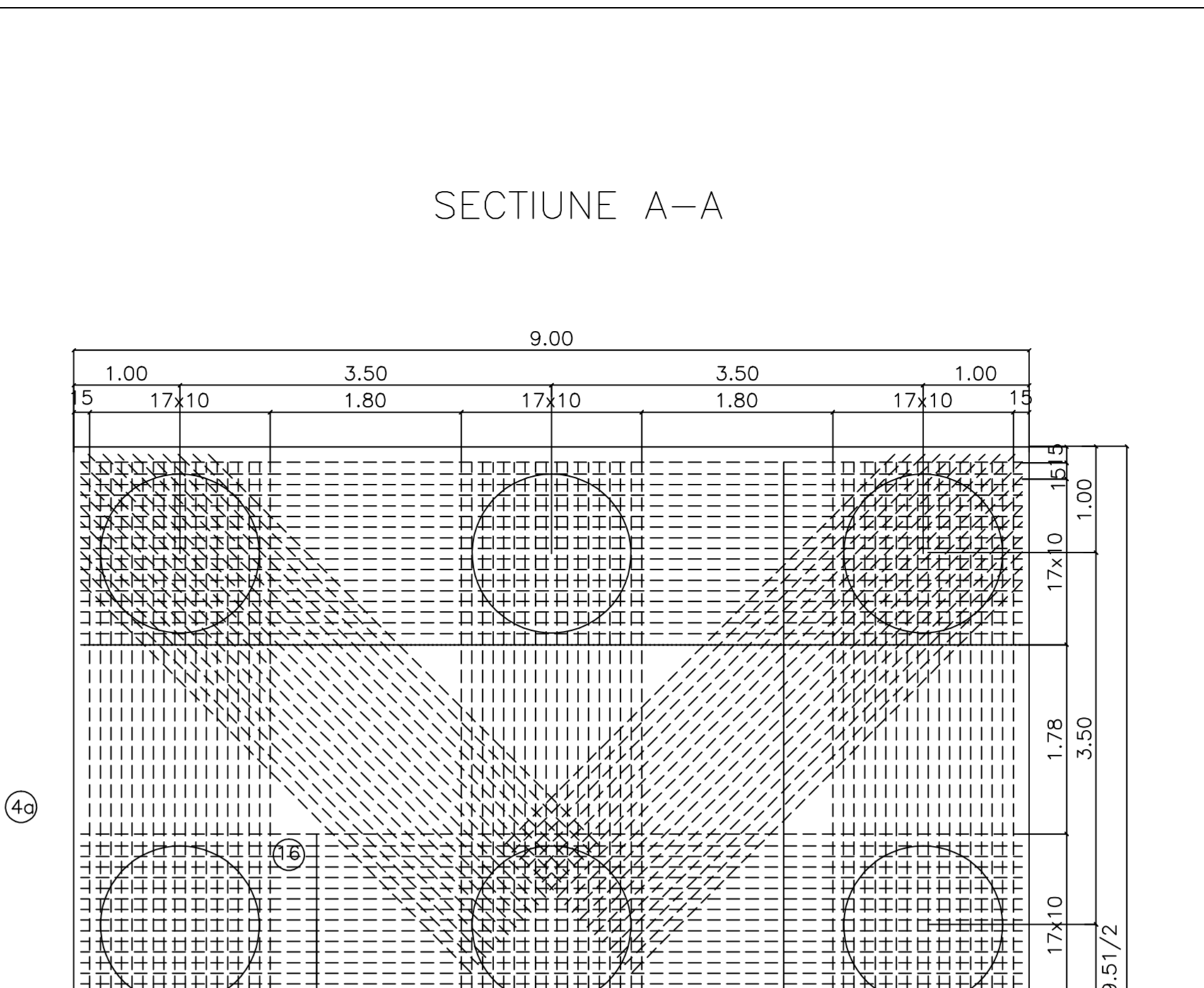

DETALIUL "a"
 INADIREA BARELOR DIN OTEL PC 52
 PRIN SUDARE MANUALA CU ARC ELECTRIC
 Sc. 1:5

Se interzice copierea, difuzarea, imprumutarea sau utilizarea in alte scopuri, fara permisiunea Arax Lider Company ca proprietar al desenului. This drawing is forbidden to be copied, lent or used in other purposes than those previously approved by Arax Lider Company as its owner.

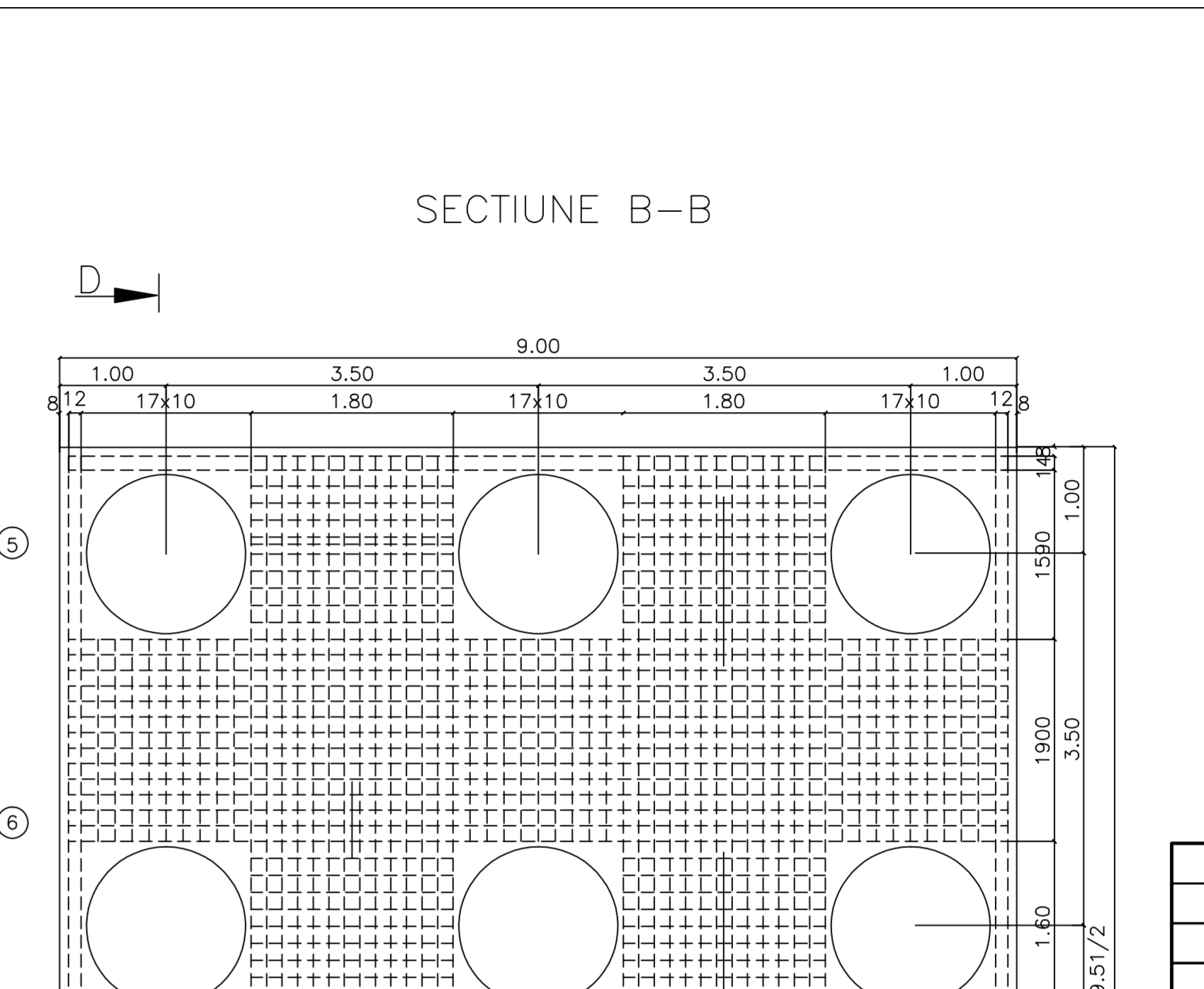

DETALIUL "b"
 INADIREA BARELOR DIN OTEL PC 52
 PRIN SUDARE MANUALA CU ARC ELECTRIC
 Sc. 1:5

Inadire prin suprapunere, cusatura pe ambele parti cu cusatura de racordare la barele necoaxiale ø>20, conf. C28/83.

MASURATOAREA OTELULUI BETON NECESAR PENTRU ARMAREA RADIERULUI

Marca	Diametru	Lung./buc.[m]	Nr.buc.	S255 ø12	S335 ø12	ø16	S345 ø20	ø25	S335 ø32
1	32	12.00	36						432
1a	25	11.65	72					838.80	
2	25	11.60	74					858.40	
3	25	2.25	108					243.00	
4	32	11.40	36						410.4
5	25	11.20	72					806.40	
6	25	11.20	36					403.20	
7	16	11.90	92			1094.80			
7a	16	5.75	48			284.50			
8	16	9.45	194			1833.30			
9	16	9.95	60			597.00			
10	16	9.10	30			273.00			
11	16	2.65	248			657.20			
12	12	3.65	10		36.50				
13	12	5.95	10		59.50				
13a	12	11.60	10		115.00				
14	12	26.00	18	468.00					
15	20	8.55	300			2565.00			
16	32	8.90	72					640.80	
Lungimi totale pe diametre (m)				468.00	211.00	4719.8	2565	3453.55	1483.20
Masa pe metru liniar (kg/m)				0.888	1.578	8.31	2.470	3.853	2.470
Masa pe diametre (kg)				415.60	187.40	7447.90	6335.60	13306.60	9363.50
Masa pe tip otel (kg)				415.60	187.40	27090.10		9363.50	
Masa totala pt un radier pila 5 (kg)						37056.60			
Spor				5%		1852.83			
Total Radier Pila 5						39.000Kg			

D					
C					
B					
A					
Indice	Data	Modificari	Proiectant	Proiectant	Proiectant
Indice	Data	Modificari	Proiectant	Proiectant	Proiectant

GUVERNUL ROMANIEI
ROMANIAN GOVERNMENT

PROIECT FINANȚAT DE UNIUNEA EUROPEA
EUROPEAN UNION FINANCED PROJECT

CFR
C.N.C.F. "C.F.R." - S.A.

CLIENT / CLIENT
ITALFER
GRUPPO FERROVIE DELLO STATO
Scott Wilson
Joint Venture leader
TECNIC
Consulting Engineers

CONSULTANT / CONSULTANT

Approbat	Proiect manager	R. Lizza	Data	Semnatura
Verificat	Coordinator Section 1	C. Gambelli		
Verificat	Expert Chief	V. Kalkdromitis		
Verificat	Checking Expert			

SUBCONTRACTANT / SUBCONTRACTOR

Approbat	Responsabil Subcontractant	A.Stanidu - Dinulescu	08.2012	Semnatura
Verificat	Subcontractant Responsible			
Intocmit	Proiectant	Mihail Ady Nicolae	08.2012	
Elaborat	Designer			

Reabilitarea liniei de cale ferata Braşov - Simeria, parte componentă a coridorului IV Pan European, pentru circulaţia trenurilor cu viteză maximă de 160 km/h, Tronsoanel : Braşov - Sighişoara
 Rehabilitation of the railway line Braşov - Simeria, component Part of the IV Pan-European Corridor, for the trains circulation with maximum speed of 160 km/h, Section : Braşov - Sighişoara

Project/Project
2004/R018/PFA003
Faza / Phase:
D.E. / E.D.

Denumire desen / Drawing Title : Stația Racos
 Viaduct Km 220+762.028 - D=2X55.00m+80.00m+55.00m+11.70m+2x18.00m
 Plan armare radier pila 5
 Bridge Km 220+762.028 - D=2X55.00m+80.00m+55.00m+11.70m+2x18.00m
 Plan for raft reinforcement pier 5

Codificare / Codification System

EA51	01	E	11	BC	PV	02	1	2	028	0
------	----	---	----	----	----	----	---	---	-----	---

Scale / Scale: 1:50
 LOT / LOT: 028
 Nr. / No: 01/01