

TIMISOARA

CENAD

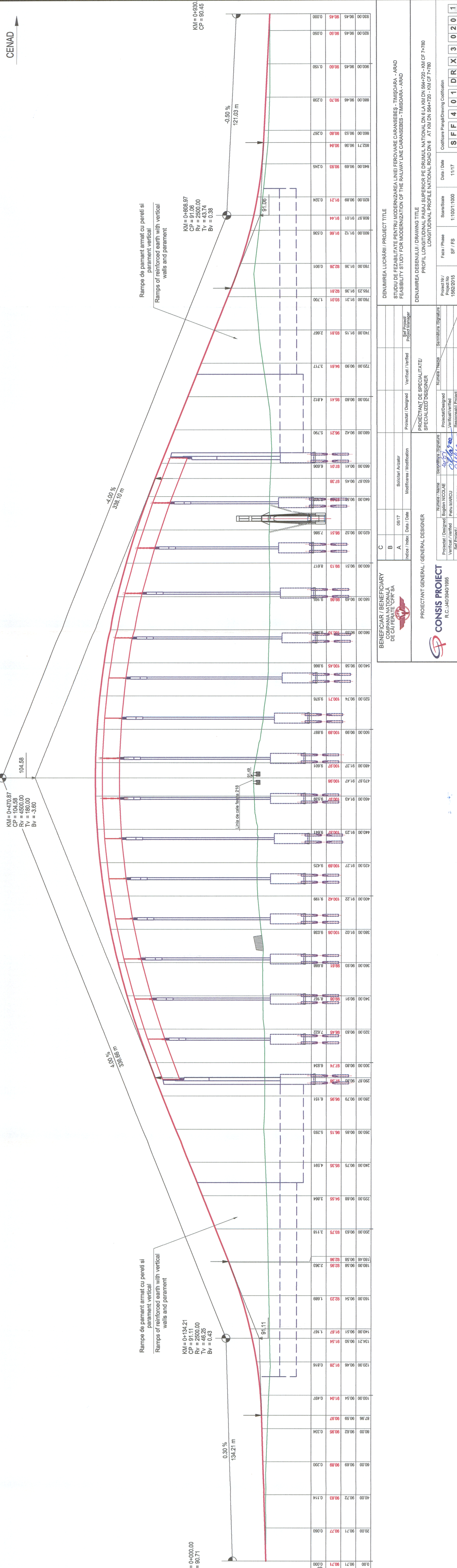

KM = 0+470.87
 CP = 104.58
 Rv = 4500.00
 Tv = 180.00
 Bv = -3.60

KM = 0+000.00
 CP = 90.71

KM = 0+134.21
 CP = 91.11
 Rv = 2500.00
 Tv = 46.25
 Bv = 0.43

KM = 0+808.97
 CP = 91.06
 Rv = 2500.00
 Tv = 43.74
 Bv = 0.38

KM = 0+930.00
 CP = 90.45

4.00 %
 338.10 m

1.00 %
 338.99 m

0.30 %
 134.21 m

-0.50 %
 121.03 m

88.0 m Niv. Ref.

Kilometraj / Chainage	Cote proiectate / Designed Level	Cote existente / Existing Level	Diferente in ax / Level differences
0+00	90.71	90.71	0.000
20+00	90.71	90.77	0.060
40+00	90.72	90.83	0.114
60+00	90.69	90.88	0.200
80+00	90.62	90.96	0.334
87+96	90.59	90.97	
100+00	90.54	91.04	0.497
120+00	90.46	91.28	0.816
134+21	90.50	91.54	
140+00	90.61	91.67	1.167
160+00	90.54	92.23	1.689
180+00	90.58	92.95	2.369
180+46	90.58	92.96	
200+00	90.63	93.74	3.118
220+00	90.68	94.56	3.884
240+00	90.75	95.36	4.591
260+00	90.85	96.15	5.293
280+00	90.79	96.95	6.151
290+87	90.80	97.38	
300+00	90.80	97.74	6.934
320+00	90.83	98.45	7.622
340+00	90.91	99.08	8.167
360+00	90.93	99.61	8.688
380+00	91.02	100.06	9.038
400+00	91.22	100.42	9.199
420+00	91.27	100.69	9.425
440+00	91.23	100.87	9.641
460+00	91.43	100.97	9.539
470+87	91.47	100.98	
480+00	91.37	100.97	9.601
500+00	90.99	100.89	9.897
520+00	90.74	100.71	9.976
540+00	90.58	100.45	9.866
560+00	90.35	100.19	9.843
580+00	90.48	99.66	9.185
600+00	90.51	99.13	8.617
620+00	90.52	98.57	7.986
640+00	90.50	97.96	7.460
650+87	90.45	97.38	
660+00	90.41	97.01	6.606
680+00	90.42	96.21	5.790
700+00	90.60	95.41	4.812
720+00	90.90	94.61	3.717
740+00	91.15	93.81	2.687
760+00	91.31	93.01	1.700
765+23	91.38	92.81	
780+00	91.56	92.28	0.901
800+00	91.12	91.66	0.536
806+97	91.01	91.44	
820+00	90.89	91.21	0.324
840+00	90.69	90.93	0.245
852+71	90.56	90.84	
860+00	90.53	90.80	0.267
880+00	90.66	90.70	0.238
900+00	90.65	90.60	0.150
920+00	90.65	90.50	0.050
930+00	90.45	90.45	0.000

BENEFICIAR / BENEFICIARY
 COMPANIA NATIONALA DE CALFERATE "CFR" SA

PROIECTANT GENERAL / GENERAL DESIGNER
 CONSIIS PROJECT
 R.C.:140/3940/1985

PROIECTANT DE SPECIALITATE / SPECIALIZED DESIGNER

DENUMIREA LUCRĂRII / PROJECT TITLE
 STUDIU DE FEZABILITATE PENTRU MODERNIZAREA LINEIEI FEROVIARE CARANSEBES - TIMIȘOARA - ARAD
 FEASIBILITY STUDY FOR MODERNIZATION OF THE RAILWAY LINE CARANSEBES - TIMIȘOARA - ARAD

DENUMIREA DESENULUI / DRAWING TITLE
 PROFIL LONGITUDINAL PASAJ SUPERIOR PE DRUMUL NATIONAL DN 6 LA KM DN 564+720 - KM CF 7+780
 LONGITUDINAL PROFILE NATIONAL ROAD DN 6 AT KM DN 564+720 - KM CF 7+780

Index / Index	Date / Date	Modificari / Modification	Solicitant / Avizator	Verificat / Verified	Self Project / Project Manager
A	08/17				
B					
C					

Projectat / Designed
 Verificat / Verified
 Semnatura / Signature
 Numele / Name
 Bogdan NICOLAE
 Peiu MARCU
 Catalin SERBAN

Project Nr / Drawing No
 15822015

Faza / Phase
 SF / FS

Scara / Scale
 1:100/1:1000

Data / Date
 11/17

Codificare / Drawing Codification
S F F 4 0 1 D R X 3 0 2 0 1