

TIMISOARA

SANNICOLAU MARE

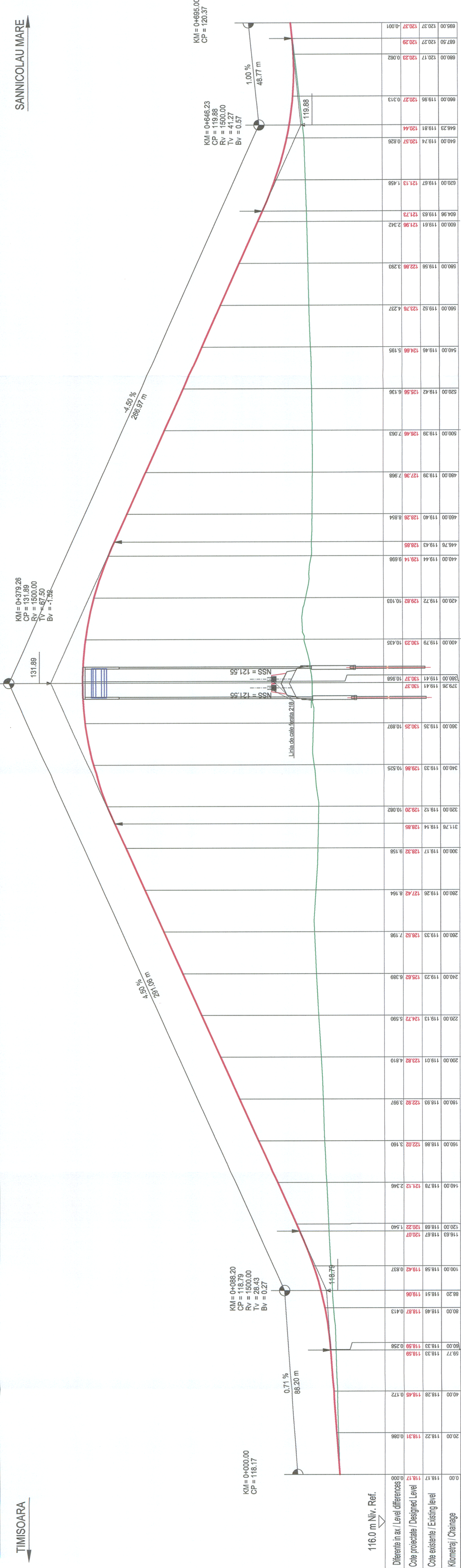

116.0 m Niv. Ref.

Diferente in ax / Level differences	116.17	118.17	118.17	0.000
Cote proiectate / Designed Level	118.17	118.31	118.31	0.086
Cote existente / Existing level	118.33	118.59	118.59	0.258
Kilometraj / Chainage	59.77	118.33	118.59	0.258
	40.00	118.28	118.45	0.172
	120.00	118.67	120.07	1.540
	140.00	118.78	121.12	2.346
	160.00	118.86	122.02	3.160
	180.00	118.93	122.92	3.997
	200.00	119.01	123.82	4.810
	220.00	119.13	124.72	5.590
	240.00	119.23	125.62	6.399
	260.00	119.33	126.52	7.198
	280.00	119.26	127.42	8.164
	300.00	119.17	128.32	9.158
	311.76	119.14	128.85	
	320.00	119.12	129.20	10.082
	340.00	119.33	129.86	10.525
	360.00	119.35	130.25	10.897
	379.26	119.41	130.37	10.958
	390.00	119.41	130.37	10.958
	400.00	119.79	130.23	10.435
	420.00	119.72	129.82	10.103
	440.00	119.44	129.14	9.698
	446.76	119.43	128.85	
	460.00	119.40	128.28	8.854
	480.00	119.39	127.36	7.968
	500.00	119.39	126.46	7.053
	520.00	119.42	125.56	6.136
	540.00	119.46	124.66	5.195
	560.00	119.52	123.76	4.237
	580.00	119.56	122.86	3.293
	600.00	119.61	121.96	2.342
	604.96	119.63	121.73	
	620.00	119.67	121.13	1.458
	640.00	119.74	120.57	0.626
	646.23	119.81	120.44	
	660.00	119.95	120.27	0.313
	680.00	120.17	120.23	0.062
	687.50	120.27	120.29	
	695.00	120.37	120.37	-0.001

KM = 0+379.26
CP = 131.89
RV = 1500.00
TV = 67.50
BV = -1.52

KM = 0+088.20
CP = 118.79
RV = 1500.00
TV = 28.43
BV = 0.27

KM = 0+646.23
CP = 119.88
RV = 1500.00
TV = 41.27
BV = 0.57

KM = 0+695.00
CP = 120.37

BENEFICIAR / BENEFICIARY COMPANIA NATIONALA DE CAI FERATE "CFR" SA		PROIECTANT GENERAL / GENERAL DESIGNER PROIECTANT DE SPECIALITATE / SPECIALIZED DESIGNER	
Indice / Index A B C	Data / Date 08/17	Modificarea / Modification 10.103	Semnatura / Signature Bogdan NICOLAE
Proiectat / Designed Verificat / Verified Semnatura / Signature Bogdan NICOLAE	Proiectat / Designed Verificat / Verified Semnatura / Signature Catalin SERBAN	Proiectat / Designed Verificat / Verified Semnatura / Signature Catalin SERBAN	Proiectat / Designed Verificat / Verified Semnatura / Signature Catalin SERBAN
Denumirea Lucrării / Project Title STUDIU DE FEZABILITATE PENTRU MODERNIZAREA LINIEI FEROVIARE CARANSEBES - TIMISOARA - ARAD FEASIBILITY STUDY FOR MODERNIZATION OF THE RAILWAY LINE CARANSEBES - TIMISOARA - ARAD		Denumirea Desenului / Drawing Title PROFIL LONGITUDINAL DEVIERE DRUM DC39 SI PASAJ SUPERIOR PE DJ692 KM CF PR. 18+729 LONGITUDINAL PROFILE DIVERSION ROAD DC39 AND OVERPASS DJ692 KM CF PR. 18+729	
Project Nr / Project No 1562/2015	Scara / Scale 1:100/1:1000	Faza / Phase SF / FS	Data / Date 08/17
Codificarea Planșii / Drawing Codification S F F 4 0 3 D R X 3 0 2 7 1			

