

SECTIUNE/SECTION A-A

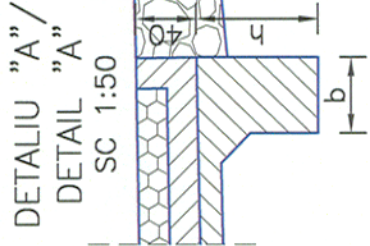

VEDERE PLANA/PLAN VIEW C-C

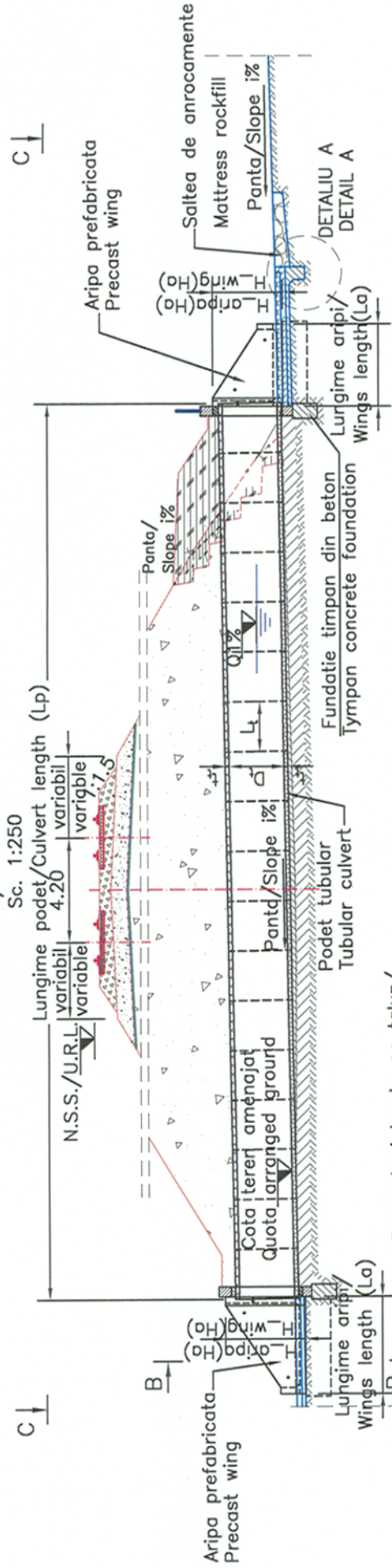
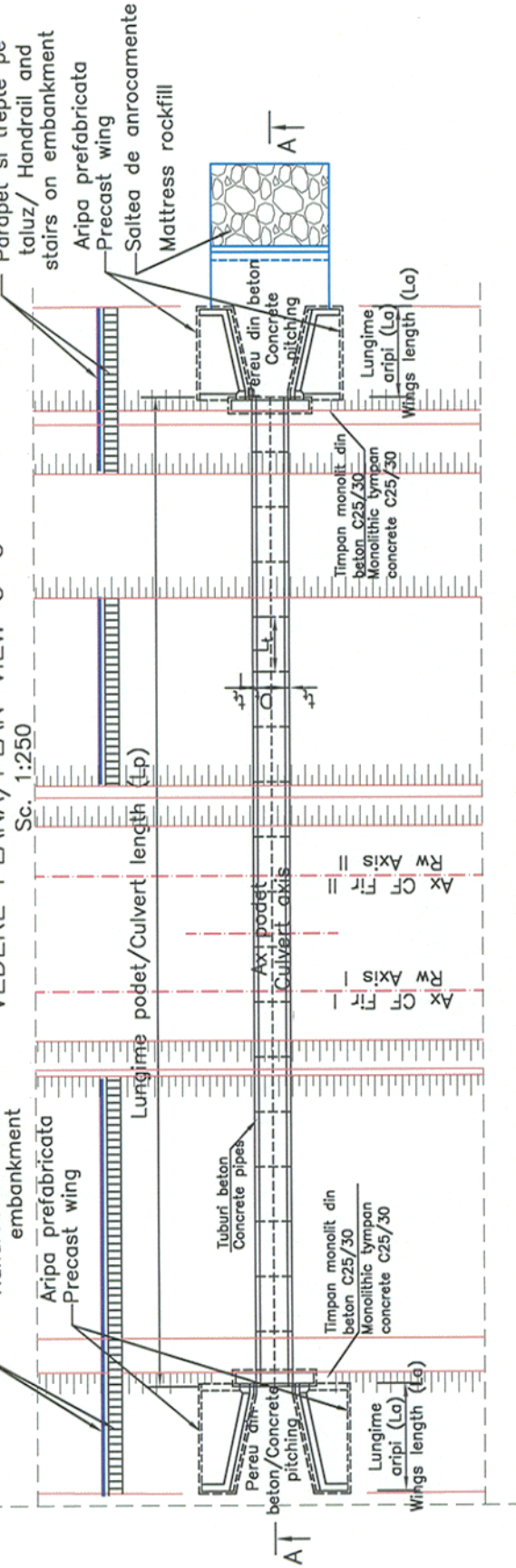

SECTIUNE/SECTION B-B

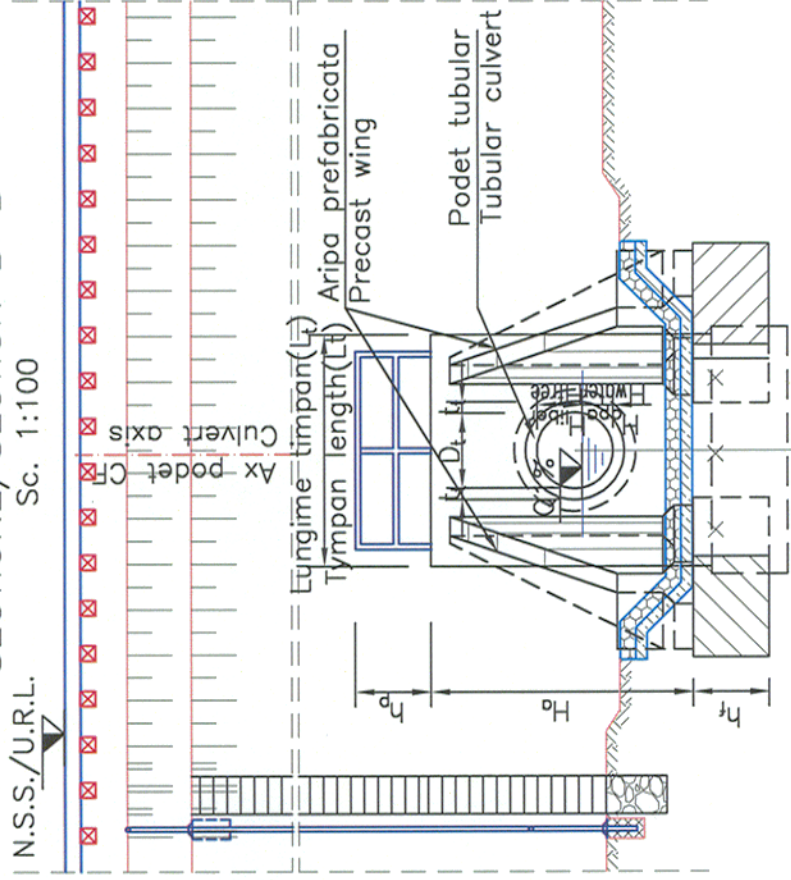

Se aplica solutia proiectata - Podet tubular 0.80-1.00m
The designed solution is applied-tubular culvert 0.80-1.00m

Linia cf/ Railway line	Pozitia kilometrica proiectata/ Designed km position	Inaltime libera in podet / free height in culvert (m)	Lungime pod/ Culvert length (m)
LINIA CF/ RAILWAY LINE 218 TIMISOARA- ARAD	42+000	1.00	28.00
LINIA CF/ RAILWAY LINE 218A ARADUL NOU-ARAD	6+254	0.80	18.00
LINIA CF/ RAILWAY LINE 123 LUGOJ- GATIA	83+362	0.80	8.00

BENEFICIAR / BENEFICIARY
COMPANIA NATIONALA
DE CAI FERATE "CFR" SA



PROIECTANT GENERAL / GENERAL DESIGNER

CONSIIS PROJECT
R.C.:J40/3940/1995

DENUMIREA LUCRĂRII / PROJECT TITLE

STUDIU DE FEZABILITATE PENTRU MODERNIZAREA LINEI FEROVIARE CARANSEBES - TIMIȘOARA - ARAD
FEASIBILITY STUDY FOR MODERNIZATION OF THE RAILWAY LINE CARANSEBES - TIMIȘOARA - ARAD

DENUMIREA DESENULUI / DRAWING TITLE

Podet tubular D=0.80m-1.00m
Tubular culvert D=0.80m-1.00m

Index / Index	Date / Date	Modificarea / Modification	Verificat / Verified	Proiectat / Designed	Semnatura / Signature
C					
B					
A					

Projectant / Designer	Projectant / Designer	Projectant / Designer
Proiectat / Designed ing. Nicoleta FLORIAN	Verificat / Verified ing. Bogdan SANDU	Semnatura / Signature [Signature]
Set Proiect / Project Manager ing. Catalin SERBAN	Responsabil Proiect / Project Responsible	

Proiect Nr./
Project No
1562/2015

Faza / Phase
SF / FS

Scara/Scale
1:250/
1:100/
1:50

Data / Date
06/17

Codificare Planșă/Drawing Codification
S F F 0 0 0 P D 2 5 0 0 7 0