

# STALPI, FUNDATII SI ANCORE POLES, FOUNDATIONS AND ANCHORS

STALP DE BETON SECP 6  
CONCRETE POLE SECP 6

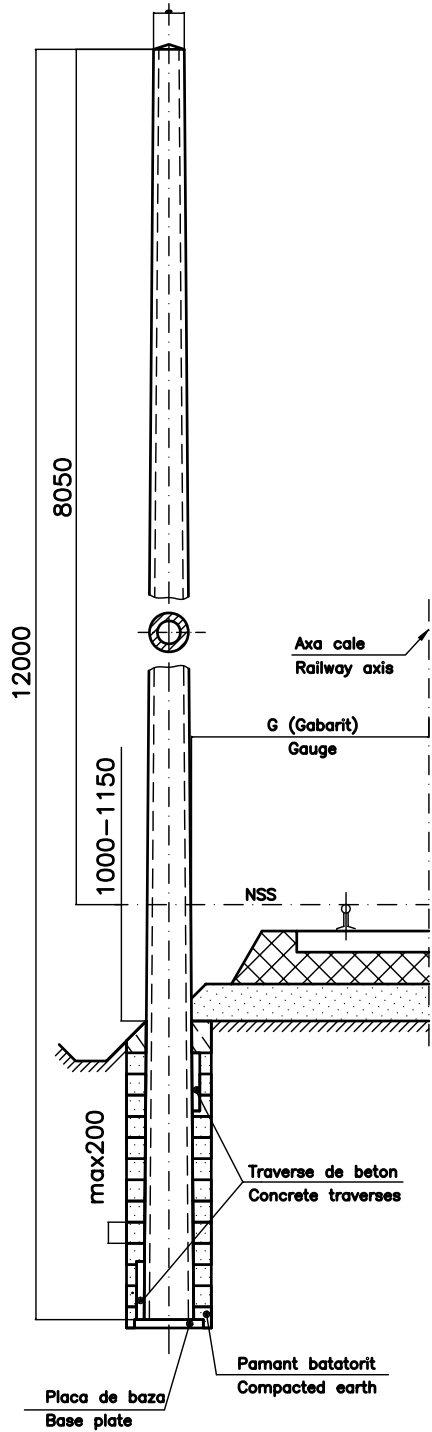

STALP METALIC MU 10-5/8,2  
METALLICAL POLE MU 10-5/8,2

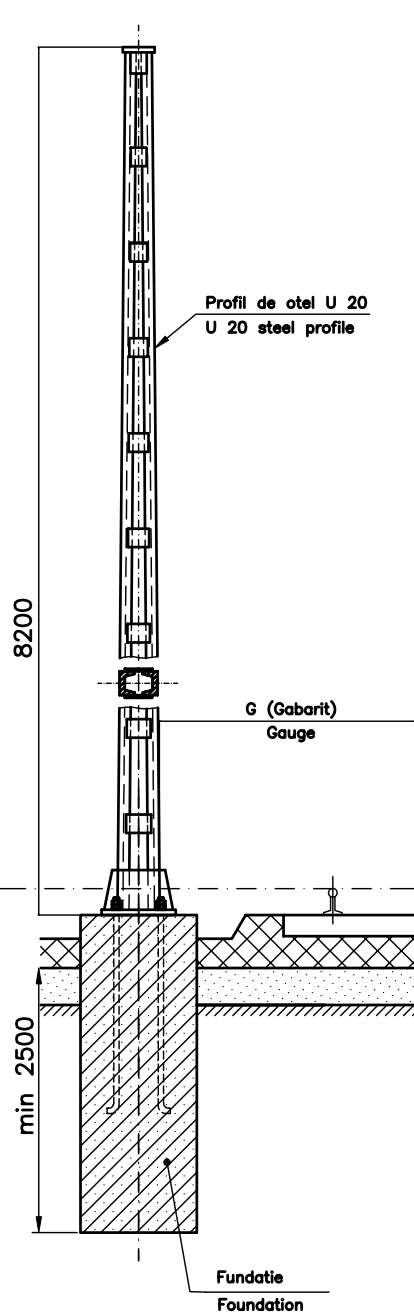

STALP METALIC PENTRU CONSOLA PESTE 2 CAI  
METALLICAL POLE FOR 2 RAILWAYS CANTILEVER

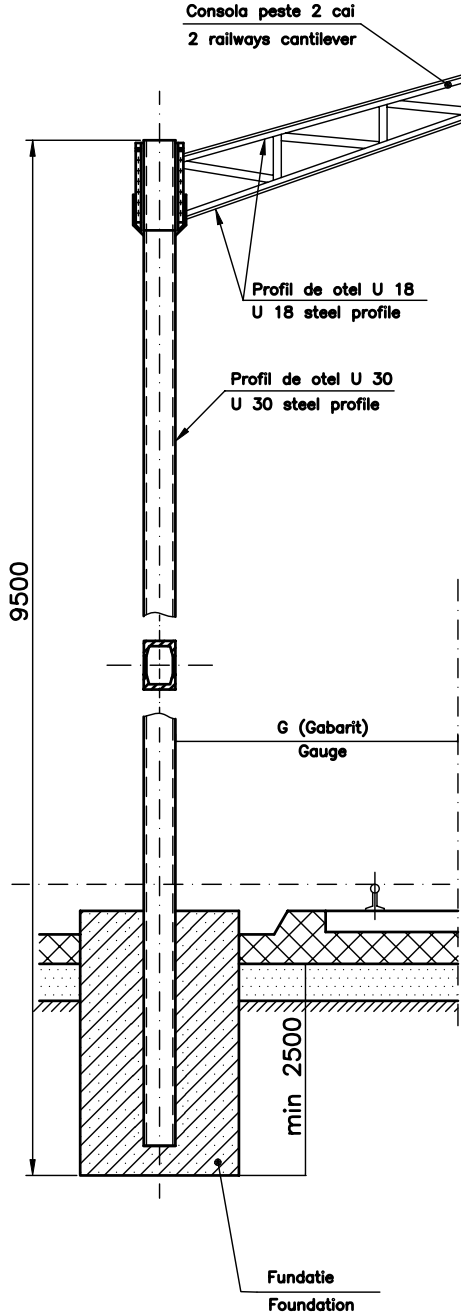

STALP METALIC H  
METALLICAL POLE H

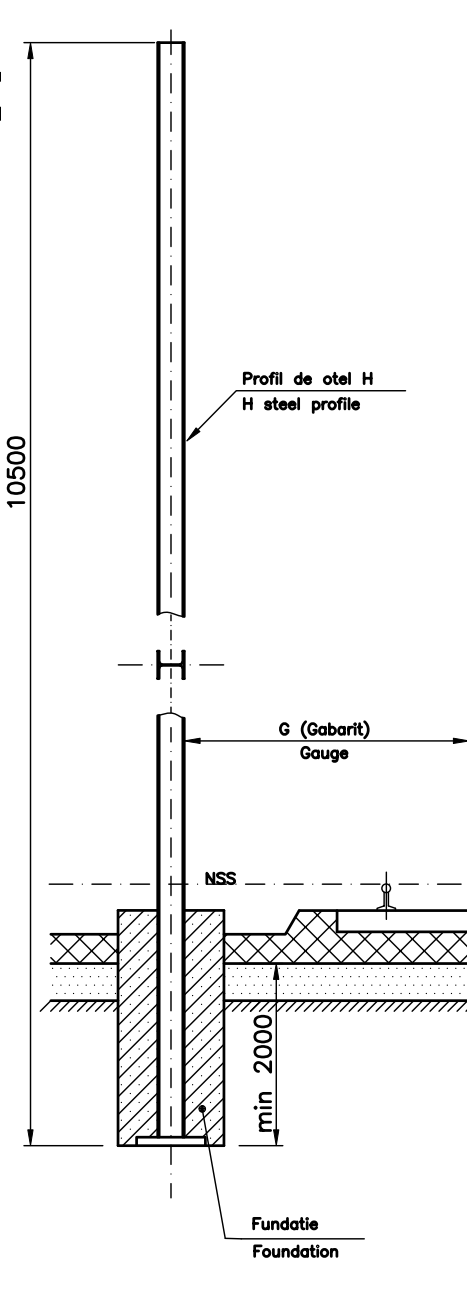

ANCORA LA NIVEL  
LEVEL ANCHOR

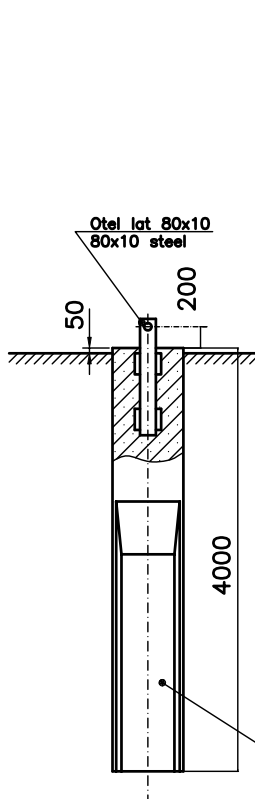

ANCORA SUPRAINALTATA  
SUPERELEVATED ANCHOR

