

Invelitoare tabla
Tin roof
Sipca 25x40mm
Stave 25x40mm
Membrana speciala PVC
Special PVC membrane
Astereala - scandura rasinoase
Roof deck softwood plank
Caprior
wood rafter

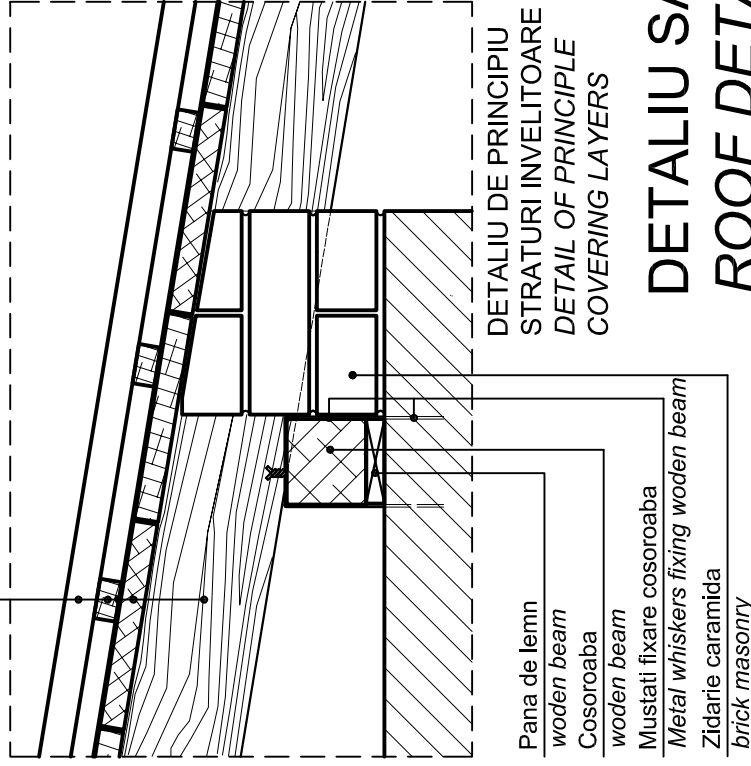

Invelitoare tabla
Tin roof
Membrana speciala PVC
Special PVC membrane
Sort de tabla zincata
Galvanized sheet
Agrata banda otel zincat
Staples galvanised steel tape
Astereala scandura rasinoase
Roof deck softwood plank
Caprior/wood rafter
Sipca 48x48mm/Stave48x48mm
Scandura faltuita/folding board
Sipca 22x42mm/Stave 22x42mm

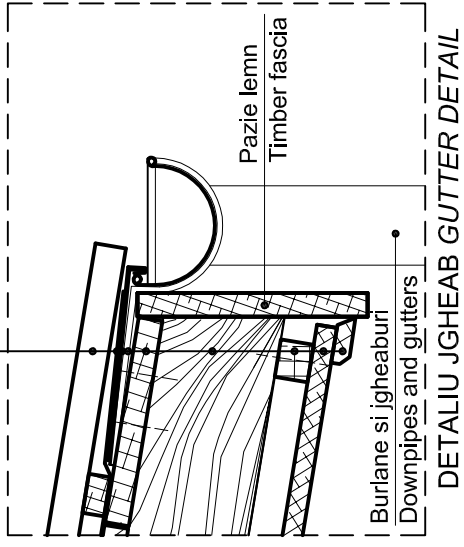

DETALIU SARPANTA SACEAC ROOF DETAIL SC 1:10

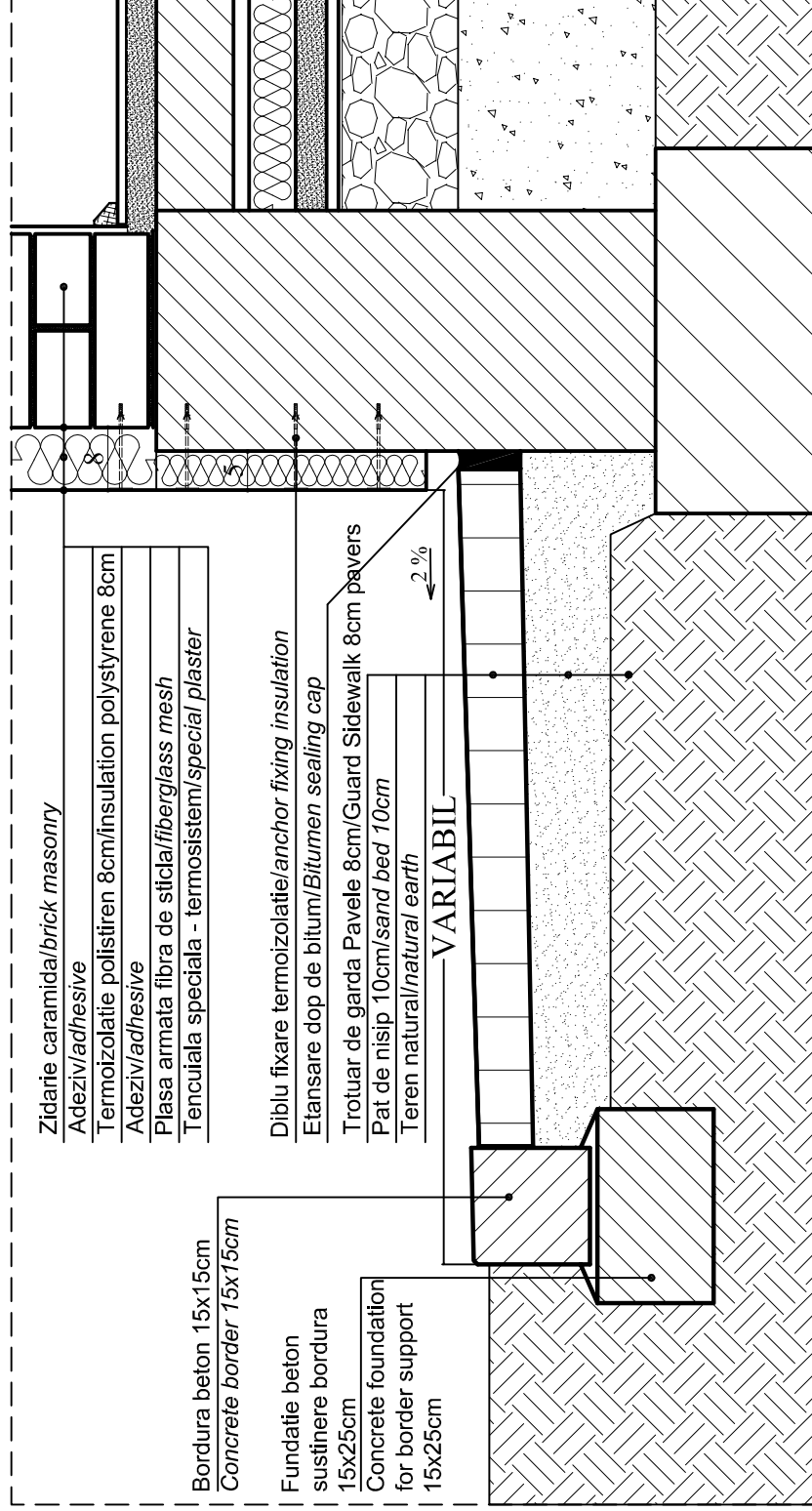

DETALIU TROTUAR DE GARDA GUARD SIDEWALK DETAIL SC 1:10

D							
C							
B							
A							



GUVERNUL ROMANIEI ROMANIAN GOVERNMENT
PROIECT FINANȚAT DE UNIUNEA EUROPEANĂ EUROPEAN UNION FINANCED PROJECT

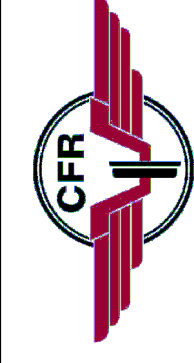

C.N.C.F. "C.F.R." - S.A.

CLIENT / CLIENT



CONSULTANT / CONSULTANT

Approbat Approved	Șef proiect Project manager	R. Liuzza	Data Date	Semnătură Signature
Approbat Approved	Coordonator Secțiune 1 Section 1 Coordinator	C. Gambelli	DEC. 2011	
Verificat Checked	Verificator Verifier	Giuseppe Fioravanti	DEC. 2011	

SUBCONTRACTANT / SUBCONTRACTOR

Approbat Approved	Responsabil Subconsultant Subconsultant Responsible	A. Stanciu - Dinulescu	Data Date	Semnătură Signature
Întocmit Elaborated	Proiectant Designer	Andrei MIU	DEC. 2011	

Reabilitarea liniei de cale ferata Brașov - Simeria, parte componentă a coridorului IV Pan European, pentru circulația trenurilor cu viteză maximă de 160 km/h,
Tronsonul : Brașov - Sighișoara
Rehabilitation of the railway line Brașov - Simeria, component Part of the IV Pan-European Corridor, for the trains circulation with maximum speed of 160 km/h,
Section : Brașov - Sighișoara

Proiect/Project
2004/RO/16/P/PA/003

Faza / Phase:
D.E. / E.D.

Denumire desen / Drawing Title :

CLADIRE CALATORI DETALII SARPANTA, TROTUAR
RAILWAY PASSENGER BUILDING ROOF & SIDEWALK DETAILS

Codificare / Codification System

Scara / Scale
1:10

Nr. / No
01 / 01

E A 5 1 0 1 E 0 0 B K C C 0 0 0 1 0 0 4 0