

# DETALIU CROMATICA FATADA - SC 1:20 CHROMATICS OF FACADE DETAIL - SC 1:20

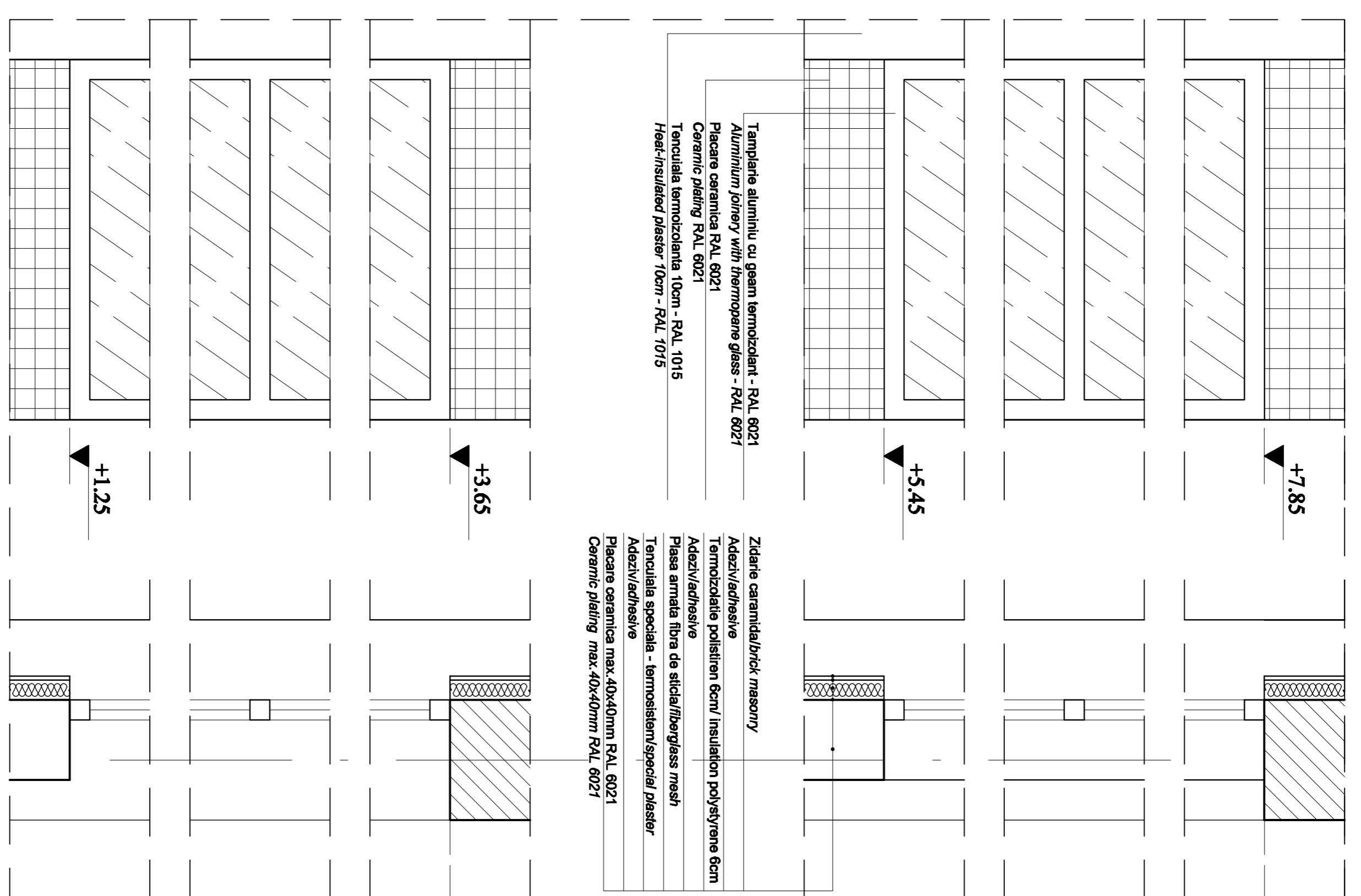

## DETALIU FINISARE FATADA A - A SC 1:10 FACADE FINISHING DETAIL A - A SC 1:10

## DETALIU CROMATICA FATADA - SC 1:20 CHROMATICS OF FACADE DETAIL - SC 1:20

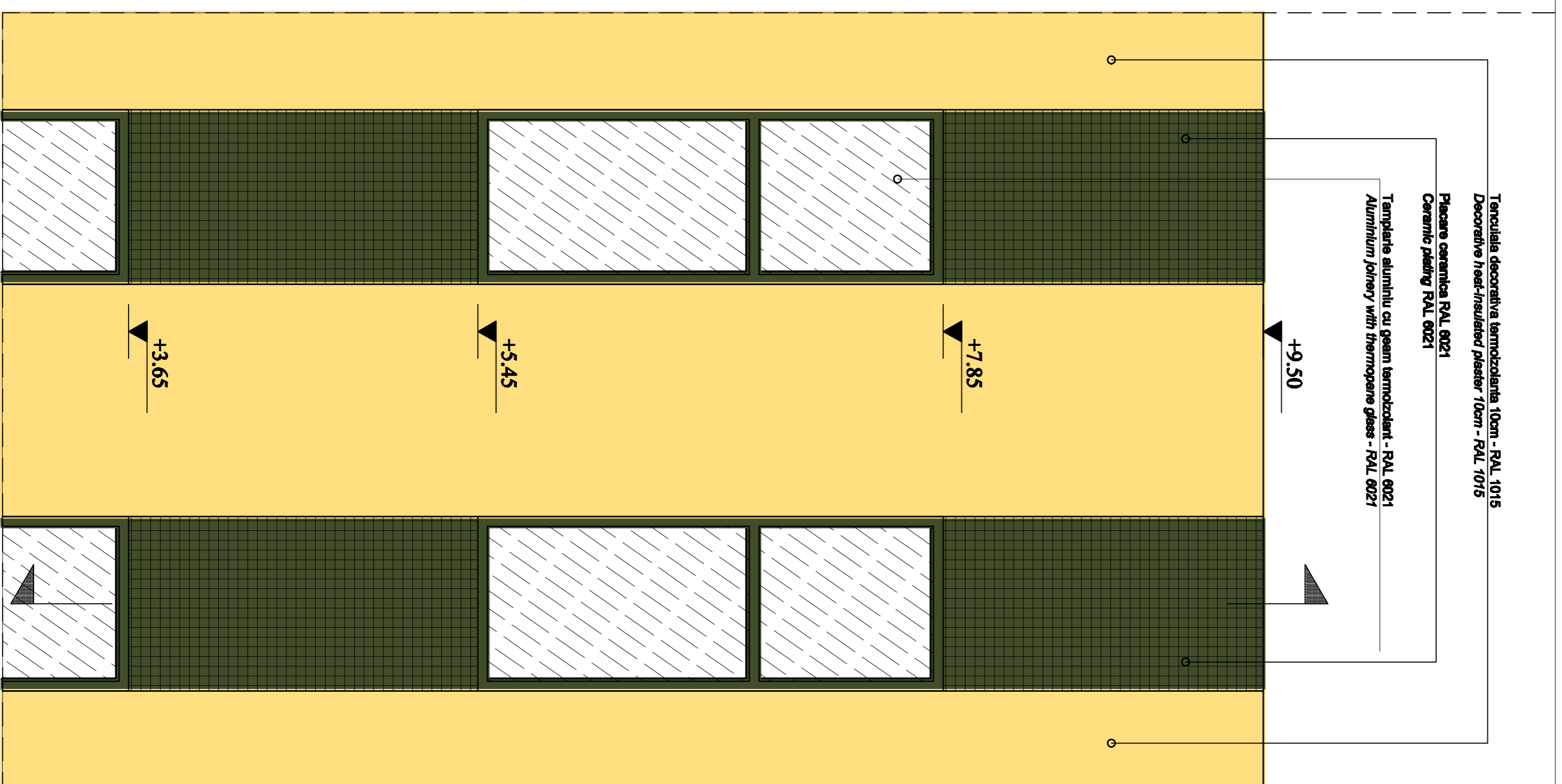
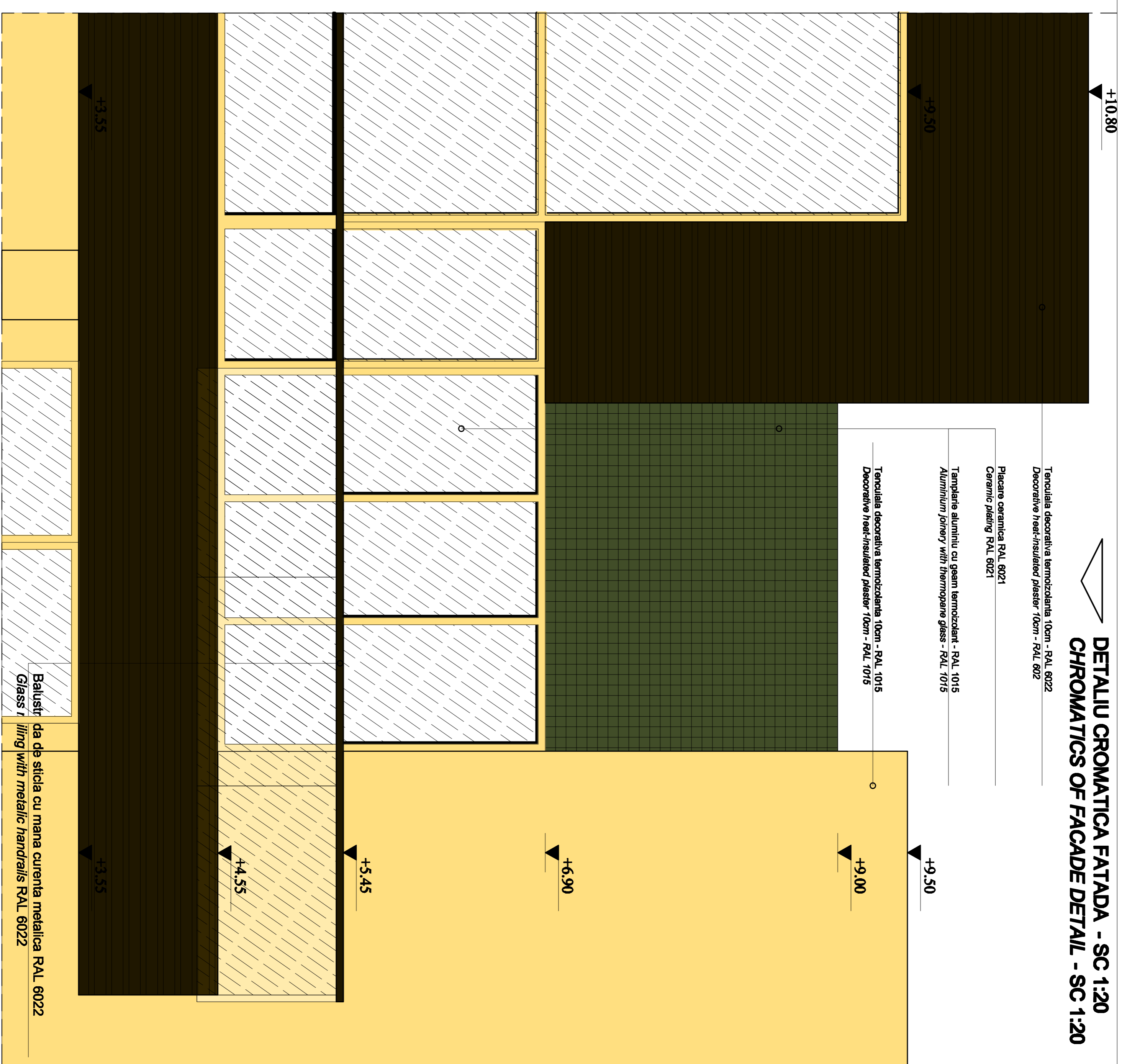
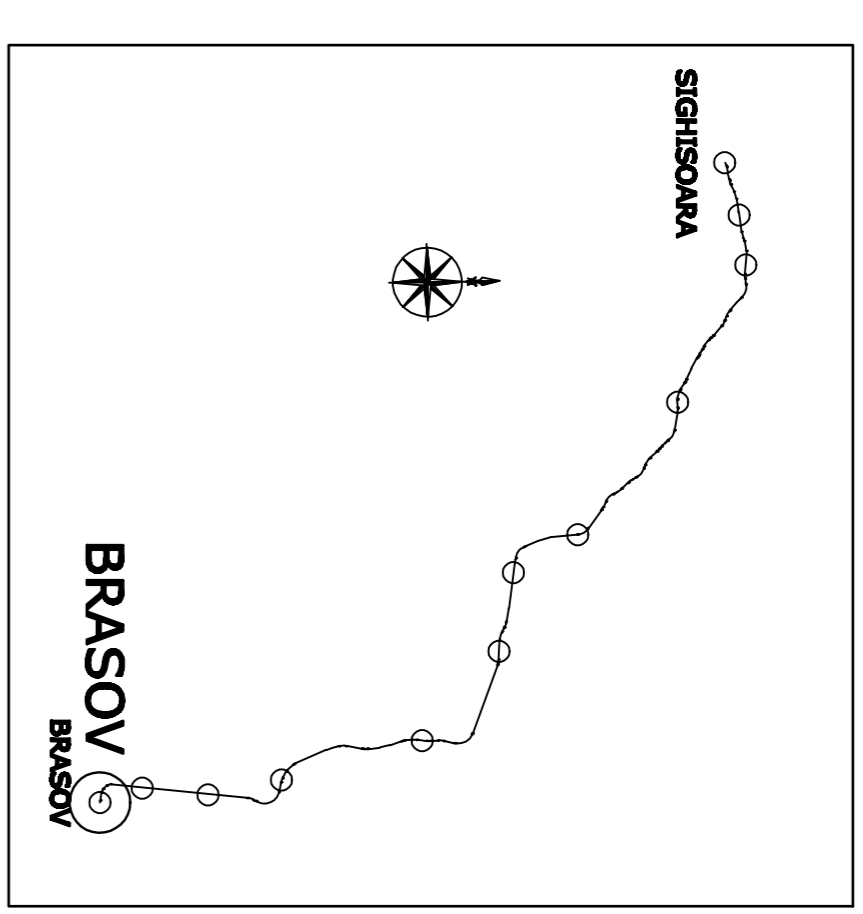

D	C	B	A
Indice	Titlu	Modificari/Revisiuni	Proiectant
			Approbat/Consultant
			Approbat/CFR
			Approbat/CFR

**GUVERNUL ROMANIEI** PROIECT FINANȚAT DE UNIUNEA EUROPEANĂ A  
**ROMANIAN GOVERNMENT** EUROPEAN UNION FINANCED PROJECT

**CLIENT / CLIENT**

**CFR**

**C.N.C.F. "C.F.R." - S.A.**

**CONSULTANT / CONSULTANT**

**TAUFER** PROIECTANT DEBUTA STIINTA  
SALA TERORUL DEBUTA

**SCOTT WILSON**

**OBERMEYER** PLANUL + SERVISUL SIMILAR  
Consulting Engineers

**TECNIC**

Approbat	Proiectant	Data	Signat
Approbat	R. Lizza	12.2011	[Signature]
Verificat	C. Gambell	12.2011	[Signature]
Verificat	Giuseppe Fioravanti	12.2011	[Signature]

**SUBCONTRACTANT / SUBCONTRACTOR**

Approbat	Proiectant	Data	Signat
Approbat	A. Serechi - Director	12.2011	[Signature]
Verificat	S. Stancu - Director	12.2011	[Signature]

Realizatiunea liniei de cale ferata Brasov - Sibiu, partea componenta a contractului IV Pan European, pentru circulatia trenurilor cu viteza maxima de 160 km/h, Tronsonul : Brasov - Sibiu, componenta Part of the IV Pan-European Corridor, for the train circulation with maximum speed of 160 km/h, Section : Brasov - Sibiu

**Project/Project**  
 2004/RO/IE/PA/003  
 Faza / Phase:  
 D.E. / E.D.

**STATA BRASOV CENTRU OPERATIONAL DE COMANDA -  
DETALIU FINISARE SI CROMATICA FATADE  
BRASOV RAILWAY STATION OPERATIONAL COMMAND CENTER -  
FINISHING DETAIL AND CHROMATICS OF FACADES**

Denumire desen / Drawing Title :  
 Sistem / System :  
 Scara / Scale : 1:20, 1:10  
 Nr. / No :  
 Data / Date :  
 Usc / Usc :  
 Nr. / No :  
 Data / Date :

**E A S I** | **0 1** | **E** | **0 1** | **B Z** | **C C** | **0 0** | **1** | **9** | **0 0 9** | **0**

841 x 1109 = 0.841P