

Demolare Cabina km 175+824 Ac=20,00mp
Cabin Demolition km 175+824 Ac=20,00sq

Demolare Peron L=15,30m/ l=1,75m
Platform Demolition L=15,30m/ l=1,75m

Demolare Peron L=15,10m/ l=1,95m
Platform Demolition L=15,10m/ l=1,95m

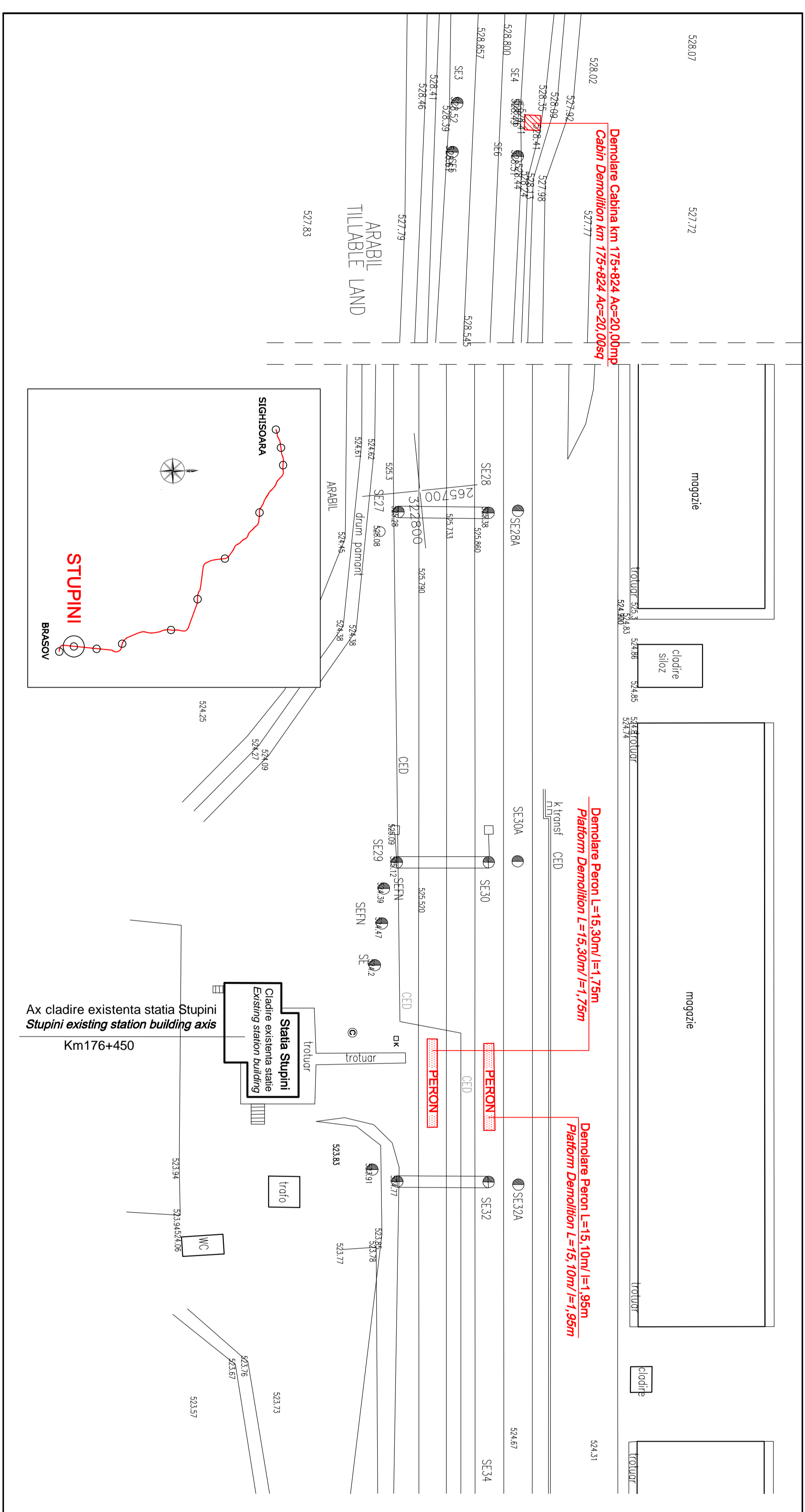

D				
C				
B				
A				
Indice	Data	Modificari	Proiectant	Approbat
Index	Date	Modification/Revision	Designer	Approved Consultant

GUVERNUL ROMANIEI **PROIECT FINANȚAT DE UNIUNEA EUROPEANĂ A EUROPEAN UNION FINANCED PROJECT**



C.N.C.F. "C.F.R." - S.A.

ITALFER **GRUPPO FERROVIE DELLO STATO**

SCOTT WILSON **Joint Venture leader**

OBERMAYER **PLANEN + BERATEN GmbH**

TECNIC **Consulting Engineers**

CONSULTANT / CONSULTANT		CONSULTANT / CONSULTANT	
Approbat	Self project	Approbat	R. Liuzza
Approved	Project manager	Approved	12. 2011
Approbat	Coordinator Sectione 1	Approbat	C. Gambelli
Approved	Section 1 Coordinator	Approved	12. 2011
Verificat	Verificator	Verificat	Giuseppe Fioravanti
Checked	Verifier	Checked	12. 2011

SUBCONTRACTANT / SUBCONTRACTOR		SUBCONTRACTANT / SUBCONTRACTOR	
Approbat	Responsabil Subcontractant	Approbat	A. Stanciu - Dinulescu
Approved	Subcontractant Responsible	Approved	12. 2011
Elaborat	Proiectant	Elaborat	Stefania Gheorghe
Elaborated	Designer	Elaborated	12. 2011

Reabilitarea liniei de cale ferata Brasov - Simeria, parte componenta a coridorului IV Pan European, pentru circulatia trenurilor cu viteza maxima de 160 km/h.
Tronsoanel : Brasov - Sighisoara
Rehabilitation of the railway line Brasov - Simeria, component Part of the IV Pan-European Corridor, for the trains circulation with maximum speed of 160 km/h.
Section : Brasov - Sighisoara

Plan de situatie Existenta + Demolari - Stajia Stupini
Stupini Station - Existing + Demolishing Layout Plan

Codificare / Codification System		Scara / Scale		Lot / LOT		Nr. / No	
E	A	5	1	0	1	C	0
C	0	3	A	8	C	0	0
1	0	1	0	0	1	0	0
0	2	1					

735x297 = 0.22