

LEGENDA PICTOGRAME SIGNS LEGEND

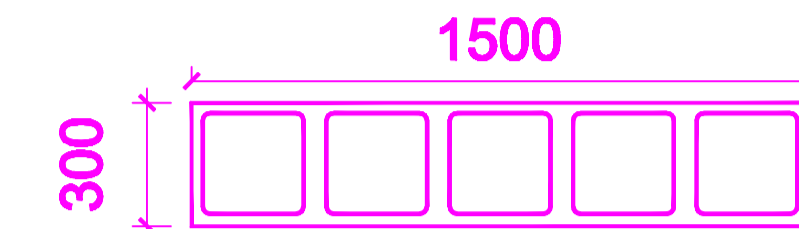

CASETA LUMINOASA MARE 1500 x 300 mm - FISA TEHNICA NR 11
LARGE LIGHT CASE 1500 x 300 mm - TECHNICAL SHEET NO 11

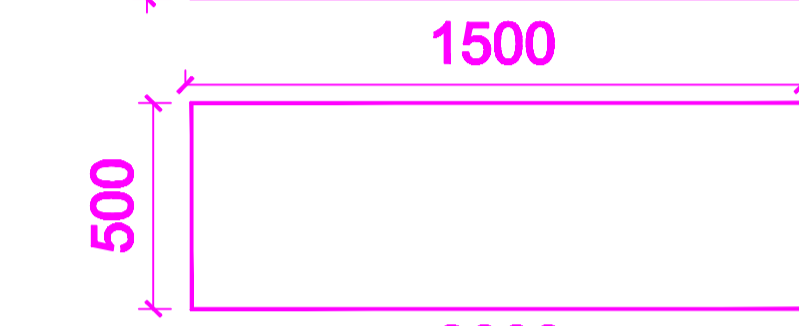

FIRMA DENUMIRE STATIE 1500 x 500 mm - FISA TEHNICA NR 14
LIGHT SIGNBOARD WITH THE STATION NAME 1500 x 500 mm - TECHNICAL SHEET NO 14

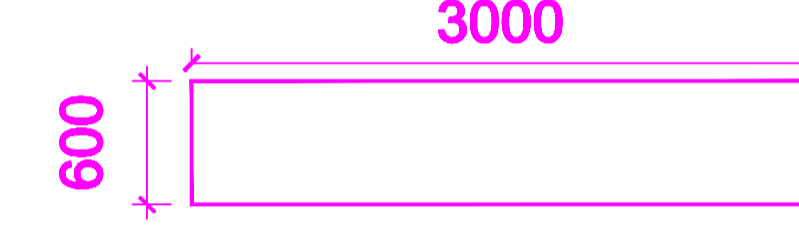

FIRMA DENUMIRE STATIE 3000 x 600 mm - FISA TEHNICA NR 15
LIGHT SIGNBOARD WITH THE STATION NAME 3000 x 1000 mm - TECHNICAL SHEET NO 15

NOTA:
H liber sub caseta rezultat in urma montarii nu trebuie sa fie mai mic de 2.30 m
free height under the looms must be over 2.30m after mounting them



Firma denumire statie pe capat de copertina
Light signboard with the station name on the canopy extremity

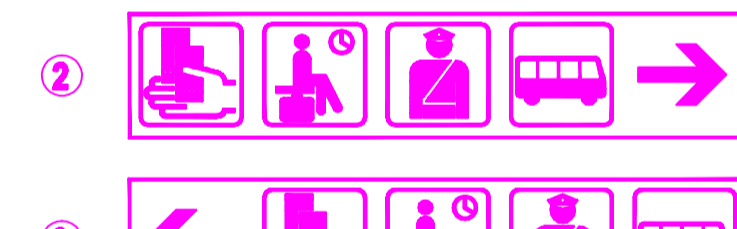

Caseta luminoasa mare
Large light case



Caseta luminoasa mare
Large light case



Firma denumire statie pe cladire
Light signboard with the station name on the building

LEGENDA DOTARI EQUIPMENTS LEGEND

5 Banci pentru calatori - FISA TEHNICA NR. 6
Benches for passengers - TECHNICAL SHEET NO 6

6 Cos de gunoi exterior - FISA TEHNICA NR.8
Outdoor garbage bin - TECHNICAL SHEET NO 8

LEGENDA LEGEND

⊗ Corp de iluminat
Lighting unit

⊥ Stalp metalic electrificare profil H
Metallic H pole

5				
4		4.75m		750m=Lu=775m
III		5.00m		915m=Lu=935m
II		5.00m		890m=Lu=890m
I		5.00m		890m=Lu=920m

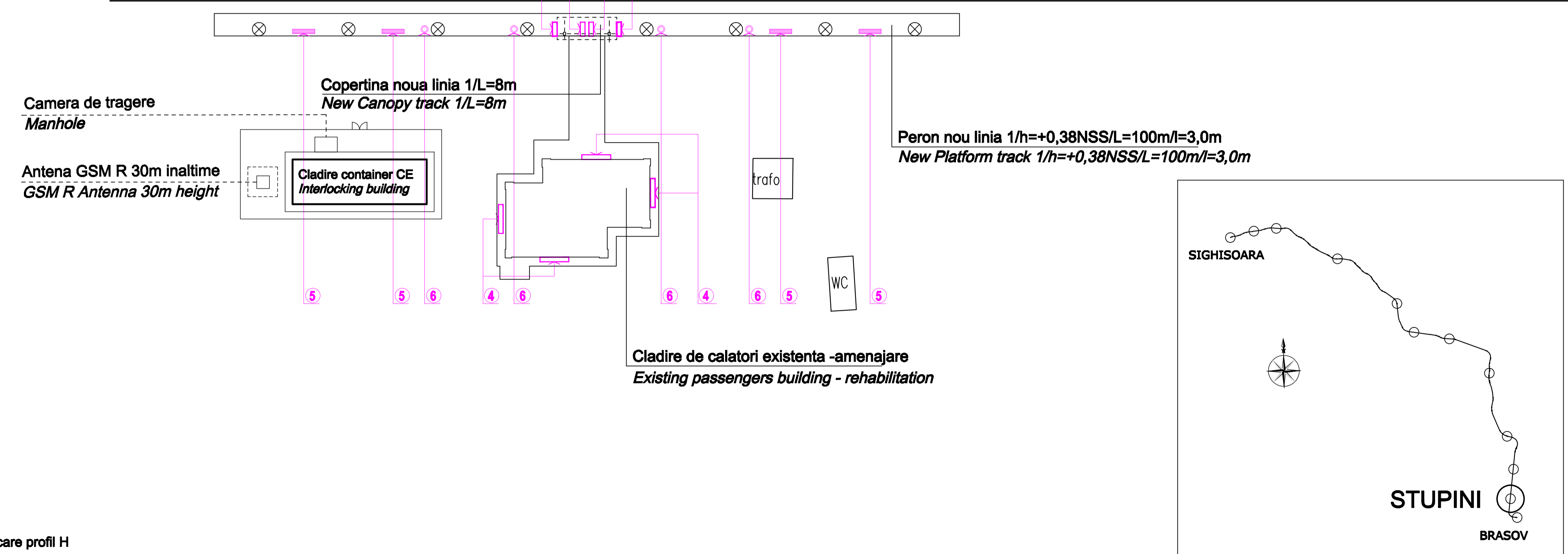

D					
C					
B					
A					
Indice Index	Data Date	Modificare Modification/Revision	Proiectant Designer	Aprobat Consultant Approved Consultant	Aprobat CFR Approved CFR



CONSULTANT / CONSULTANT			Data Date	Semnatura Signature
Aprobat Approved	Șef proiect Project manager	R. Liuzza	12.2011	[Signature]
Aprobat Approved	Coordonator Secțiune 1 Section 1 Coordinator	C. Gambelli	12.2011	[Signature]
Verificat Checked	Verificator Verifier	Giuseppe Fioravanti	12.2011	[Signature]

SUBCONTRACTANT / SUBCONTRACTOR			Data Date	Semnatura Signature
Aprobat Approved	Responsabil Subcontractant Subcontractant Responsible	A.Stanclu - Dinulescu	12.2011	[Signature]
Elaborat Elaborated	Proiectant Designer	Stefania Gheorghe	12.2011	[Signature]

Reabilitarea liniei de cale ferata Braşov - Simeria, parte componentă a coridorului IV Pan European, pentru circulația trenurilor cu viteză maximă de 160 km/h, Tronsoanel : Braşov - Sighişoara
Rehabilitation of the railway line Braşov - Simeria, component Part of the IV Pan-European Corridor, for the trains circulation with maximum speed of 160 km/h, Section : Braşov - Sighişoara

Proiect/Project 2004/RO/16/PPA/003
Faza / Phase: D.E. / E.D.

Denumire desen / Drawing Title :
Plan amplasare dotari si pictograme - Stația Stupini/
Stupini Station - Layout Plan for equipments and symbols

Codificare / Codification System	Scara / Scale 1:500	LOT / LOT	Nr. / No 01 / 01
E A 5 1 0 1 E 0 3 L 8 C C 0 0 3 2 0 0 9 1			