

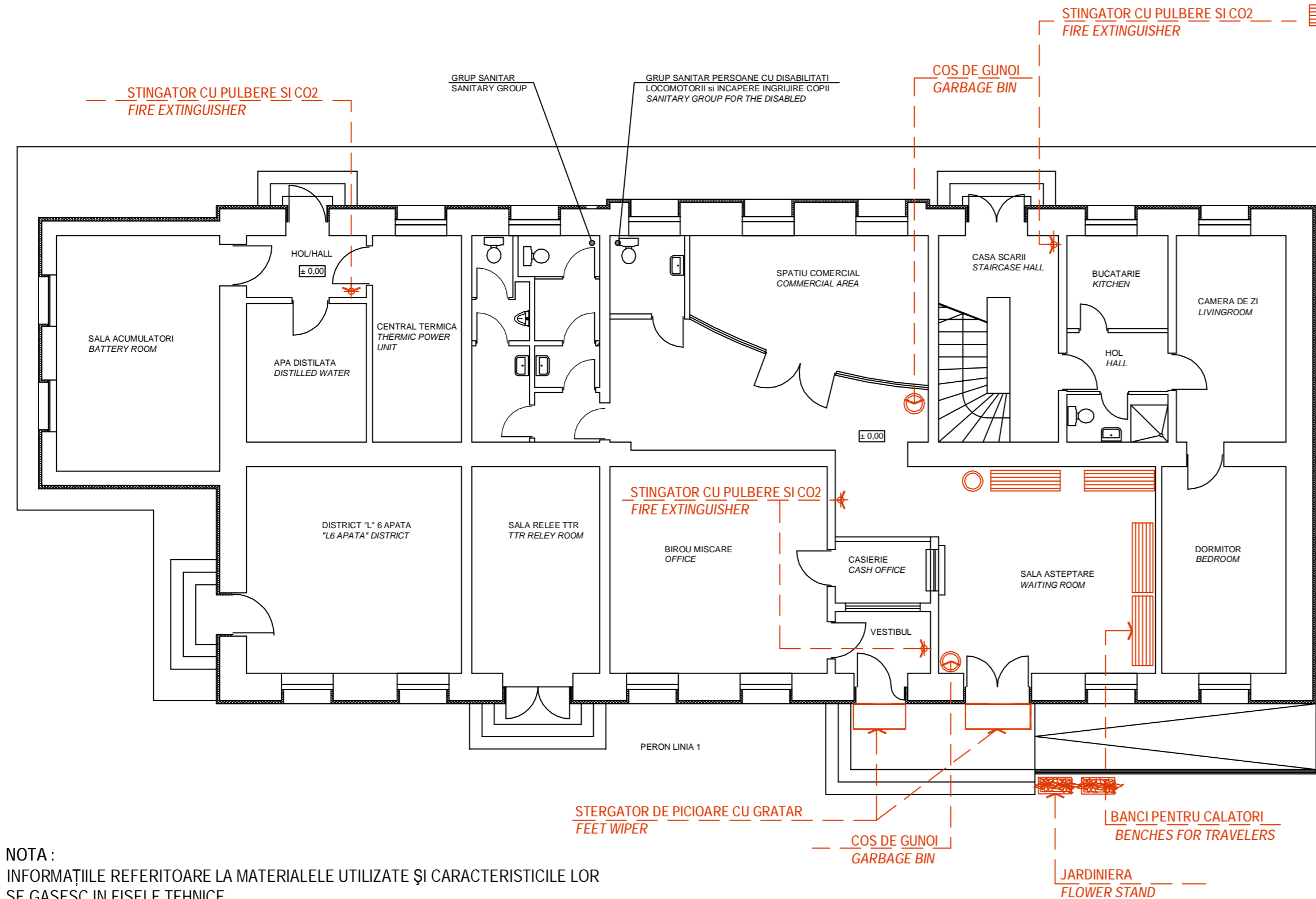





## LEGENDA / LEGEND



-  BANCI PENTRU CALATORI - FISA TEHNICA NR 6  
BENCHES FOR TRAVELERS - TECHNICAL SHEET NO 6
-  STERGATOR DE PICIOARE CU GRATAR - FISA TEHNICA NR 4  
FEET WIPER - TECHNICAL SHEET NO 4
-  COS DE GUNOI - FISA TEHNICA NR 8  
GARBAGE BIN - TECHNICAL SHEET NO 8
-  STINGATOR CU PULBERE SI CO2 - FISA TEHNICA NR 10  
FIRE EXTINGUISHER - TECHNICAL SHEET NO 10
-  JARDINIERA - FISA TEHNICA NR 7  
FLOWER STAND - TECHNICAL SHEET NO 7

NOTA :  
INFORMAȚIILE REFERITOARE LA MATERIALELE UTILIZATE ȘI CARACTERISTICILE LOR SE GASESC IN FISELE TEHNICE

THE INFORMATIONS ALLOWING TO UNDERSTAND WHICH MATERIAL ARE USED AND THEIR CHARACTERISTICS ARE SHOWN IN THE TECHNICAL SHEETS

### PLAN PARTER AMPLASARE DOTARI SC.1/100 GROUND FLOOR PROPOSAL - DISPLAY OF EQUIPMENTS scale 1/100

D					
C					
B					
A					
Indice Index	Data Date	Modificare Modification/Revision	Proiectant Designer	Aprobat Consultant Approved Consultant	Aprobat CFR Approved CFR



GUVERNUL ROMANIEI  
ROMANIAN GOVERNMENT

PROIECT FINANȚAT DE UNIUNEA EUROPEANĂ  
EUROPEAN UNION FINANCED PROJECT



C.N.C.F. "C.F.R." - S.A.

CLIENT / CLIENT



CONSULTANT / CONSULTANT

Aprobat Approved	Șef proiect Project manager	R. Liuzza	Data Date	Semnătură Signature
Aprobat Approved	Coordonator Secțiune 1 Section 1 Coordinator	C. Gambelli		
Verificat Checked	Expert Cheie Checking Expert	Giuseppe Fioravanti		

SUBCONTRACTANT / SUBCONTRACTOR



Aprobat Approved	Responsabil Subconsultant Subconsultant Responsible	A.Stanciu - Dinulescu	Data Date	Semnătură Signature
Intocmit Elaborated	Proiectant Designer	Alexandra Hegedus	12.2011	

Reabilitarea liniei de cale ferată Brașov - Simeria, parte componentă a coridorului IV Pan European, pentru circulația trenurilor cu viteză maximă de 160 km/h,  
Tronsonul : Brașov - Sighișoara  
Rehabilitation of the railway line Brașov - Simeria, component Part of the IV Pan-European Corridor, for the trains circulation with maximum speed of 160 km/h,  
Section : Brașov - Sighișoara

Proiect/Project  
2004/RO/16/P/PA/003  
Faza / Phase:  
D.E. / E.D.

Denumire desen / Drawing Title :

STATIA C.F. FELDIOARA - CLADIRE DE CALATORI - PLAN PARTER  
AMPLASARE DOTARI  
RAILWAY STATION FELDIOARA - TRAVELERS BUILDING - GROUND FLOOR  
PROPOSAL - DISPLAY OF EQUIPMENTS

Codificare / Codification System	Scara / Scale 1:100	LOT / LOT	Nr. / No 01 / 01
E A 5 1 0 1 E 0 7 B A C C 0 0 3 1 0 2 2 0			