

**LEGENDA PICTOGRAME
SIGNS LEGEND**

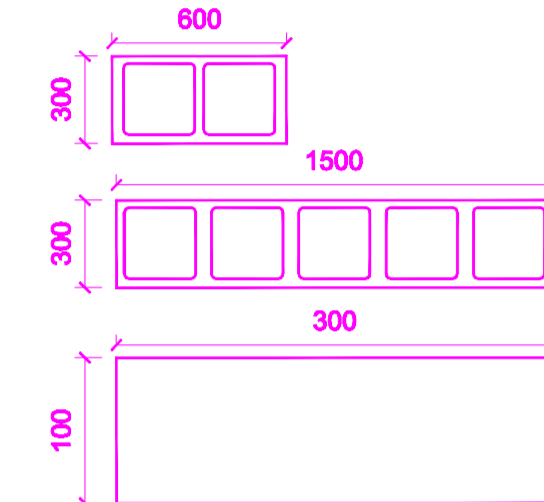

CASETA LUMINOASA MICA 600 x 300 mm - FISA TEHNICA NR.5
SMALL LIGHT CASE 600 x 300 mm - TECHNICAL SHEET NO 5

CASETA LUMINOASA MARE 1500 x 300 mm - FISA TEHNICA NR.11
LARGE LIGHT CASE 1500 x 300 mm - TECHNICAL SHEET NO 11

FIRMA DENUMIRE STATIE 3000 x 1000 mm - FISA TEHNICA NR.2
LIGHT SIGNBOARD WITH THE STATION NAME 3000 x 1000 mm - TECHNICAL SHEET NO 2

NOTA:
H fiber sub caseta rezultat in urma montarii nu trebuie sa fie mai mic de 2,30 m
The light under the case must be over 2.30m after mounting them

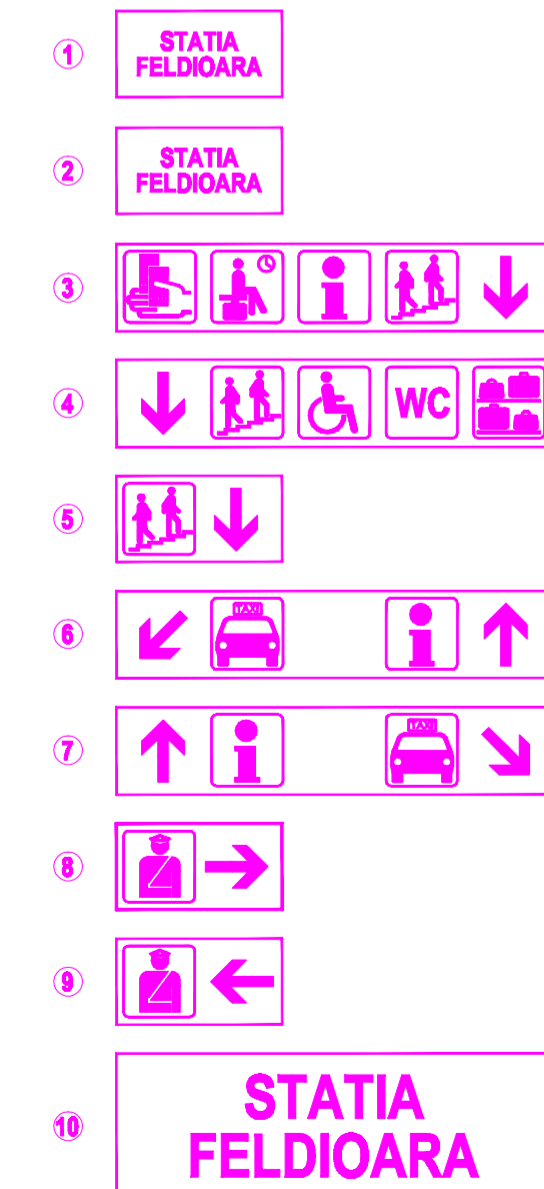

1) Firma denumire statie pe capat de copertina
Light signboard with the station name on the canopy extremity

2) Firma denumire statie
Light signboard with the station name

3) Caseta luminoasa mare
Large light case

4) Caseta luminoasa mare
Large light case

5) Caseta luminoasa mica
Small light case

6) Caseta luminoasa mare
Large light case

7) Caseta luminoasa mare
Large light case

8) Caseta luminoasa mica
Small light case

9) Caseta luminoasa mica
Small light case

10) Firma denumire statie pe cladire
Light signboard with the station name on the building

**LEGENDA DOTARI
EQUIPMENTS LEGEND**

- 11) Platforma elevatoare pentru persoane cu dizabilitati - FISA TEHNICA NR.1
Mobile platform for disabled persons - TECHNICAL SHEET NO 1
- 12) Banci pentru calatori - FISA TEHNICA NR.6
Benches for passengers - TECHNICAL SHEET NO 6
- 13) Jardiniera - FISA TEHNICA NR.7
Flower stand - TECHNICAL SHEET NO 7
- 14) Cos de gunoi exterior - FISA TEHNICA NR.8
Outdoor garbage bin - TECHNICAL SHEET NO 8
- 15) Stalpi delimitatori la interax de 1,5m - FISA TEHNICA NR.12
Boundary pole at 1,5m distance between - TECHNICAL SHEET NO 12

**LEGENDA
LEGEND**

- ⊗ Corp de iluminat
Lighting unit
- ⊥ Stalp metalic electrificare profil H
Metallic H pole
- ⊠ Stalp metalic electrificare profil Mu
Metallic Mu pole

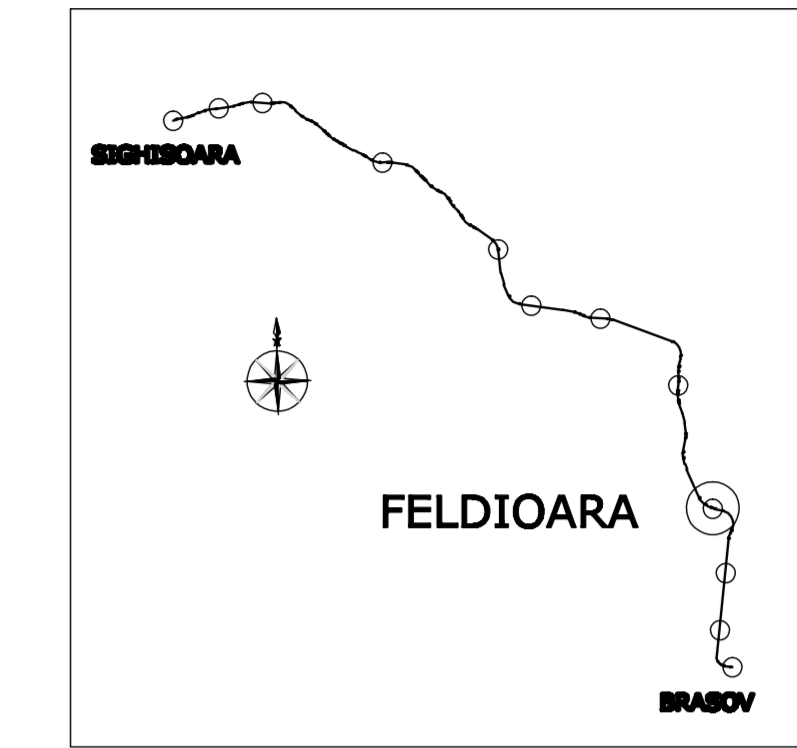
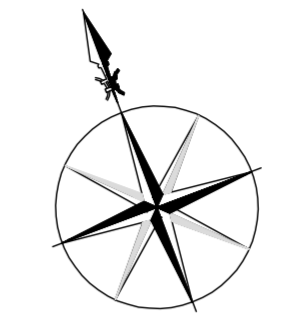
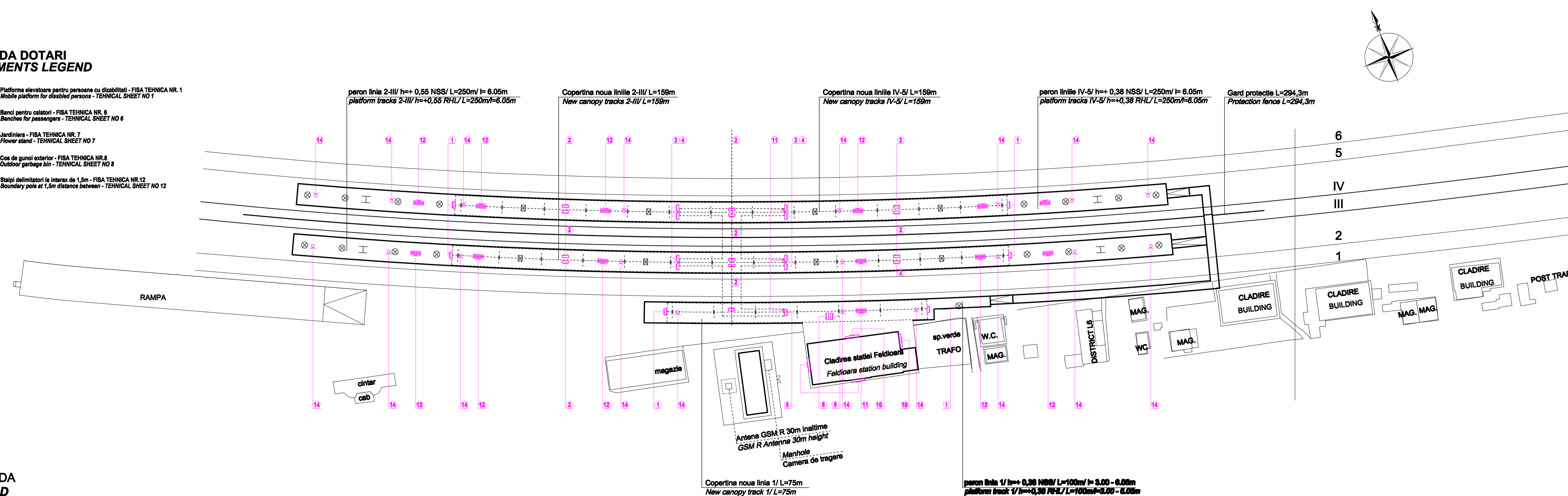

D					
C					
B					
A					
Indice	Data	Modificari/Revision	Proiectant	Aprobat Consultant	Aprobat CFR

GUVERNUL ROMANIEI ROMANIAN GOVERNMENT
PROIECT FINANȚAT DE UNIUNEA EUROPEANĂ EUROPEAN UNION FINANCED PROJECT

CLIENT / CLIENT
CFR C.N.C.F. "C.F.R." - S.A.

CONSULTANT / CONSULTANT
ITALFERR GRUPUL FERVIAR DE STATO John's Venture leader
Scot Wilson
OBERMEYER FLANEN + BERATEN GmbH
TECNIC Consulting Engineers

CONSULTANT / CONSULTANT		Data	Semnatura
Aprobat	Self project	R. Lukza	12.2011
Approved	Project manager		
Aprobat	Coordonator Sectiune 1	C. Gambelli	12.2011
Approved	Section 1 Coordinator		
Verificat	Verificator	Giuseppe Fioravanti	12.2011
Checked	Verifier		

SUBCONTRACTANT / SUBCONTRACTOR		Data	Semnatura
Aprobat	Responsabil Subcontractant	A. Stancu - Dinulescu	12.2011
Approved	Subcontractant Responsible		
Intocmit	Proiectant	Stefania Gheorghe	12.2011
Elaborated	Designer		

Reabilitarea liniei de cale ferata Brasov - Simeria, parte componenta a coridorului IV Pan European, pentru circulatia trenurilor cu viteza maxima de 180 km/h, Tronsoanel: Brasov - Sighisoara
Rehabilitation of the railway line Brasov - Simeria, component Part of the IV Pan-European Corridor, for the trains circulation with maximum speed of 180 km/h, Section: Brasov - Sighisoara

Project/Project 2004/RO16/PP1A003
Faza / Phase: D.E. / E.D.

Denumire desen / Drawing Title:
Plan amplasare dotari si pictograme - Stația Feldioara;
Feldioara Station - Layout Plan for equipments and symbols

Codificare / Codification System	Scara / Scale 1:500	LOT / LOT	Nr. / No 01/01
EA51 01 E 07 LB CC 00 5 2 009 1			