

DETALIU 1 - PLAN sc 1:100 / DETAIL 1 - PLAN sc 1:100  
 DETALIU 2 - PLAN sc 1:100 / DETAIL 2 - PLAN sc 1:100  
 DETALIU 3 - PLAN sc 1:100 / DETAIL 3 - PLAN sc 1:100

**LEGENDA DETALII / DETAILS LEGEND**

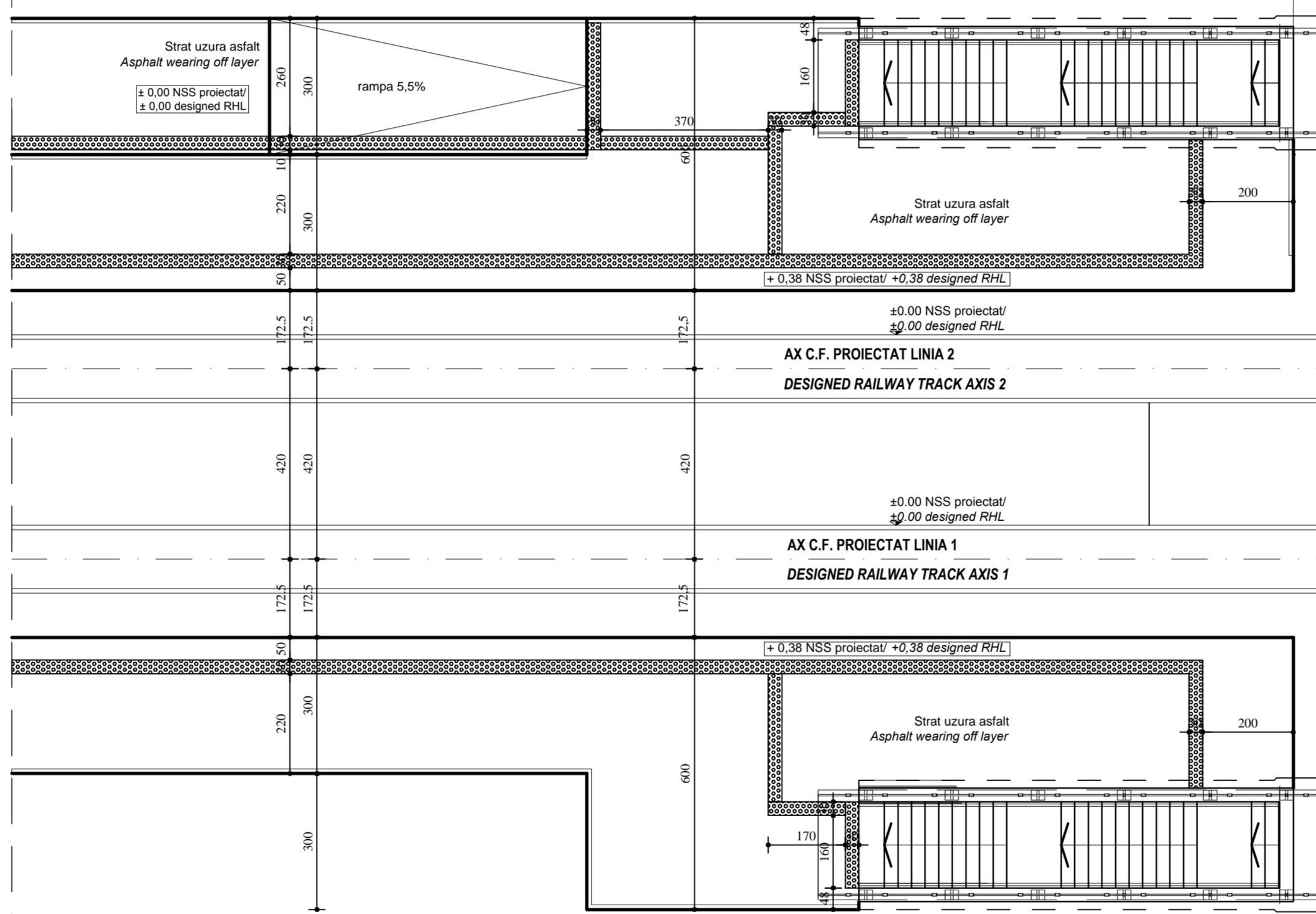

DETALIU 3 - PLAN sc 1:100 / DETAIL 3 - PLAN sc 1:100

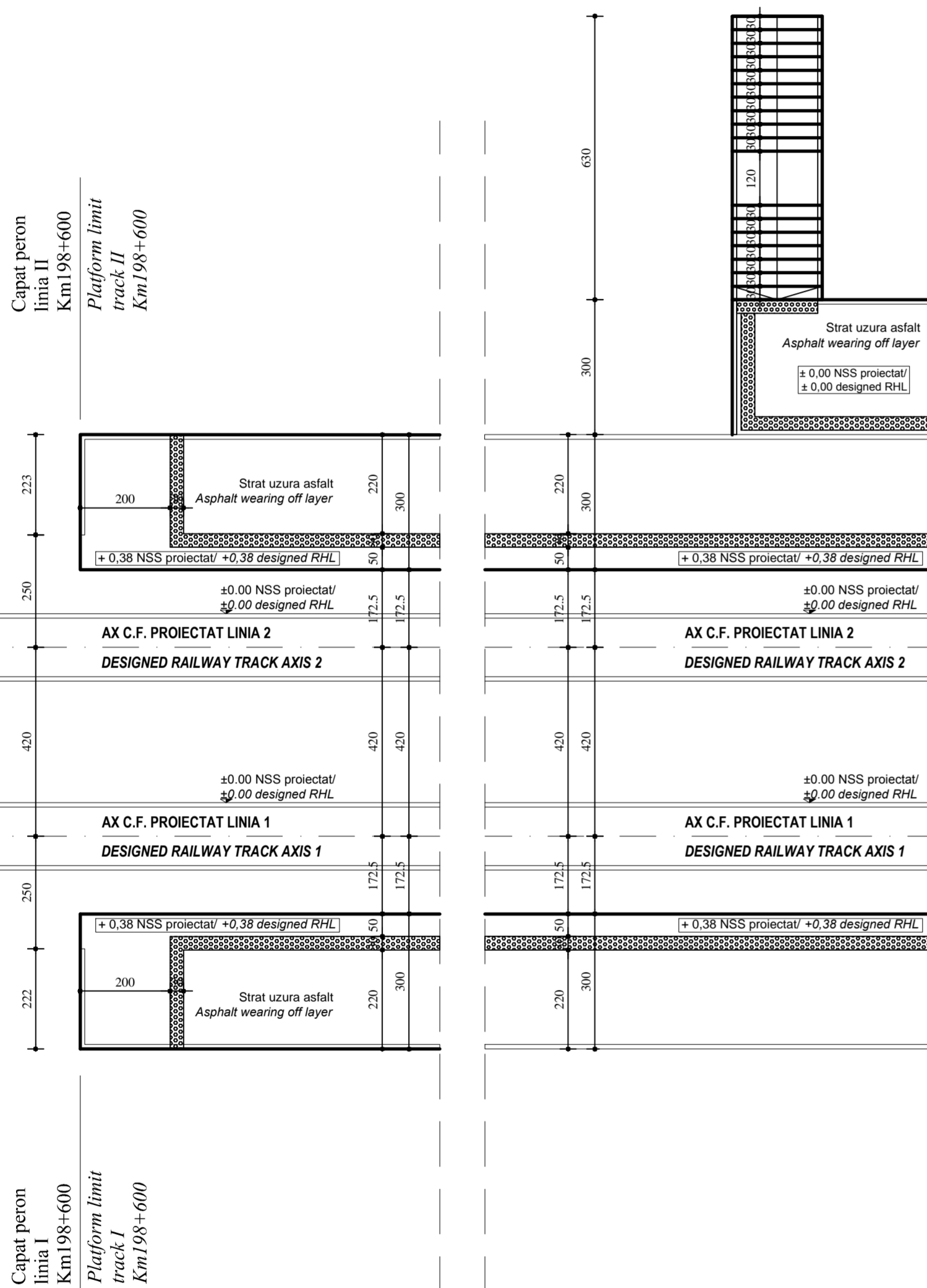

DETALIU 1 - PLAN sc 1:100 / DETAIL 1 - PLAN sc 1:100

DETALIU 2 - PLAN sc 1:100 / DETAIL 2 - PLAN sc 1:100



Ax tunel pietonal nou  
 Km 198+754,30  
 New Pedestrian tunnel Axis  
 Km 198+754,30

Capat peron linia II  
 Km 198+750  
 Platform limit track II  
 Km 198+750

Capat peron linia II  
 Km 198+750  
 Platform limit track II  
 Km 198+750

Ax tunel pietonal nou  
 Km 198+754,30  
 New Pedestrian tunnel Axis  
 Km 198+754,30

D					
C					
B					
A					
Indice	Data	Modificare	Proiectant	Aprobat Consultant	Aprobat CFR
Index	Date	Modification/Revision	Designer	Approved Consultant	Approved CFR

**GUVERNUL ROMANIEI / ROMANIAN GOVERNMENT**
**PROIECT FINANȚAT DE UNIUNEA EUROPEANĂ / EUROPEAN UNION FINANCED PROJECT**

**C.N.C.F. "C.F.R." - S.A.**  
**CLIENT / CLIENT**

CONSULTANT / CONSULTANT			Data	Semnătură
			Date	Signature
Aprobat / Approved	Șef proiect / Project manager	R. Liuzza	12.2011	
Aprobat / Approved	Coordonator / Section 1 Coordinator	C. Gambelli	12.2011	
Verificat / Checked	Verificator / Verifier	Giuseppe Fioravanti	12.2011	

SUBCONTRACTANT / SUBCONTRACTOR			Data	Semnătură
			Date	Signature
Aprobat / Approved	Responsabil Subcontractant / Subcontractant Responsible	A.Stanciu - Dinulescu	12.2011	
Intocmit / Elaborated	Proiectant / Designer	Stefania Gheorghie	12.2011	

Reabilitarea liniei de cale ferată Brașov - Simeria, parte componentă a coridorului IV Pan European, pentru circulația trenurilor cu viteză maximă de 160 km/h,  
**Tronsonul : Brașov - Sighișoara**  
 Rehabilitation of the railway line Brașov - Simeria, component Part of the IV Pan-European Corridor, for the trains circulation with maximum speed of 160 km/h,  
**Section : Brașov - Sighișoara**

**Proiect/Project**  
 2004/RO/16/PPA/003  
**Faza / Phase:**  
 D.E. / E.D.

**Denumire desen / Drawing Title :**  
**Detalii capete de peroane - Halta Vadu Rosu;**  
**Vadu Rosu Flag Station - Details for platforms extremities**

Codificare / Codification System	Scara / Scale 1:100	LOT / LOT	Nr. / No 01 / 01																					
<table border="1"> <tr> <td>E</td><td>A</td><td>5</td><td>1</td> <td>0</td><td>1</td> <td>E</td> <td>0</td><td>8</td> <td>B</td><td>A</td> <td>C</td><td>C</td> <td>0</td><td>0</td> <td>1</td> <td>2</td> <td>0</td><td>0</td><td>8</td> <td>2</td> </tr> </table>				E	A	5	1	0	1	E	0	8	B	A	C	C	0	0	1	2	0	0	8	2
E	A	5	1	0	1	E	0	8	B	A	C	C	0	0	1	2	0	0	8	2				