

**LEGENDA PICTOGRAME  
SIGNS LEGEND**

- 1 **STATIA VANATORI**
- 2 **STATIA VANATORI**
- 3 **Caseta luminoasa mare**  
Large light case
- 4 **Caseta luminoasa mare**  
Large light case
- 5 **Caseta luminoasa mica**  
Small light case
- 6 **Caseta luminoasa mare**  
Large light case
- 7 **Caseta luminoasa mare**  
Large light case
- 8 **Caseta luminoasa mica**  
Small light case
- 9 **Caseta luminoasa mica**  
Small light case
- 10 **STATIA VANATORI**

Firma denumire statie pe capat de copertina  
Light signboard with the station name on the canopy extremity

Firma denumire statie  
Light signboard with the station name

Caseta luminoasa mare  
Large light case

Caseta luminoasa mare  
Large light case

Caseta luminoasa mica  
Small light case

Caseta luminoasa mare  
Large light case

Caseta luminoasa mare  
Large light case

Caseta luminoasa mica  
Small light case

Caseta luminoasa mica  
Small light case

Firma denumire statie pe cladire  
Light signboard with the station name on the building

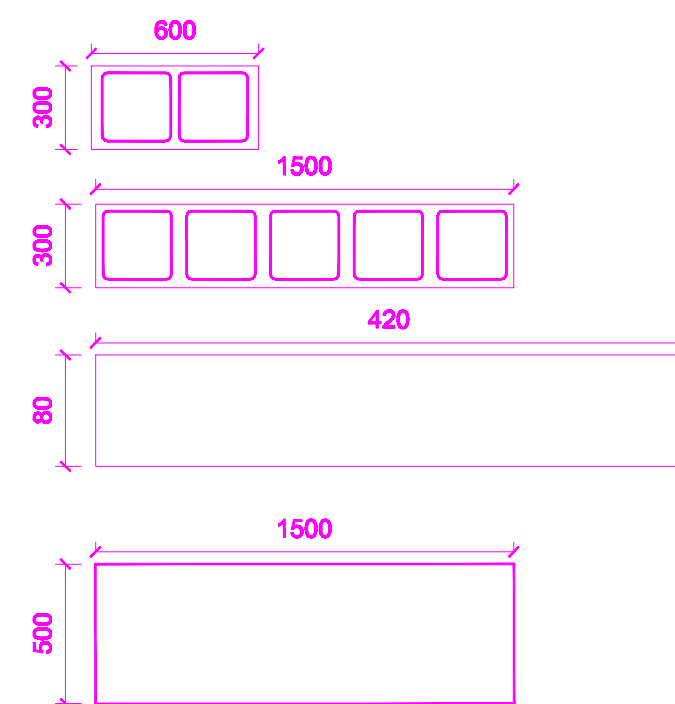

NOTA:  
H fiber sub caseta rezultat in urma montarii nu trebuie sa fie mai mic de 2.30 m  
free height under the icons must be over 2.30m after mounting them

**LEGENDA DOTARI  
EQUIPMENTS LEGEND**

- 11 Platforma elevatoare pentru persoane cu dizabilitati - FISA TEHNICA NR. 1  
Mobile platform for disabled persons - TECHNICAL SHEET NO 1
- 12 Banci pentru calatori - FISA TEHNICA NR. 6  
Benches for passengers - TECHNICAL SHEET NO 6
- 13 Jardiniera - FISA TEHNICA NR. 7  
Flower stand - TECHNICAL SHEET NO 7
- 14 Cos de gunoi exterior - FISA TEHNICA NR.8  
Outdoor garbage bin - TECHNICAL SHEET NO 8
- 15 Stalpi delimitatori la interax de 1,5m - FISA TEHNICA NR.12  
Boundary pole at 1,5m distance between - TECHNICAL SHEET NO 12
- 16 Carucior pentru transport bagaje - FISA TEHNICA NR. 13  
Cart for luggage transport - TECHNICAL SHEET NO 13

CASETA LUMINOASA MICA 600 x 300 mm - FISA TEHNICA NR 5  
SMALL LIGHT CASE 600 x 300 mm - TECHNICAL SHEET NO 5

CASETA LUMINOASA MARE 1500 x 300 mm - FISA TEHNICA NR 11  
LARGE LIGHT CASE 1500 x 300 mm - TECHNICAL SHEET NO 11

FIRMA DENUMIRE STATIE 4200 x 800 mm - FISA TEHNICA NR 2  
LIGHT SIGNBOARD WITH THE STATION NAME 4200 x 800 mm -  
TEHNICAL SHEET NO 2

FIRMA DENUMIRE STATIE 1500 x 500 mm - FISA TEHNICA NR 14  
LIGHT SIGNBOARD WITH THE STATION NAME 1500 x 500 mm -  
TEHNICAL SHEET NO 14

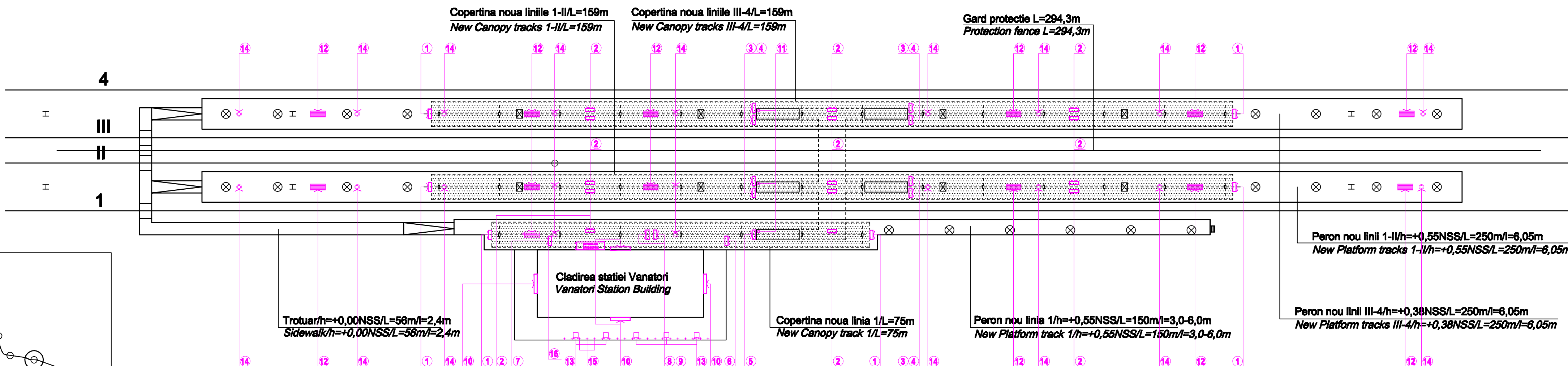
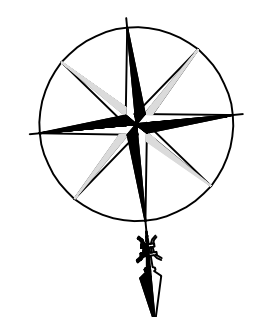
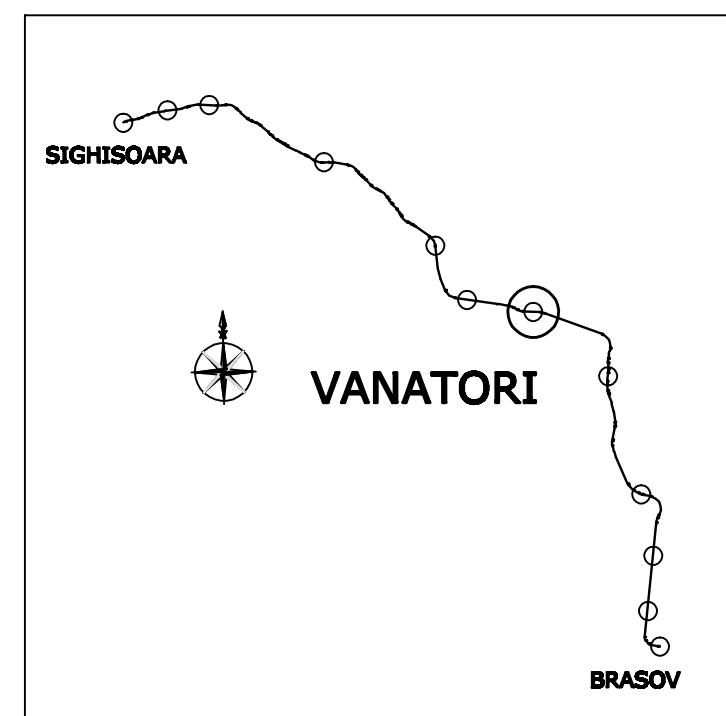

- LEGENDA  
LEGEND**
- Corp de iluminat  
Lighting unit
  - Stalp metallic electrificare profil H  
Metallic H pole
  - Stalp metallic electrificare profil Mu  
Metallic Mu pole

D					
C					
B					
A					
Index	Date	Modificari Modifications/Revisions	Proiectant Designer	Aprobat Clientul Approved Client	Aprobat CFR Approved CFR
				GUVERNUL ROMANIEI ROMANIAN GOVERNMENT	
		PROIECT FINANȚAT DE UNIUNEA EUROPEANĂ EUROPEAN UNION FINANCED PROJECT			
<b>CLIENT / CLIENT</b>					
<b>CONSULTANT / CONSULTANT</b>					
Aprobat Approved	Data Date	Responsabil Responsible	Data Date	Semnatura Signature	
Verificat Checked		Verificator Verifier			
<b>SUBCONTRACTANT / SUBCONTRACTOR</b>					
Aprobat Approved		Responsabil Subcontractant Subcontractant Responsible			
Intocmit Elaborated		Proiectant Designer			
Reabilitarea liniei de cale ferata Brasov - Simeria, parte component a a coridorului IV Pan European, pentru circulația trenurilor cu viteză maximă de 160 km/h, Tronsoanel : Brasov - Sighisoara Reabilitarea the railway line Brasov - Simeria, component Part of the IV Pan-European Corridor, for the trains circulation with maximum speed of 160 km/h, Section : Brasov - Sighisoara		<b>Project/Project</b> 2004/RO/16/PPA/003 Faza / Phase: D.E. / E.D.			
Denumire desen / Drawing Title : <b>Plan amplasare dotari si pictograme - Stația Vanatori;                  Vanatori Station - Layout Plan for equipments and symbols</b>					
Codificare / Codification System		Scara / Scale 1:200	LOT / LOT	Nr. / No 01 / 01	
E A 5 1		0 1	E	1 7	L 8
C C		0 1	0	2	0 0 9
1					