

NOTA :
LA ETAJ NU SE INTERVINE IN SPATIILE EXISTENTE.
FIRST FLOOR PLAN - EXISTING SPACES WILL NOT SUFFER ANY TRANSFORMATION

- NOTA :
- Se vor executa desfaceri de :
- tamplarie ferestre
 - Se vor executa lucrari noi de :
- tamplarie ferestre
- NOTE :
- It will be executed disassembles of existing :
- joinery of windows
 - It will be executed new works :
- new joinery of windows

LEGENDA / LEGEND :

INLOCUIRE TAMPLARIE EXISTENTA
WINDOWS SUBJECT TO INTERVENTION
(REPLACEMENT OF THE OLD JOINERY WITH A NEW ONE)

MARCI FERESTRE
MARKS OF NEW JOINERY

Numerele pozitionate in cercurile reprezinta pozitia in plan(marca) a prinderilor interne si externe ;
descrierea lor poate fi regasita in plansa nr. EA5101E19BACC00910150
The circled numbers represent the position in plane (mark) of the internal and external fixtures ;
their description can be found in drawing no EA5101E19BACC00910150

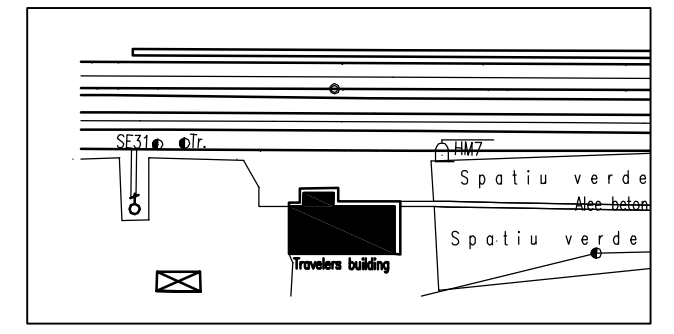
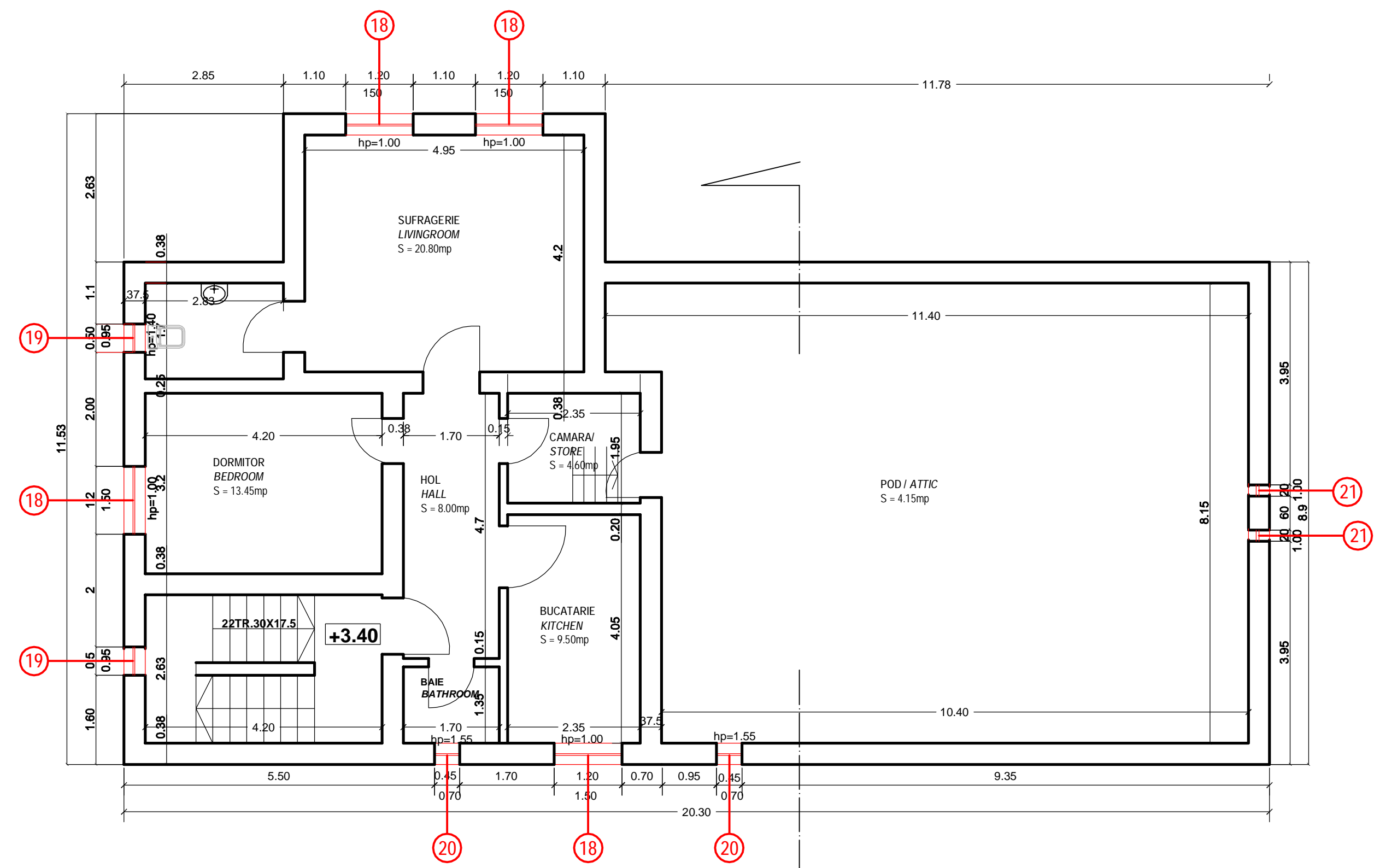

PLAN ETAJ INLOCUIRE TAMPLARIE EXTERIOARA SC. 1/50
FIRST FLOOR PLAN - EXTERIOR WOODWORK REPLACEMENT SCALE 1/50

D					
C					
B					
A					
Index	Data	Modificare	Proiectant	Aprobat	Aprobat CFR
	Date	Modification/Revision	Designer	Approved Consultant	Approved CFR
		GUVERNUL ROMANIEI ROMANIAN GOVERNMENT		PROIECT FINANȚAT DE UNIUNEA EUROPEANĂ EUROPEAN UNION FINANCED PROJECT	
CLIENT / CLIENT		C.N.C.F. "C.F.R." - S.A.			
CONSULTANT / CONSULTANT					Data
Aprobat	Șef proiect	R. Liuzza			Semnătură
Approved	Project manager				Signature
Aprobat	Coordonator Secțiune 1	C. Gambelli			
Approved	Section 1 Coordinator				
Verificat	Expert Cheie	Giuseppe Fioravanti			
Checked	Key Expert				
SUBCONTRACTANT / SUBCONTRACTOR					
Aprobat	Responsabil Subconsultant	A. Stanciu - Dinulescu			
Approved	Subconsultant Responsible				
Întocmit	Proiectant	Alexandra Hegedus			12.2011
Elaborated	Designer				
Reabilitarea liniei de cale ferată Brașov - Simeria, parte componentă a coridorului IV Pan European, pentru circulația trenurilor cu viteză maximă de 160 km/h, Tronsonul : Brașov - Sighișoara					Project/Project 2004/RO/16/PIPA/003
Rehabilitation of the railway line Brașov - Simeria, component Part of the IV Pan-European Corridor, for the trains circulation with maximum speed of 160 km/h, Section : Brașov - Sighișoara					Faza / Phase: P.Th. / T.D.
Denumire desen / Drawing Title : STATIA C.F. ALBESTI-TARNAVA - CLADIRE DE CALATORI - PLAN ETAJ INLOCUIRE TAMPLARIE EXTERIOARA RAILWAY STATION ALBESTI-TARNAVA - TRAVELERS BUILDING - FIRST FLOOR PLAN - EXTERIOR WOODWORK REPLACEMENT					
Codificare / Codification System		Scara / Scale 1:50	LOT / LOT	Nr. / No 01/01	
E	A	5	1	0	1
C	1	9	P	B	1
C	0	0	9	1	1
0	2	7	1		