

**ALBESTI TARNAVA** FIRMA STATIEI (pe cladire) FISA TEHNICA NR 15  
 LIGHT SIGNBOARD WITH THE STATION NAME  
 (on the facade) TEHNICAL SHEET NO 15

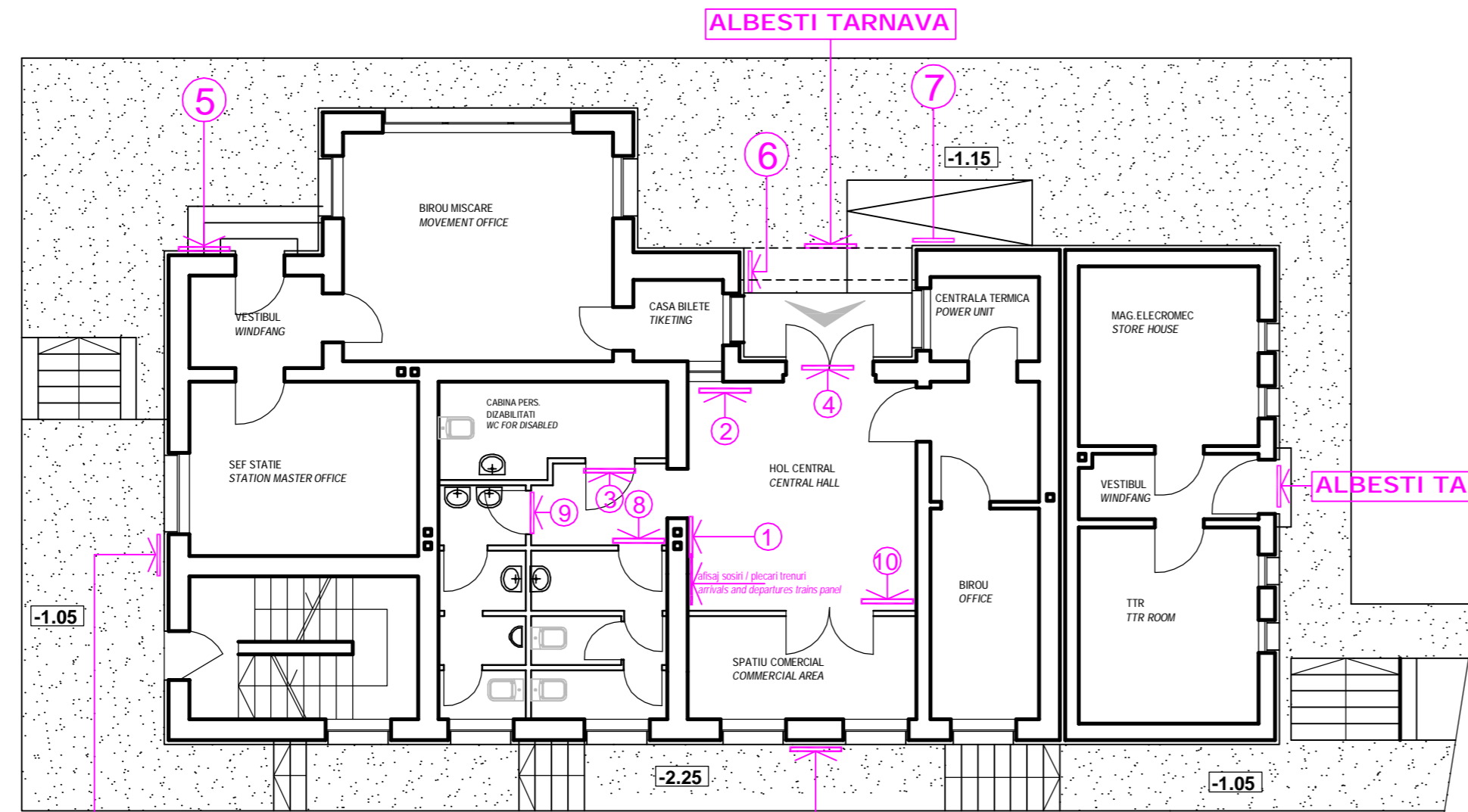

- ① GR. SANIT.PUBLIC  
PUBLIC SANITARY GROUP
- ② CASA BILETE  
TIKETING
- ③ GR. SANIT.PERS.DIZABILITATI  
SANITARY GROUP FOR THE DISABLED +  
MOTHER AND CHILD
- ④ IESIRE PERON LINIA 1  
EXIT TO PLATFORM LINE 1
- ⑤ SEF STATIE  
STATION MASTER
- ⑥ INFORMATII  
INFO
- ⑦ SALA ASTEPTARE  
WAITING ROOM
- ⑧ GR. SANIT. FEMEI  
WOMEN TOILET
- ⑨ GR. SANIT. BARBATI  
MEN'S TOILET
- ⑩ PRESA  
NEWSPAPERS

**ALBESTI TARNAVA** LEGENDA  
**LEGEND**  
**ALBESTI TARNAVA** PLAN PARTER AMPLASARE PICTOGRAME SC.1/100  
**GROUND FLOOR PROPOSAL -DISPLAY OF SYMBOLS scale 1/100**

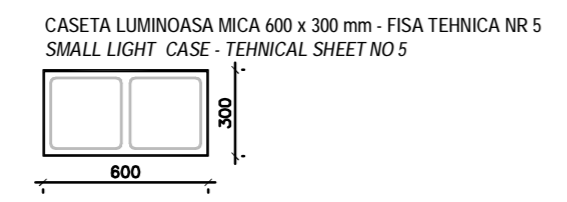

NOTA:  
 H liber sub casete rezultat in urma montarii nu trebuie sa fie mai mic de 2.30 m  
 free height under the icons must be over 2.30m after mounting them

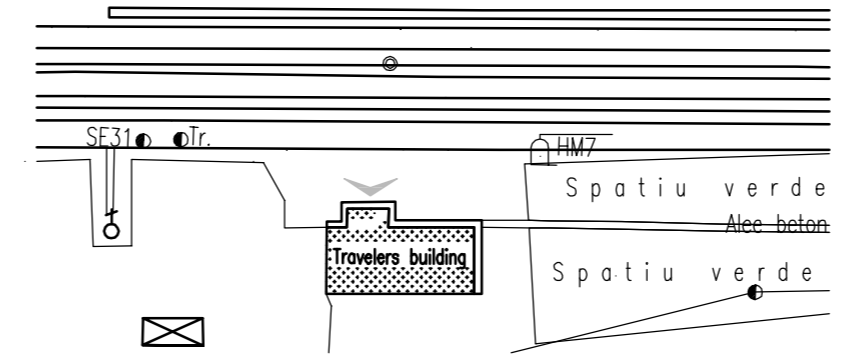

D					
C					
B					
A					
Indice Index	Data Date	Modificare Modification/Revision	Proiectant Designer	Aprobat Consultant Approved Consultant	Aprobat CFR Approved CFR

**GUVERNUL ROMANIEI**  
 ROMANIAN GOVERNMENT

**PROIECT FINANȚAT DE UNIUNEA EUROPEANĂ**  
 EUROPEAN UNION FINANCED PROJECT

**C.N.C.F. "C.F.R." - S.A.**

**CLIENT / CLIENT**

**ITALFERR**  
 GRUPPO FERROVIE DELLO STATO  
 Joint Venture leader

**Scott Wilson**

**OBERMEYER**  
 PLANEN + BERATEN GmbH

**TECNIC**  
 Consulting Engineers

**CONSULTANT / CONSULTANT**

Aprobat Approved	Responsabil Project manager	R. Liuzza	Data Date	Semnătură Signature
Aprobat Approved	Coordonator Secțiune 1 Section 1 Coordinator	C. Gambelli		
Verificat Checked	Expert Cheie Key Expert	Giuseppe Fioravanti		

**SUBCONTRACTANT / SUBCONTRACTOR**

Aprobat Approved	Responsabil Subconsultant Subconsultant Responsible	A. Stanciu - Dinulescu	Data Date	Semnătură Signature
Întocmit Elaborated	Proiectant Designer	Alexandra Hegedus	12.2011	

Reabilitarea liniei de cale ferata Braşov - Simeria, parte componentă a a coridorului IV Pan European, pentru circulația trenurilor cu viteză maximă de 160 km/h,  
**Tronsonul : Braşov - Sighişoara**  
 Rehabilitation of the railway line Braşov - Simeria, component Part of the IV Pan-European Corridor, for the trains circulation with maximum speed of 160 km/h,  
**Section : Braşov - Sighişoara**

2004/RO/16/PPA/003  
 Faza / Phase:  
 D.E. / E.D.

Denumire desen / Drawing Title :

STATIA C.F. ALBESTI-TARNAVA - CLADIRE DE CALATORI - PLAN PARTER  
 AMPLASARE PICTOGRAME  
 RAILWAY STATION ALBESTI-TARNAVA - TRAVELERS BUILDING  
 -GROUND FLOOR PROPOSAL - DISPLAY OF SYMBOLS

Codificare / Codification System	Scara / Scale 1:100	LOT / LOT	Nr. / No 01 / 01
EA51 01 E 19 BA CC 00 9 1 020 2			

A3 . 297 x 600