

IESIRE SPRE ORAS
EXIT TO TOWN

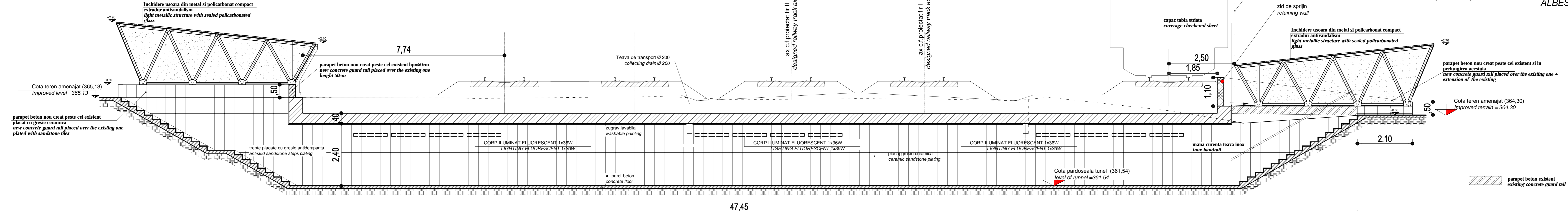

47,45
SECTIUNE LONGITUDINALA A - A 1/50 ;AMENAJARE
LONGITUDINAL SECTION A - A scale 1/50;PROPOSAL

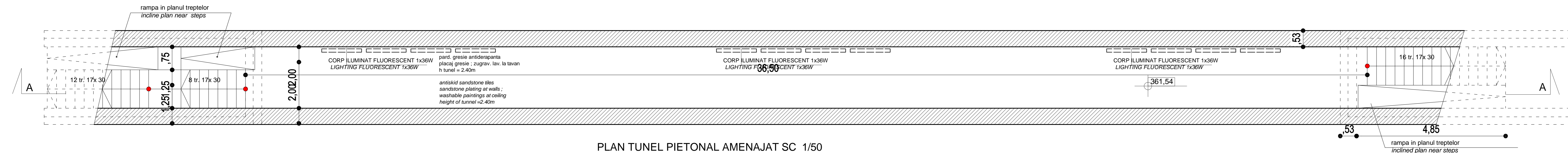

PLAN TUNEL PIETONAL AMENAJAT SC 1/50
PROPOSED PEDESTRIAN TUNNEL PLAN SCALE 1/50

SUBTRAVERSARE PASAJ PIETONAL EXISTENT
STATIA CF ALBESTI

EXISTENT UNDERGROUND PEDESTRIAN PASSAGE
ALBESTI RAILWAY STATION

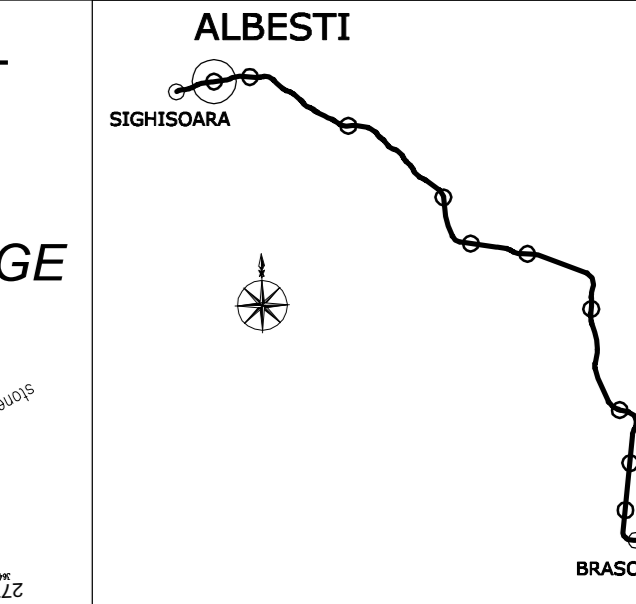
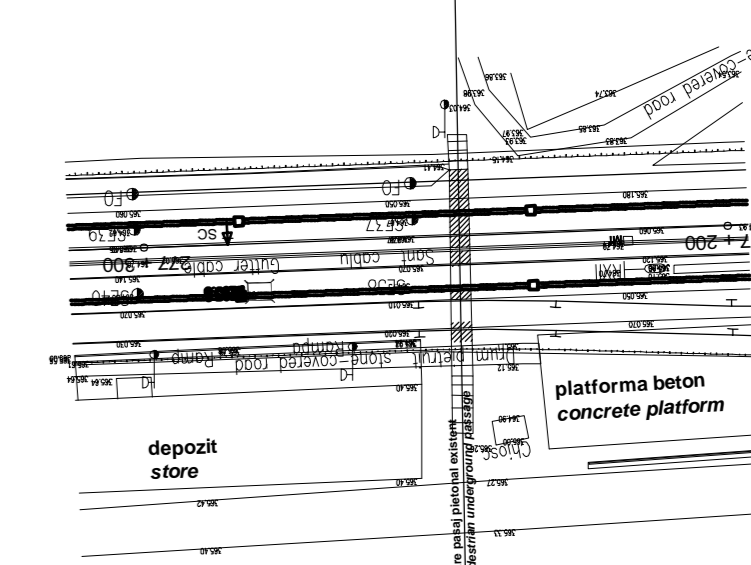

Indice	Data	Modificare/Revision	Proiectant	Approbat Consultant	Approbat CFR
D					
C					
B					
A					



CLIENT / CLIENT
 C.N.C.F. "C.F.R." - S.A.



CONSULTANT / CONSULTANT		Data	Semnatura
Approbat	Set proiect	R. Liuzza	
Approbat	Project manager		
Approbat	Coordinator Section 1	C. Gambelli	
Verificat	Projectant	Giuseppe Fioravanti	
Checkat	Expert Cheie		
	Checking Expert		

SUBCONTRACTANT / SUBCONTRACTOR		Data	Semnatura
Approbat	Responsabil Subcontractant	A. Stanciu - Dinulescu	
Approbat	Subcontractant Responsible		
Elaborat	Projectant	Alexandra Hegedus	
	Designer		

Reabilitarea liniei de cale ferata Brasov - Simeria, parte componenta a coridorului IV Pan European, pentru circulația trenurilor cu viteza maximă de 160 km/h,
Tronsonul : Brasov - Sighisoara
 Rehabilitation of the railway line Brasov - Simeria, component Part of the IV Pan-European Corridor, for the trains circulation with maximum speed of 160 km/h,
Section : Brasov - Sighisoara

Denumire desen / Drawing Title :
 TUNEL PIETONAL EXISTENT STATIA C.F. ALBESTI TARNAVA - PLAN SI
 SECTIUNE LONGITUDINALA AMENAJARE
 ALBESTI TARNAVA RAILWAY STATION - EXISTENT PEDESTRIAN TUNNEL ;
 PLAN AND LONGITUDINAL SECTION PROPOSAL

Codificare / Codification System	Scara / Scale	LOT/LOT	Nr. / No
E A 5 1	1:50	01	01/01