

SUBTRAVERSARE PASAJ PIETONAL EXISTENT  
STATIA CF ALBESTI  
EXISTENT UNDERGROUND PEDESTRIAN PASSAGE  
ALBESTI RAILWAY STATION

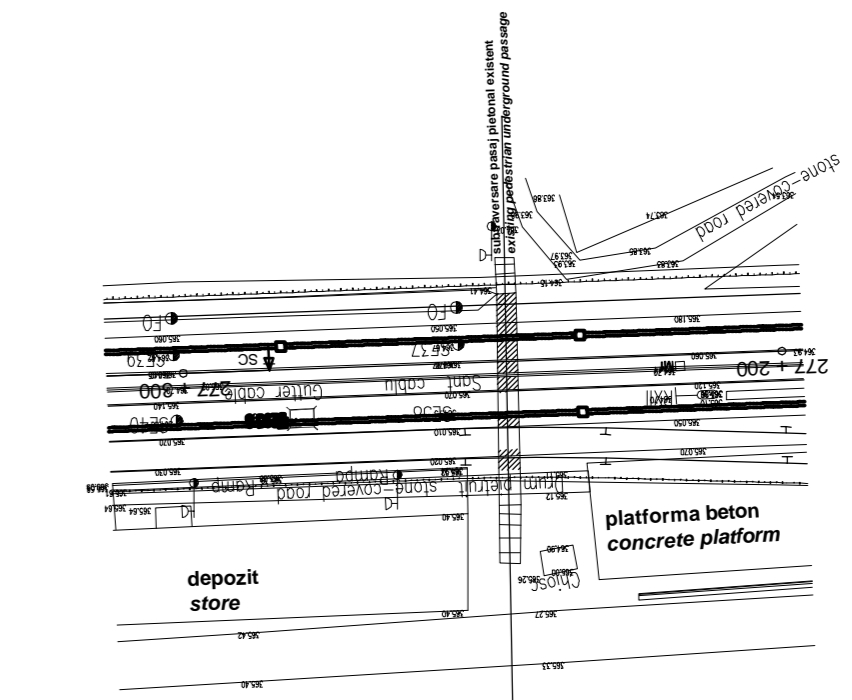
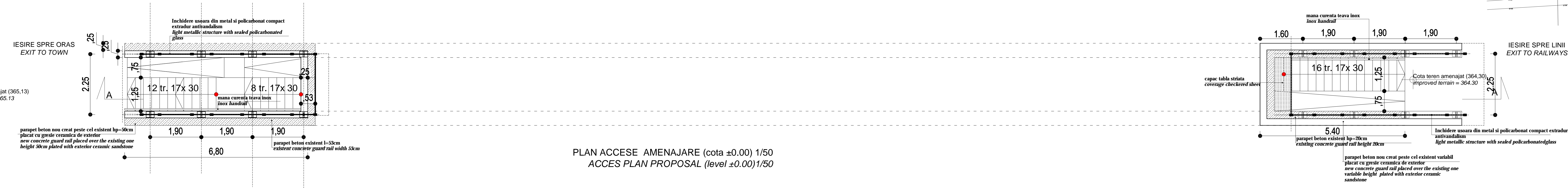

PLAN ACCESE AMENAJARE (cota ±0.00) 1/50  
ACCES PLAN PROPOSAL (level ±0.00) 1/50

parapet beton existent  
existing concrete guard rail

parapet beton nou creat peste cel existent  
new concrete guard rail placed over the existing one

D					
C					
B					
A					
Indice	Data	Modificare	Proiectant	Aprobat	Aprobat CFR
Index	Date	Modification/Revision	Designer	Approved Consultant	Approved CFR



GUVERNUL ROMANIEI  
ROMANIAN GOVERNMENT

PROIECT FINANȚAT DE UNIUNEA EUROPEANĂ  
EUROPEAN UNION FINANCED PROJECT

C.F.R.

C.N.C.F. "C.F.R." - S.A.



CONSULTANT / CONSULTANT		Date	Semnatura
Aprobat	Set proiect	Date	Signature
Aprobat	Project manager		
Aprobat	Coordonator Sectiune 1		
Aprobat	Section 1 Coordinator		
Verificat	Expert Cheie		
Checked	Checking Expert		

SUBCONTRACTANT / SUBCONTRACTOR		Date	Semnatura
Aprobat	Responsabil Subcontractant	Date	Signature
Aprobat	Subcontractant Responsible		
Elaborat	Projectant		
Elaborat	Designer	12.2011	

Reabilitarea liniei de cale ferata Brasov - Simeria, parte component a a coridorului IV Pan European, pentru circula ția trenurilor cu viteza maxim a de 160 km/h,  
Tronsonul : Brasov - Sighisoara  
Rehabilitation of the railway line Brasov - Simeria, component Part of the IV Pan-European Corridor, for the trains circulation with maximum speed of 160 km/h,  
Section : Brasov - Sighisoara

Project/Project  
2004/RO/16/P/PA/003  
Faza / Phase:  
P.TH / T.D.

Denumire desen / Drawing Title :  
TUNEL PIETONAL EXISTENT STATIA C.F. ALBESTI TARNAVA - PLAN  
ACCES AMENAJARE  
ALBESTI TARNAVA RAILWAY STATION - EXISTENT PEDESTRIAN TUNNEL ;  
PROPOSAL ACCESS PLAN

Codificare / Codification System	Scara / Scale 1:50	LOT / LOT	Nr. / No 01 / 01
E   A   5   1   0   1   C   1   9   P   B   C   C   0   0   9   4   0   1   6   1			