

EXTRAS DE LAMINATE GTC3 - pentru 1 buc. LAMINATED ELEMENTS TABLE GTC3-1 pcs.

Poz.	Dimensiuni (mm)	Lungime (mm)	Bucăți	Greutate kg	
				/m	TOTAL
P34	22x500-	500	2	86.35	43.18
P41	10x300-	5300	2	23.60	125.08
P42	12x220-	5386	1	20.73	111.24
P43	12x220-	5450	1	20.73	112.94
P44	10x199-	299	2	15.62	4.67
P45	6x199-	129	2	9.38	1.21
P46	10x120-	300	8	9.42	2.83
P47	L125x200x14-	250	6	34.40	8.60
P49	M20-	240	8	-	0.635
P50	5x50-	50	24	1.96	0.10
P51	M20-	-	24	-	0.0603
P52	M20-	180	4	-	0.449
P56	Ø140x10-	240	3	40.80	9.73
P57	10x100-	180	6	7.85	1.42
TOTAL LAMINATE				695.33	
ELECTROZI + GRIND 3% ELECTRODES + WELDING 3%				20.67	
TOTAL Kg / 1 buc. / 1 pcs.				716.00	

EXTRAS DE LAMINATE GTC4 - pentru 1 buc. LAMINATED ELEMENTS TABLE GTC4 - 1 pcs.

Poz.	Denumirea	Dimensiuni (mm)	Lungime (mm)	Bucăți	Greutate kg	
					/m	TOTAL
P34	Placă de asamblare	22x500-	500	2	86.35	43.18
P41	Laterală grindă transversală	10x300-	5300	2	23.60	125.08
P42	Țeavă superioară	12x220-	5386	1	20.73	111.24
P43	Țeavă inferioară	12x220-	5450	1	20.73	112.94
P44	Rigidizare interioară grindă	10x199-	299	2	15.62	4.67
P45	Capac	6x199-	129	2	9.38	1.21
P46	Rigidizare (gusur)	10x120-	300	8	9.42	2.83
P48	Reazem pană	L125x200x14-	300	6	34.40	10.32
P49	Șurub	M20-	240	16	-	0.635
P50	Șaibă	5x50-	50	48	1.96	0.10
P51	Pășă	M20-	-	48	-	0.0603
P52	Șurub	M20-	180	8	-	0.449
P56	Țeavă rigidizare	Ø140x10-	240	3	40.80	9.73
P57	Guseu rigidizare	10x100-	180	6	7.85	1.42
P58	Ediș	10x180-	300	6	14.10	4.23
TOTAL LAMINATE				741.76		
ELECTROZI + GRIND 3% ELECTRODES + WELDING 3%				22.24		
TOTAL Kg / 1 buc. / 1 pcs.				764.00		

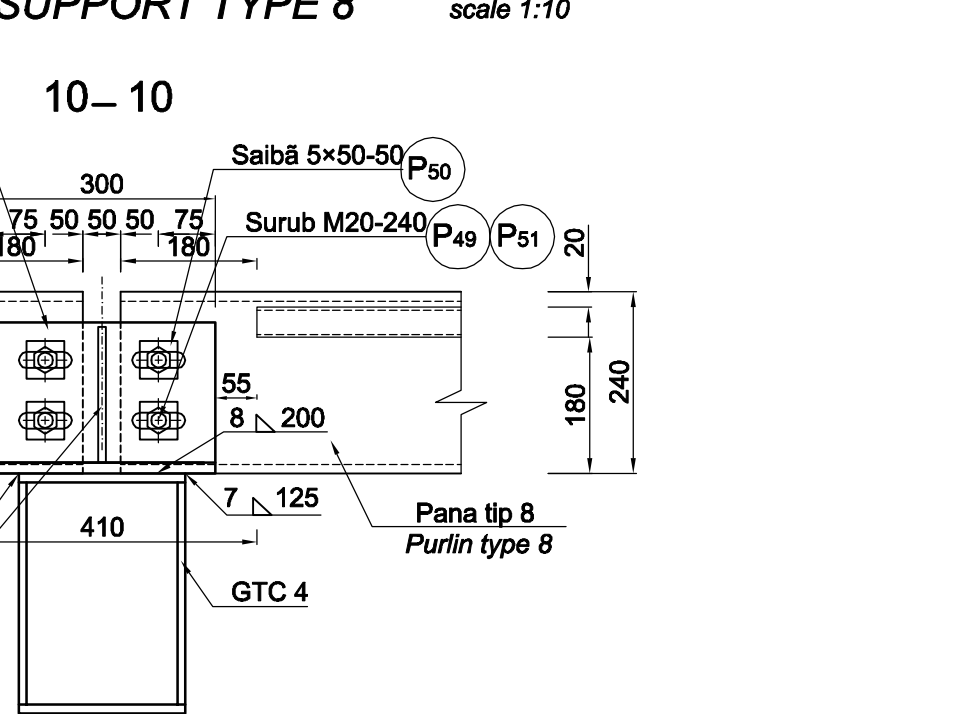
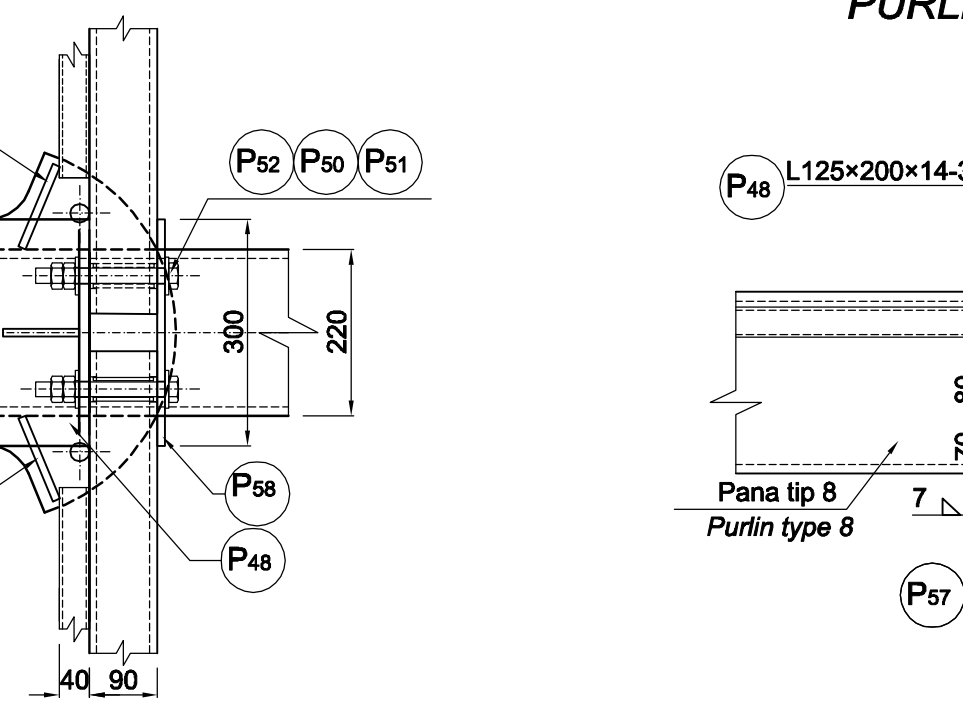
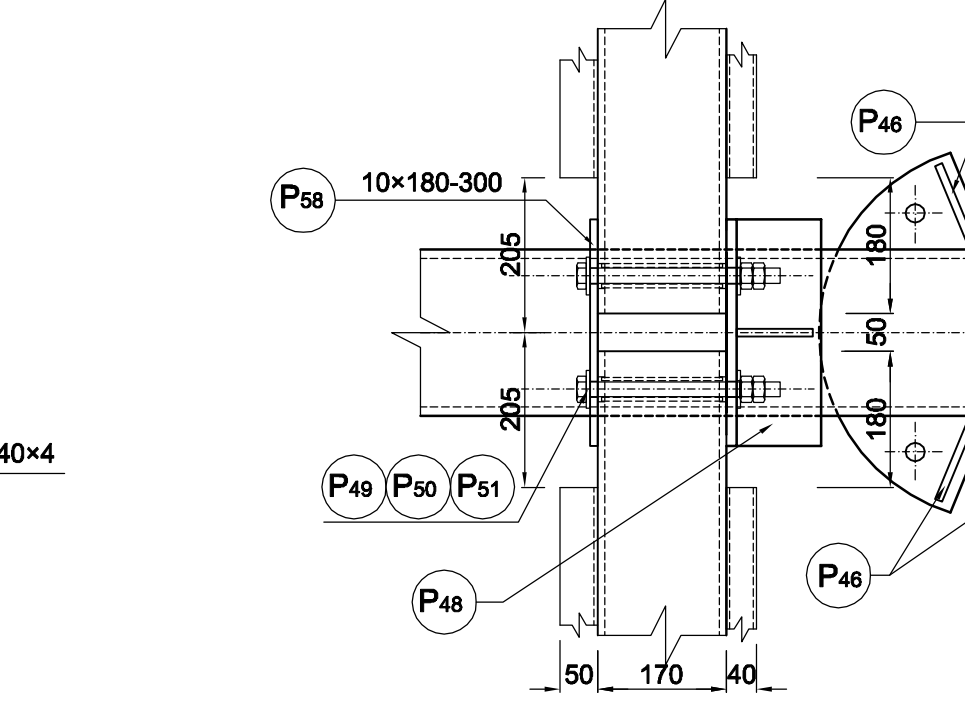
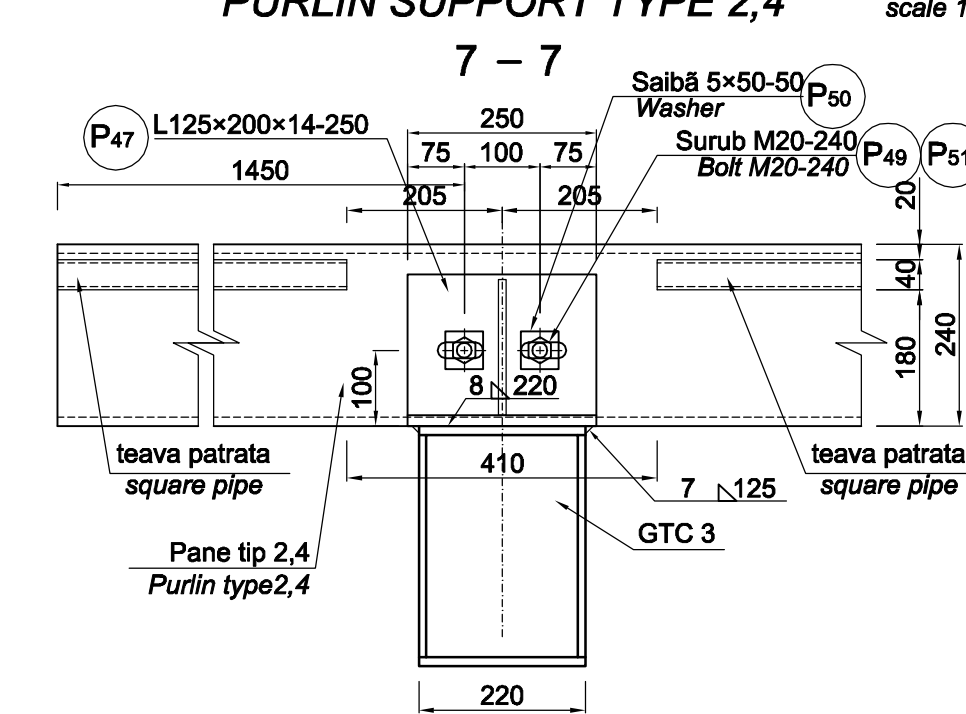
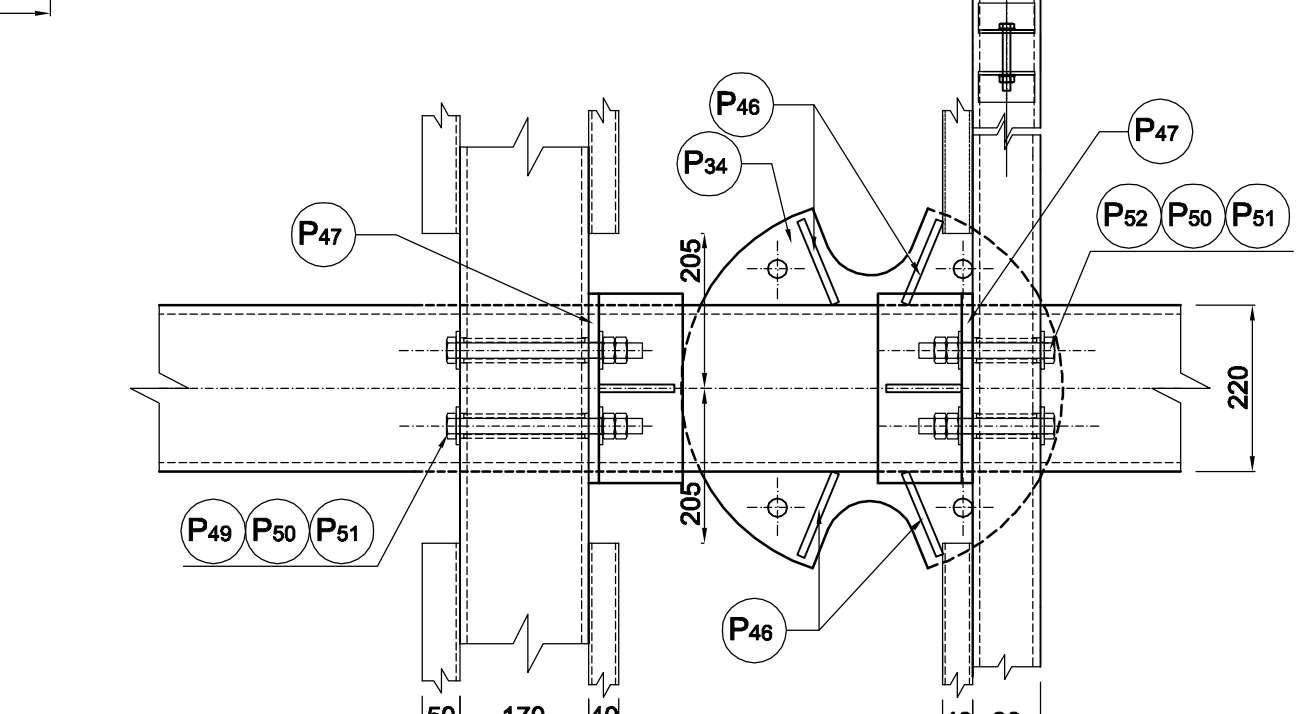
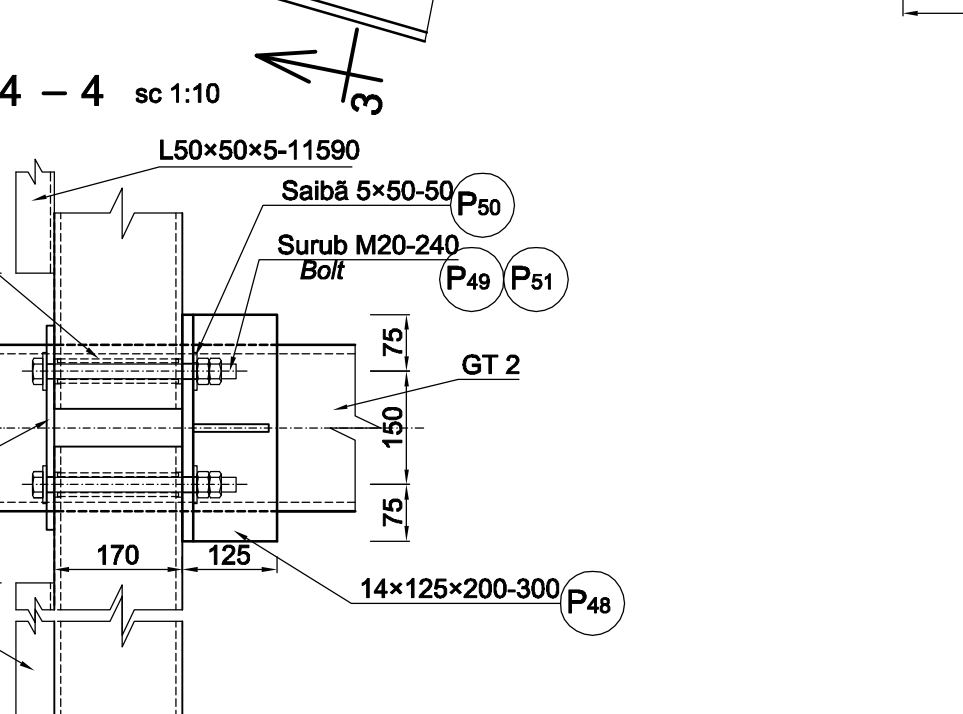
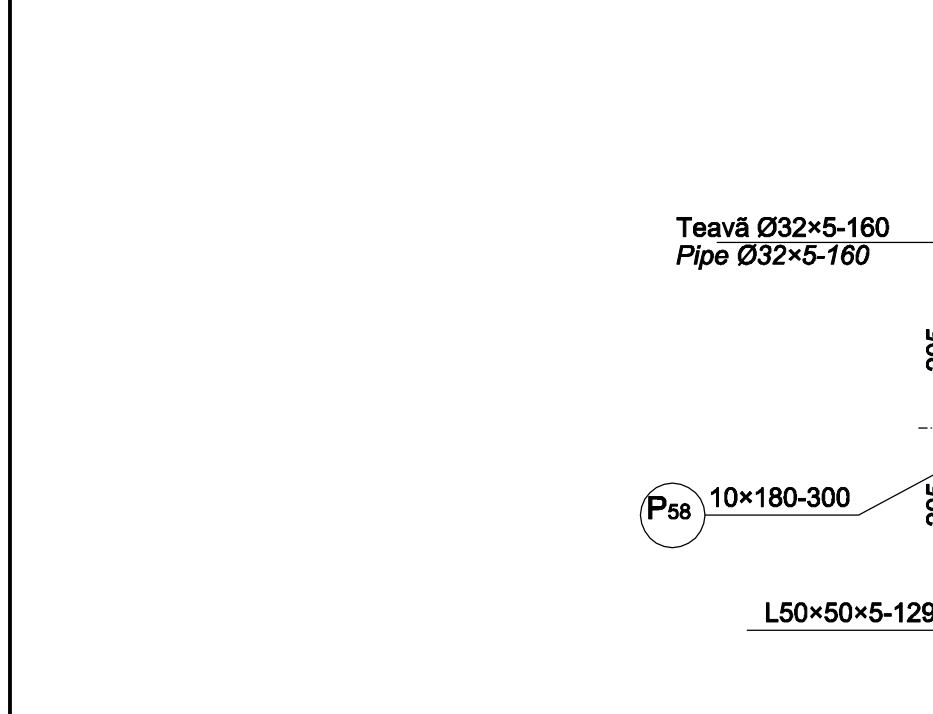
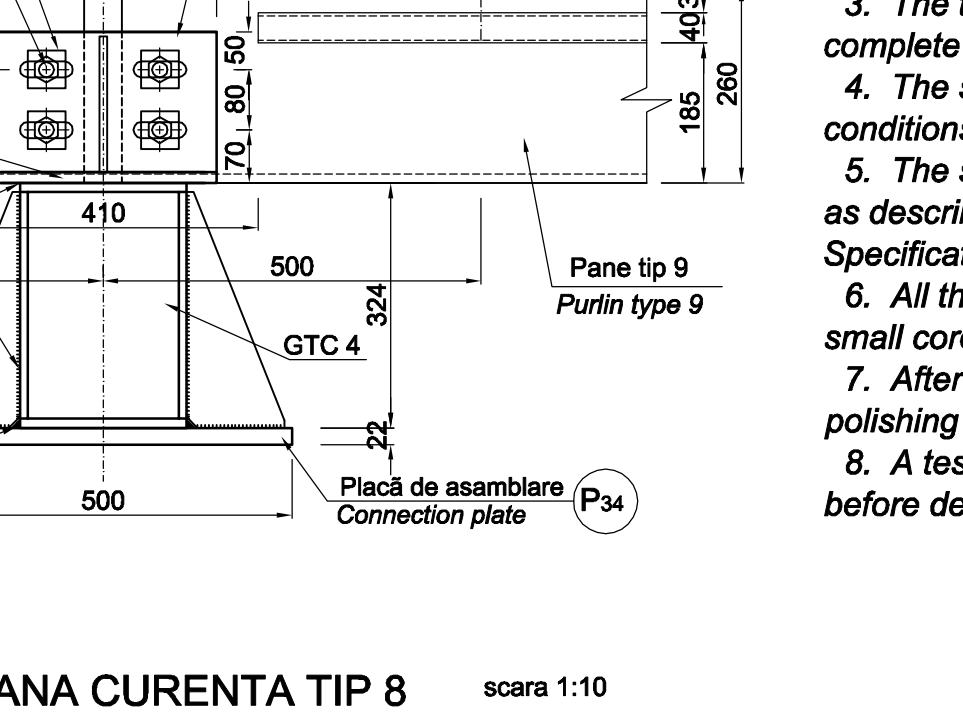
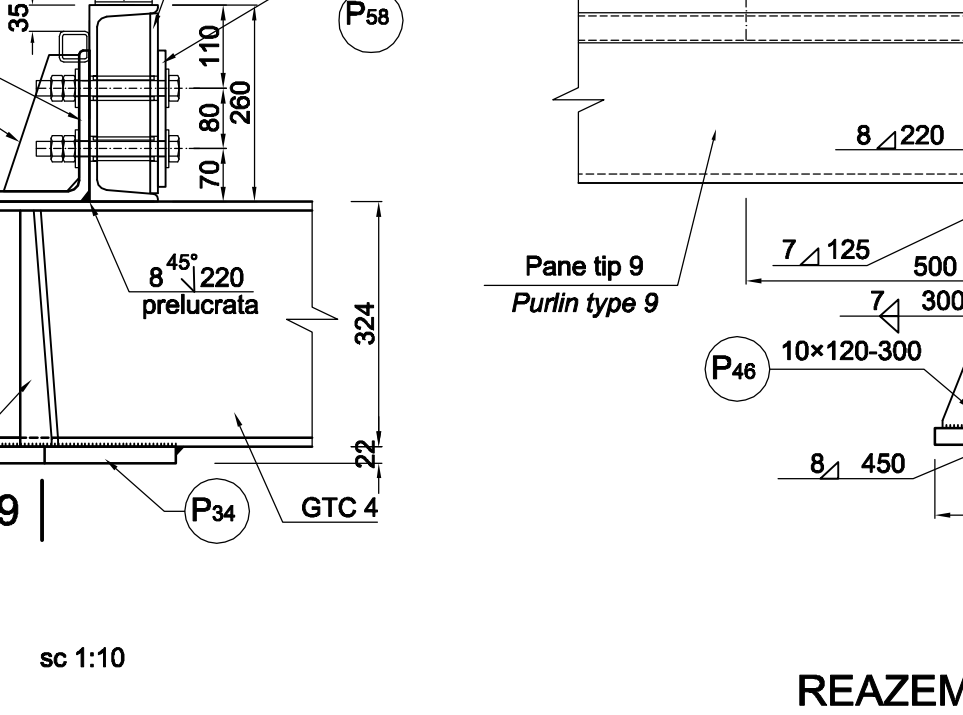
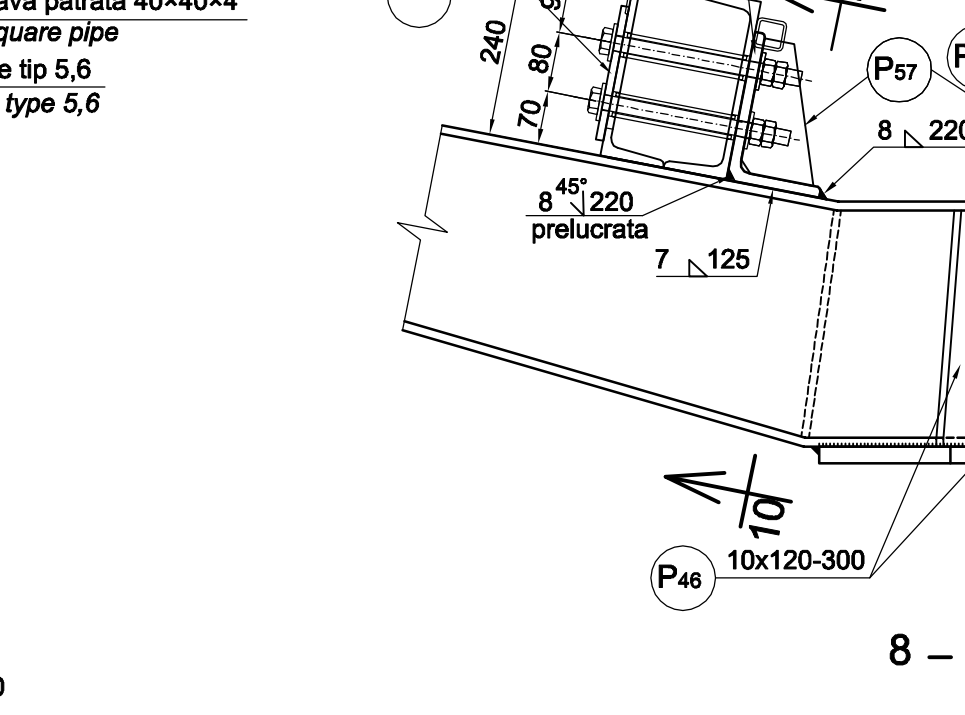
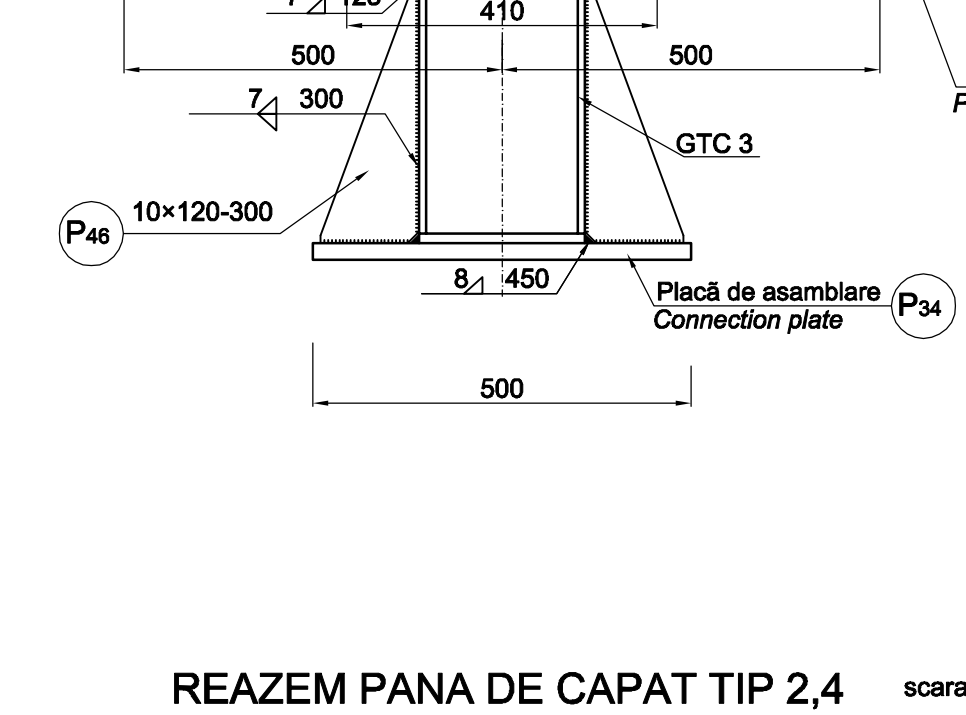
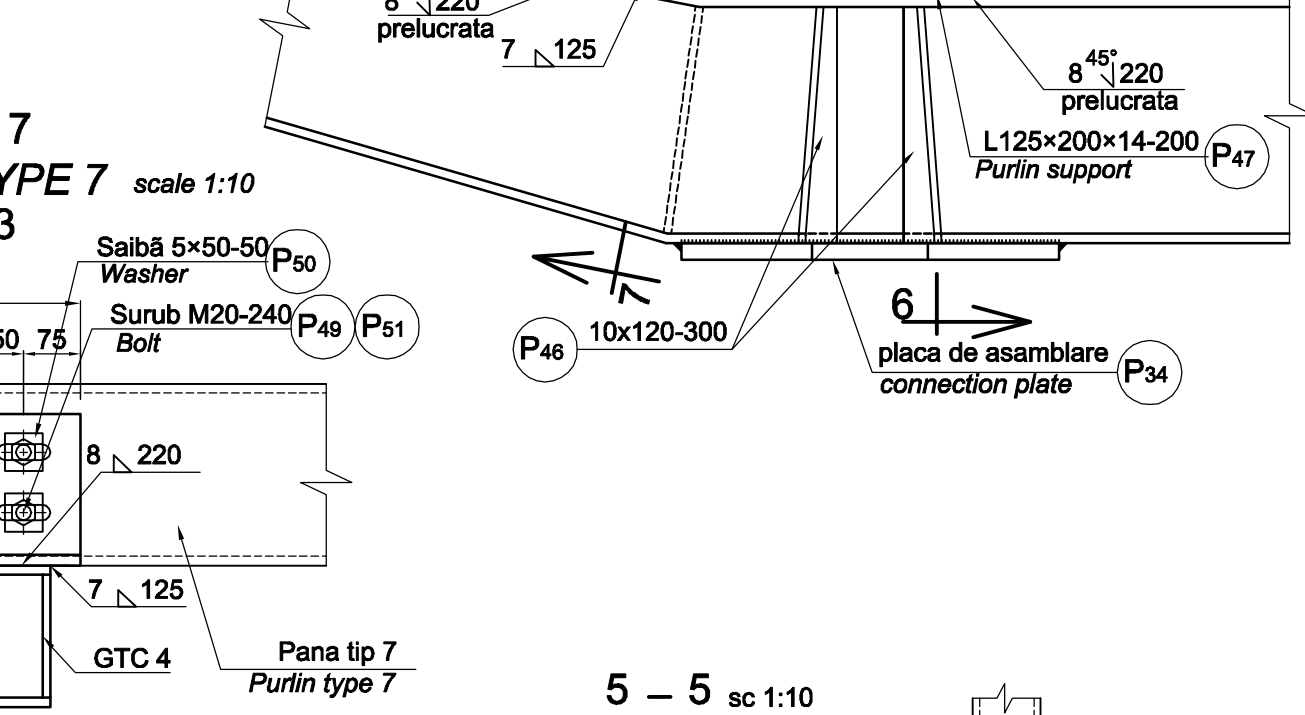
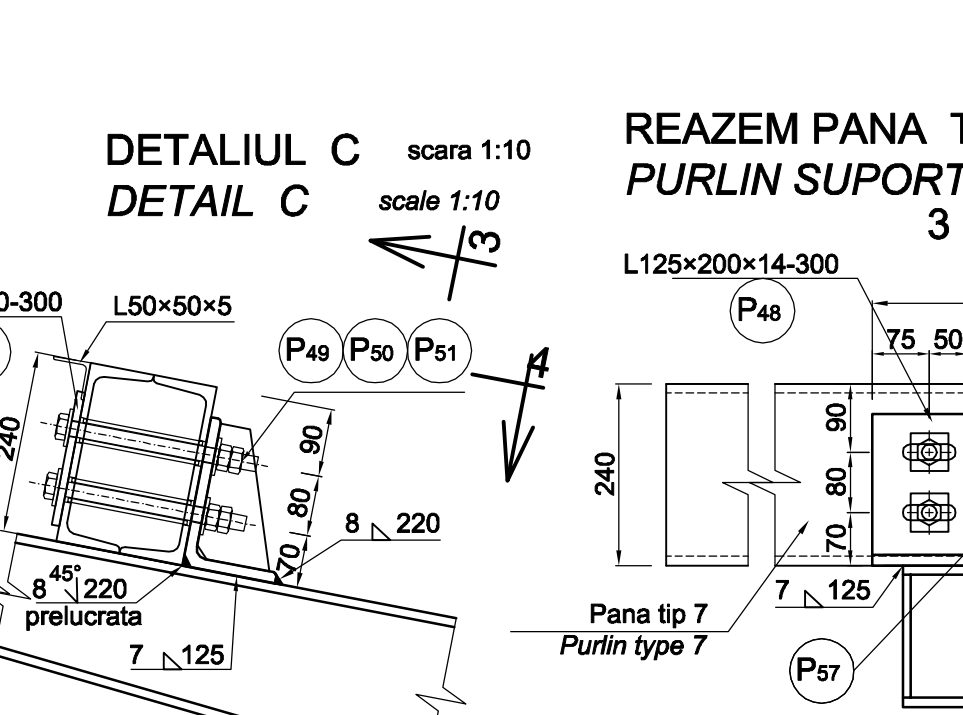
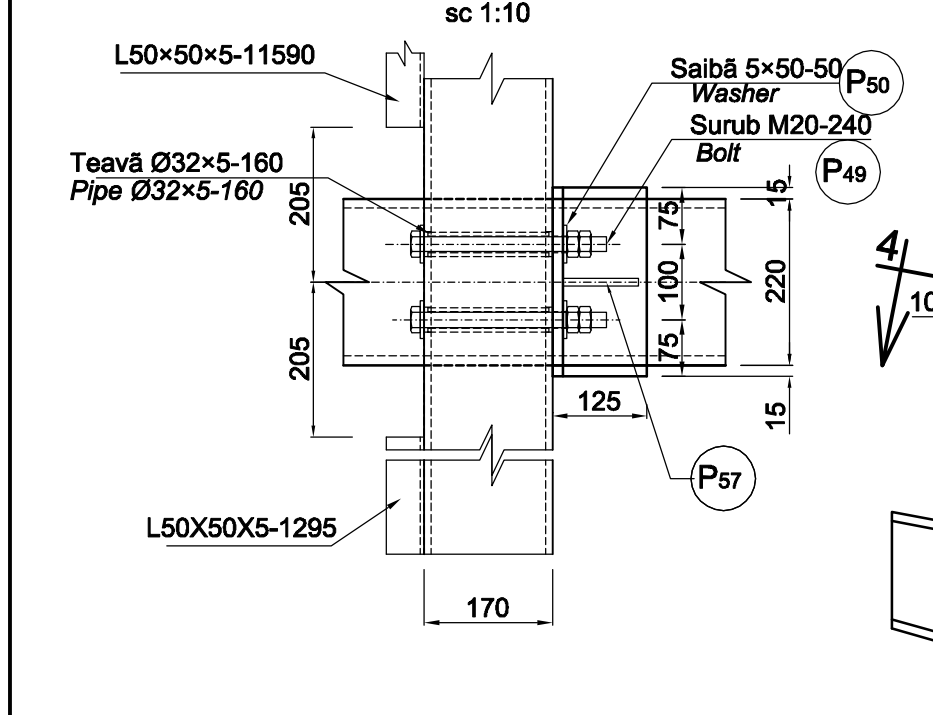
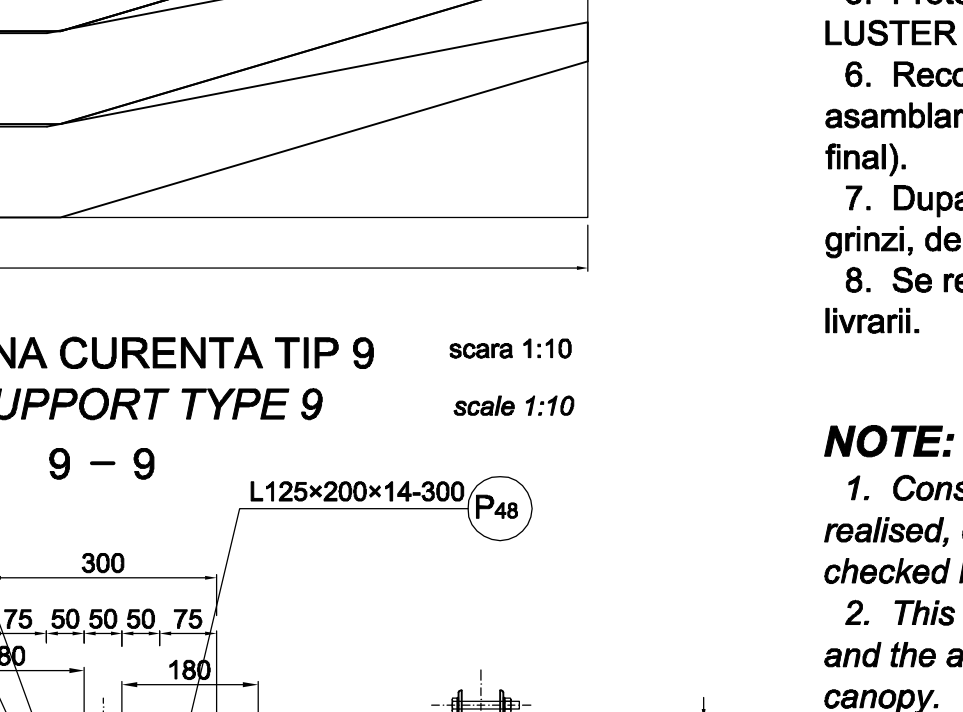
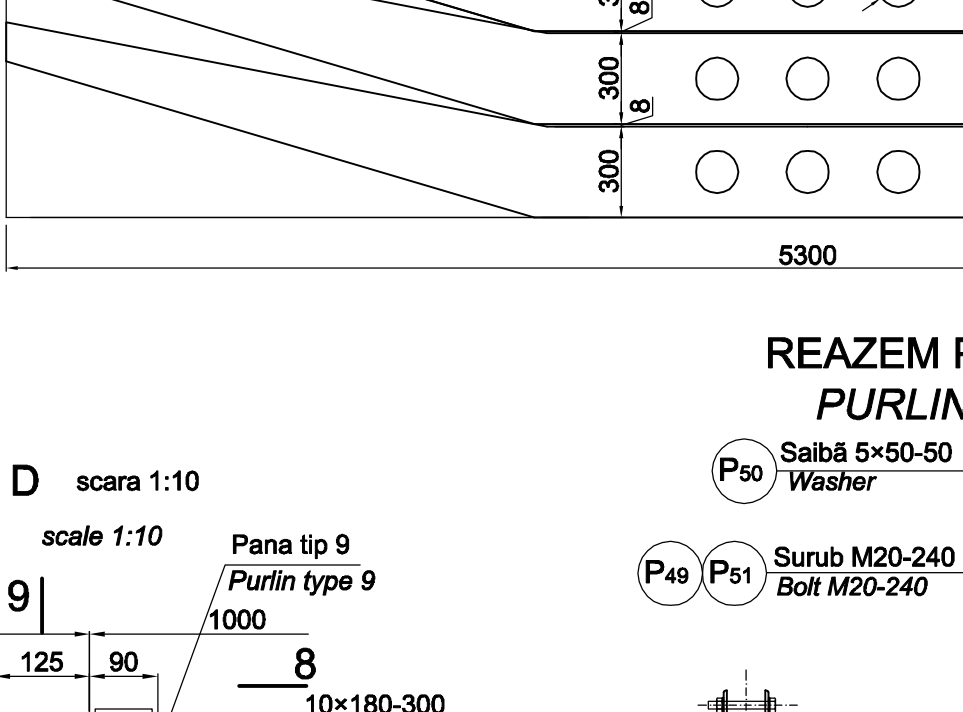
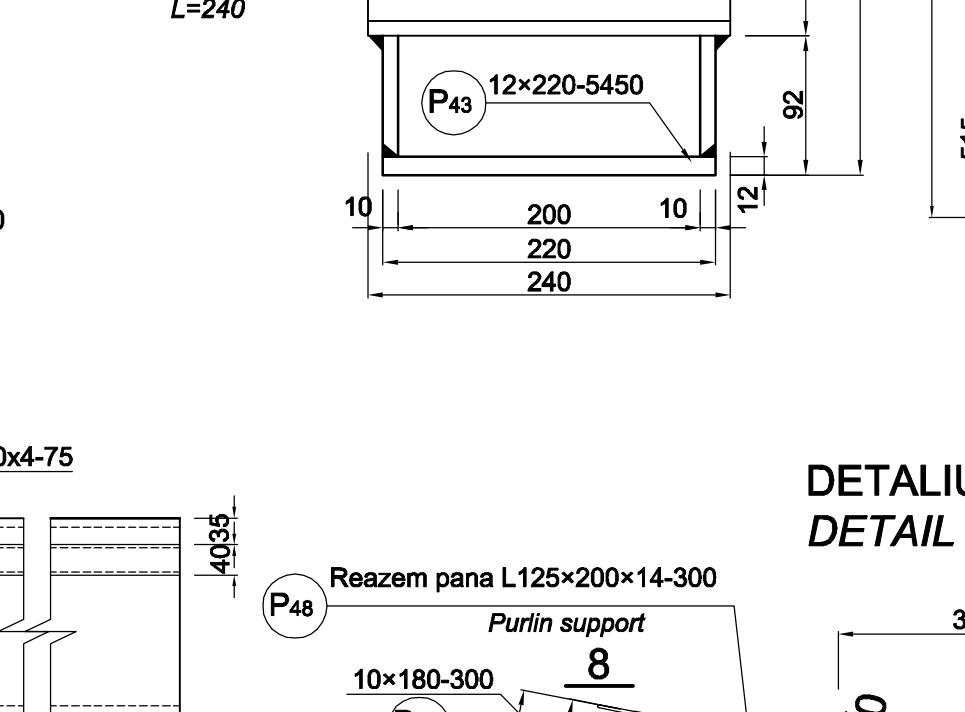
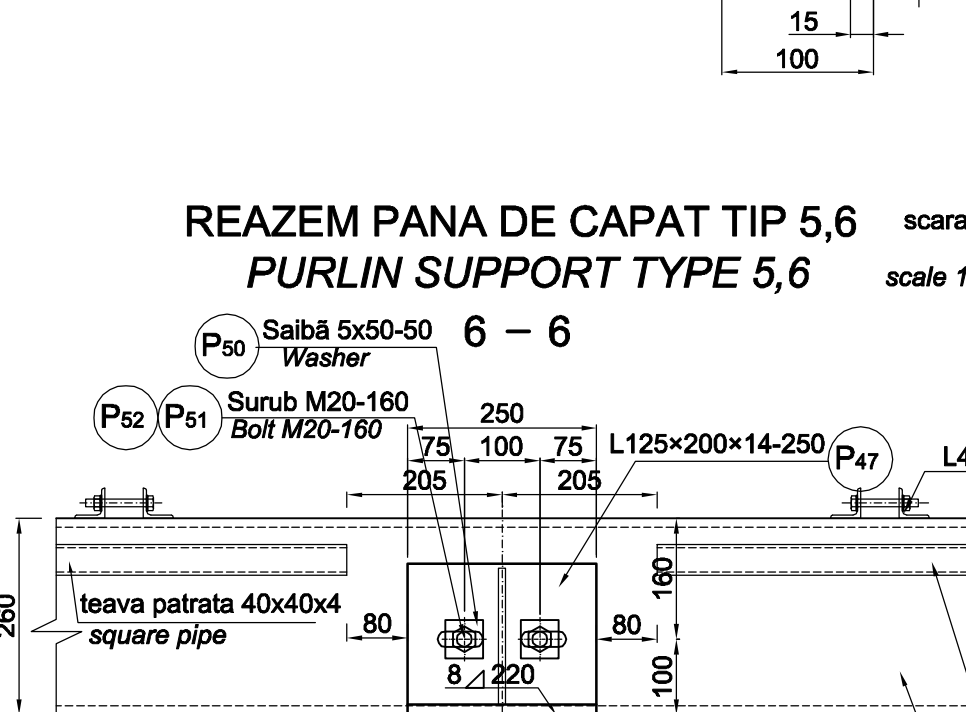
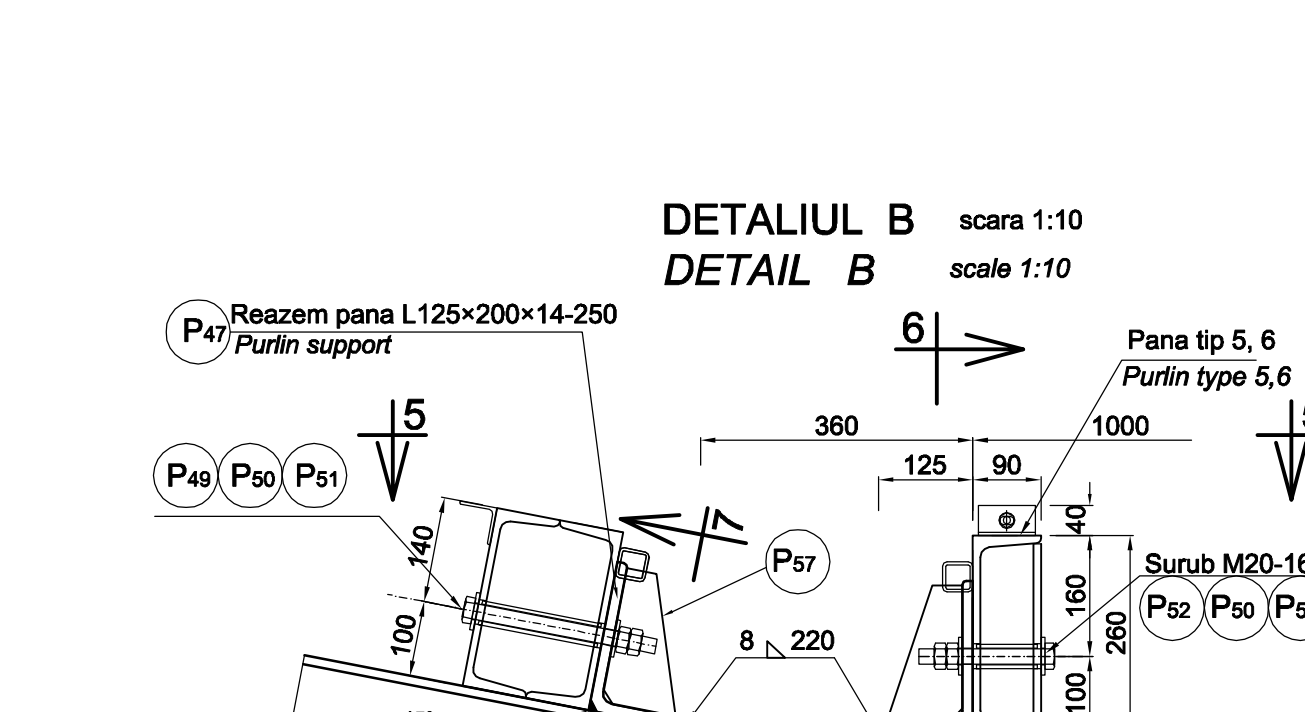
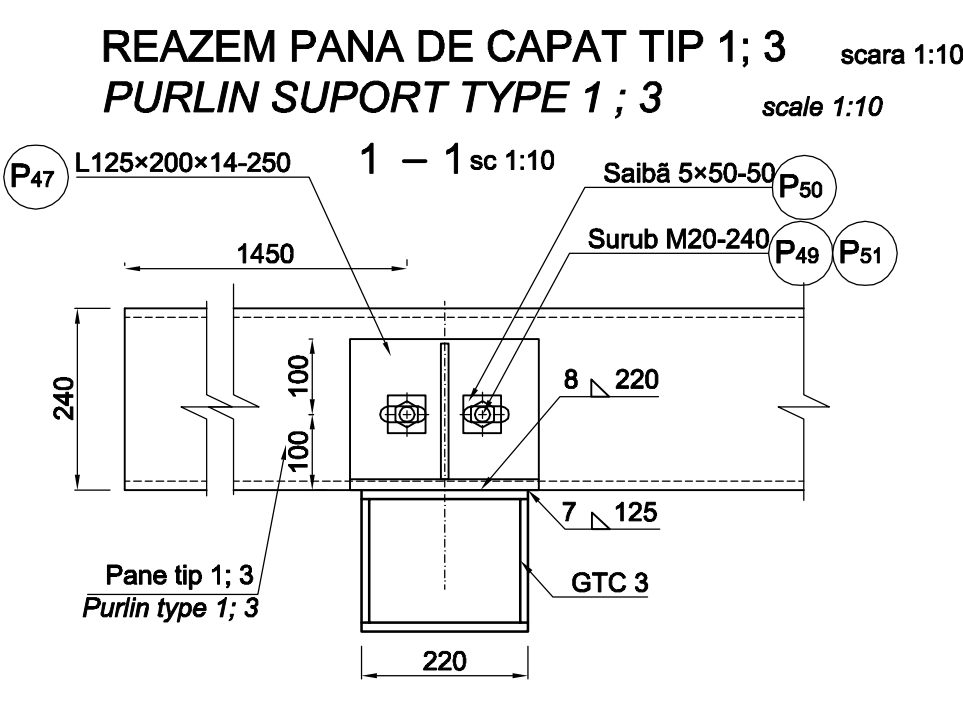
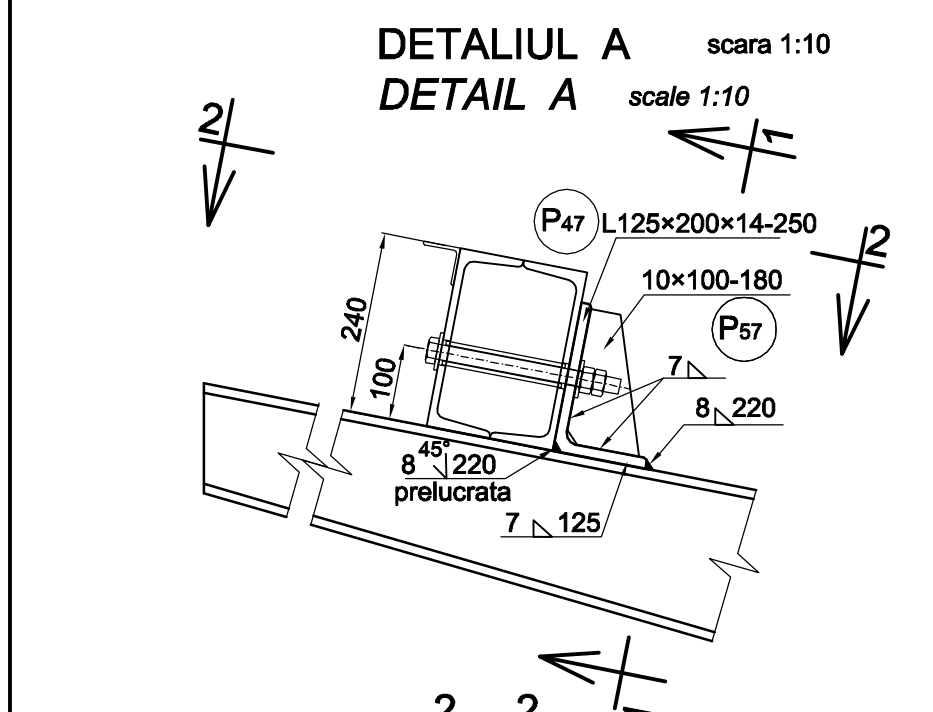
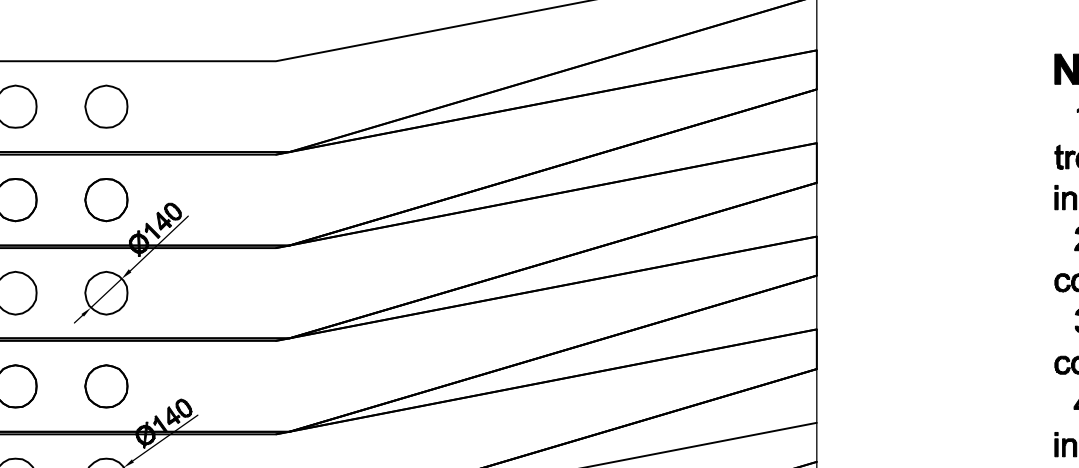
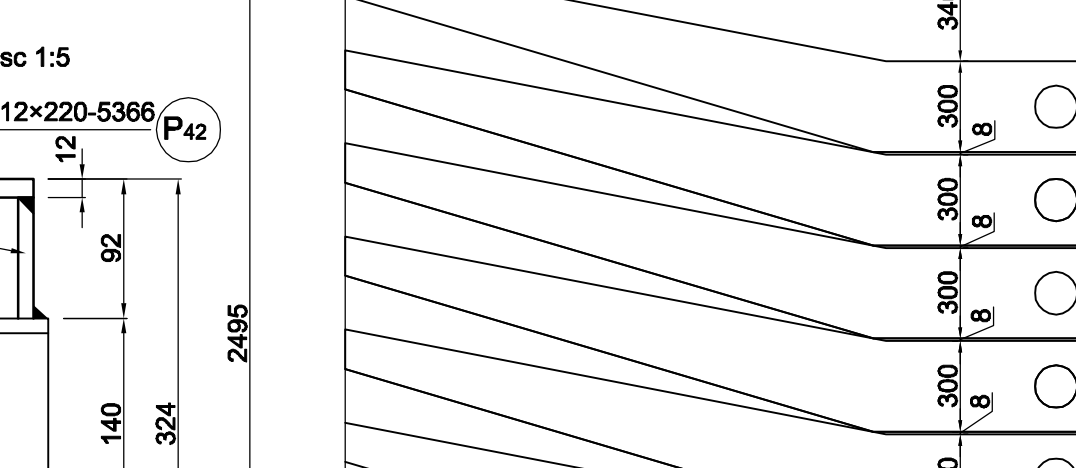
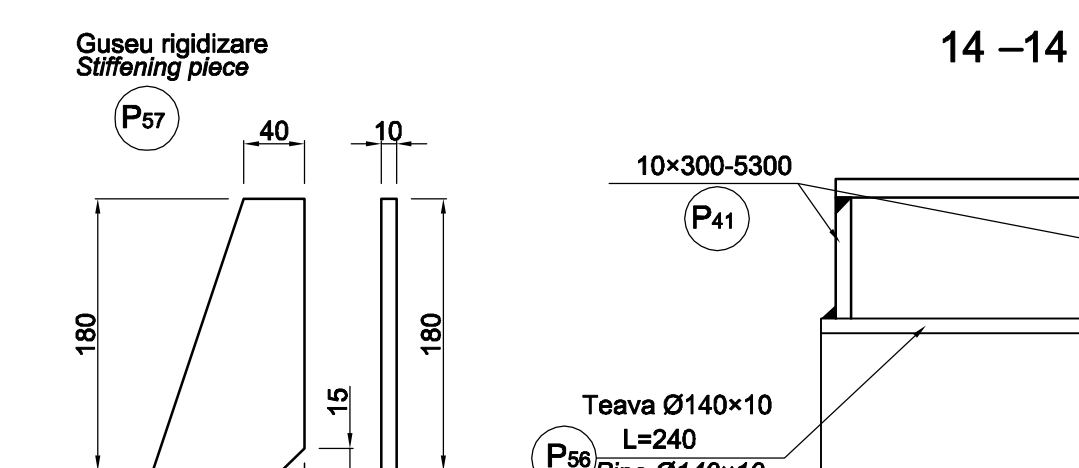
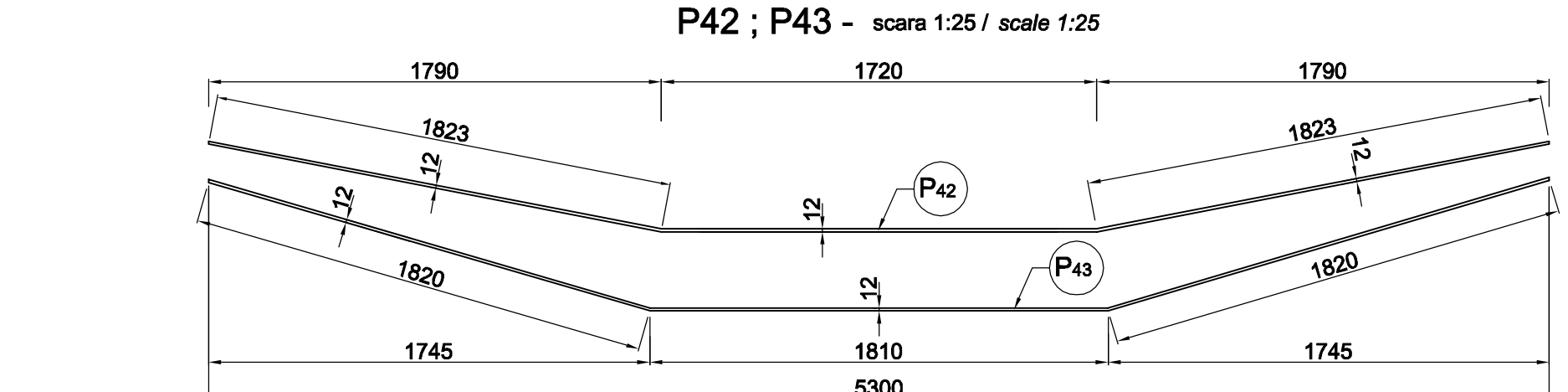
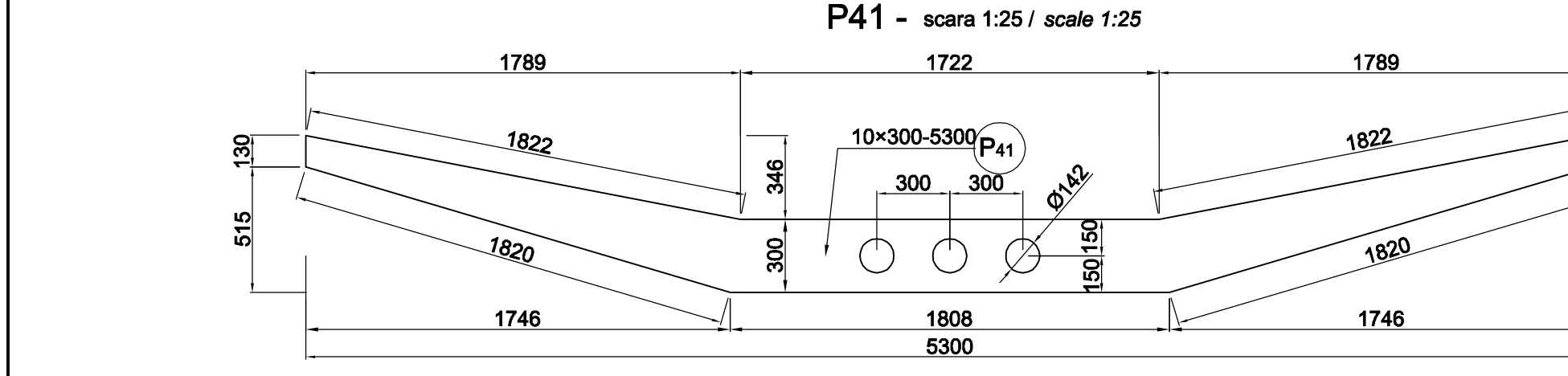
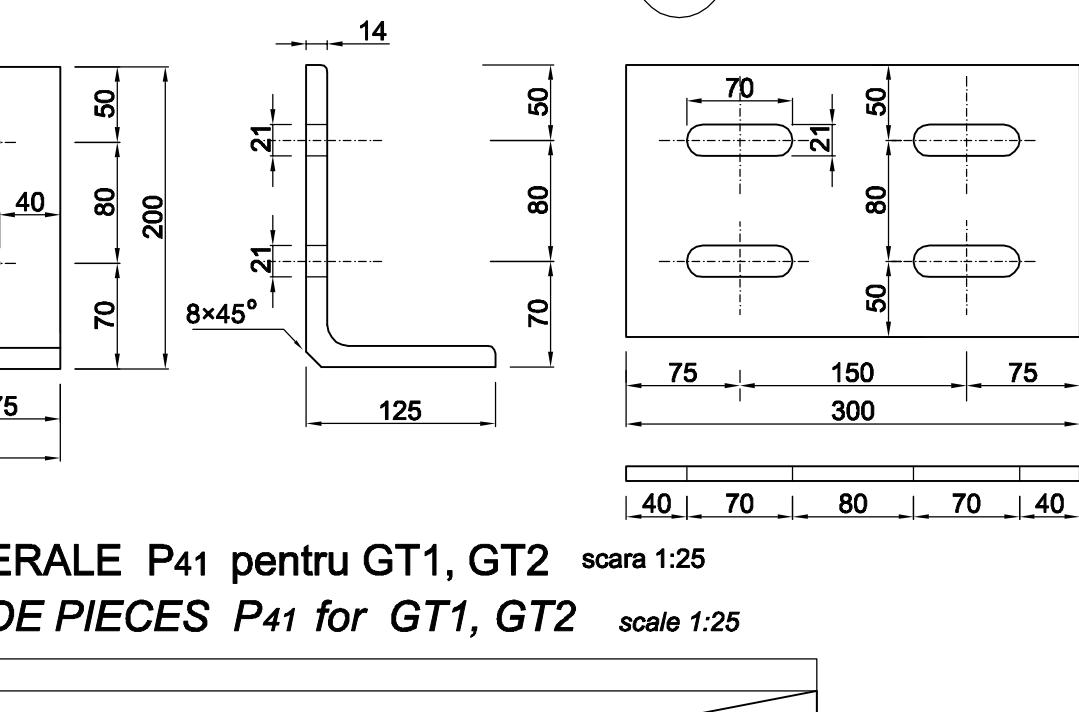
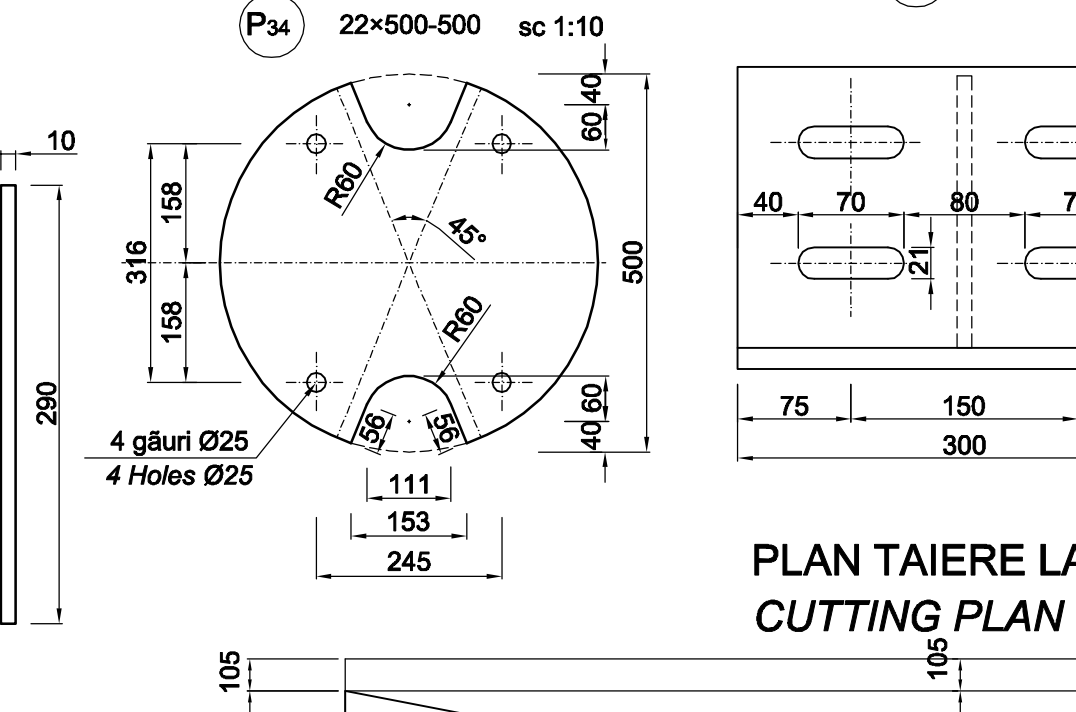
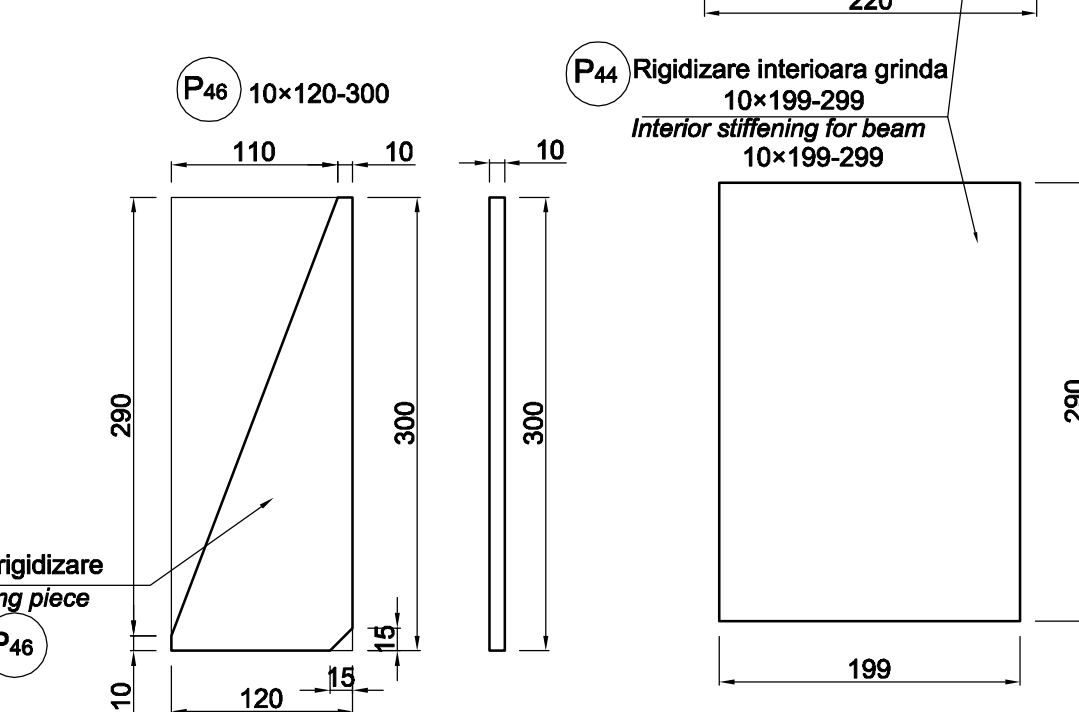
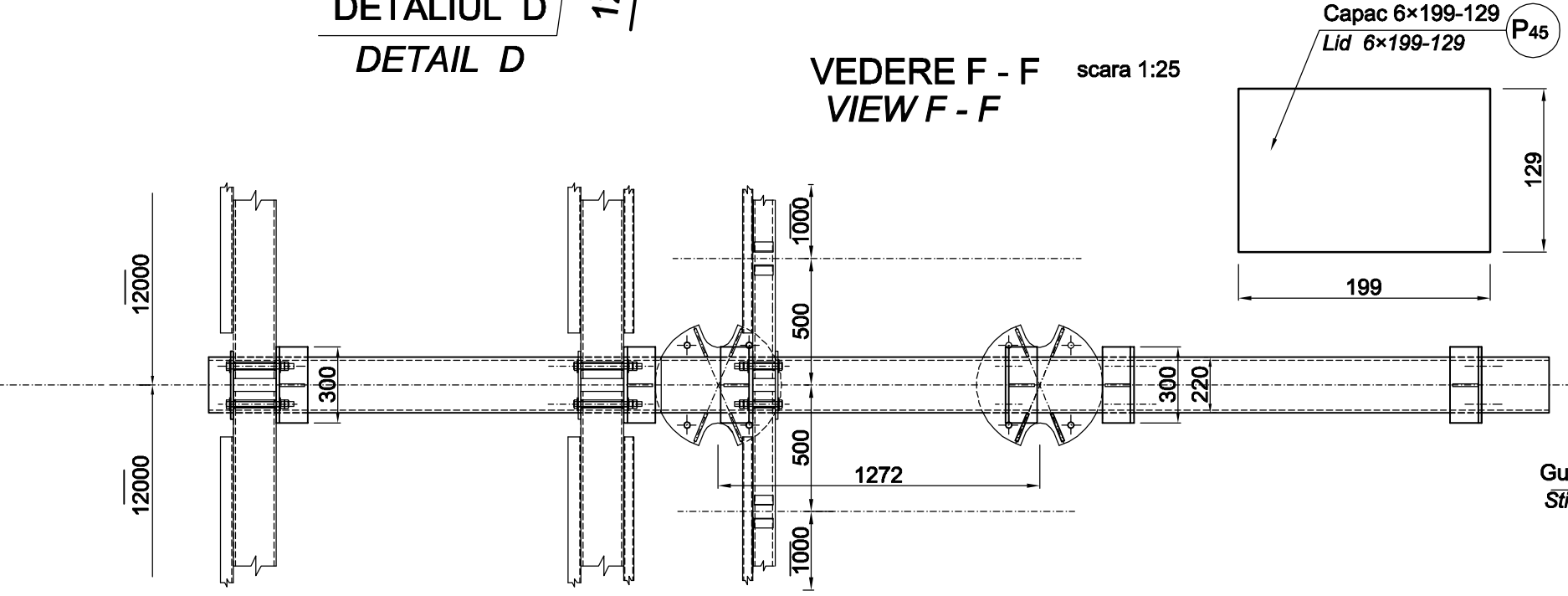
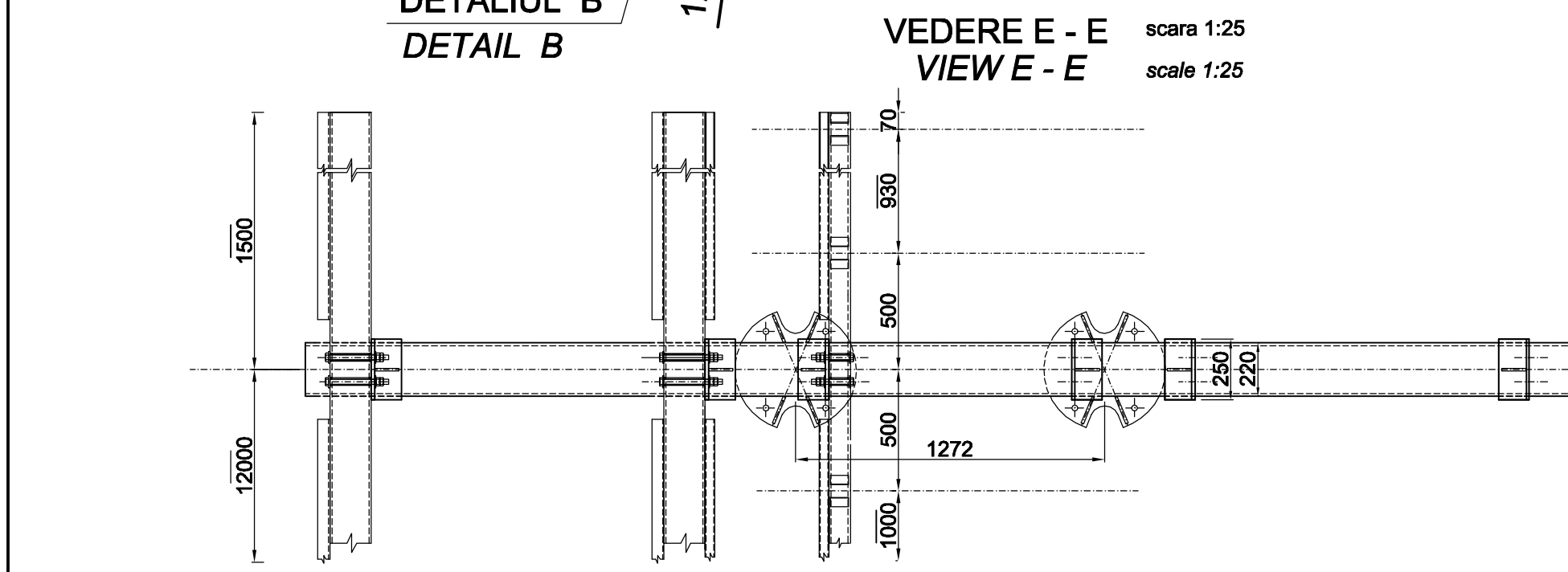

**NOTA :**

- Având în vedere numărul mare de elemente identice (grinzi transversale), care trebuie executate, se va realiza câte un element prototip complet care va fi verificat și de inginer, după care se poate trece la producția de serie.
- Acest plan se va citi corelat cu celelalte planuri ale copertinei și planurile corespunzătoare de instalații, electrice și telecomunicații.
- Grinzile transversale se vor închide etans față de pătrunderea apei prin realizarea corectă și completă a sudurilor (care au și rol de etansare).
- Confecțiile metalice vor respecta condițiile de execuție, montare și recepție precizate în "Calețul de Sarcini" al lucrării.
- Protectia confecțiilor metalice se realizează în sistem MC MIOZINC / MIOMASTIC / LUSTER conform "Calețului de Sarcini" și a specificațiilor tehnice ale producătorului.
- Recomandăm ca toate cele 3 straturi de protecție să fie aplicate în uzină, (după asamblarea elementelor structurale se pot face pe șantier doar mici corecții la stratul final).
- După recepția făcută în uzină nu se mai permite nici o intervenție asupra elementelor grinzi, de genul: găurire, sudură, tăiere, polizare, etc.
- Se recomandă asamblarea de probă în uzină a grinzii transversale cu stalpul înaintea livrării.

**NOTE:**

- Considering the great number of similar elements (transversal beams) that must be realised, one complete prototype of each element shall be carried out and shall be also checked by engineer, then they shall proceed to the series production.
- This plan shall be read in correlation with the other structural drawings of the canopy and the afferent drawings for sanitary, electrical and telecommunications installations of the canopy.
- The transversal beams shall be sealed to avoid the water penetration by correct and complete cask welding.
- The steel elements shall comply with the manufacturing, mounting and reception conditions, stipulated in the "Technical Specifications for the Work".
- The steel elements are protected by using MC MIOZINC/ MIOMASTIC/ LUSTER system as described in "Technical Specifications for the Work" and in the Manufacturer's Technical Specifications.
- All the 3 protection layers shall be applied in the plant, (after assembling the purlins, only small corrections of the final layer can be made on site).
- After the acceptance made in the plant, no intervention such as boring, welding, cutting, polishing etc. is allowed for the elements.
- A test assembling in the factory is recommended for the transversal beam and pole before delivery.

**SUDURI**  
Acolo unde nu există alte precizări, sudurile se vor realiza cu grosimea cordonului de sudură a = 0,7 mm (unde t min = cea mai mică grosime a pieselor care se sudează)

**WELDING**  
If there are no other specifications, the welding will have the welding seam a = 0,7 t min (where t min = the smallest thickness of pieces to be welded).

**MATERIALE**  
\* Laminat: S275J2G3 (OL44.3n)  
\* Șuruburi M20 grupa 6.6

**MATERIALS**  
\* Rolled elements: S275J2G3 (OL44.3n)  
\* Bolts M20 resistance group 6.6

**OBSERVAȚIE :**

- Grinzile transversale de tip GTC, se vor folosi la copertinele perconale în curba.
- Pentru poziția, tipul, și numărul lor în cadrul copertinelor, vezi PLAN DISPOZIȚIE GENERALĂ COPERTINE (revizuit) ale fiecărei stații (după caz).

**REMARK :**

- The GTC type transversal beams, will be used for the platform canopies in curve.
- As regards the position, type, and number of GTC beams for each canopy, see the CANOPY GENERAL ASSEMBLY PLAN (reviewed) for each station (dependonng the case)

Index	Date	Modificarea	Proiectant	Aprobat	Consultant	Aprobat
Index	Date	Modification/Revision	Designer	Approved	Approved Consultant	Approved CFR

GUVERNUL ROMÂNIEI ROMANIAN GOVERNMENT  
PROIECT FINANȚAT DE UNIUNEA EUROPEANĂ EUROPEAN UNION FINANCED PROJECT

CLIENT / CLIENT  
C.N.C.F. "C.F.R." - S.A.

Consultant / Consultant	Data	Semnătură
Approved Project manager	R. Liuzzi	12.2011
Approved Architect	C. Gambelli	12.2011
Verified Checked	Giuseppe Fioravanti	12.2011

SUBCONTRACTANT / SUBCONTRACTOR  
Reabilitarea liniei de cale ferată Brașov - Simeria, parte componentă a coridorului IV Pan European, pentru circulația trenurilor cu viteză maximă de 160 km/h, Transonul : Brașov - Sighișoara  
Rehabilitation of the railway line Brașov - Simeria, component Part of the IV Pan-European Corridor, for the trains circulation with maximum speed of 160 km/h, Section : Brașov - Sighișoara  
Project/Project 2004/RO/16/PPA003  
Faza / Phase: D.E. / E.D.

Denumire desen / Drawing Title :  
COPERTINE : GRINZI TRANSVERSALE TIP GTC3, GTC4 - DETALII DE EXECUȚIE  
CANOPY : TRANSVERSAL BEAMS TYPE GTC3, GTC4 - DETAILS

Codificare / Codification System	Scara / Scale	LOT / LOT	Nr. / No
	1:25, 1:10, 1:5		01/01
E A 5 1	0 1	E 0 0	B Z C C 0 0 0 3 0 0 6 1