

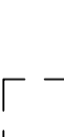



- LEGENDA / LEGEND**
-  ZIDARIE EXISTENTA / EXISTING MASONRY
 -  UMLERI GOLUR (PARTER) / MASONRY FILLING (GROUND FLOOR)
 -  ZIDURI NOI RIGIPS 10 cm GROS. / NEW RIGIPS WALLS 10 cm WIDTH
 -  FUNDATII EXISTENTE / EXISTENT FOUNDATIONS



PLAN FUNDATII - CONSOLIDARE sc. 1 : 50
FOUNDATIONS PLAN - CONSOLIDATION

BETON ARMAT C16/20
OTEL BETON OB37, PC52

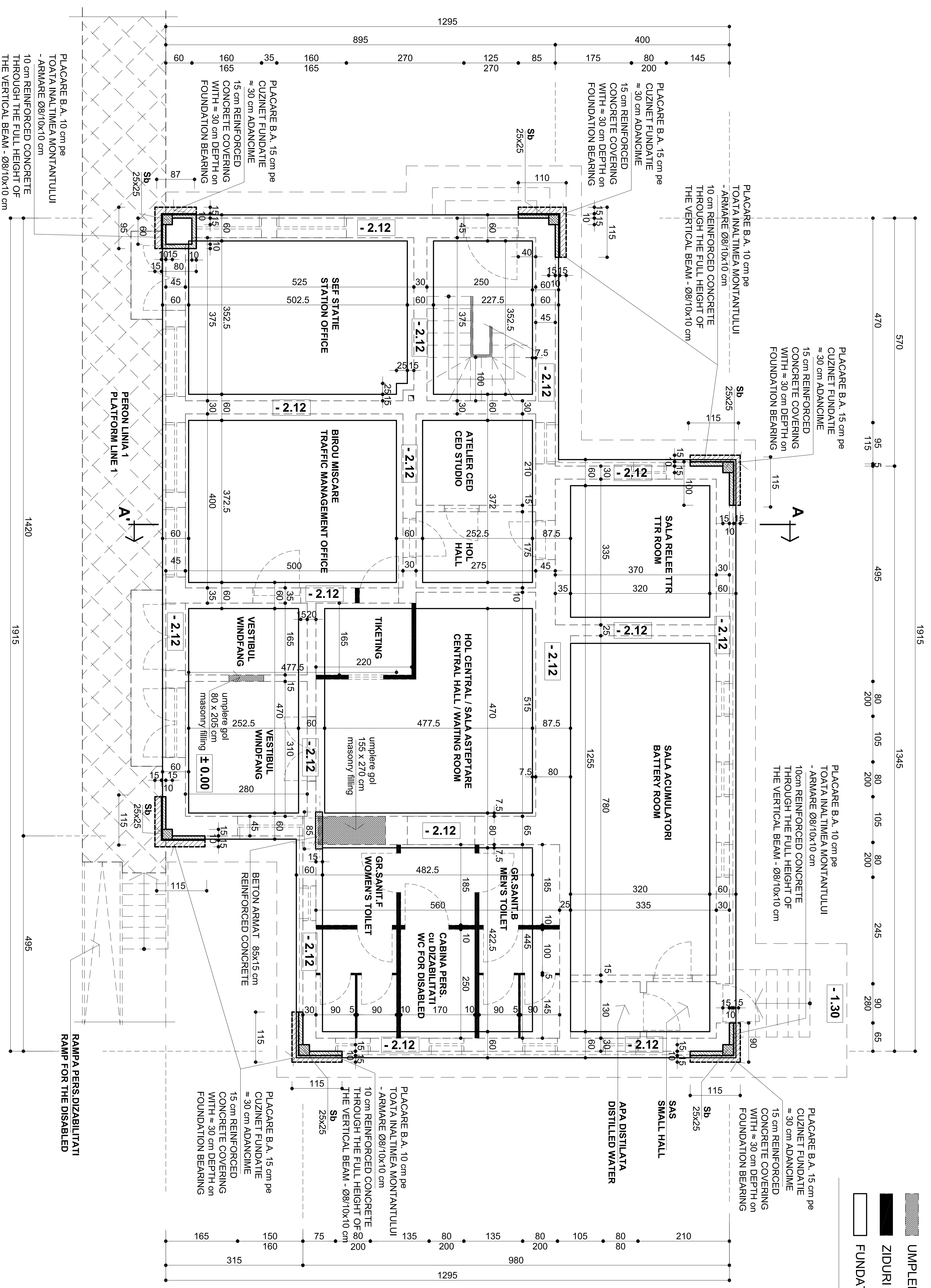
Denumire desen / Drawing Title :	STATTIA C.F. STUPINI/ RAILWAY STATION STUPINI		
Proiectant / Designer :	CLADIRE DE CALATOR I / MAIN BUILDING		
PLAN FUNDATII - CONSOLIDARE/FOUNDATION PLAN - REINFORCEMENT	Scara / Scale	1:20	LOT/LOT
Codificare / Codification System	E A 5 1	0 1	E 0 3 B B C C 0 0 1 1 0 1 9 0

Author	Self project	R. Lutzza	Date	12.2011
Approved	Project manager	C. Garmhall	Signature	
Approved	Coordinator Section 1	Giuseppe Fioravanti	Date	01/01
Approved	Section 1 Coordinator			
Approved	Expert Chief			
Overseer	Key Expert			

Author	Responsible Supervisor	A. Standu - Dinulescu	Date	12.2011
Approved	Supervisor Responsible			
Approved	Designer	Arca Rus		

Reabilitarea liniei de cale ferata Brasov - Sibiu, parte componenta a coridorului IV Pan European, pentru circulatia trenurilor cu viteza maxima de 160 km/h.
Tronsoani : Brasov - Sighisoara
 Rehabilitation of the railway line Brasov - Sibiu, component Part of the IV Pan-European Corridor, for the trains circulation with maximum speed of 160 km/h.
Section : Brasov - Sighisoara

CLIENT / CLIENT

GUVERNUL ROMANIEI
ROMANIAN GOVERNMENT

PROIECT FINANATAT DE UNIUNEA EUROPEANA
EUROPEAN UNION FINANCED PROJECT

C.N.C.F. "C.F.R." - S.A.