

B - B
SECTIUNE LONGITUDINALA PRIN RAMPA ACCES PERON
ACCESS RAMP PLATFORM - LONGITUDINAL SECTION

SCARA 1:25

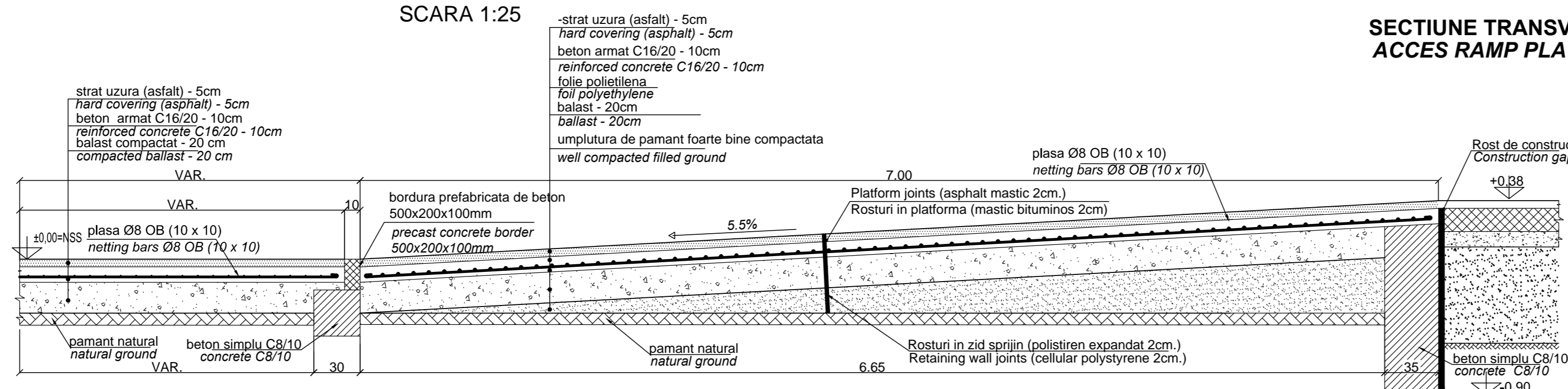

C - C
DETALIU TROTUAR PERON
PLATFORM SIDEWALK DETAIL

SCARA 1:25

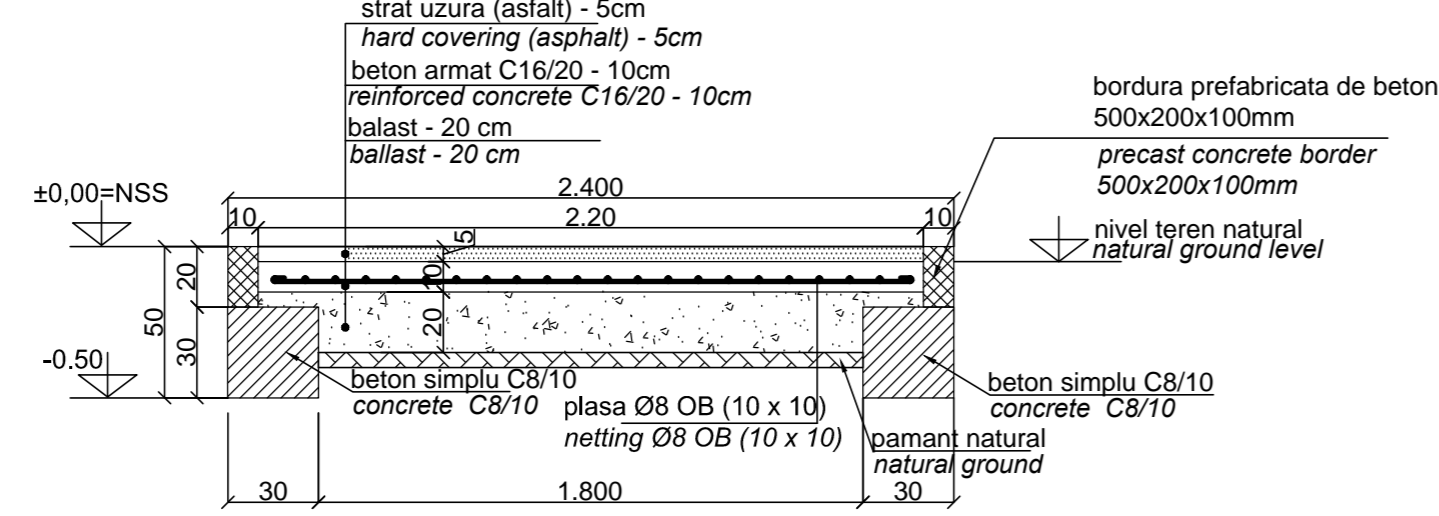

A - A
SECTIUNE TRANSVERSALA RAMPA ACCES PERON
ACCESS RAMP PLATFORM - CROSS SECTION

SCARA 1:25

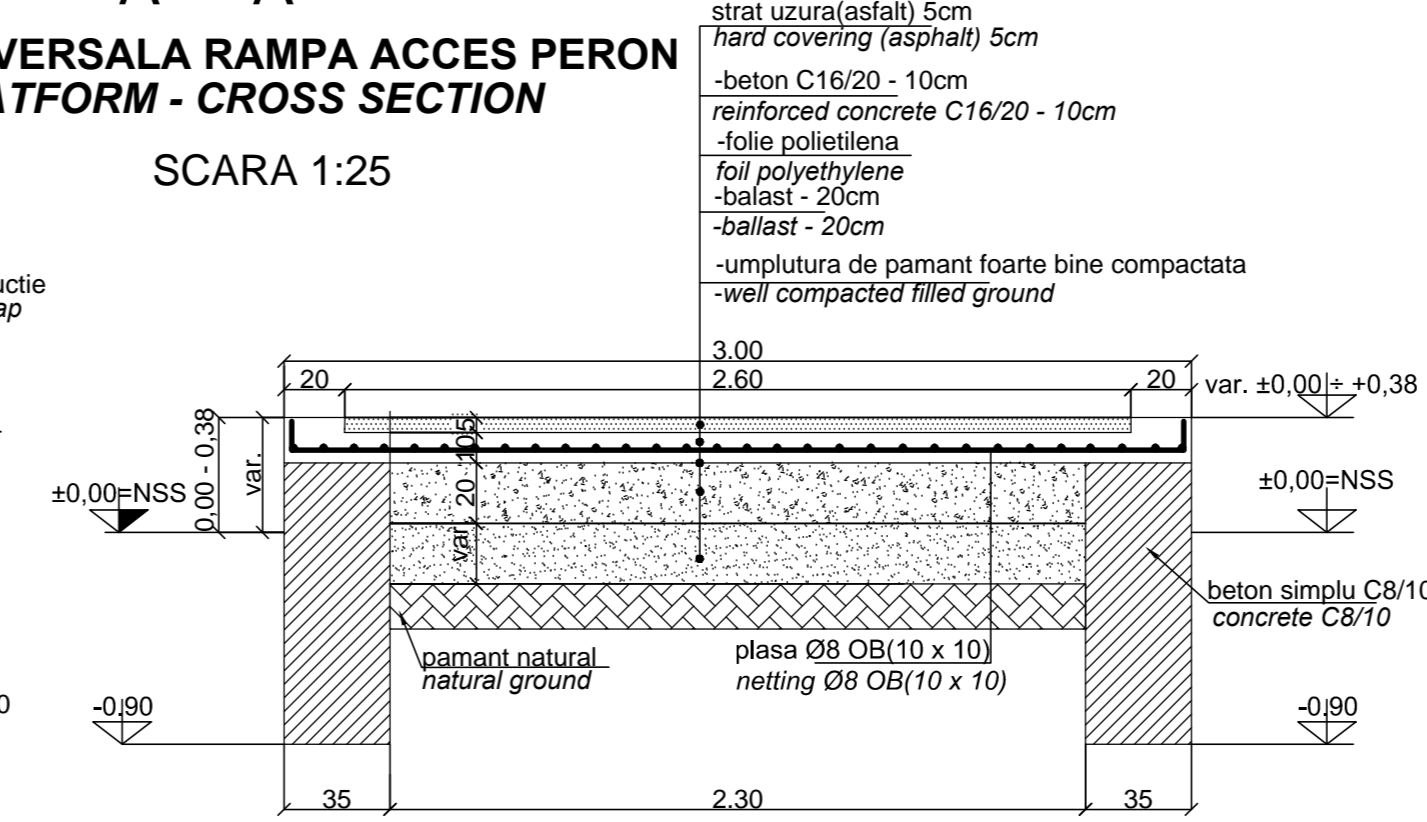

Extras armatura OB37:

25,00 mp x 20ml/mp x 0,394 kg/ml = 200 kg
380,00 mp x 20ml/mp x 0,394 kg/ml = 3000 kg

Se va citi impreuna cu planul de dispozitie generala a peroarelor.
Will be read with general layout platform.

NIVEL DE REFERINTA ±0.00 ≡ N.S.S.

Beton armat : C 16 / 20 - P4-T3-IIA-SR32.5
Beton simplu : C8/10
Orel beton : OB 37

D					
C					
B					
A					

Index	Data	Modificari	Proiectant	Approbat Consultant	Approbat CFR
		Modification/Revision	Designer	Approved Consultant	Approved CFR

GUVERNUL ROMANIEI
 ROMANIAN GOVERNMENT

PROIECT FINANȚAT DE UNIUNEA EUROPEANĂ
 EUROPEAN UNION FINANCED PROJECT

C.N.C.F. "C.F.R." - S.A.

CLIENT / CLIENT

CONSULTANT / CONSULTANT		Data	Semnatura
Approbat	Self project	R. Liuzza	
Approved	Project manager	12.2011	
Approved	Coordinator/Section 1	C. Gambelli	12.2011
Approved	Section 1 Coordinator		
Checked	Verifier	Giuseppe Fioravanti	12.2011
Checked	Verifier		

SUBCONTRACTANT / SUBCONTRACTOR		Data	Semnatura
Approbat	Responsabil Subcontractant	A.Stanciu - Dinulescu	12.2011
Approved	Subcontractant Responsible		
Elaborat	Designer	Georgescu Georgiana Adina	12.2011
Elaborated	Designer		

Reabilitarea liniei de cale ferata Brasov - Simeria, parte componenta a coridorului
 IV Pan European, pentru circulatia trenurilor cu viteza maxima de 160 km/h,
Tronsoanel : Brasov - Sighisoara
 Rehabilitation of the railway line Brasov - Simeria, component Part of the IV Pan-European
 Corridor, for the trains circulation with maximum speed of 160 km/h,
Section : Brasov - Sighisoara

Project/Project
 2004/RO/16/PPA/003
 Faza / Phase:
 D.E./E.D.

Denumire desen / Drawing Title :
RRAMPE SI DETALIU TROTUAR PERON HALTA ROTBAV -
ROTBAY FLAG STATION RAMPS AND PLATFORM SIDEWALK DETAIL

Codificare / Codification System	Scara / Scale	LOT / LOT	No. / No
	1:25		01 / 01

E	A	5	1	0	1	E	0	8	P	Z	C	C	0	0	1	2	0	0	4	1
---	---	---	---	---	---	---	---	---	---	---	---	---	---	---	---	---	---	---	---	---