

**PLAN POSTAMENT PENTRU SEPARATOR SEDIMENTE
PLATFORM PLAN FOR SEDIMENT SEPARATOR**

Scara / Scale 1:25

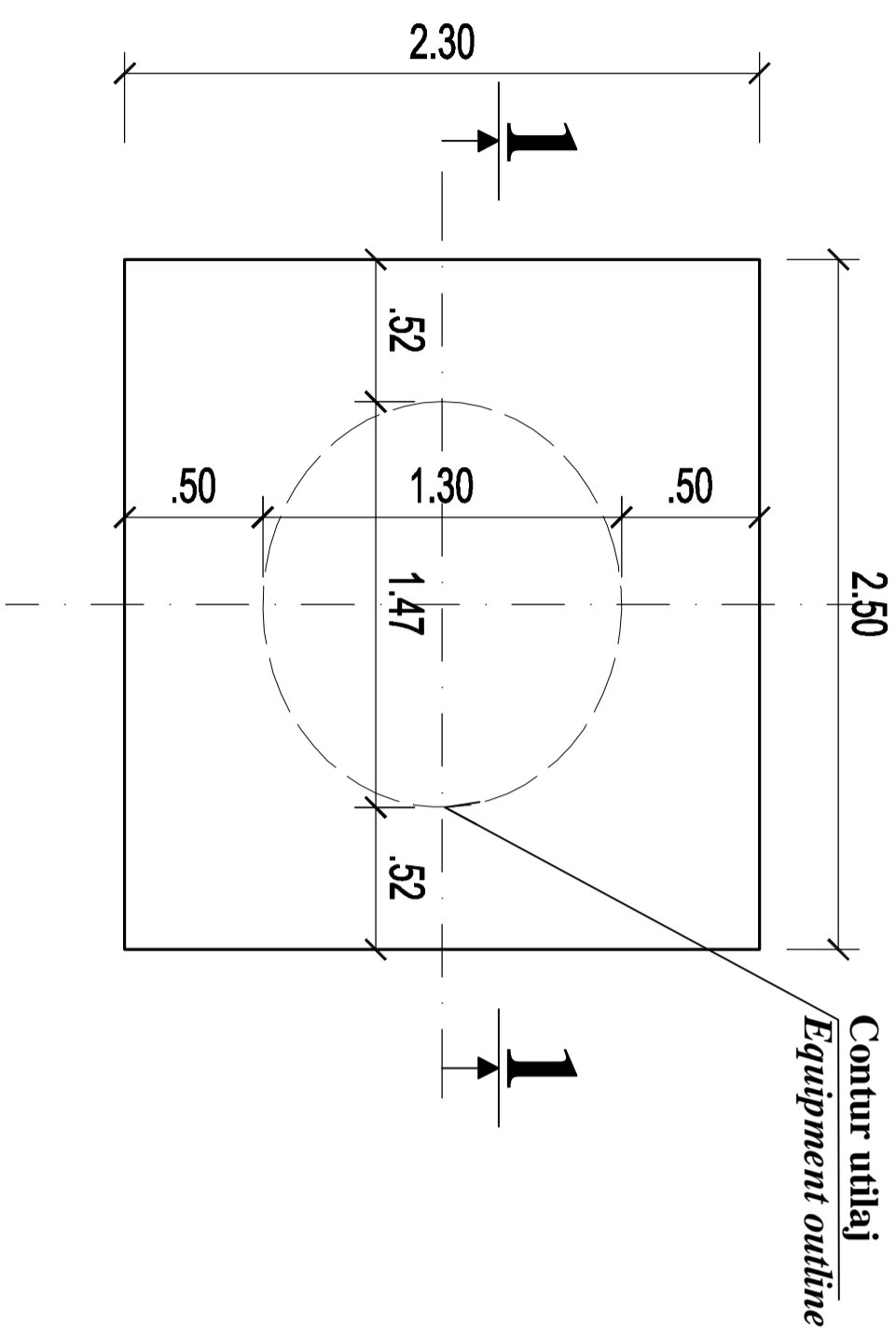

CARACTERISTICI / CHARACTERISTICS

- Clasa de importanta / *Importance class* (P100/1 - 2006) ---- "III"
- Categoria de importanta / *Importance category* (HG 766 - 1997) ---- "C"
- Seism / *seism* ---- " $a_g = 0,20$ "; " $T_c = 0,7 \text{ sec}$ "

SECTIUNEA / SECTION "1" - "1"

Scara / Scale 1:25

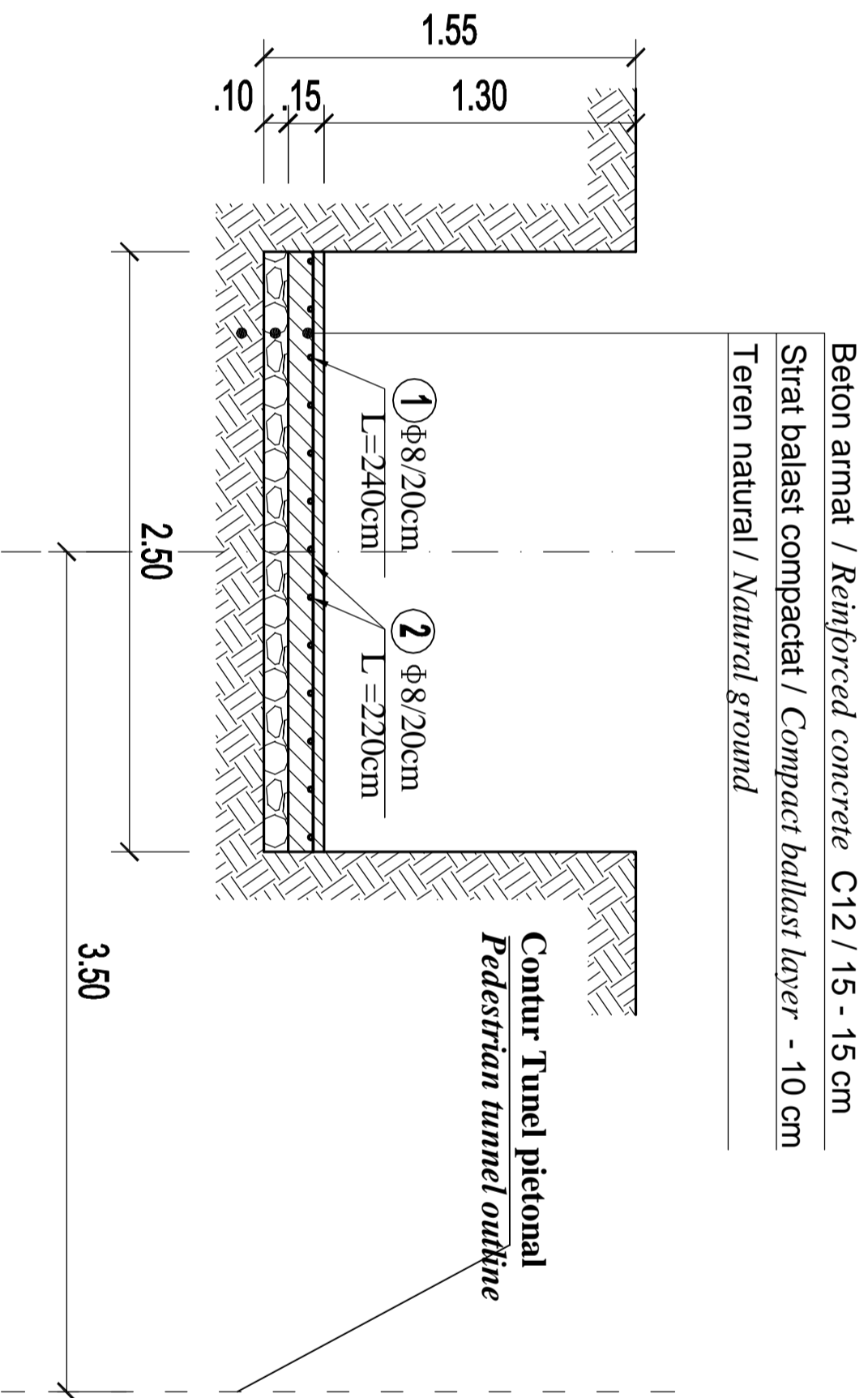

MATERIALE

BETON SIMPLU: C 6/7.5
OTEL BETON : PC52
Acoperirea cu beton a armaturilor de rezistență : c = 4.5 cm.

MATERIALS

CONCRETE : C 6/7.5
REINFORCEMENT : PC52
STEEL : S235J2G3 (OL37.2n)
Concrete covering of the main reinforcing bars : c = 4.5 cm.

EXTRAS ARMATURA - BILL OF REINFORCEMENT

Marca	Φ	buc	lung (m)	PC 52 Φ 8
	1	8	2.40	33.60
	2	8	2.20	28.60
Total m/Φ				62.20
Kg/ m/Φ				0.395
Kg/Φ				24.569
TOTAL Kg				24.57

Index	Date	Modificare / Revision	Proiectant / Designer	Approbat Consultant / Approved Consultant	Approbat CFR / Approved CFR
D					
C					
B					
A					

GUVERNUL ROMANIEI
ROMANIAN GOVERNMENT

PROIECT FINANȚAT DE UNIUNEA EUROPEANĂ
EUROPEAN UNION FINANCED PROJECT

C.N.C.F. "C.F.R." - S.A.

CLIENT / CLIENT

ITALFERA
GRUPPO FERROVIE DELLO STATO
Joint Venture leader

Scott Wilson

OBERMEYER
PLANEN + BERATEN GmbH

TECNIC
Consulting Engineers

CONSULTANT / CONSULTANT

Approbat / Approved	Șef proiect / Project manager	Data / Date	Semnătură / Signature
Approbat / Approved	R. Luizza	12.2011	[Signature]
Approbat / Approved	Coordonator Secțiune 1 / Section 1 Coordinator	12.2011	C. Gambelli
Verificat / Checked	Verificator / Verifier	12.2011	Giuseppe Fioravanti

SUBCONTRACTANT / SUBCONTRACTOR

Approbat / Approved	Responsabil / Subcontractant	Data / Date	Semnătură / Signature
Approbat / Approved	A. Stanciu - Dinulescu	12.2011	[Signature]
Elaborat / Elaborated	Proiectant / Designer	12.2011	Andreea Staicu

Reabilitarea liniei de cale ferată Brașov - Simeria, parte componentă a coridorului IV Pan European, pentru circulația trenurilor cu viteză maximă de 160 km/h, Tomsonul : Brașov - Sighișoara

Rehabilitation of the railway line Brașov - Simeria, component Part of the IV Pan-European Corridor, for the trains circulation with maximum speed of 160 km/h, Section : Brașov - Sighișoara

Proiect/Project: 2004/RO/16/RF/PA/003
Faza / Phase: D.E. / E.D.

Denumire desen / Drawing Title :
HALTA ROTBAV - POSTAMENT PENTRU SEPARATORUL DE SEDIMENTE
LA TUNELULUI PIETONAL
FLAG STATION ROTBAV - SEDIMENT SEPARATOR PLATFORM FOR PEDESTRIAL TUNNEL

Codificare / Codification System

E	A	S	1	0	1	E	0	8	B	Z	C	C	0	0	1	4	0	1	0	0
---	---	---	---	---	---	---	---	---	---	---	---	---	---	---	---	---	---	---	---	---

Scara / Scale 1:25

LOT / LOT

Nr. / No 01 / 01