

**sect a-a** sc. 1 : 25

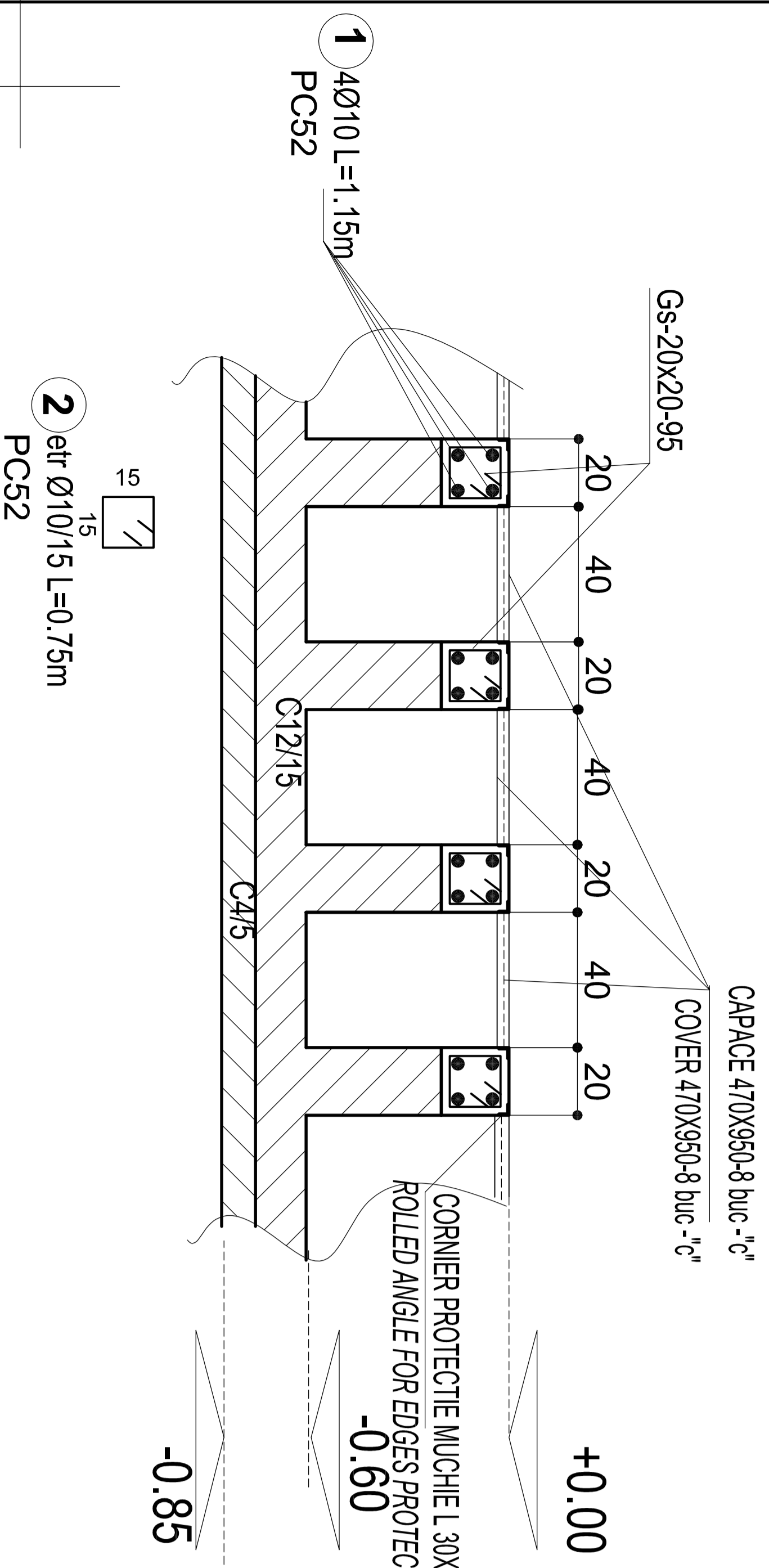

**sect d-d** sc. 1 : 25

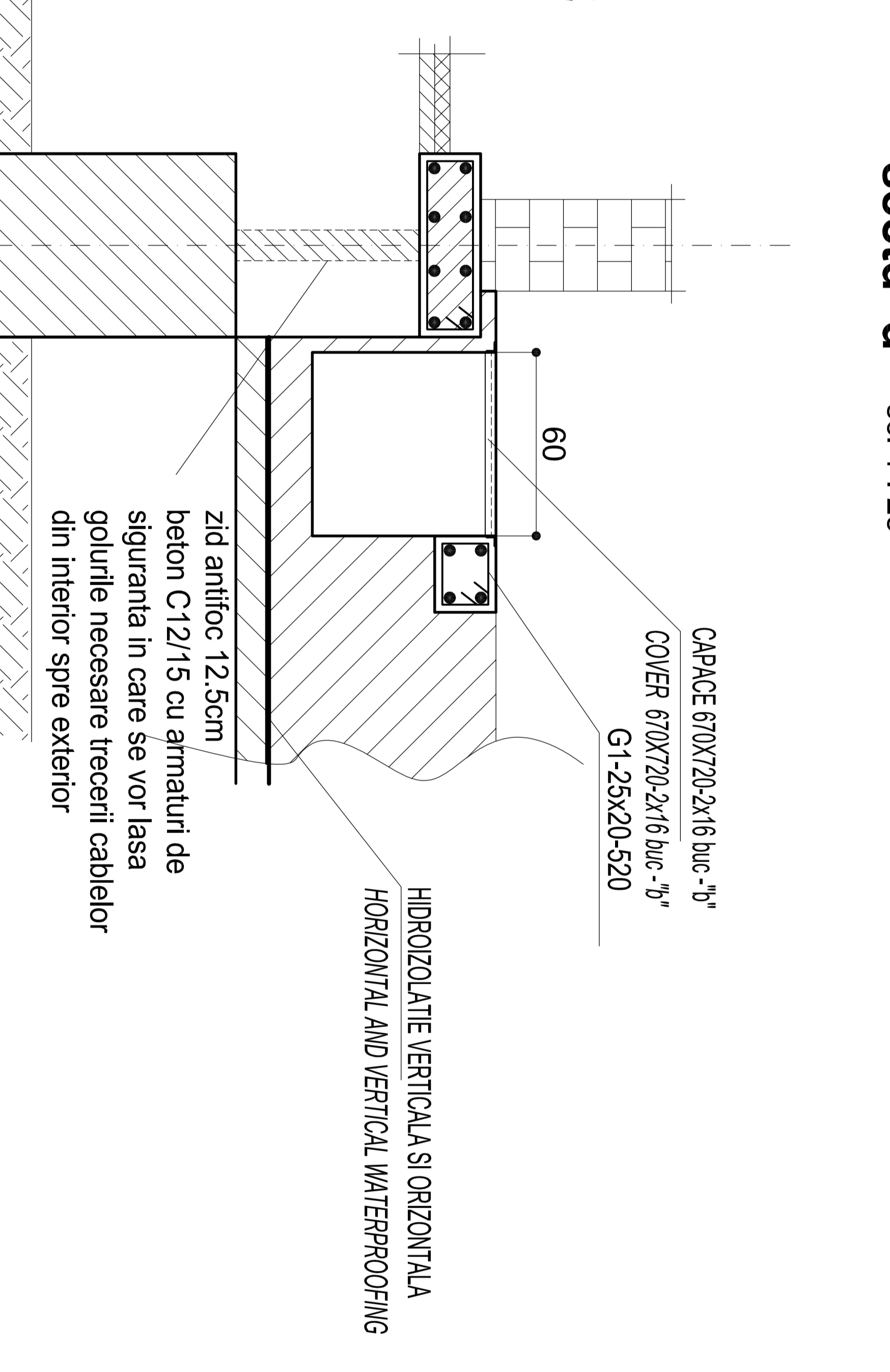

**sect b-b** sc. 1 : 25

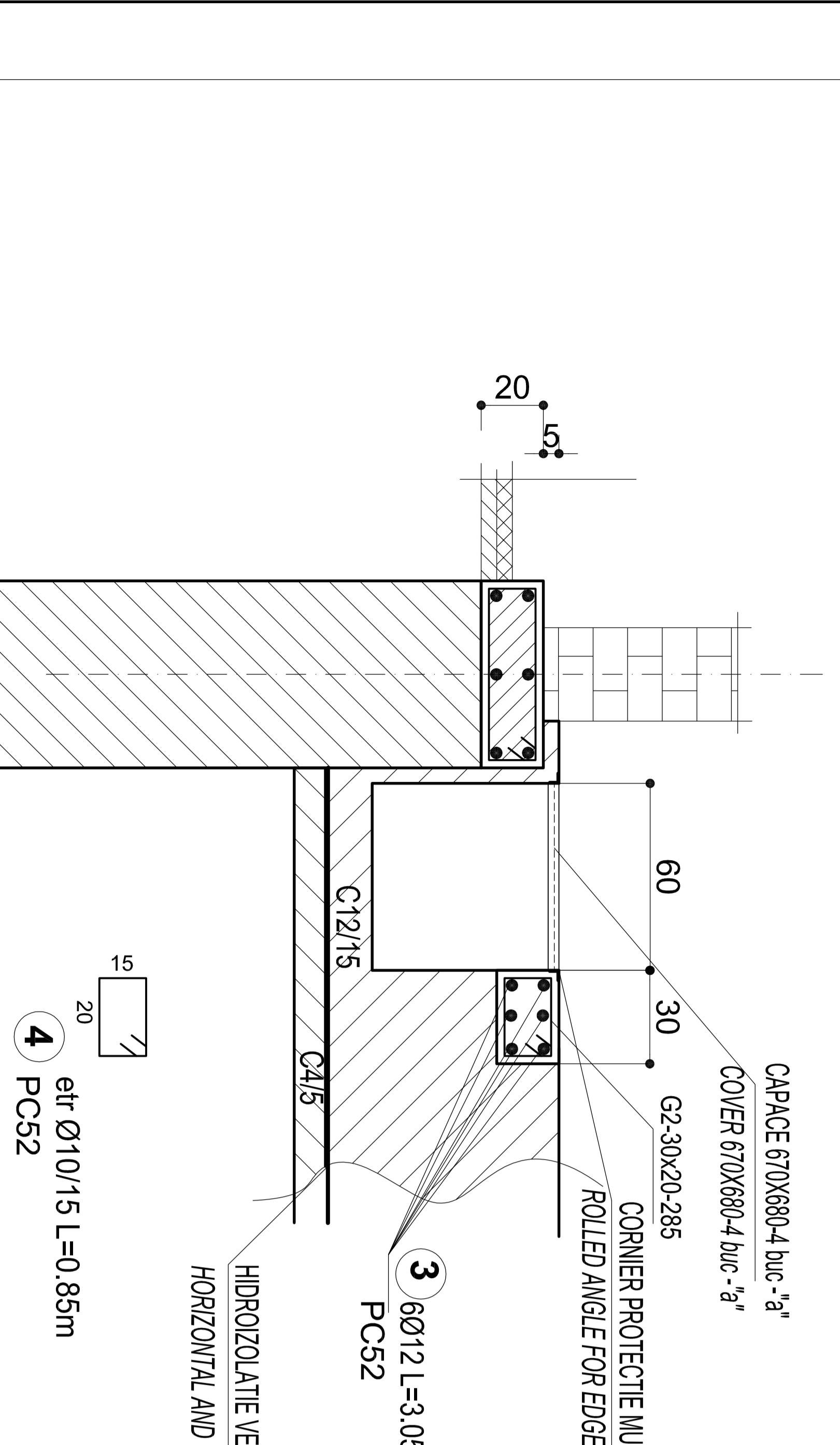

**sect c-c** sc. 1 : 25

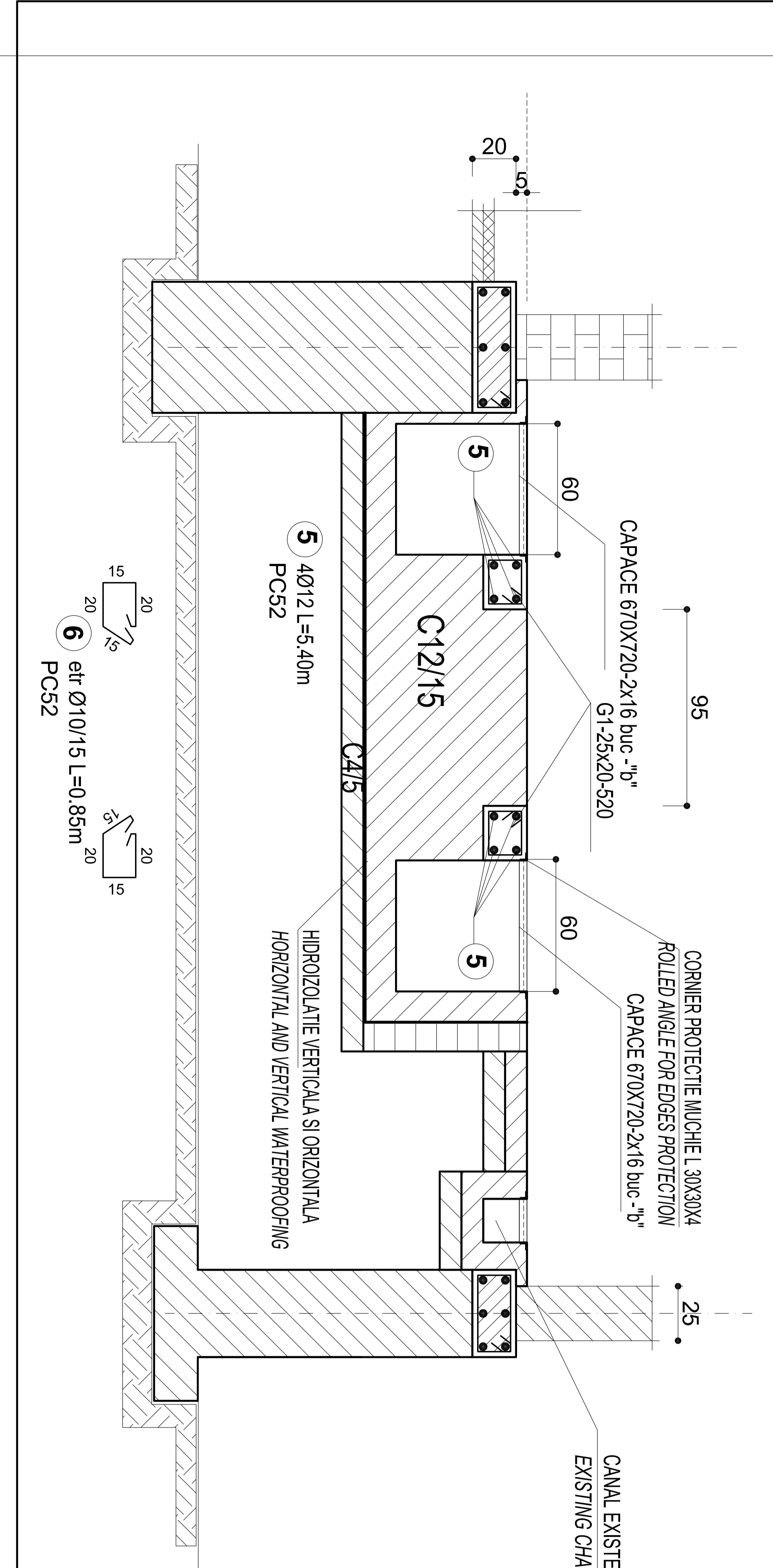

**DIMENSUNI CAPACE TS 5/ DIMENSION COVER**

670X680 - 2X4 buc - "a"  
670X720 - 2x16 buc - "b"  
470X950 - 8 buc - "c"

CORNER PROTECTIE MUCHIE L. 30X30X4 S235JRG2  
ROLLED ANGLE FOR EDGES PROTECTION  
1.78 Kg/m - 80.00m = 142.40Kg

**EXTRAS ARMATURA/REINFORCEMENT EXTRAS**

ELEM.	MARCA	DIAM. BUC.	NR. BUC.	LUNG. BARA -m-	LUNGIMI / DIAMETRE		
					Ø8	Ø10	Ø12
1	10	28	1.15		32.2		
2	10	45	0.75		33.75		
3	12	12	3.05		36.6	36.6	
4	10	40	0.85		34.0		
5	12	8	5.40			43.2	
6	10	70	0.85		59.5		
LUNGIME / DIAMETRE					0.0	196.1	79.8
LUNGIME /m / DIAMETRE					0.395	0.617	1.578
GREUTATE / DIAMETRE					0.0	121.0	125.9
TOTAL kg :					0.0	121.0	126.0
TOTAL GENERAL (PCS2) kg. :						247.0	

**BETON ARMATI/ REINFORCED CONCRETE C12/15**  
**BETON SIMPLU / CONCRETE C4/5**  
**OTEL BETON / REINFORCING STEEL PCS2**



Index	Date	Modificare / Revision	Proiectant / Designer	Approbat Consultant / Approved Consultant	Approbat CFR / Approved CFR
A					
B					
C					
D					

 **GUVERNUL ROMANIEI / ROMANIAN GOVERNMENT**  
PROIECT FINANȚAT DE UNIUNEA EUROPEANĂ / EUROPEAN UNION FINANCED PROJECT

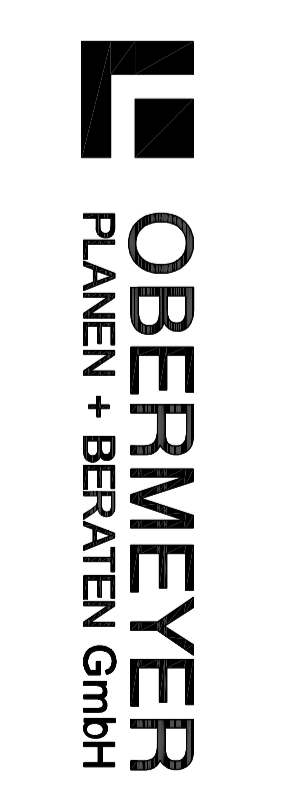
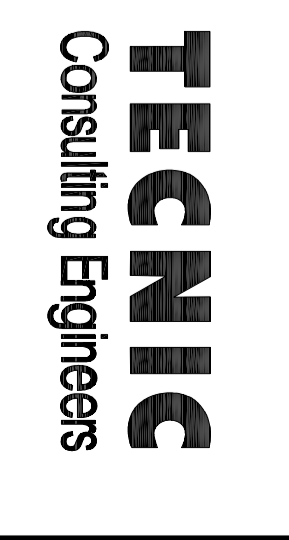
 **C.N.C.F. "C.F.R." - S.A.**

**CLIENT / CLIENT**  
 **SCOTT WILSON**  
 **OBERMAYER PLANEN + BERATEN GmbH**  
 **TECHNIC Consulting Engineers**

**CONSULTANT / CONSULTANT**

Approbat / Approved	Set proiect / Project manager	Date / Date	Semnătură / Signature
Approbat / Approved	R. Lutzza	12.2011	
Verificat / Verified	C. Gambelli	12.2011	
Verificat / Verified	Giuseppe Fioravanti	12.2011	

**SUBCONTRACTANT / SUBCONTRACTOR**

Approbat / Approved	Responsabil / Subcontractant	Date / Date	Semnătură / Signature
Approbat / Approved	A. Stanciu - Dinulescu	12.2011	
Elaborat / Elaborated	Anca Rus	12.2011	

**Reabilitarea liniei de cale ferata Brasov - Simeria, parte componentă a coridorului IV Pan European, pentru circulația trenurilor cu viteză maximă de 160 km/h, Tronsoani : Brasov - Sighișoara**  
Rehabilitation of the railway line Brasov - Simeria, component Part of the IV Pan-European Corridor, for the trains circulation with maximum speed of 160 km/h,  
**Section : Brasov - Sighișoara**

**Denumire desen / Drawing Title :**  
**Substația de tracțiune MĂIERUȘ / MĂIERUȘ Traction Substation**  
**Detalii și secțiuni canale - Bloc de comandă / Details and section channel - Control building**

Codificare / Codification System

E	A	5	1	0	1	E	0	8	B	Z	A	C	0	0	1	4	0	0	8	0
---	---	---	---	---	---	---	---	---	---	---	---	---	---	---	---	---	---	---	---	---

Scara / Scale: 1:25  
LOT / LOT: \_\_\_\_\_  
Nr. / No: 01 / 01