

**PLAN POSTAMENT PENTRU SEPARATOR SEDIMENTE
PLATFORM PLAN FOR SEDIMENT SEPARATOR**

Scara / Scale 1:25

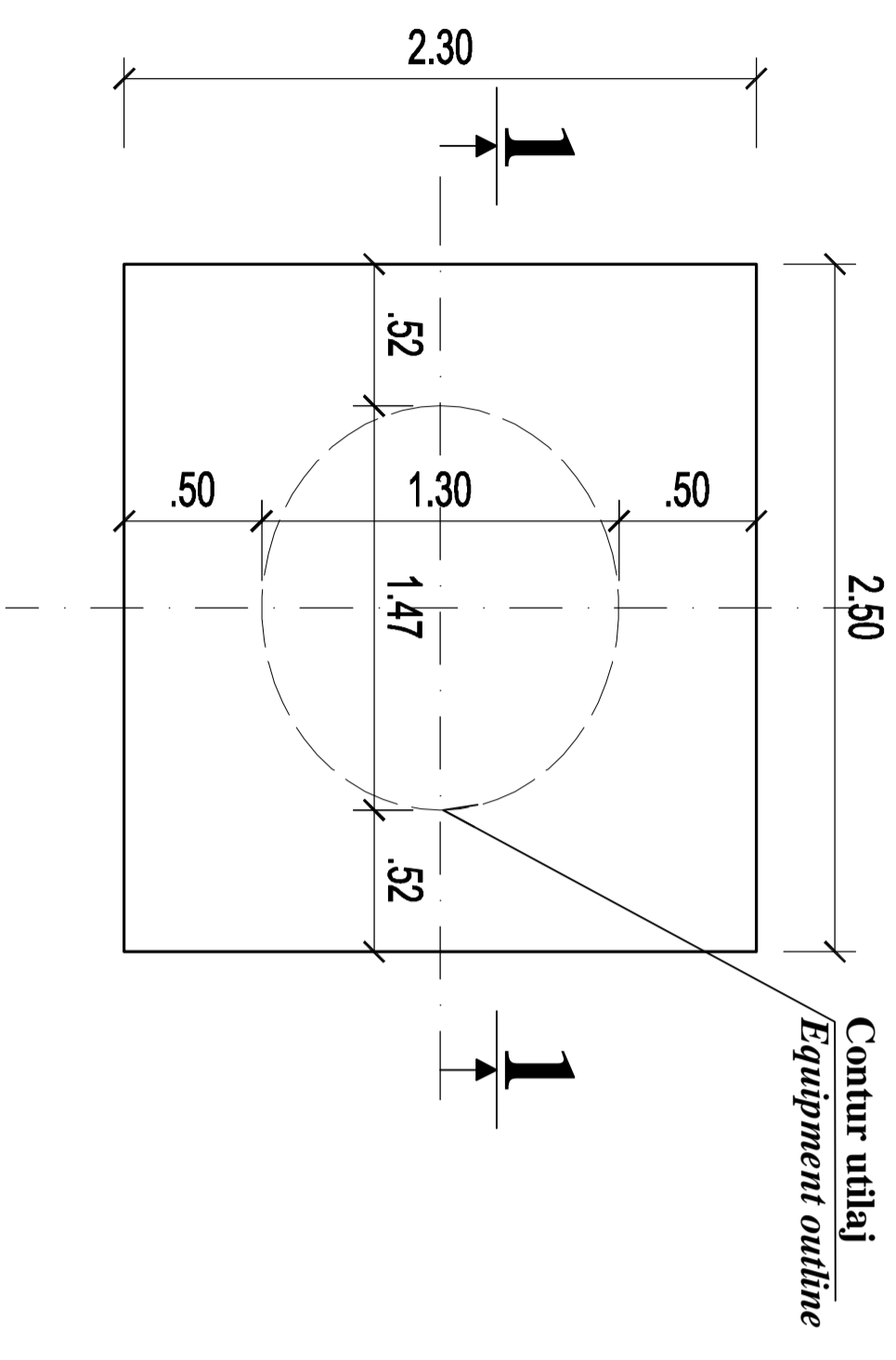

CARACTERISTICI / CHARACTERISTICS

- Clasa de importanta / Importance class (P100/1 - 2006) ---- "III"
- Categoria de importanta / Importance category (HG 766 - 1997) ---- "C"
- Seism / seism ---- "ag = 0,20"; "Tc = 0,7 sec"

SECTIUNEA / SECTION "1" - "1"

Scara / Scale 1:25

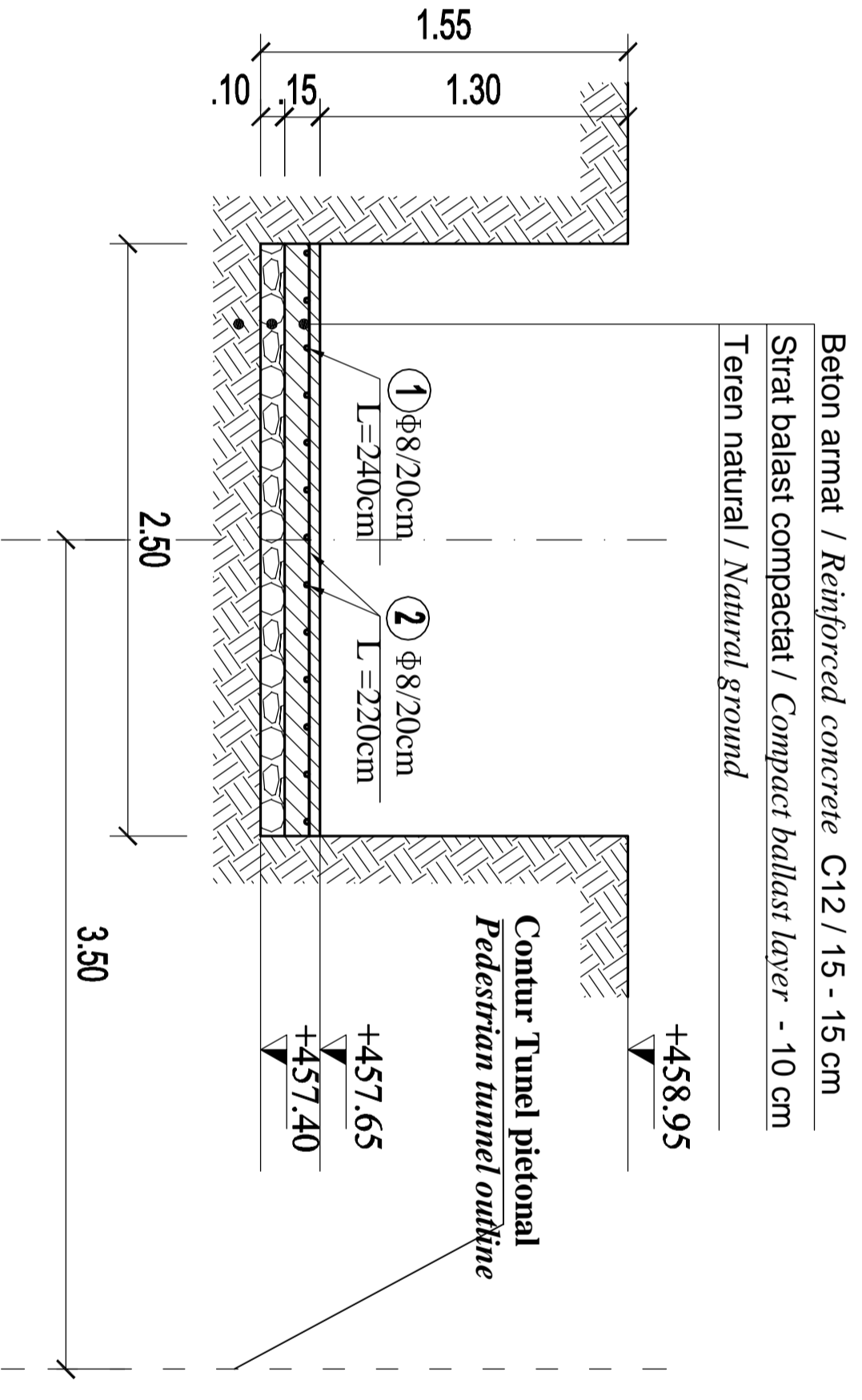

- MATERIALE**
- BETON SIMPLU: C 6/7.5
 - OTEL BETON : PC52
 - Acoperirea cu beton a armaturilor de rezistență : c = 4.5 cm.
- MATERIALS**
- CONCRETE : C 6/7.5
 - REINFORCEMENT : PC52
 - STEEL : S235L2G3 (OL37.2n)
 - Concrete covering of the main reinforcing bars : c = 4.5 cm.

EXTRAS ARMATURA - BILL OF REINFORCEMENT



Marca	φ	buc	lung (m)	PC 52	φ 8
	8	14	2.40	33.60	
	8	13	2.20	28.60	
Total m/φ				62.20	
Kg/ m/φ				0.395	
Kg/φ				24.569	
TOTAL Kg				24.57	

Index	Date	Modificare/Revision	Proiectant Designer	Approbat Consultant	Approbat CFR
D					
C					
B					
A					

GUVERNUL ROMANIEI
 ROMANIAN GOVERNMENT

PROIECT FINANȚAT DE UNIUNEA EUROPEANĂ
 EUROPEAN UNION FINANCED PROJECT

C.N.C.F. "C.F.R." - S.A.

CLIENT / CLIENT

GRUPPO FERROVIE DELLO STATO
 Joint Venture leader

FLANEN + BERATEN GmbH
TECNIC
 Consulting Engineers

CONSULTANT / CONSULTANT

Approbat Approved	Șef proiect Project manager	R. Liuzza	Data Date	Semnătură Signature
Approbat Approved	Coordonator Section 1 Coordinator	C. Gambelli	12.2011	
Verificat Verified	Verificator Verifier	Giuseppe Fioravanti	12.2011	
Checked				

SUBCONTRACTANT / SUBCONTRACTOR

Approbat Approved	Responsabil Subcontractant	A. Stanciu - Dinulescu	Data Date	Signature
Approbat Approved	Subcontractant Responsible		12.2011	
Elaborat Elaborated	Designer	Andreea Staicu	12.2011	

Reabilitarea liniei de cale ferata Brașov - Simeria, parte componentă a coridorului IV Pan European, pentru circulația trenurilor cu viteză maximă de 160 km/h,
 Tomsonul : Brașov - Sighișoara
 Coridor, for the trains circulation with maximum speed of 160 km/h,
 Section : Brașov - Sighișoara

Proiect/Project: 2004/RO/16/RF/PA/003
 Faza / Phase: D.E. / E.D.

Denumire desen / Drawing Title :
HALTA MATEIAS - POSTAMENT PENTRU SEPARATORUL DE SEDIMENTE
LA TUNELULUI PIETONAL
FLAG STATION MATEIAS - SEDIMENT SEPARATOR PLATFORM FOR PEDESTRIAL TUNNEL

Codificare / Codification System

E	A	S	1	0	1	E	1	2	B	Z	C	C	0	0	1	4	0	1	0	0
---	---	---	---	---	---	---	---	---	---	---	---	---	---	---	---	---	---	---	---	---

Scara / Scale 1:25
 LOT / LOT
 Nr. / No 01 / 01