

**PLAN POSTAMENT PENTRU SEPARATOR SEDIMENTE  
PLATFORM PLAN FOR SEDIMENT SEPARATOR**

Scara / Scale 1:25

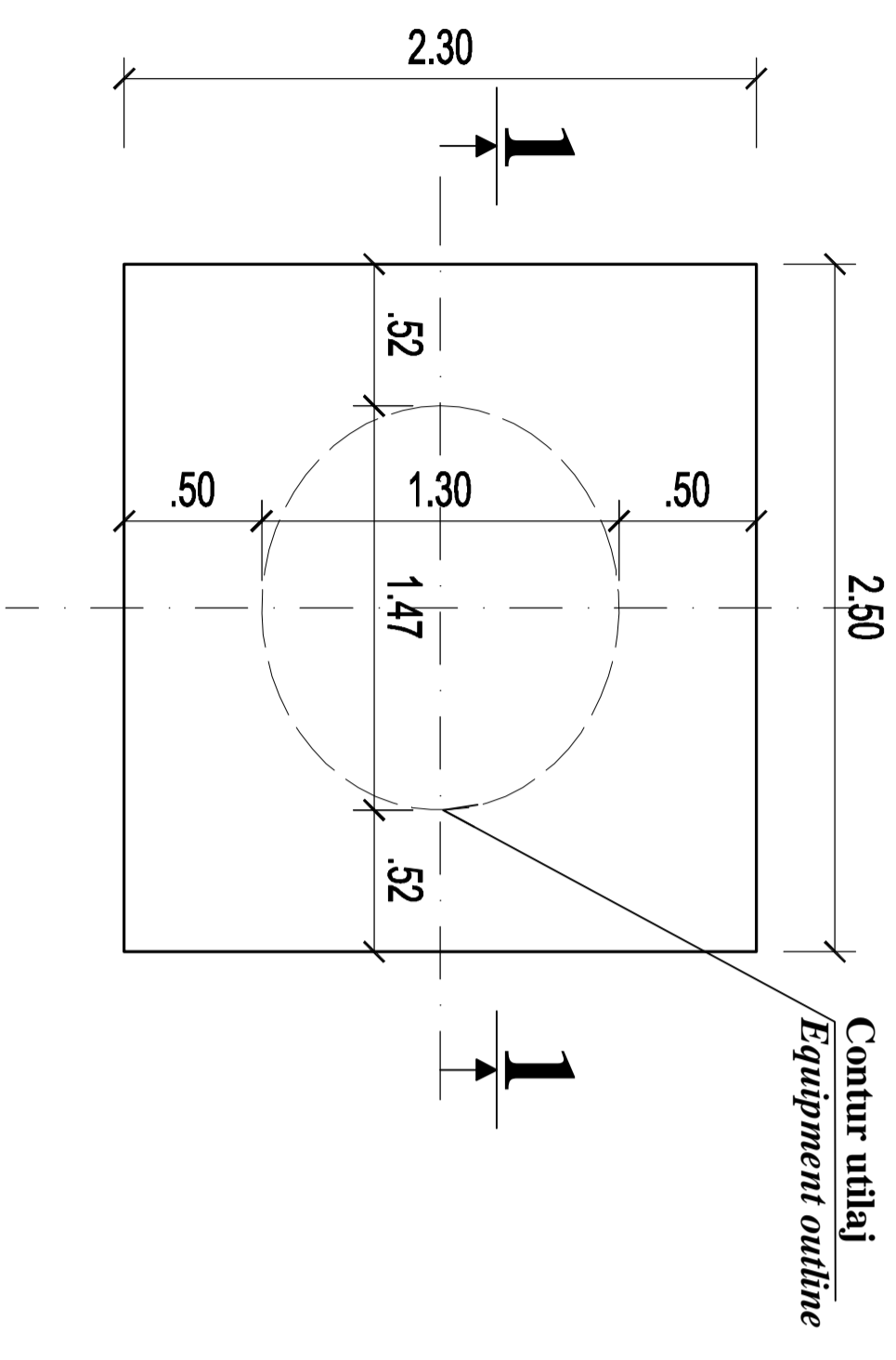

**CARACTERISTICI / CHARACTERISTICS**

- Clasa de importanta / *Importance class* (P100/1 - 2006) ---- "III"
- Categoria de importanta / *Importance category* (HG 766 - 1997) ---- "C"
- Seism / *seism* ---- "a<sub>g</sub> = 0,20"; "T<sub>c</sub> = 0,7 sec"

**SECTIUNEA / SECTION "1" - "1"**

Scara / Scale 1:25

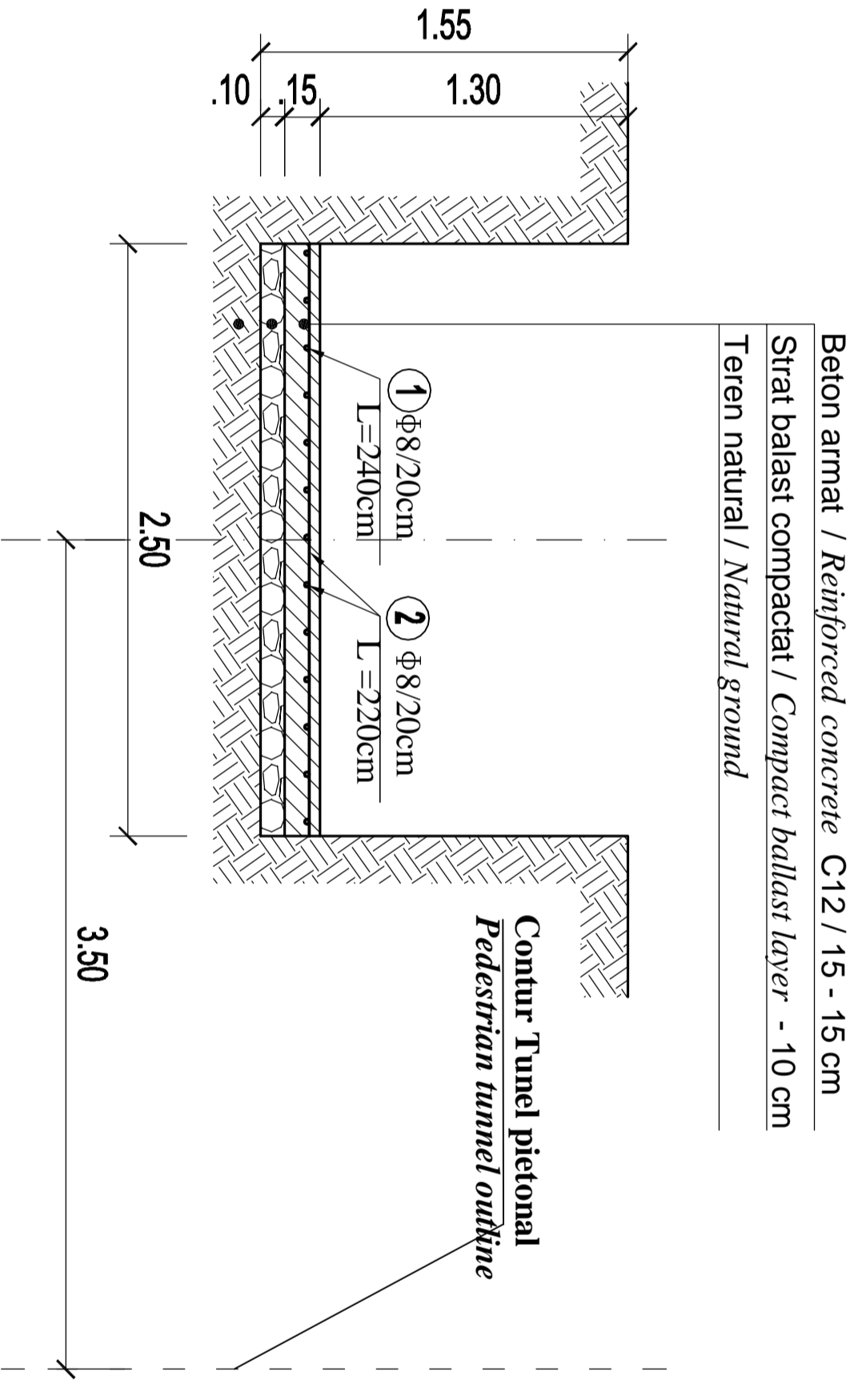

- MATERIALE**
- BETON SIMPLU: C 6/7.5
  - OTEL BETON : PC52
  - Acoperirea cu beton a armaturilor de rezistență : c = 4.5 cm.
- MATERIALS**
- CONCRETE : C 6/7.5
  - REINFORCEMENT : PC52
  - STEEL : S235L2G3 (OL37.2n)
  - Concrete covering of the main reinforcing bars : c = 4.5 cm.

EXTRAS ARMATURA - BILL OF REINFORCEMENT				
Marca	φ	buc	lung (m)	PC 52 φ 8
	1	8	2.40	33.60
	2	8	2.20	28.60
Total m/φ			62.20	
Kg/ m/φ			0.395	
Kg/φ			24.569	
<b>TOTAL Kg</b>			<b>24.57</b>	

D				
C				
B				
A				
Index	Date	Modificare / Revision	Proiectant / Designer	Approbat / Approved
				Approbat CFR / Approved CFR

**GUVERNUL ROMANIEI** / ROMANIAN GOVERNMENT
 
**PROIECT FINANȚAT DE UNIUNEA EUROPEANĂ** / EUROPEAN UNION FINANCED PROJECT

**C.N.C.F. "C.F.R." - S.A.**

**CLIENT / CLIENT**

**TECNIC** / Consulting Engineers

CONSULTANT / CONSULTANT		Data	Semnătură / Signature
Approbat / Approved	Șef proiect / Project manager	12.2011	
Approbat / Approved	Coordonator Secțiune 1 / Section 1 Coordinator	12.2011	
Verificat / Checked	Verificator / Verifier	12.2011	

SUBCONTRACTANT / SUBCONTRACTOR		Data	Semnătură / Signature
Approbat / Approved	Responsabil Subcontractant / Subcontractant Responsible	12.2011	
Elaborat / Elaborated	Proiectant / Designer	12.2011	

Reabilitarea liniei de cale ferată Brașov - Simeria, parte componentă a coridorului IV Pan European, pentru circulația trenurilor cu viteză maximă de 160 km/h, Tomsonul : Brașov - Sighișoara  
 Rehabilitation of the railway line Brașov - Simeria, component Part of the IV Pan-European Corridor, for the trains circulation with maximum speed of 160 km/h,  
 Section : Brașov - Sighișoara

Denumire desen / Drawing Title :  
**HALTA MURENI - POSTAMENT PENTRU SEPARATORUL DE SEDIMENTE**  
**LA TUNELULUI PIETONAL**  
**FLAG STATION MURENI - SEDIMENT SEPARATOR PLATFORM FOR PEDESTRIAL TUNNEL**

Codificare / Codification System :
 

E	A	S	1	0	1	E	1	6	B	Z	C	C	0	0	2	4	0	1	0	0
---	---	---	---	---	---	---	---	---	---	---	---	---	---	---	---	---	---	---	---	---

Scara / Scale : 1 : 25
 

LOT / LOT	Nr. / No
	01 / 01