

PLAN FUNDATII - FOUNDATION PLAN

sc. 1 : 100

PROFIL METALIC 120 - 120 METALLIC PROFILE
L = 3.60 m, 4x75.6 kg/buc = 302.4 kg

PLASE DUBLE LEGATE sau SUDATE
Ø8/15x15 cm PC52 460 kg, S = 2x36 m²
DOUBLE STEEL WIRE FRAME ARMORED or WELDED

TABLEAU ARMARE
TABLE of QUANTITY of REINFORCEMENTS

MARCA	DIAM	NR. BUC.	LUNG. BARA -m-	LUNGIMI / DIAMETRE	
				PC52	Ø14
1	8	150	0.45	67.5	
				67.5	
				0.0	0.0
				0.395	0.617
				26.7	0.0
				27.0	0.0
				27.0	27.0

BETON ARMAT/ REINFORCED CONCRETE : C16/20
OTEL BETON / REINFORCEMENT : PC52

DETALIU CONSOLIDARE PLANSEU FISURAT
DETAIL of FLOOR REINFORCEMENT for THE RIFTY LEVEL

sc. 1 : 10

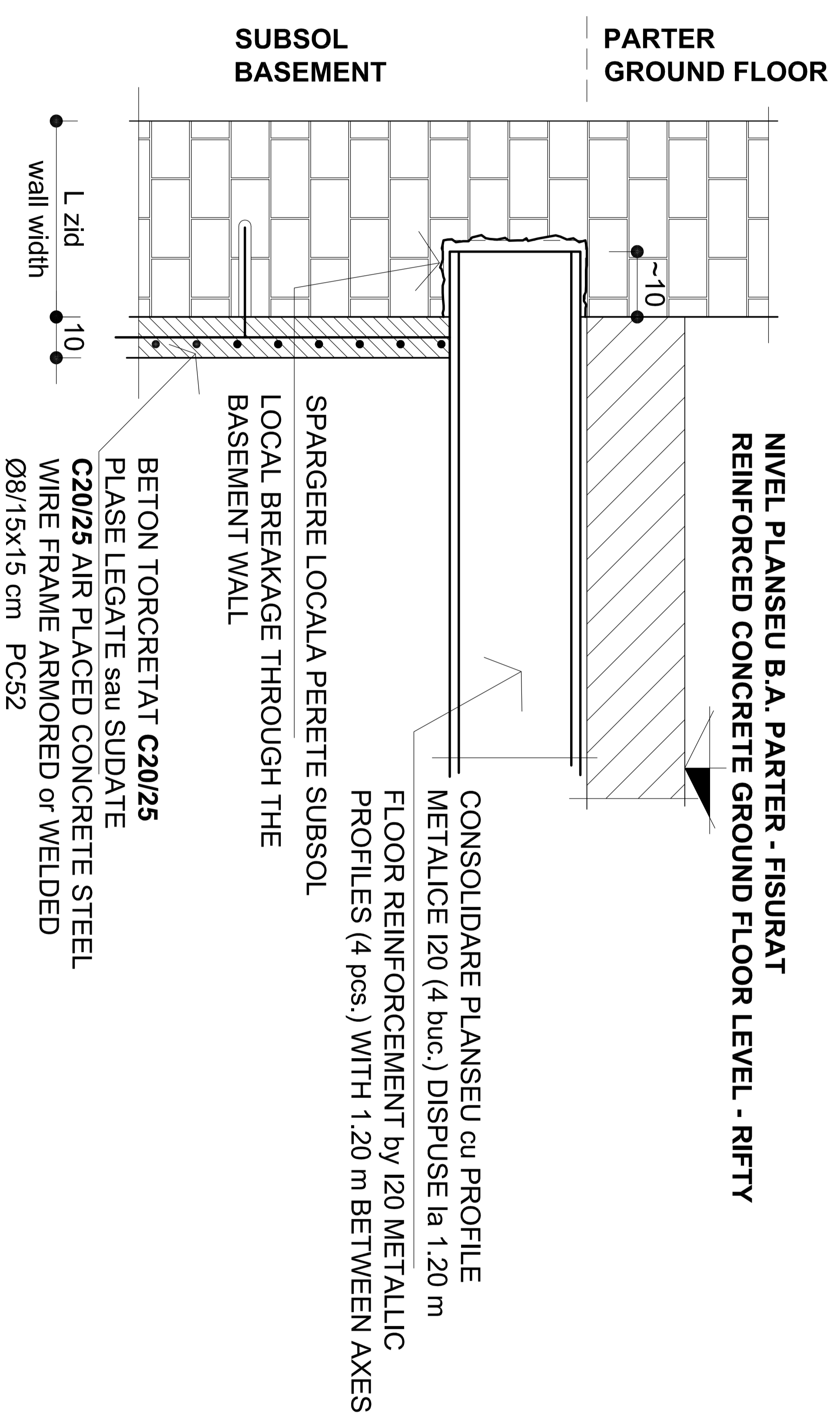

NIVEL PLANSEU B.A. PARTER - FISURAT
REINFORCED CONCRETE GROUND FLOOR LEVEL - RIFTY

DETALIU / DETAIL 1

CAMASUALA cu BETON TORCRETAT
pe O FATA a PERETELUI
COATING WITH AIR PLACED CONCRETE
ON THE FACE TO WALL

sc. 1 : 10

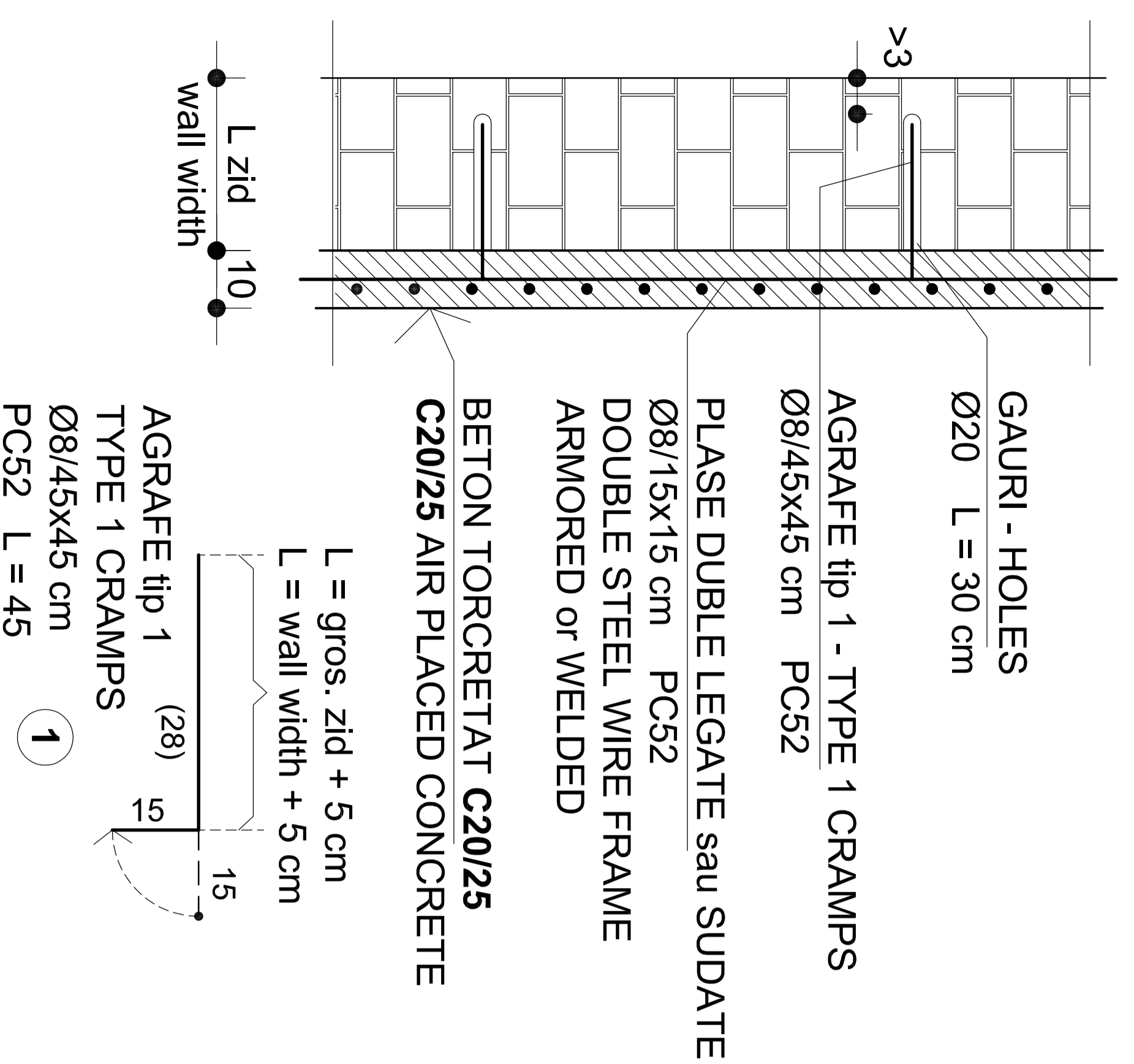

SUBSOL BASEMENT

PARTER GROUND FLOOR

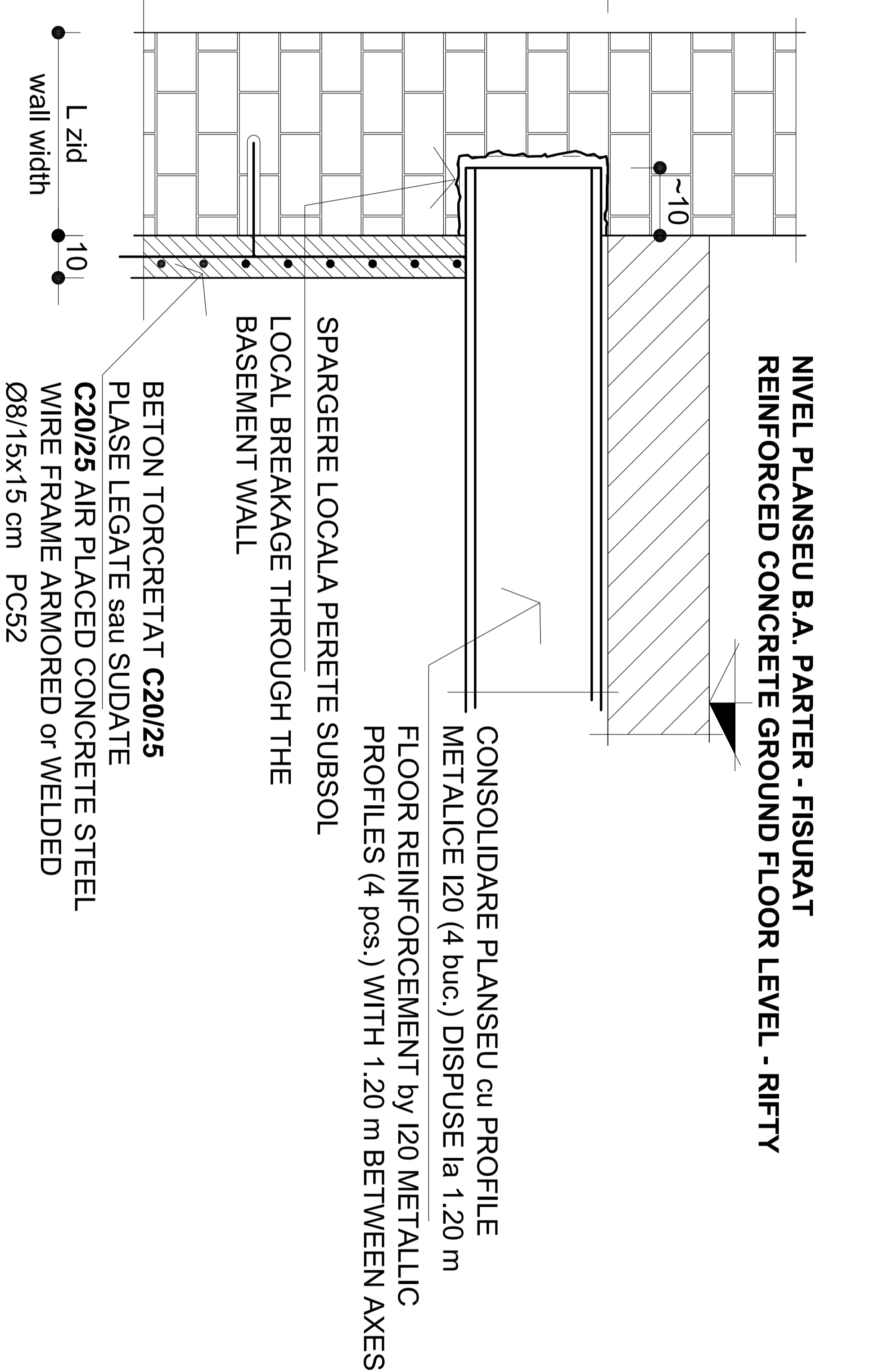

AGRAFE tip 1 TYPE 1 CRAMPS
Ø8/45x45 cm
PC52 L = 45

CLIENT / CLIENT

CFR

C.N.C.F. "C.F.R." - S.A.

CONSULTANT / CONSULTANT

ITALFERR (Grupul Feroviar de la Stato Joint Venture leader)

Scott Wilson

OBERMEYER (FLANEN + BERATEN GmbH)

TECNIC (Consulting Engineers)

Approbat / Approved	Set proiect / Project manager	R. Lutzza	Data / Date	Semnatura / Signature
Approbat / Approved	Coordonator Sectiune 1 / Section 1 Coordinator	C. Gambelli	12.2011	[Signature]
Verificat / Verified	Verificator Expert / Expert Checkings	Giuseppe Fioravanti	12.2011	[Signature]

SUBCONTRACTANT / SUBCONTRACTOR

Approbat / Approved	Responsabil Subcontractant / Subcontractant Responsible	A. Stanciu - Dinulescu	Data / Date	Semnatura / Signature
Intocmit / Elaborated	Proiectant / Designer	Anca Rus	12.2011	[Signature]

Reabilitarea liniei de cale ferata Brasov - Simeria, parte componenta a coridorului IV Pan European, pentru circulatia trenurilor cu viteza maxima de 160 km/h, **Tronsoani : Brasov - Sighisoara**

Rehabilitation of the railway line Brasov - Simeria, component Part of the IV Pan-European Corridor, for the trains circulation with maximum speed of 160 km/h, **Section : Brasov - Sighisoara**

Denumire desen / Drawing Title :
STATIA C.F. ALBESTI TARNAVA/ RAILWAY STATION ALBESTI-TARNAVA
CLADIRE DE CALATORI / MAIN BUILDING
DETALIILE CONSOLIDARE FUNDATII/ FOUNDATION DETAILS-CONSOLIDATION

Codificare / Codification System	Scara / Scale	LOT / LOT	Nr. / No
E A 5 1 0 1 E 1 9 B C C C 0 0 9 1 0 2 5 0	1:100 1:25 1:10		01 / 01