

Iesire spre oras / Exit to town

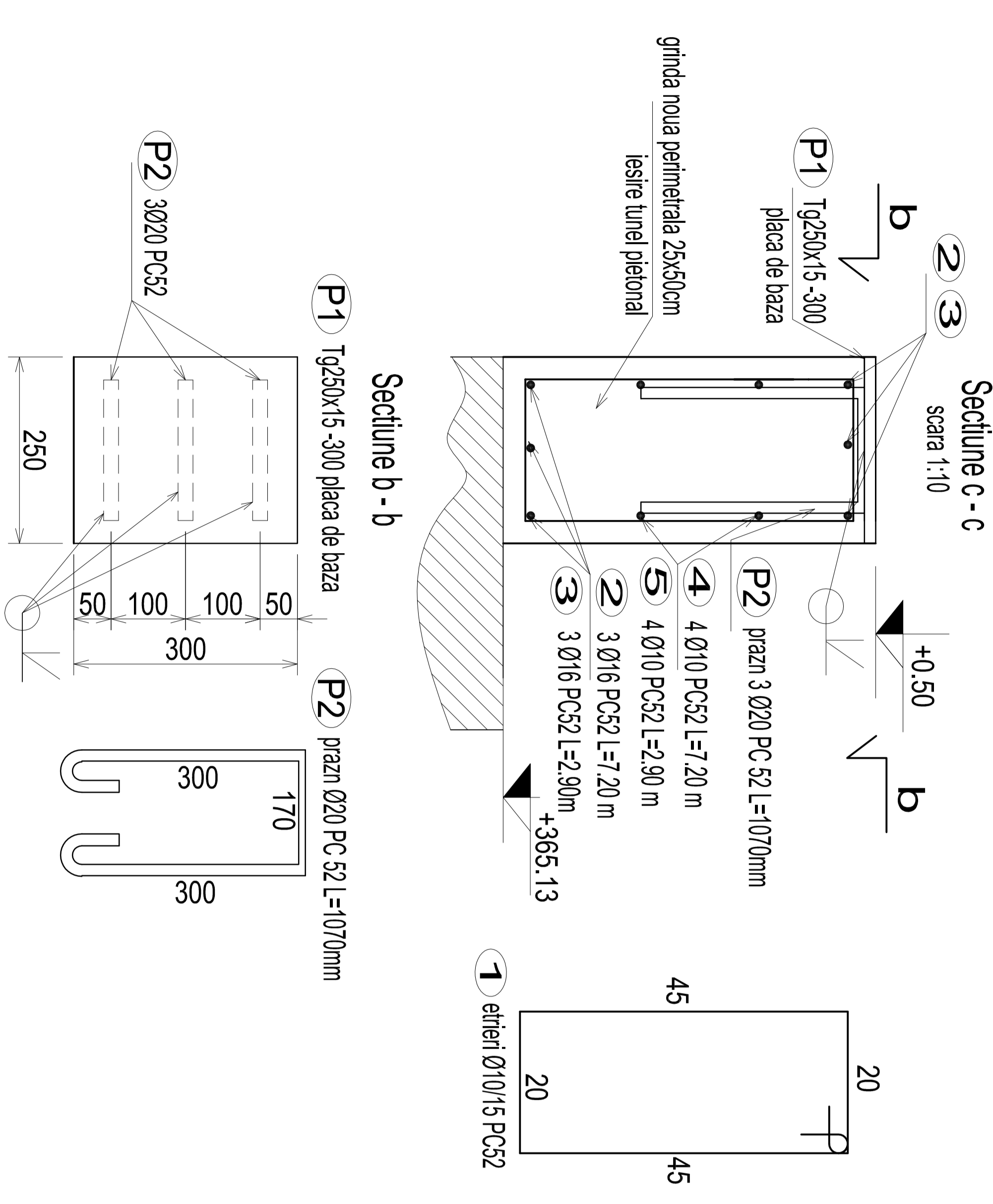
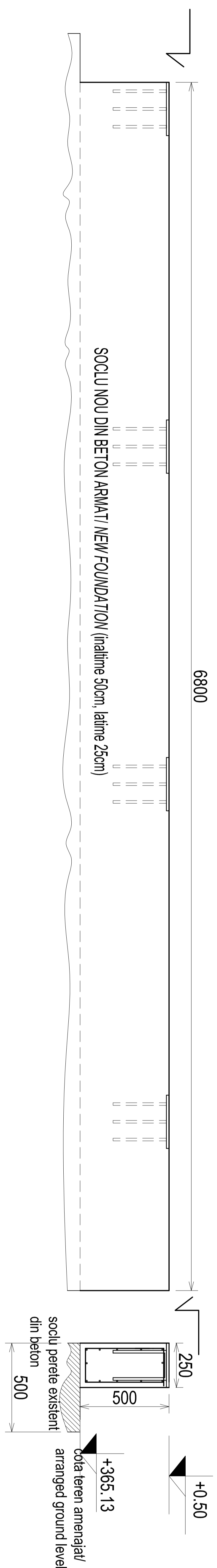
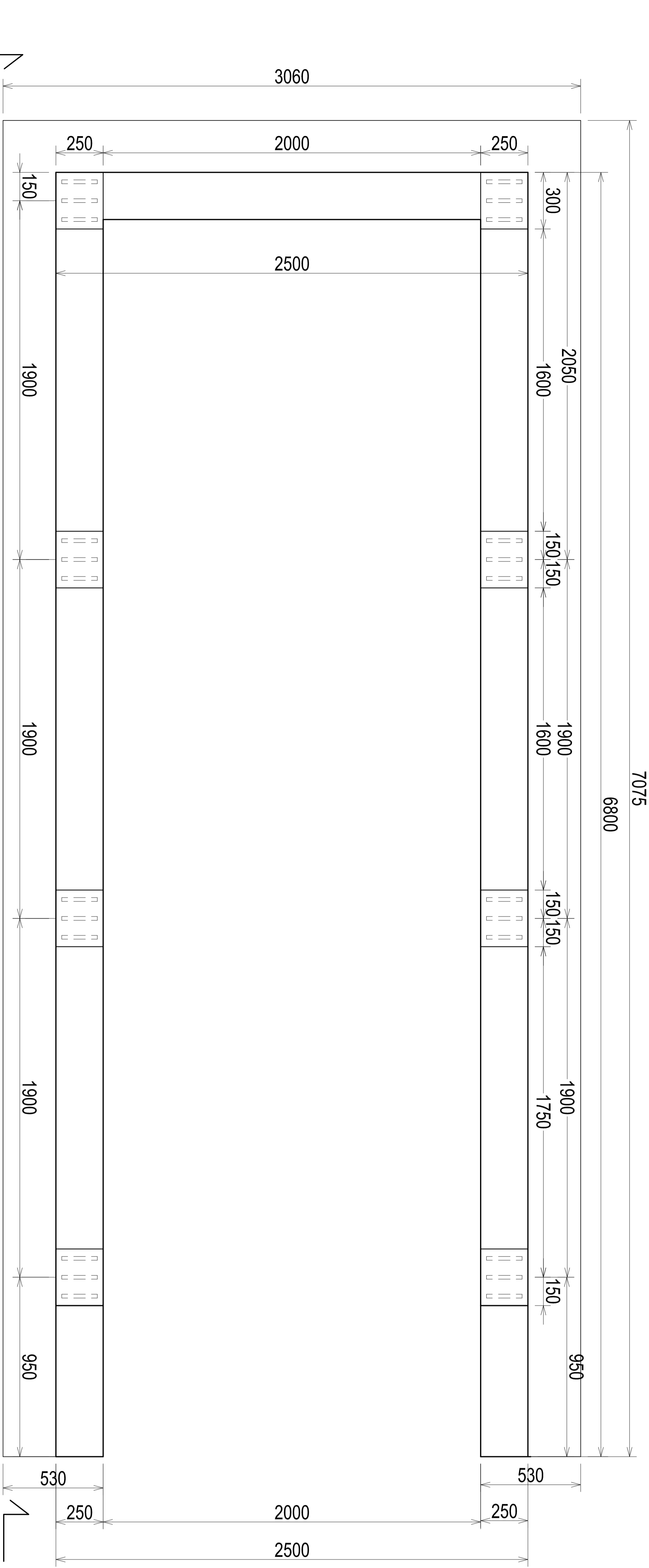

| ELEM.                 | MARCA | DIAM  | NR. BUC. | LUNG. BARA -m- | LUNGIMI / DIAMETRE |     |
|-----------------------|-------|-------|----------|----------------|--------------------|-----|
| 1                     | 10    | 115   | 1.30     | Ø8             | Ø10                | Ø16 |
| 2                     | 16    | 12    | 7.20     | 149.5          |                    |     |
| 3                     | 16    | 6     | 2.90     | 86.4           |                    |     |
| 4                     | 10    | 8     | 7.20     | 57.6           |                    |     |
| 5                     | 10    | 4     | 2.90     | 11.6           |                    |     |
| LUNGIME / DIAMETRE    |       | 0.0   | 218.7    | 103.8          |                    |     |
| LUNGIME /m./ DIAMETRE |       | 0.395 | 0.617    | 1.578          |                    |     |
| GREUTATE /DIAMETRE    |       | 0.0   | 134.9    | 163.8          |                    |     |
| TOTAL                 |       | kg. : | 135.0    | 164.0          |                    |     |
| TOTAL GENERAL (pc52)  |       | kg.:  | 299.0    |                |                    |     |

- P1 Tg250x15-300 placa de baza 8.83kg/bucata\*8=70.64kg
- P2 prazn Ø20 PC 52 L=1070mm / 2.47Kg/m\*1.070 = 2.64kg/bucata 2.64kg/bucata\*24bucati=64kg

Otel/ Steel - OL 37-2  
Clasa beton/ C25/30

| Index | Date | Modificare / Revision | Proiectant / Designer | Approbat Consultant / Approved Consultant | Approbat CFR / Approved CFR |
|-------|------|-----------------------|-----------------------|---|-----------------------------|
| A     |      |                       |                       |   |                             |
| B     |      |                       |                       |   |                             |
| C     |      |                       |                       |   |                             |
| D     |      |                       |                       |   |                             |

ROMANIAN GOVERNMENT PROJECT FINANȚAT DE UNIUNEA EUROPEANĂ  
EUROPEAN UNION FINANCED PROJECT

CLIENT / CLIENT

C.N.C.F. "C.F.R." - S.A.

CONSULTANT / CONSULTANT

ITALFERR  
GRUPPO FERROVIE DELLO STATO  
Joint Venture leader

Scott Wilson

OBERMEYER PLANEN + BERATEN GmbH  
Consulting Engineers

| Approbat / Approved | Responsabil / Responsible | Data / Date | Semnatura / Signature |
|---------------------|---------------------------|-------------|-----------------------|
| Approbat / Approved | R. Luzzza                 | 12.2011     |                       |
| Approbat / Approved | C. Gambelli               | 12.2011     |                       |
| Verificat / Checked | Giuseppe Fioravanti       | 12.2011     |                       |

SUBCONTRACTANT / SUBCONTRACTOR

ARIX

| Approbat / Approved   | Responsabil / Responsible | Data / Date | Semnatura / Signature |
|-----------------------|---------------------------|-------------|-----------------------|
| Approbat / Approved   | A. Stancliu - Dimulescu   | 12.2011     |                       |
| Elaborat / Elaborated | Anca Rus                  | 12.2011     |                       |

Reabilitarea liniei de cale ferata Brasov - Simeria, parte componentă a coridorului IV Pan European, pentru circulația trenurilor cu viteză maximă de 160 km/h.  
Tronsoanul : Brasov - Sighisoara  
Rehabilitation of the railway line Brasov - Simeria, component Part of the IV Pan-European Corridor, for the trains circulation with maximum speed of 160 km/h.  
Section : Brasov - Sighisoara

Project/Project  
2004/RO/16/P/PA/003

Denumire desen / Drawing Title :  
STATIA C.F. ALBES TI-TARNAVE / RAILWAY STATION ALBES TI - TARNAVE  
COPERTINA TUNEL PIETONAL / PEDESTRIAN TUNNEL CANOPY  
- DETALII PRINDERE - IESIRE SPRE ORAS /  
FIXING DETAILS - EXIT TO TOWN -

Codificare / Codification System

|   |   |   |   |   |   |   |   |   |   |   |   |   |   |   |   |   |   |   |   |   |
|---|---|---|---|---|---|---|---|---|---|---|---|---|---|---|---|---|---|---|---|---|
| E | A | 5 | 1 | 0 | 1 | E | 1 | 9 | B | Z | C | C | 0 | 0 | 9 | 4 | 0 | 1 | 9 | 0 |
|---|---|---|---|---|---|---|---|---|---|---|---|---|---|---|---|---|---|---|---|---|

Scara / Scale 1:25 1:10

Lot/Lot 01/01

Nr. / No 01/01