

PLAN PARTER
GROUND FLOOR PLAN

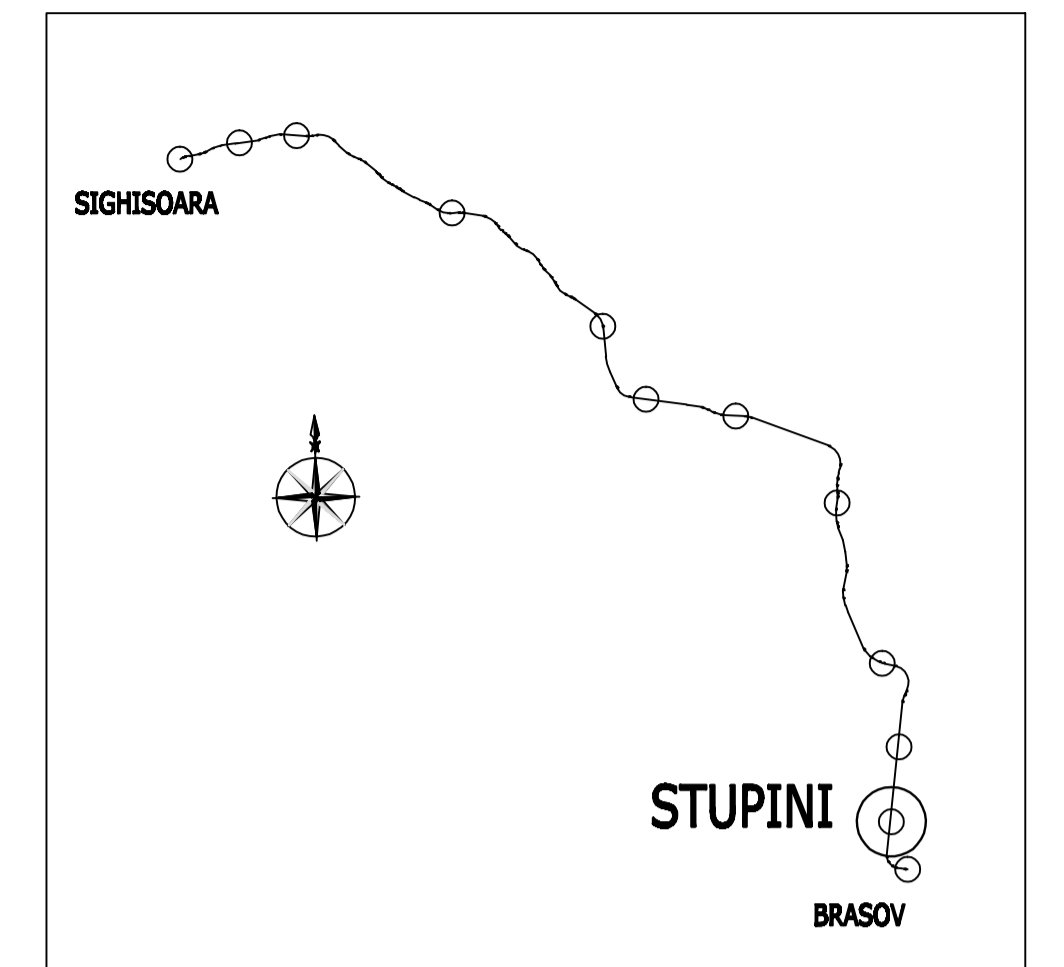
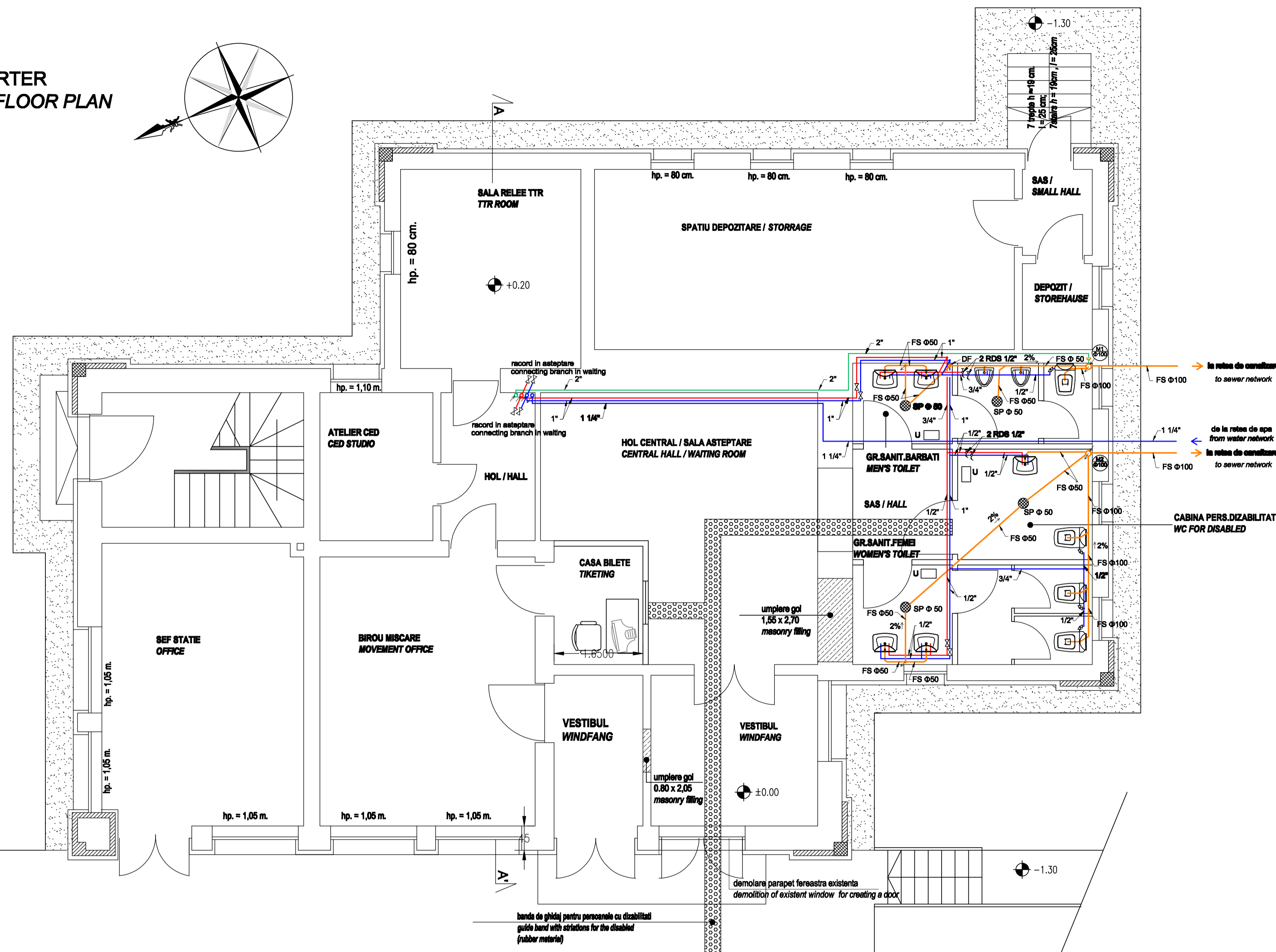
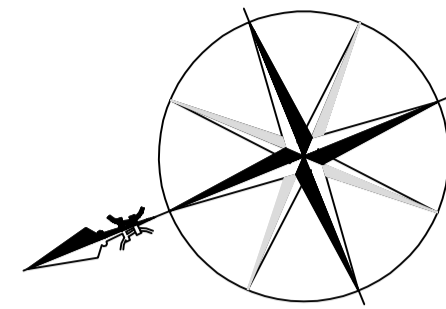

LEGENDA / LEGEND :

- conducta apa rece/ cold water pipes;
 - conducta apa caldă/ hot water pipes;
 - conducta canalizare apă uzată menajeră/ wastewater sewage pipes;
 - conducta de reținere apă uzată/ wastewater discharge pipes;
 - conducta din cupru în și de la panourile solare/ copper pipe in and from the solar panels;
- FS furtă de scurgere/ cast iron drain;
 - RDS robinet dublu servici/ double service tap;
 - M coloana apă uzată menajeră/ wastewater column;
 - SP alina de parchet/ floor trap;
 - U uscator de mătăi cu senzor/ sensor hand dryer P=2,5 kW, U=230 V;
 - B boiler bivalent (o serpentina de la panourile solare și o rezistență electrică)/ bivalent water heater (a coil from the solar panel and an electrical resistance) V=200L, P=9 kW, ØxH = 0,50x1,57 m;
 - CR clapeta de reținere (de sens unic)/ check valve (one-way sense);
 - Rp recipient de parchet/ container floor; 0,8x0,8x0,8m;
 - P+H grup pompare cu membrană și hidropomp/ pumping group with membrane and water pump, q=1,0l/s, H=15mCA, P=0,8kW;
 - EP electropompa submersibilă/ submersible electric pump, q=0,33l/s, H=13mCA, P=1,5kW;
 - RT rezervor tampon deschis/ open buffer, V=2m, LxHxh = 2x1x1m, sup de furtă/ iron cap.
 - DF dop de furtă/ iron cap.

PLAN SUBSOL
BASEMENT PLAN

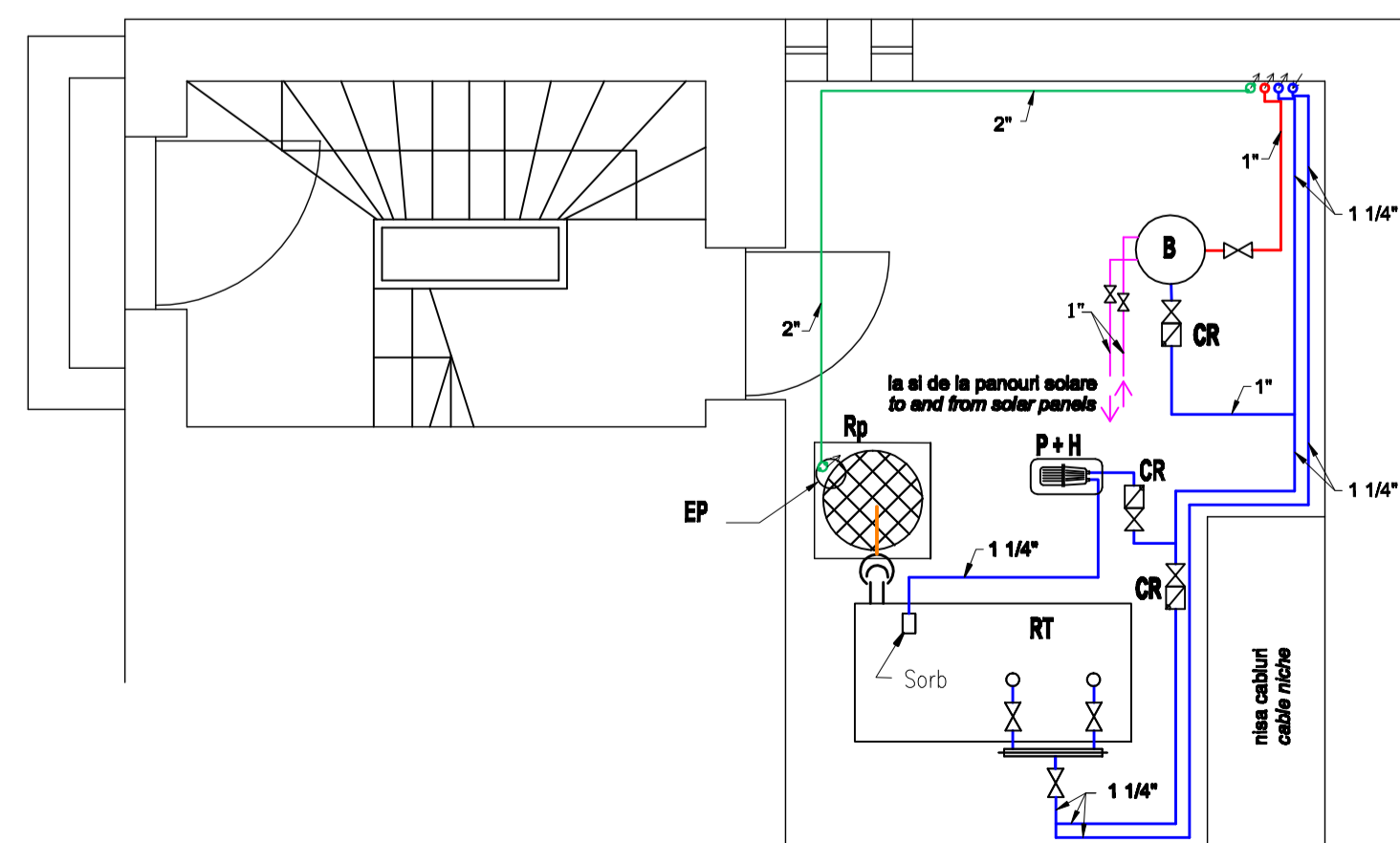

NOTA:

- trecerile prin pereti si planse ale conductelor se vor face prin tuburi de protectie;
- legaturile la canalizare dintre obiectele sanitare si coloane se vor monta cu o panta de 2%, descendenta;
- toate conductele vor fi mascate;
- functiile de rezultatul studiilor hidrogeologice se va stabili dacă apa de alimentare a acestor grupuri sanitare este potabila sau nu. In cazul in care parametrii tehnici ai apei conduc la concluzia ca aceasta este nepotabila se vor monta placute pentru avertizare deasupra fiecarei lavare.

NOTE:

- the passages of pipes through walls and floors will be made through protective tubes.
- links to the sanitary objects and columns will be installed with a slope of 2% downward.
- all pipes will be hidden.
- depending on the outcome of hydrogeological studies, it will be determined whether the water supply at toilets is drinkable or not. If the technical parameters of water lead to the conclusion that it is not potable, warning plates will be mounted above each washstand (sink).

D					
C					
B					
A					
Indice	Data	Modificari	Proiectant	Approbat	Approbat CFR
Index	Date	Modification/Revision	Designer	Approved Consultant	Approved CFR
CLIENT / CLIENT					
CONSULTANT / CONSULTANT					
Approbat	Șef proiect				
Approved	Project manager	R. Luzza	DEC. 2011		
Approbat	Coordonator Secțiune 1				
Approved	Section 1 Coordinator	C. Gambell	DEC. 2011		
Verificat	Expert Cheie				
Checked	Key Expert	Giuseppe Fioravanti	DEC. 2011		
SUBCONTRACTANT / SUBCONTRACTOR					
Approbat	Responsabil Subcontractant				
Approved	Subcontractant Responsible	A. Stanoli - Dinulescu	DEC. 2011		
Intocmit	Proiectant				
Elaborated	Designer	Anca Ionescu	DEC. 2011		
Reabilitarea liniei de cale ferată Brașov - Simeria, parte componentă a coridorului IV Pan-European, pentru circulația trenurilor cu viteză maximă de 160 km/h, Tronsoanel : Brașov - Sighisoara Rehabilitation of the railway line Brașov - Simeria, component Part of the IV Pan-European Corridor, for the trains circulation with maximum speed of 160 km/h, Section : Brașov - Sighisoara					Project/Project 2004/RQ/18/PFA/003 Fașa / Phase: P.Th. / T.D.
Denumire desen / Drawing Title :					
STATIA C.F. STUPINI / RAILWAY STATION STUPINI CLADIREA STATIEI / STATION BUILDING Plan instalatii sanitare interioare + Statie hidrofor - Revizua 2 Indoor sanitary installation plan + Pumping station - Revision 2					
Codificare / Codification System		Scara / Scale	LOT / LOT	Nr. / No	
EA51		1:50		01/01	
01 C		03	PB	IS 00 1 1 040 2	