

DETALIU ARMARE ZIDURI DE SPRIJIN H_e=1.80 m
REINFORCING DETAIL RETAINING WALLS

Scara/Scale 1:50

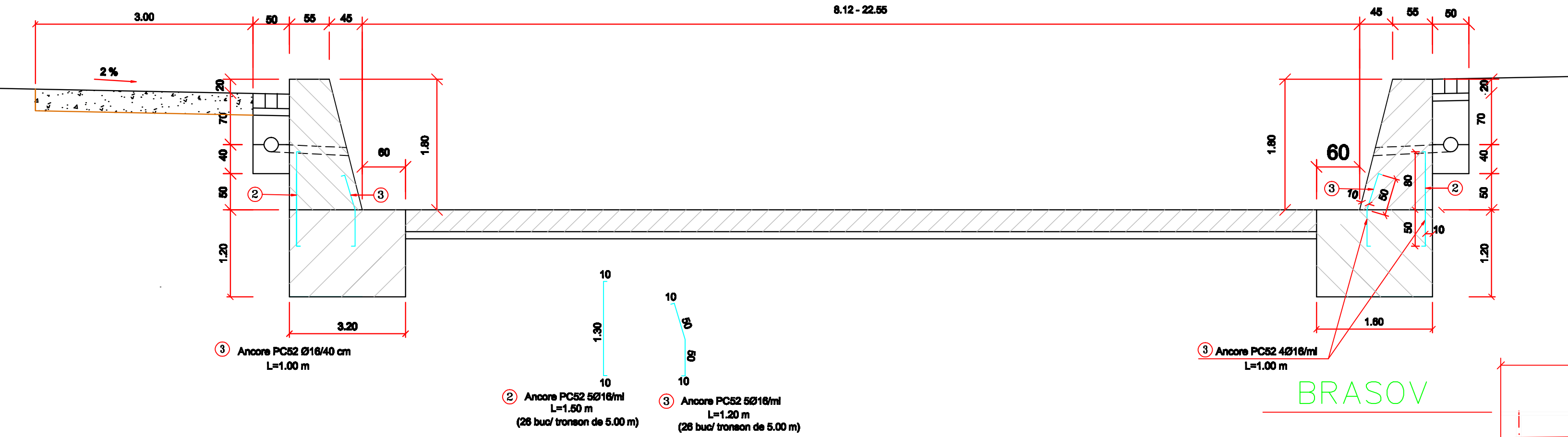

DETALIU ARMARE ZID DE SPRIJIN H_e=2.80 m
REINFORCING DETAIL RETAINING WALLS

Scara/Scale 1:50

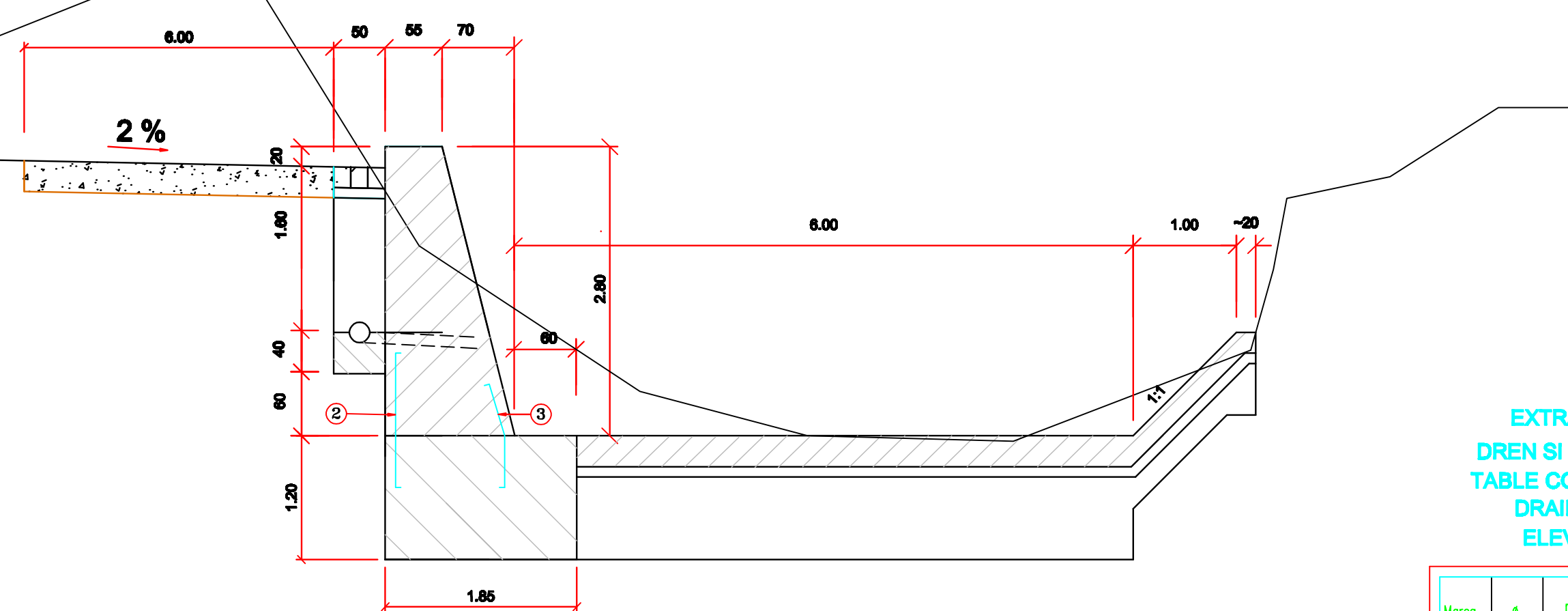

EXTRAS ARMARE CONSOLA
DREN SI ROST ELEVATIE FUNDATIE
TABLE CONTAINING REINFORCEMENT
DRAIN BRACKET AND JOINT
ELEVATION FOUNDATION

Marca	q	n	LUNGME UNITARA (buc)	LUNGME TOTALA (m)		
				QB.37	PC. 52	
1	12	25	2.85	66.25	916	
2	16	462	1.50		693.00	
3	16	462	1.20		554.40	
4	12	6	1.35		8.10	
5	12	6	3.80		22.80	
6	10	16	4.40		70.40	
7	10	16	1.60		25.60	
8	10	16	3.75		60.00	
9	10	42	3.05		128.10	
Total lungime/ø			(kg/m)	284.10	97.15	1248.00
Gradulde unitari/ø				0.617	0.888	1.578
Gradulde totalu/ø				176.00	87.80	1970.00
Gradulde totalu						2235.00

DETALIU ARMARE RACORDARE CU ZIDURI DE SPRIJIN INTRE PODURILE CF
REINFORCEMENT DETAIL CONNECTION BETWEEN BRIDGES WITH RETAINING WALLS

Scara/Scale 1:50

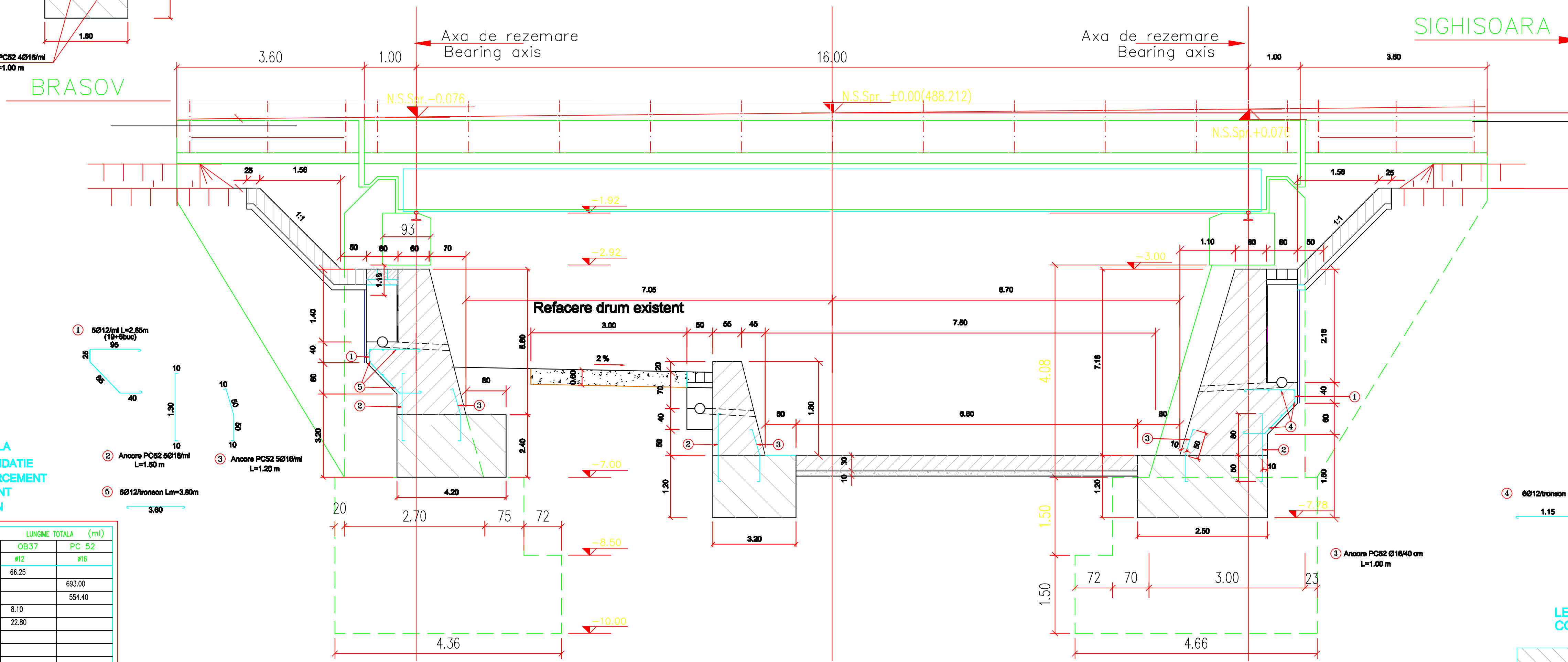

LEGENDA BETOANE:
CONCRETE LEGEND:

- beton de fundatie clase C20/25 - (fundatii ziduri de sprijin, praguri de fund si pinta peruu taluz).
- foundation concrete class C20/25 - (foundations and retaining walls, bottom sill and slope pitching spur)
- beton monolit clase C25/30 - (elevatii ziduri de sprijin, praguri de fund si peruu taluz)
- monolith concrete class C25/30 - (elevation walls, bottom sill and pitching)
- C25/30 - T4 - P12 - CEM I/IIA - S 32.5 R - A/C = 0.45 - 0/1

DETALIU ARMARE PEREU TALUZE DIN BETON H=2.80 m
CONCRETE REINFORCEMENT DETAIL SLOPE PITCHING

Scara/Scale 1:50

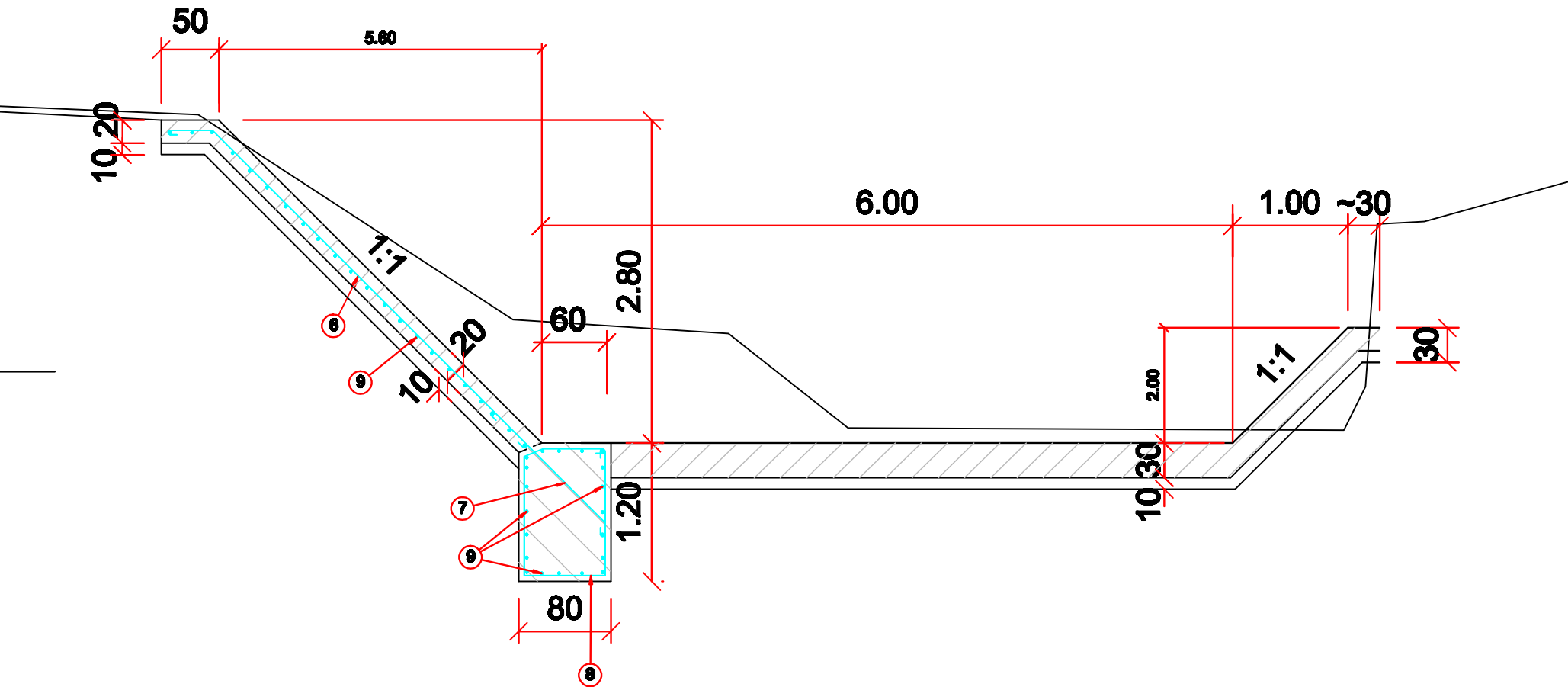

DETALII ARMARE PROTECTIE TALUZ H=2,80m
REINFORCEMENT SLOPE PROTECTION DETAILS H=2,80m

Scara /scale 1:50

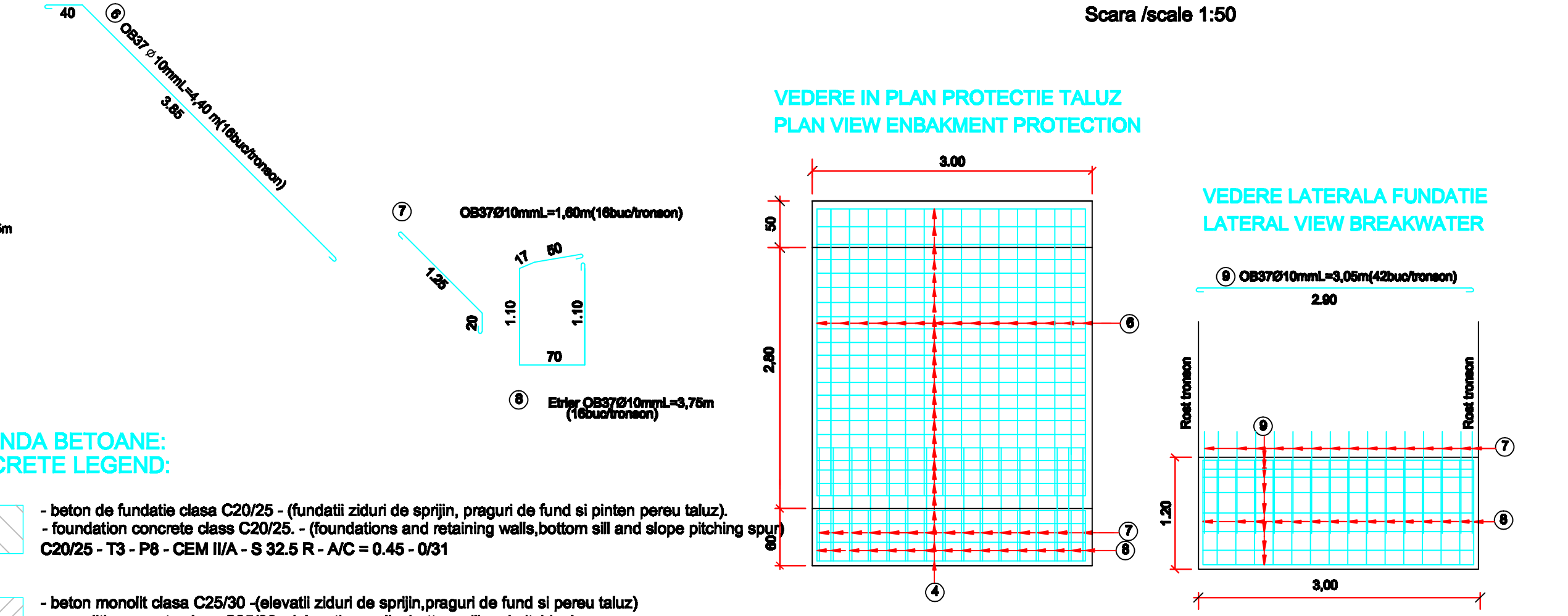

D					
C					
B					
A	11.2011	Revizia 1	Popescu Anca Raluca	Popescu Anca Raluca	Popescu Anca Raluca
Index	Date	Modificari	Proiectant	Proiectant	Proiectant
		Modification/Revision	Designer	Approved Consultant	Approved CFR

GUVERNUL ROMANIEI / ROMANIAN GOVERNMENT
 PROIECT FINANATAT DE UNIUNEA EUROPEA / EUROPEAN UNION FINANCED PROJECT

C.N.C.F. "C.F.R." - S.A.
 CLIENT / CLIENT

TALFERA
 Wilson
 OBERMEYER
 TECNIC

CONSULTANT / CONSULTANT

Aprobat	Def. proiect	R. Liuzza	Data	Semnatura
Approved	Project manager			
Aprobat	Coordonator Sectiune	C. Gambelli		
Approved	Section 1 Coordinator			
Verificat	Expert Cheie	V. Kallidromitis		
Checked	Checking Expert			

SUBCONTRACTANT / SUBCONTRACTOR

Aprobat	Responsabil Subcontractant	A. Dinulescu Stanciu		
Approved	Subcontractant Responsible			
Intocmit	Proiectant	Popescu Anca-Raluca	24.08.2011	
Elaborated	Designer			

Reabilitarea liniei de cale ferata Brasov - Simaria, parte componenta a coridorului IV Pan European, pentru circulatia trenurilor cu viteza maxima de 160 km/h,
 Tronsoanel: Brasov - Sighisoara
 Corridor of the railway line Brasov - Simaria, component Part of the IV Pan-European
 Corridor, for the trains circulation with maximum speed of 160 km/h,
 Section : Brasov - Sighisoara

Denumire desen / Drawing Title :
 INTERVAL CATA-ARCHITA / CATA-ARCHITA SECTION
 PROTECTIE POD C.F. KM. 242+92.068
 SECTION TIP - DETALII DE ARMARE
 242+92.068 KM RAILWAY BRIDGE PROTECTION
 SECTIONS TYPE - REINFORCING DETAILS

Codificare / Codification System: Scara / Scale 1:100, LOT / LOT, Nr. / No 01 / 01

E A S 1 0 1 E 1 4 W A A P 0 1 6 3 0 0 4 1