

STIPIŢĂ	TRAFIC DE CALĂTORII (CALUZI)	AMPLAS	MEZIU
ASR/1A	288	174	

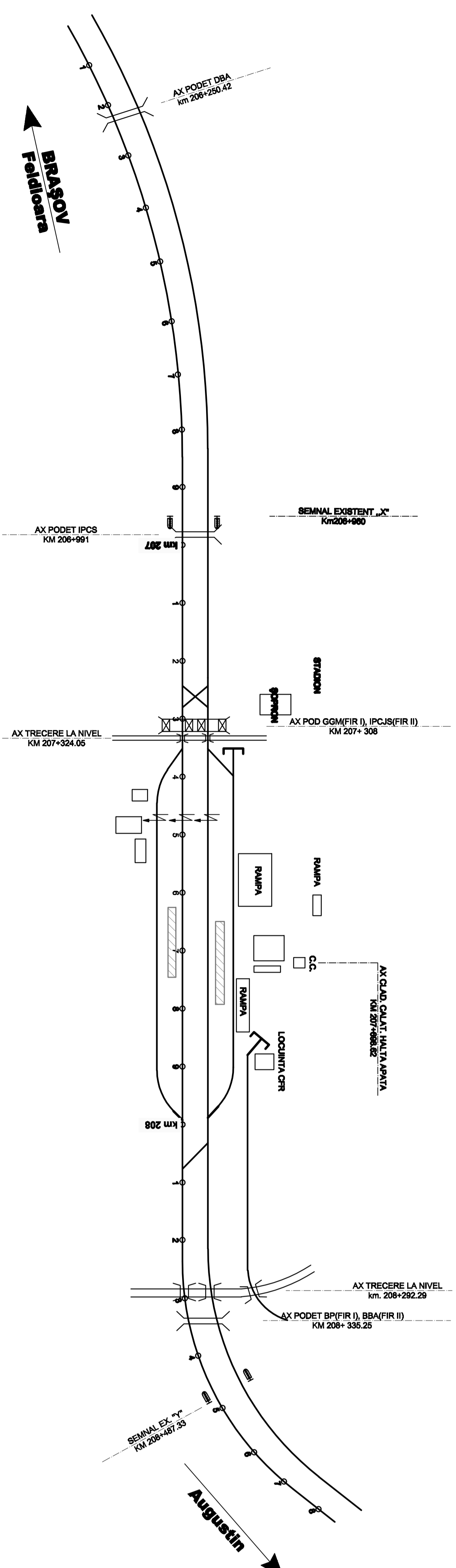

APATA - situația existentă

V_{act} = 70 km/h

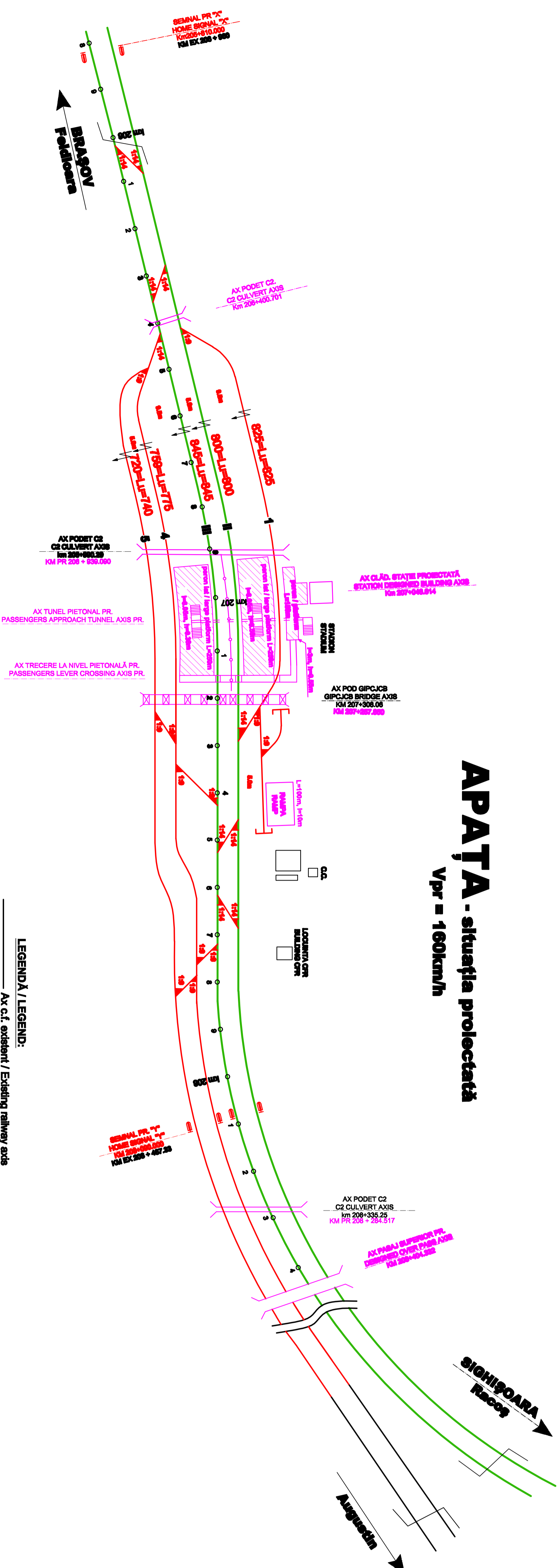

APATA - situația proiectată

V_{pr} = 160km/h

LEGENDA / LEGEND:

- Ax c.d. existent / Existing railway axis
- Ax c.d. linii directe nesolabile / Direct rehabilitated railway axis
- Ax c.d. linii procedate / Designed railway axis
- Construcții existente / Existing buildings
- Construcții procedate / Designed buildings
- Gard între linii directe / Fence between direct railway

D				
C				
B				
A				
Indice Index	Data Date	Modificarea Modification/Revision	Proiectant Designer	Proiectant Consultant
				Proiectant Consultant
				Proiectant Consultant



GUVERNUL ROMÂNIEI
ROMANIAN GOVERNMENT

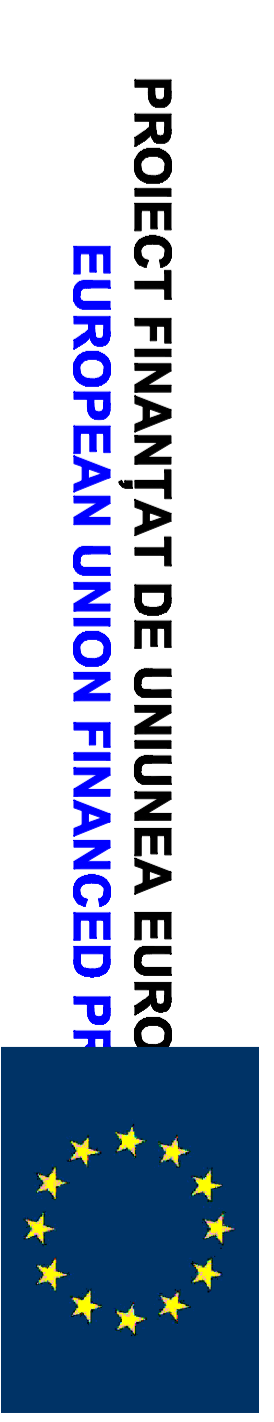

PROIECT FINANȚAT DE UNIUNEA EUROPEANĂ
EUROPEAN UNION FINANCED PROJECT

CLIENT / CLIENT



C.N.C.F. "C.F.R." - S.A.



CONSULTANT / CONSULTANT

Approbat Approved	Șef proiect Project manager	R. Luzzi	12.2011	[Signature]
Approbat Approved	Coordonator Secțiune 1 Section 1 Coordinator	C. Gambelli	12.2011	[Signature]
Verificat Verified	Expert Cheie Key Expert	S. Menichini	12.2011	[Signature]
Checked				

SUBCONTRACTANT / SUBCONTRACTOR

Approbat Approved	Responsabil Subcontractant Subcontractant Responsible	A.Stancu - Dinulescu	12.2011	[Signature]
Elaborat Elaborated	Proiectant Designer	V. Ispas	12.2011	[Signature]

Reabilitarea liniei de cale ferată Brașov - Simeria, parte componentă a coridorului IV Pan European, pentru circulația trenurilor cu viteză maximă de 160 km/h,
Tronsonul : Brașov - Sighișoara
Rehabilitation of the railway line Brașov - Simeria, component Part of the IV Pan-European Corridor, for the trains circulation with maximum speed of 160 km/h,
Section : Brașov - Sighișoara

Denumire desen / Drawing Title :
Schita Stației / Station Sketch
Apata

Codificare / Codification System

E	A	5	1	0	1	C	0	9	U	Z	T	F	0	0	5	0	0	0	1	2
---	---	---	---	---	---	---	---	---	---	---	---	---	---	---	---	---	---	---	---	---

Scara / Scale

LOT / LOT	Nr. / No
	01 / 01