

TITLUL PLANȘEI / PLAN TITLE		COD/CODE																			
		a	b	c	d	e	f	g	h	i	j	k									
DETAILS FOR BEARING BLOCK MADE OF TEFLOIN AND NEOPRENE	DETALII APARAT DE REAZEM DIN TEFLOIN SI NEOPREN	E	A	S	1	0	1	E	0	0	B	K	P	V	0	0	0	0	2	0	
DETAILS FOR WATERPROOFING AND JOINT COVERING	DETALII HIDROIZOLATI SI ROSTURURI	E	A	S	1	0	1	E	0	0	Q	K	P	V	0	0	0	0	0	3	0
DETAILS FOR DISCHARGE OPENINGS	DETALII GURI DE SCURGERE	E	A	S	1	0	1	E	0	0	Q	K	P	V	0	0	0	0	0	4	0
DETAILS FOR PARAPETS ON THE DECK	DETALII PARAPET PE TABLIER	E	A	S	1	0	1	E	0	0	B	K	P	V	0	0	0	0	1	8	0
FASTENING TABLES FOR ELECTRIFICATION POLES	DETALII PRINDERE STABILE DE ELECTRIFICARE	E	A	S	1	0	1	E	0	0	B	C	P	V	0	0	0	0	0	0	0
STRUCTURAL FORMWORKS OF STEEL BEAM FOR TRUSS BEAM DECK WITH Lx= 35 m and W= 9.90 m	PLAN GENERAL GRINDA METALICA PENTRU TABLIER GRINDA ZABRELE, Lx= 35 m Si W= 9.90 m	E	A	S	1	0	1	E	0	0	B	C	P	V	0	0	0	0	0	7	0

NOTA:

- Prezentul plan s-a intocmit pe baza urmatoarelor date:
-Plan de situatie
-profil in lung
-profil transversal
-fisa podului
-calcul hidrolic
- Podul este construit pe consolidari de calauzire (M71 si SM72)
- Noul pod are urmatoarea structura:
- suprapunere: table din grinda cu acoperire cu beton, cale de beton
- infrastructura: cutii de beton armat, fundatii directe
- La executie se vor respecta cu strictitate prevederile din "Normativ pentru producerea betonului si executarea lucrurilor din beton, beton armat si beton precomprimat. Partea I: Producerea betonului", indicativ NE 012/1-2007 si "Normativ pentru producerea betonului si executarea lucrurilor din beton, beton armat si beton precomprimat. Partea 2: Executarea lucrurilor din beton", indicativ NE 012/2-2010, iar verificarea calitatii lucrurilor si receptiunile se vor face conform normativului CSE-1985.
- Scara la executie se va consulta recomandarea litera situata evidentia pe teren si cea din proiect se va consulta prioritara.
- Constructia se incadreaza in categoria de importanta B (constructii de importanta deosebita), modelul I de asigurare a calitatii si clasa de importanta B, conform NE 766/1997
- Proiectul va fi verificat la cerintele MA2; B2; D2.

NOTE:

- This plan has been drawn up based on the following data:
- Lay-out Plan
- Longitudinal Profile
- Cross-section Profile
- Bridge's File
- Hydraulic determination
- The culvert corresponds to the UIC determination category (M71 and SM72)
- The new bridge has the following structure:
- Superstructure: deck made from metallic beams
- Infrastructure: abutments and reinforced concrete, with direct foundation.
- The execution will strictly comply with the provisions of "Practice code for the concrete production and works execution, reinforced and pre-stressed concrete - Part 1: Practice code for concrete production" NE 012/1-2007 and "Practice code for the concrete production and works execution, reinforced and pre-stressed concrete - Part 2: The execution of concrete works" NE 012/2-2010, and the quality and the reception of the works shall be made accordingly to Norm C-56-1990.
- In case during the execution there will be found out any discrepancies between the existing situation on site and in project, the designer will be announced.
- The construction has been classified in B category of importance (High important construction), model I - ensuring the quality and class of importance B according to G.D. 766/97.
- The project will be checked in order to comply with the MA2; B2; D2 requirements.

LEGENDA BETOANELOR/CONCRETE LIST

	Beton armat in bancuta de cofraj
	C 25/30-Grnd (A)-S 52.5-(D)4X(F)3(A)2-A/C=0.50-D 1.2-0.20
	Beton armat in elevatie si in zidurile intarite
	C 25/30-Grnd H 1/A-S 42.5-(D)4X(F)3-A/C=0.50-D 1.2-0.20
	Beton simplu in fundatii
	Plain concrete in abutments foundations:
	Beton in trusa de protectie a horizontalizatiilor
	Concrete in the protection layer of the waterproofing

In cazul in care temperatura in timpul lucrului este scaduta, se vor folosi acceleratori cu rezistenta initiala mare, si in cazul acceleratori, se vor folosi acceleratori cu rezistenta initiala scaduta, si in cazul intaritorilor (concret NE 012/2-2010 si tabelul 2 din SR EN 12010-2010).
When the temperature during the casting is low, concrete with high initial resistance, R and accelerating additives shall be used and when it is cold during warm weather, concrete with common initial resistance, R and delaying additives shall be used (according to the norm NE 012/2-2010 and table 2 for the SR EN197-1:2002).

DATE HIDRAULICE

-Inaltime de apa in pod: h=1.98m
-Perimetru scut: P=35.87m
-Ara scut: A=41.59m²
-Viteza de curgere apa: V=4.03m/s

HYDRAULIC DATA

-Hydraulic height: h=1.98m
-Wet perimeter: P=35.87m
-Wet surface: A=41.59m²
-Water flow speed: V=4.03m/s

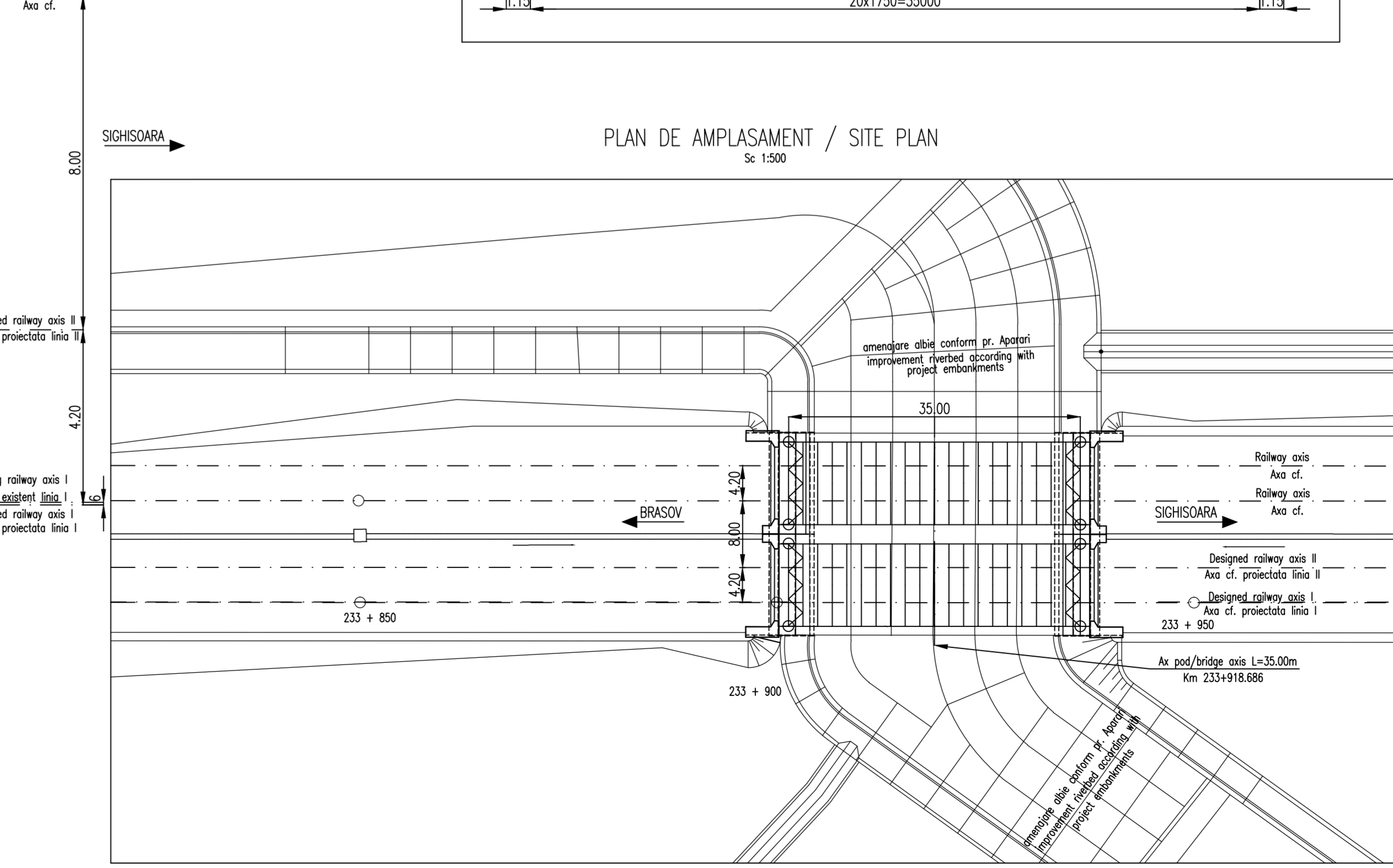
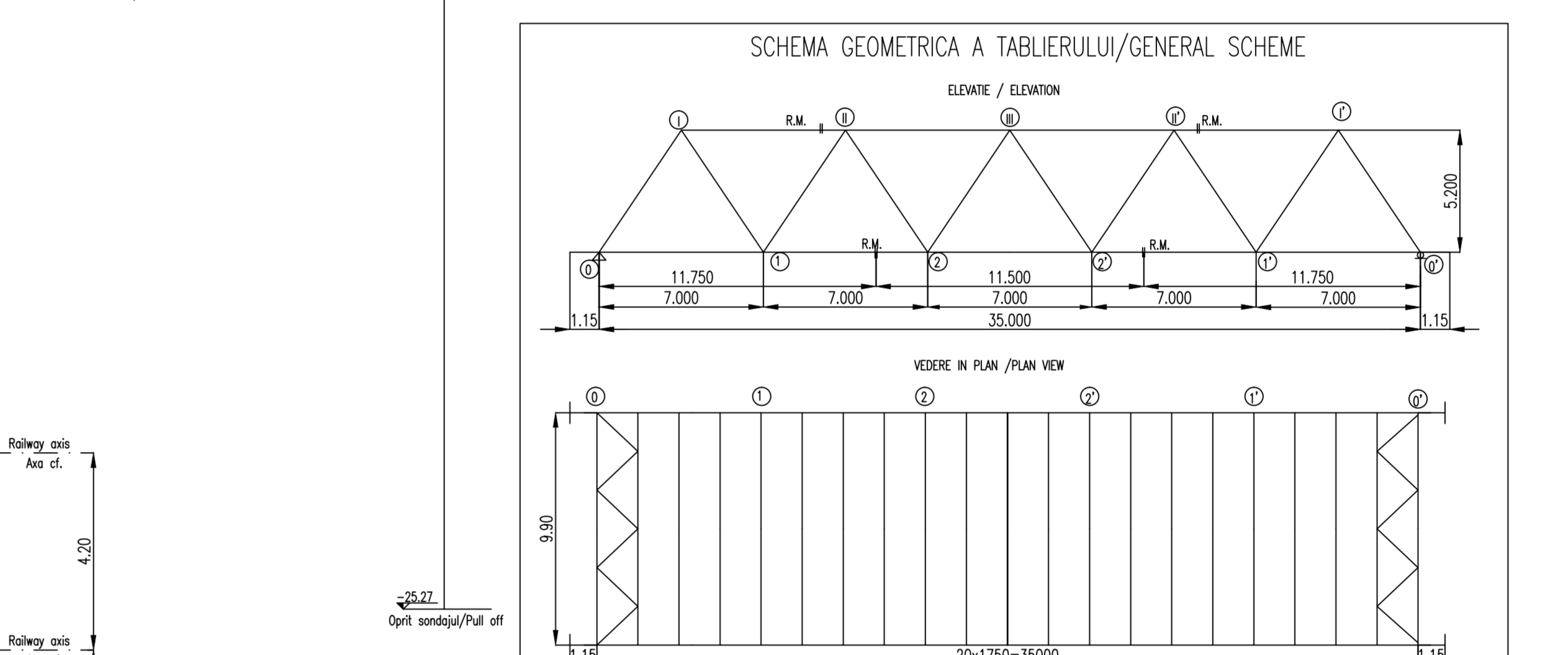
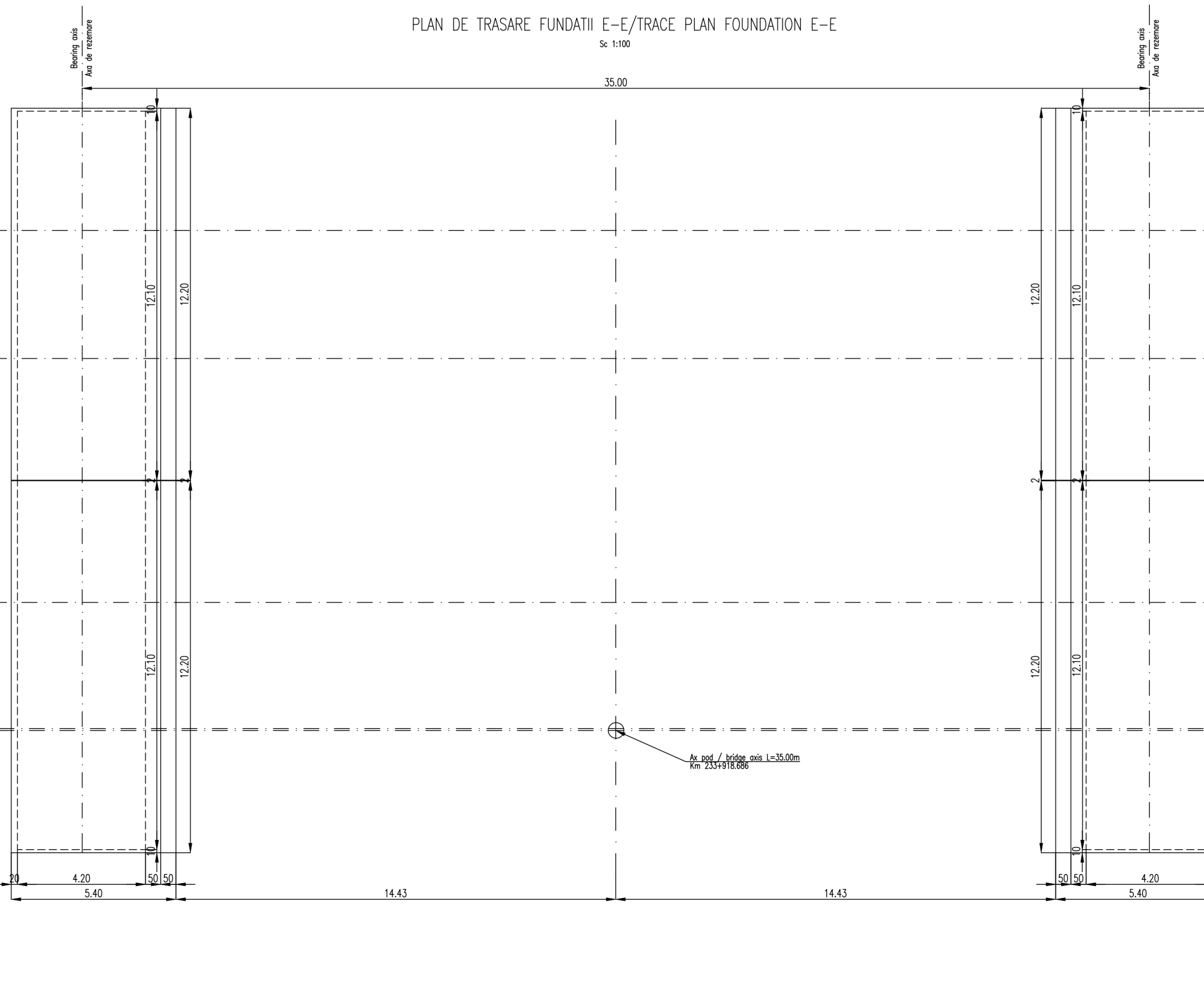
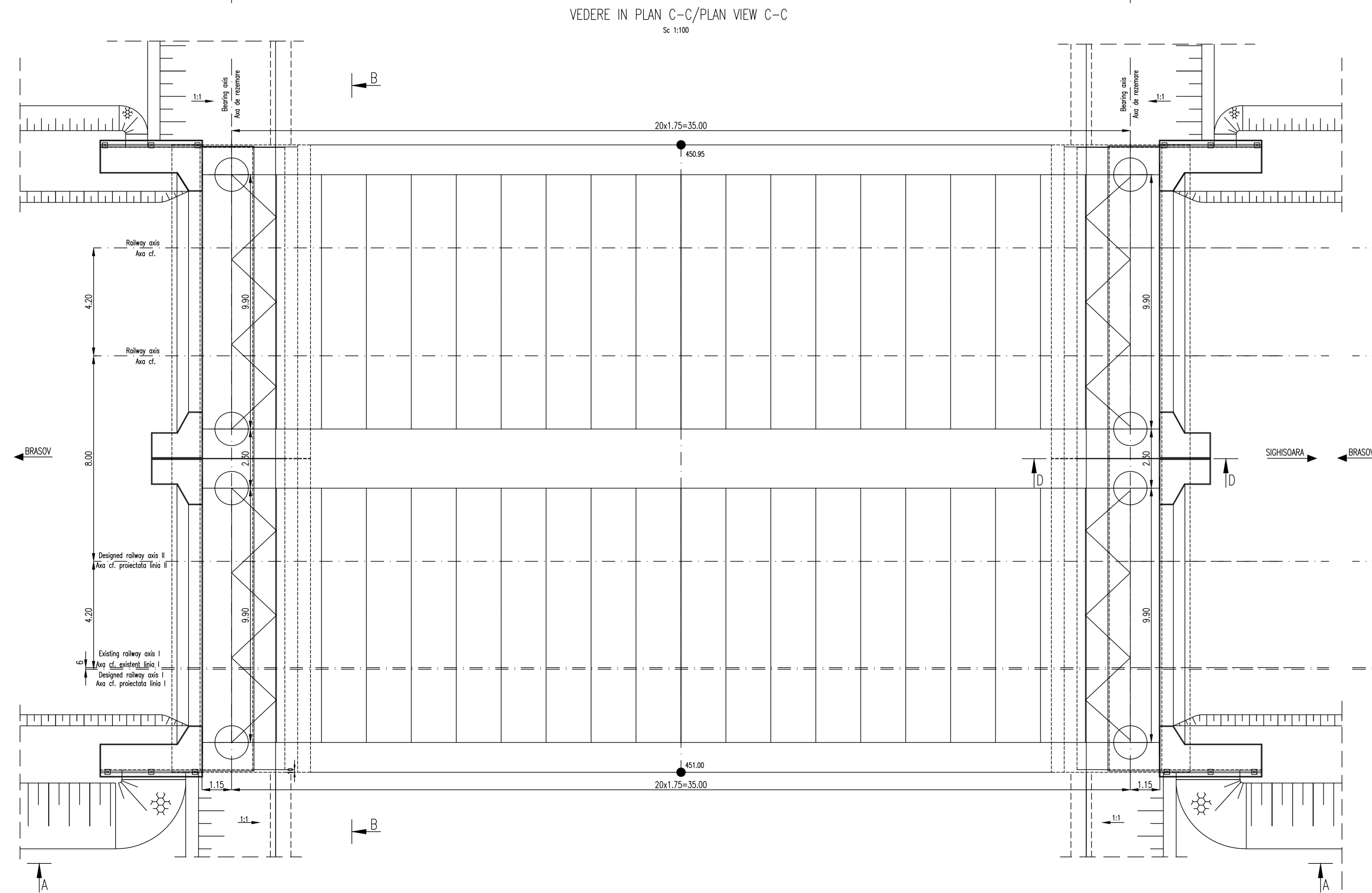

Se interzice copierea, difuzarea, imprintrarea sau utilizarea in alte scopuri fara permisiunea ARX LEER COMPANY sa proprietar si detinatorul. This drawing is forbidden to be copied, lent or used in other purposes than those previously approved by ARX LEER COMPANY or its owner.

D	C	B	A
12.2011	12.2011	12.2011	12.2011
Index	Date	Index	Date

GUVERNUL ROMANIEI / ROMANIAN GOVERNMENT
PROIECT FINANAT DE UNIUNEA EUROPEANA / EUROPEAN UNION FINANCED PROJECT

C.N.C.F. "C.F.R." - S.A.

CLIENT / CLIENT

CONSULTANT / CONSULTANT
 R. Liuzza
 C. Gambelli
 V. Kallidromitis

SUBCONTRACTANT / SUBCONTRACTOR
 A. Dinulescu Stanciu

Reabilitarea liniei de cale ferata Racos - Sighisoara [ca] [1] [1] c) a coridorului IV Pan European, pentru circula la trenurilor cu viteza maxim de 160 km/h.
Tronsoanel: Brasov - Sighisoara
 Reabilitarea liniei de cale ferata Racos - Sighisoara, componenta Partea a IV Pan-European Corridor, for the trains circulation with maximum speed of 160 km/h.
Section : Brasov - Sighisoara

Denumire desen / Drawing Title:
INTERVAL / SECTION RACOS - CATA
POD / BRIDGE Km 233+918.686 L=35.00m
DISPOZITIE GENERALA / GENERAL LAYOUT

Codificare / Codification System: Scara / Scale: 1:100; 1:500 LOT / LOT: Nr. / No: 01 / 01