

Se interzice copierea, difuzarea, imprimarea sau utilizarea in alte scopuri, fara permisiunea AREX LIBER COMPANY ca proprietar al desenului. This drawing is forbidden to be copied, lent or used in other purposes than those previously approved by AREX LIBER COMPANY as its owner.

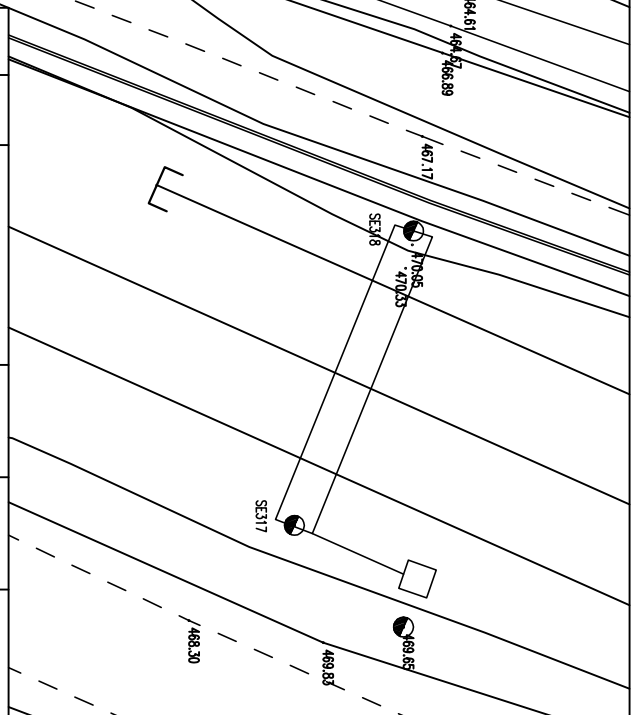

D				
C				
B				
A	12.2011	REVIZIA 1	Toran Ciprian	Arhitect Conducator
Indice	Descriere	Modificari/Revizii	Elaborat	Verificat

GUVERNUL ROMANIEI / ROMANIAN GOVERNMENT
 PROIECT FINANATAT DE UNIUNEA EUROPEANA / EUROPEAN UNION FINANCED PROJECT

CLIENT / CLIENT
C.N.C.F. "C.F.R." - S.A.

CONSULTANT / CONSULTANT
TECNIC
 Consulting Engineers

SUBCONTRACTANT / SUBCONTRACTOR
AREX
 A. Dinulescu Stencilu

Redabilirea liniei de cale ferata Brasov - Simeia, parte componenta a coridorului IV Pan European, pentru dublarea trenurilor cu viteza maxima de 160 km/h, pe tronul Brasov - Simeia componenta a liniei Pan-European Coridor, for the trains of double track maximum speed of 160 km/h.
 Section : Brasov - Sighisoara

Denumirea desen / Drawing Title
INTERVAL / SECTION: CATA - ARCHITA
PODET - KM 255+487.052 / KM 255+487.052 - CULVERT
PLAN DE SITUATIE / LAYOUT PLAN

Codificare / Codification System
 Scara / Scale 1:100 TS
 LOT / LOT
 Nr. / Nr. 01/01

