

This drawing is forbidden to be copied, lent or used in other purposes than those previously approved by AREX *Lider* Company as its owner.
 Se interzice copierea, difuzarea, imprumutarea sau utilizarea in alte scopuri, fara permisiunea AREX *Lider* Company ca proprietar al desenului.

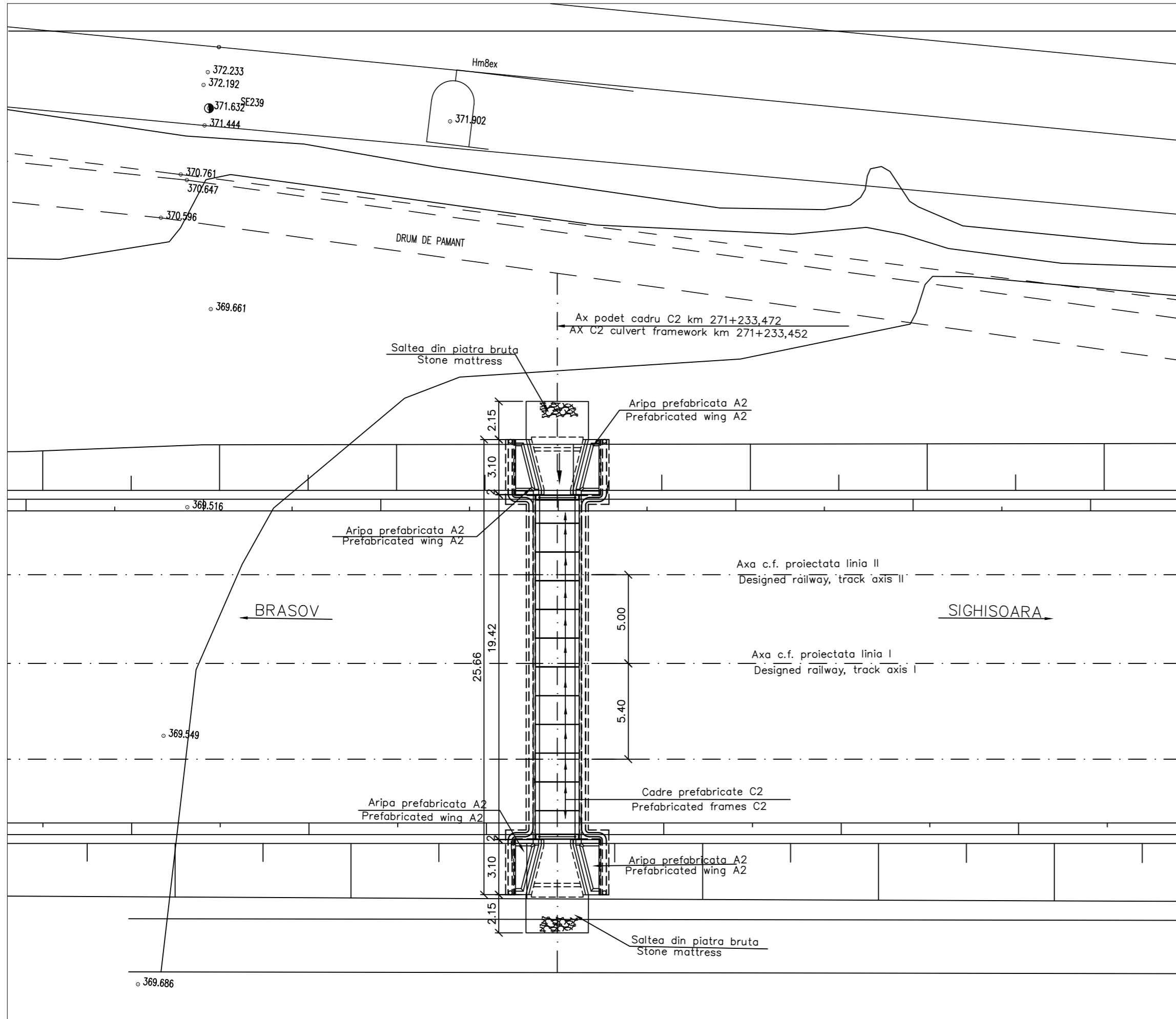

D					
C					
B					
A	12.2011	Revizia 1	Elena Radu		
Indice Index	Data Date	Modificare Modification/Revision	Proiectant Designer	Aprobat Consultant Approved Consultant	Aprobat CFR Approved CFR

GUVERNUL ROMANIEI
ROMANIAN GOVERNMENT

PROIECT FINANȚAT DE UNIUNEA EUROPEANĂ
EUROPEAN UNION FINANCED PROJECT

C.N.C.F. "C.F.R." - S.A.

CLIENT / CLIENT





GRUPPO FERROVIE DELLO STATO
Joint Venture leader







CONSULTANT / CONSULTANT

			Data Date	Semnătură Signature
Aprobat Approved	Şef proiect Project manager	R. Liuzza		
Aprobat Approved	Coordonator Secțiune 1 Section 1 Coordinator	C. Gambelli		
Verificat Checked	Expert Cheie Checking Expert	V. Kallidromitis		

SUBCONTRACTANT / SUBCONTRACTOR

Aprobat Approved	Responsabil Subconsultant Subconsultant Responsible	A. Dinulescu Stanciu	08.2011	
Intocmit Elaborated	Proiectant Designer	Elena Radu	08.2011	

Reabilitarea liniei de cale ferata Braşov - Simeria, parte componentă a coridorului IV Pan European, pentru circulația trenurilor cu viteza maximă de 160 km/h,
Tronsonul : Braşov - Sighişoara
 Rehabilitation of the railway line Braşov - Simeria, component Part of the IV Pan-European Corridor, for the trains circulation with maximum speed of 160 km/h,
Section : Braşov - Sighişoara

Proiect/Project
 2004/RO/16/P/PA/003
Faza / Phase:
 P.Th. / T.D.

Denumire desen / Drawing Title :

STATIA / STATION; VANATORI
PODET - KM 271+233,472 / KM 271+233,472 - CULVERT
PLAN DE SITUATIE / LAYOUT PLAN

Codificare / Codification System	Scara / Scale 1:200	LOT / LOT	Nr. / No 01 / 01																					
<table border="1"> <tr> <td>E</td><td>A</td><td>5</td><td>1</td> <td>0</td><td>1</td> <td>C</td> <td>1</td><td>6</td> <td>L</td><td>8</td> <td>P</td><td>O</td> <td>0</td><td>7</td> <td>7</td> <td>1</td> <td>0</td><td>0</td><td>1</td> <td>1</td> </tr> </table>	E	A	5	1	0	1	C	1	6	L	8	P	O	0	7	7	1	0	0	1	1			
E	A	5	1	0	1	C	1	6	L	8	P	O	0	7	7	1	0	0	1	1				