



**DATE HIDRAULICE:**  
 -Inaltimea de apa: h=0,54m  
 -Perimetrul udat: P=3,08m  
 -Aria udata: A=1,08m<sup>2</sup>  
 -Viteza de curgere a apei V=2,30m/s

**HIDRAULIC DATA:**  
 -Hydraulic height: h=0,54m  
 -Perimeter: P=3,08m  
 -surface: A=1,08m<sup>2</sup>  
 -Water flow speed: V=2,30m/s

**NOTA**  
 Numar de elemente prefabricate  
 -Cadre prefabricate C2 12buc  
 -Aripi prefabricate A2 2buc.  
 -Timpane prefabricate T2 2buc

**NOTE**  
 Number of precast section  
 -Prefabricated frames C2 12pcs.  
 -Prefabricated wings A2 2pcs.  
 -Prefabricated tympan T2 2pcs.

**LEGENDA BETOANELOR  
 CONCRETE LIST**

-  Beton armat in elementele prefabricate  
Reinforced concrete in the prefabricated elements  
C35/45-CEM II/A-S32,5-(XC4+XF3+XA1)-A/C=0,50-Dmax 22Cl 0.20
-  Beton simplu in fundatia elementelor prefabricate si a aripilor  
Plain concrete in the prefabricated elements end wings  
C25/30-CEM II/A-S32,5-(XF1)-A/C=0,50-Dmax 32-Cl 0.20
-  Beton simplu de panta in piten si in rigola drenului  
Plain concrete slope and spur the gutter drain  
C 25/30-CEM II/A-S 32,5-(XC4+XF3+XA1)-A/C=0,50-Dmax16-Cl 0.20

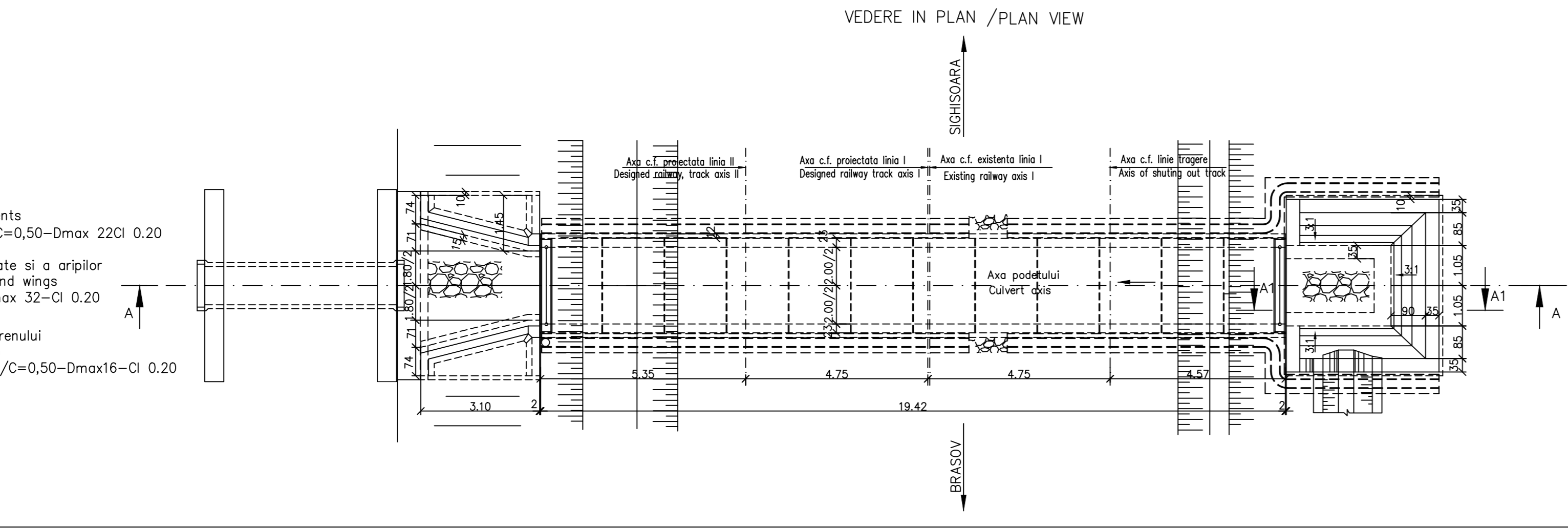
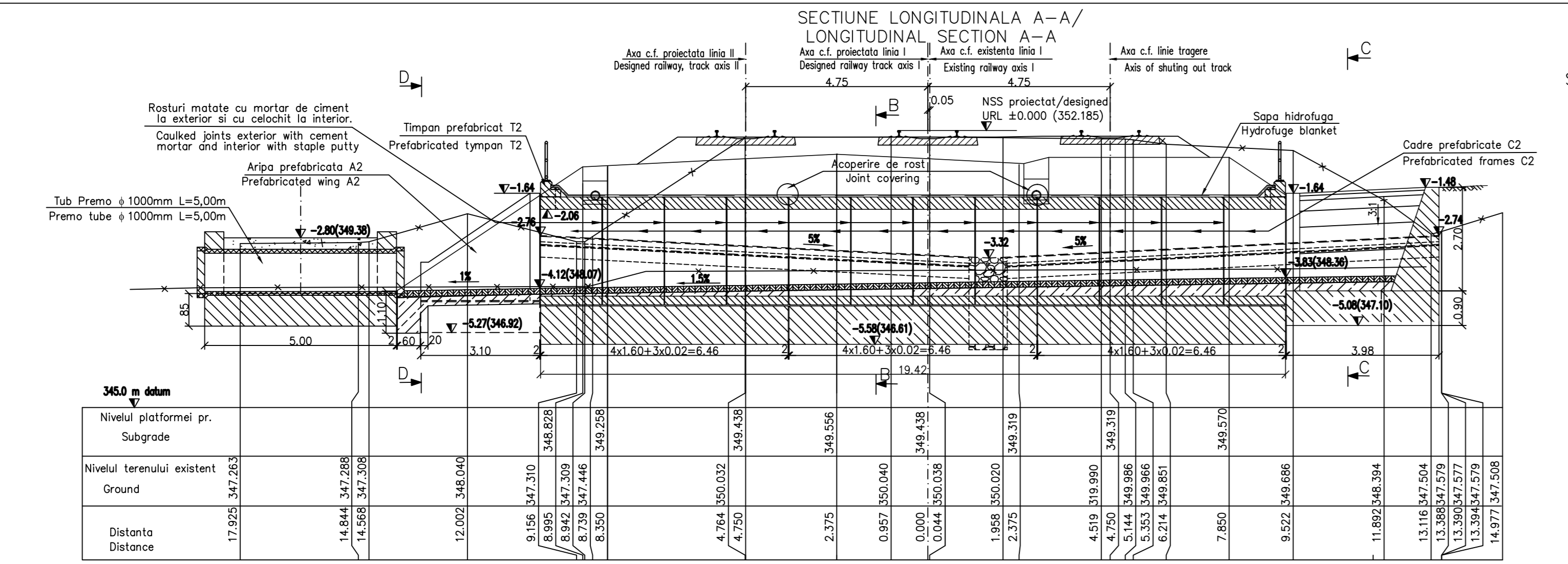

**SECTIONTE LONGITUDINALA A1-A1 /  
 LONGITUDINAL SECTION A1-A1**

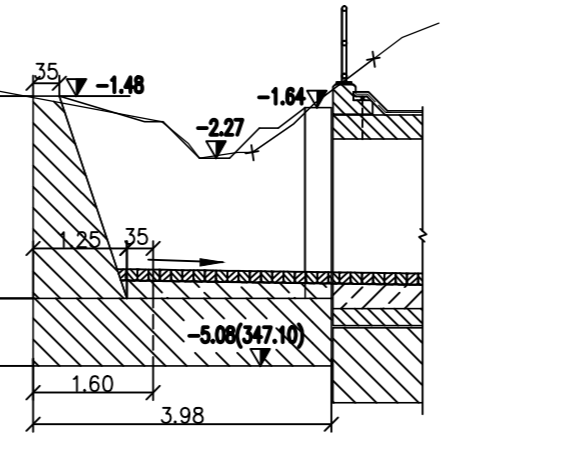

**SECTIONTE TRANSVERSALA B-B /  
 B-B CROSS SECTION**

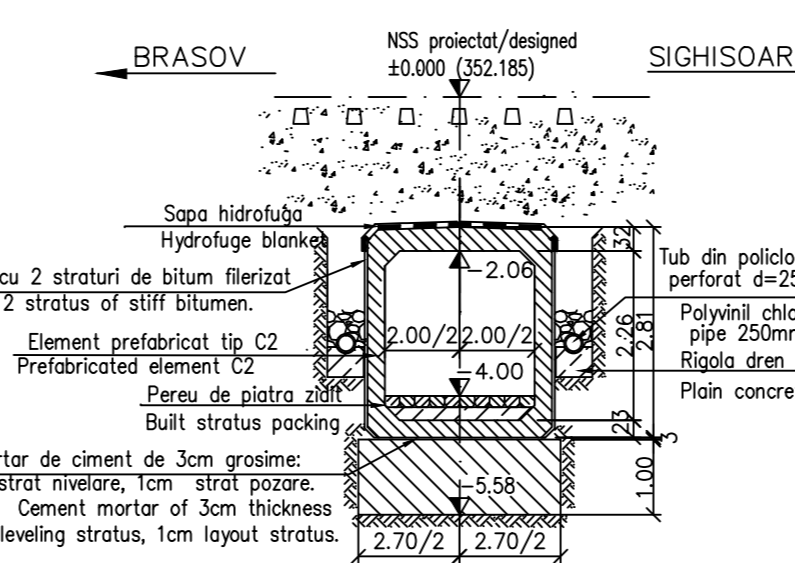

**SECTIONTE TRANSVERSALA C-C /  
 C-C CROSS SECTION**

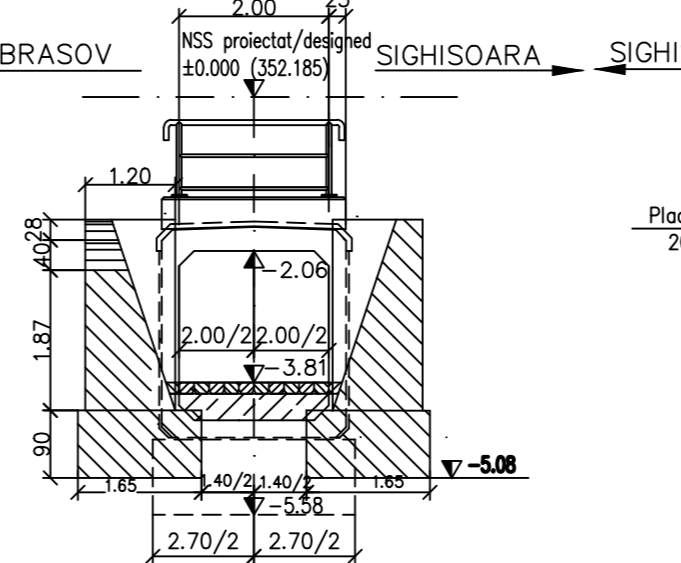

**SECTIONTE TRANSVERSALA D-D /  
 D-D CROSS SECTION**

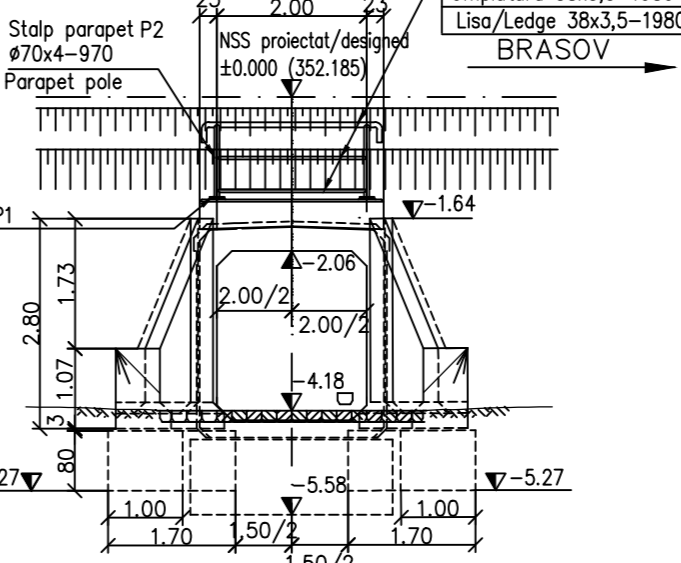

**DETALIU PENTRU PRINDEREA PLACUTELOR P1 DE TIMPAN /  
 DETAIL TO JOIN THE SLABS P1 AT THE TYMPANUM**

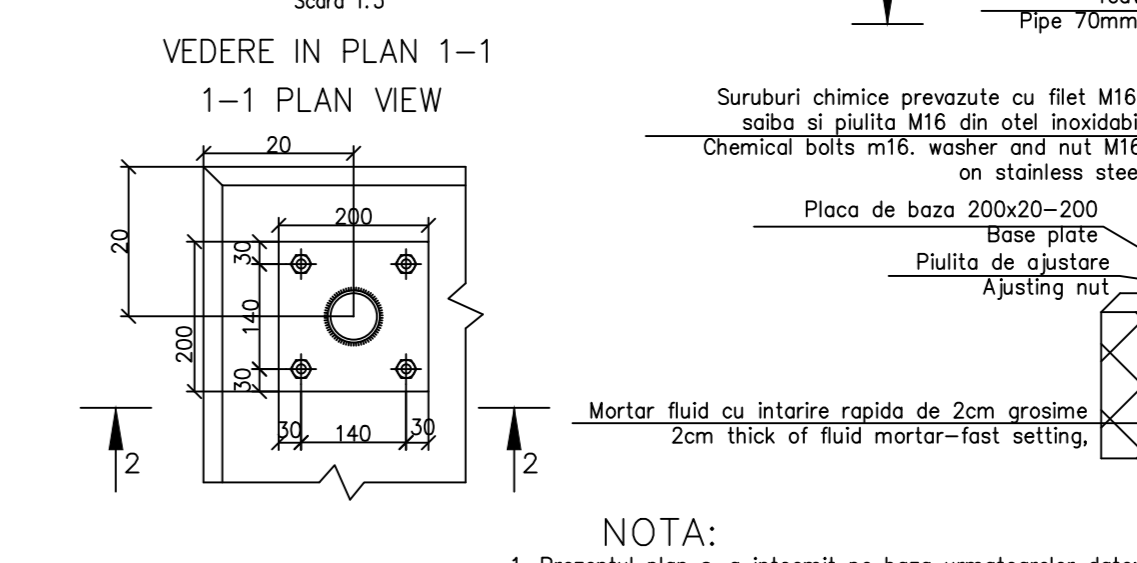

**PLANUL FUNDATIILOR /  
 FOUNDATION PLAN SECTION**

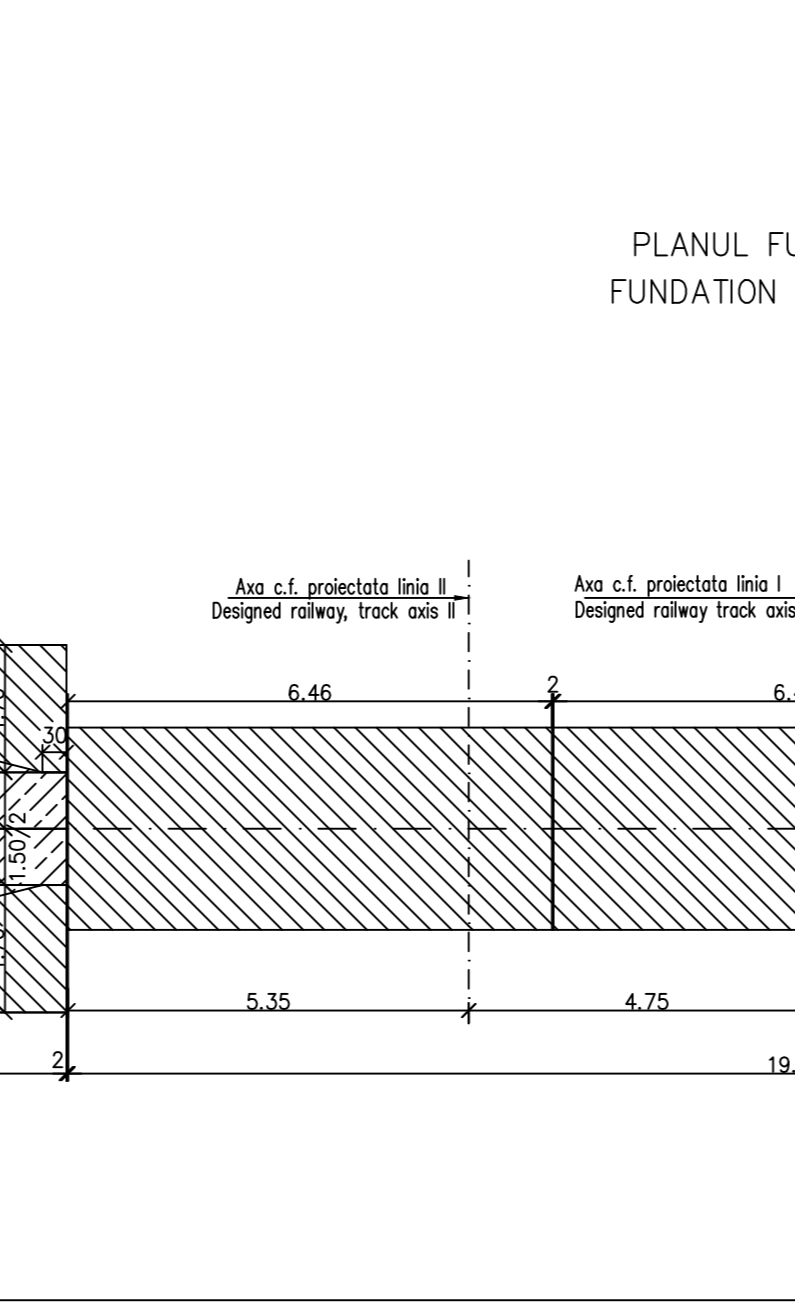

**MATERIAL METALIC PENTRU CONFECTIONAREA PARAPETULUI /  
 THE METALIC MATERIAL TO BUILD PARAPET OF CULVERT**

Poz. / Piece	Denumirea materialului / The denomination of the material	Buc. / Section	Lung. / Long. / (mm)	Sectiune /Section		
				kg/ml	kg/buc	kg
P1	Placuta prindere / Clamping plate	4	200x20	200	31.40	125.60
P2	Stalp parapet EN 10297 - E275 / Parapet pole	4	70x4	970	6.51	25.26
P3	Mana curenta EN 10297 - E275 / Handrail	2	70x4	2900	6.51	37.76
P4	Umplutura EN 10058 / Filling	2	38x3,5	1980	2.98	11.80
P5	Lisa EN 10058 / Ledge	2	38x3,5	1980	2.98	11.80
Total partial					111.74	
Partially total					111.74	
Sudura 2% / Welding 2%					2.24	
TOTAL					115	

**NOTA:**

- Prezentul plan s-a intocmit pe baza urmatoarelor date:  
-plan de situatie; profil in lung; profil transversal; fisă podului; calcul hidraulic; date culese pe teren.
- Podetului corespunde la convectoarele de calcul UIC (LM71 si SW/2)
- La executie se vor respecta cu strictitate prevederile din "Normativ pentru producerea betonului si executarea lucrarilor din beton, beton armat si beton precomprimat. Partea 1: Producerea betonului", indicativ NE 012/1-2007 si "Normativ pentru producerea betonului si executarea lucrarilor din beton, beton armat si beton precomprimat. Partea 2: Executarea lucrarilor din beton", indicativ NE 012/2-2010, iar verificarea calitatii lucrarilor si receptionarea lor se va face conform normativului C56-1985.
- Daca la executie se vor constata neconcordante intre situatia existenta pe teren si cea din proiect se va anunta proiectantului.
- Construcția se încadrează în categoria de importanță B (construcții de importanță deosebită), modelul 1 de asigurare a calitatii si clasa de importanță B, conform HG 766/1997.
- Proiectul va fi verificat la exigentele A4.2; B2.2; D2.2.
- Se atrage in mod deosebit atentie asupra obligativitatii rezemarii elevatiilor prefabricate pe blocul de fundatie prin intermediul unui strat de mortar de ciment pentru a se realiza un contact perfect pe toata suprafata intre talpa prefabricatului si fundatie. Se interzice rezemarea directa fara strat de mortar de ciment.

**NOTE:**

- This plan has been drawn up based on the following data:  
-Lay-out Plan/longitudinal profiles/cross-section profile, bridge's file hydraulic determination; field data.
- The culvert corresponds to the UIC determination convays (LM71 and SW/2).
- The execution will strictly comply with the provisions of "Practice code for the concrete production and works execution, reinforced and pre-stressed concrete - Part 1: Practice code for concrete production" NE 012/1-2007 and "Practice code for the concrete production and works execution, reinforced and pre-stressed concrete - Part 2: the execution of concrete works." NE 012/2-2010, and the quality and the reception of the works shall be made accordingly to Norm C 56-1985.
- If during the execution, discrepancies are found between the existing situation on site and the situation stated in the project, the designer will be notified.
- The construction has been classified in B category of importance (high important constructions), model 1-ensuring the quality and class of importance B according to G.O. 766/97.
- The project will be checked in order to comply with the A4.2; B2.2; D2.2 requirements.
- Particular attention is drawn on binding prefabricated elevations settlement on block foundation through a layer of cement mortar to achieve a perfect contact over the entire surface between precast and foundation base.Propping is prohibited without direct layer of cement mortar.

Se interzice copierea, difuzarea, imprumutarea sau utilizarea in alte scopuri fara permisiunea ALEX LIDER COMPANY ca proprietar al desenului  
 This drawing is forbidden to be copied, lent or user in other purposes, than those previously approved by ALEX LIDER COMPANY as owner

Indice / Index	Data / Date	Modificari / Modification/Revision	Proiectant / Designer	Proiectant / Designer	Proiectant / Designer
A	11.2011	Revizia 1	Elena Radu	Elena Radu	Elena Radu



**CLIENT / CLIENT**  
 GUVERNUL ROMANIEI / ROMANIAN GOVERNMENT  
 PROIECT FINANȚAT DE UNIUNEA EUROPEANĂ / EUROPEAN UNION FINANCED PROJECT  
 C.N.C.F. "C.F.R." - S.A.



CONSULTANT / CONSULTANT		Data / Date	Semnătură / Signature
Proiectant / Elaborated	Sef proiect / Project manager	R. Liuzza	
Verificat / Checked	Expert Cheie / Checking Expert	V.Kalidromitis	

SUBCONTRACTANT / SUBCONTRACTOR		Data / Date	Semnătură / Signature
Proiectant / Elaborated	Responsabil Subcontractant / Subcontractant Responsible	A. Dinulescu Stanciu	

Reabilitarea liniei de cale ferata Braşov - Simeria, parte componentă a coridorului IV Pan European, pentru circulația trenurilor cu viteză maximă de 160 km/h,  
**Tronsonul : Braşov - Sighişoara**  
 Rehabilitation of the railway line Braşov - Simeria, component Part of the IV Pan-European Corridor, for the trains circulation with maximum speed of 160 km/h,  
**Section : Braşov - Sighişoara**

Denumire desen / Drawing Title :  
**STATIA SIGHISOARA / SIGHISOARA STATION**  
**PODET - KM 282+566.782 / KM 282+566.782 - CULVERT**  
**DISPOZITIE GENERALA / GENERAL LAYOUT**

Codificare / Codification System	Scara / Scale	LOT / LOT	Nr. / No
E A 5 1 0 1 C 2 1 P A P O 1 0 8 1 0 0 2 1	1:100; 1:5		01/01