

STEEL RIB HEB 220
NERVURI DIN OTEL HEB 220
Scale/Scara 1:20

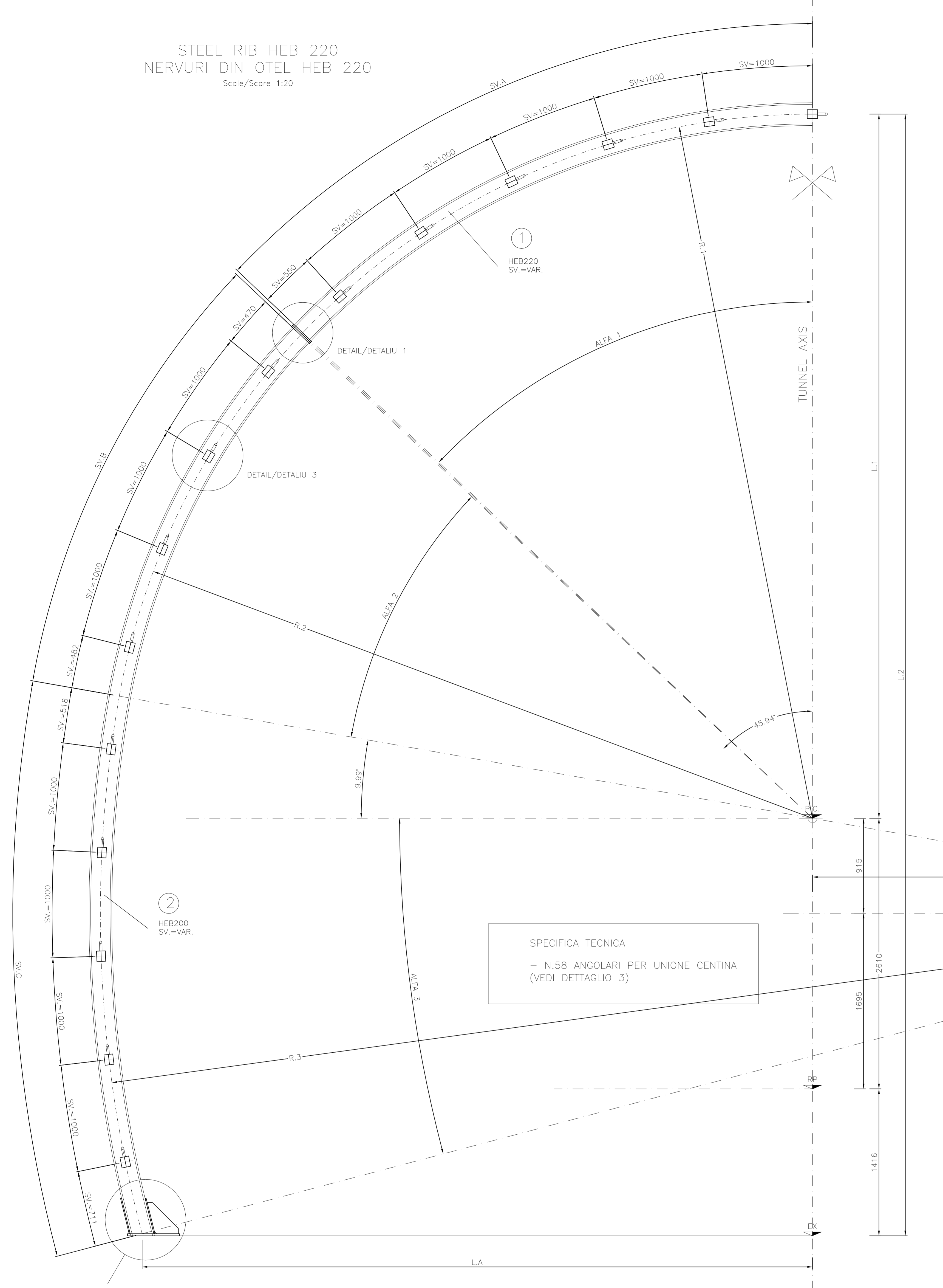

DETAIL "1"
DETALIU "1"
Scale/Scara 1:5

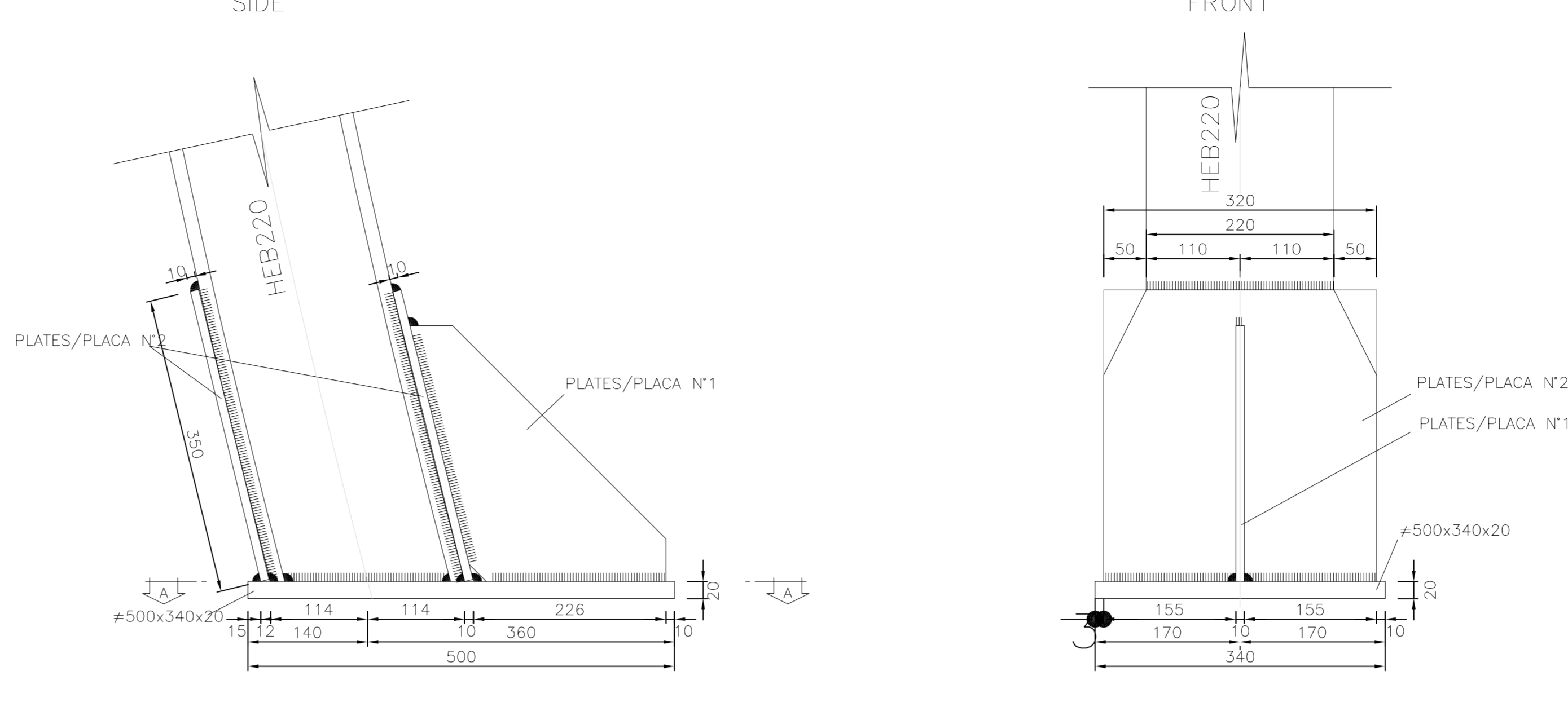

SECTION A-A
SECTIUNEA A-A
Scale/Scara 1:5

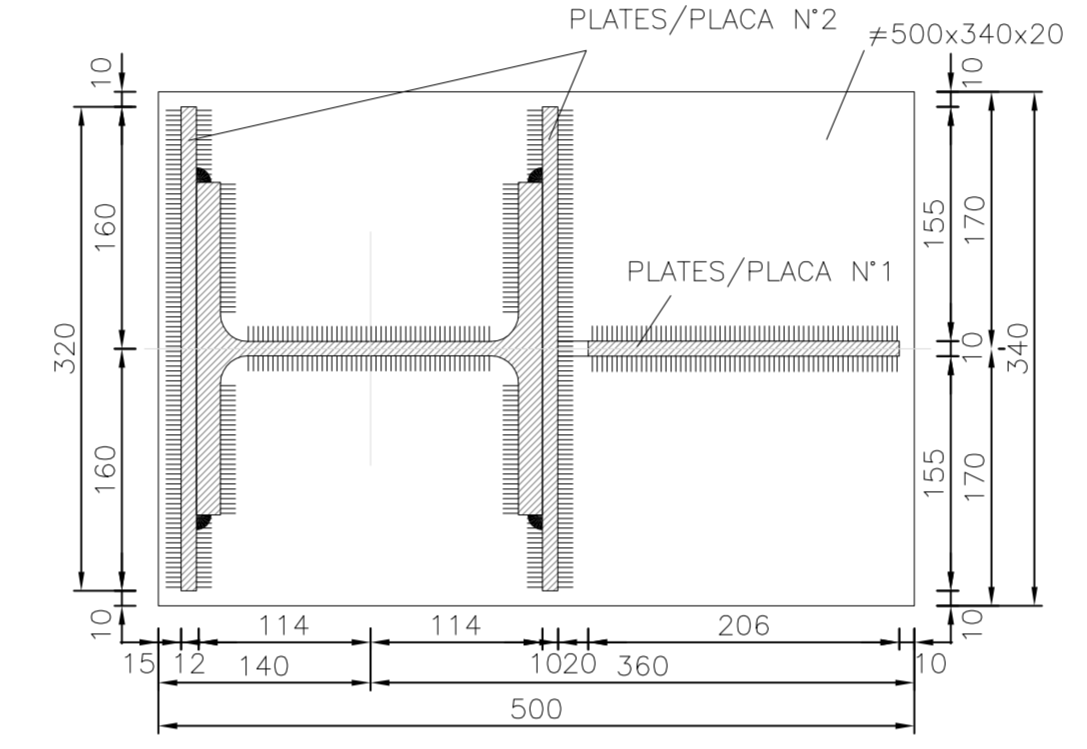

SECTION B-B
SECTIUNEA B-B
Scale/Scara 1:5

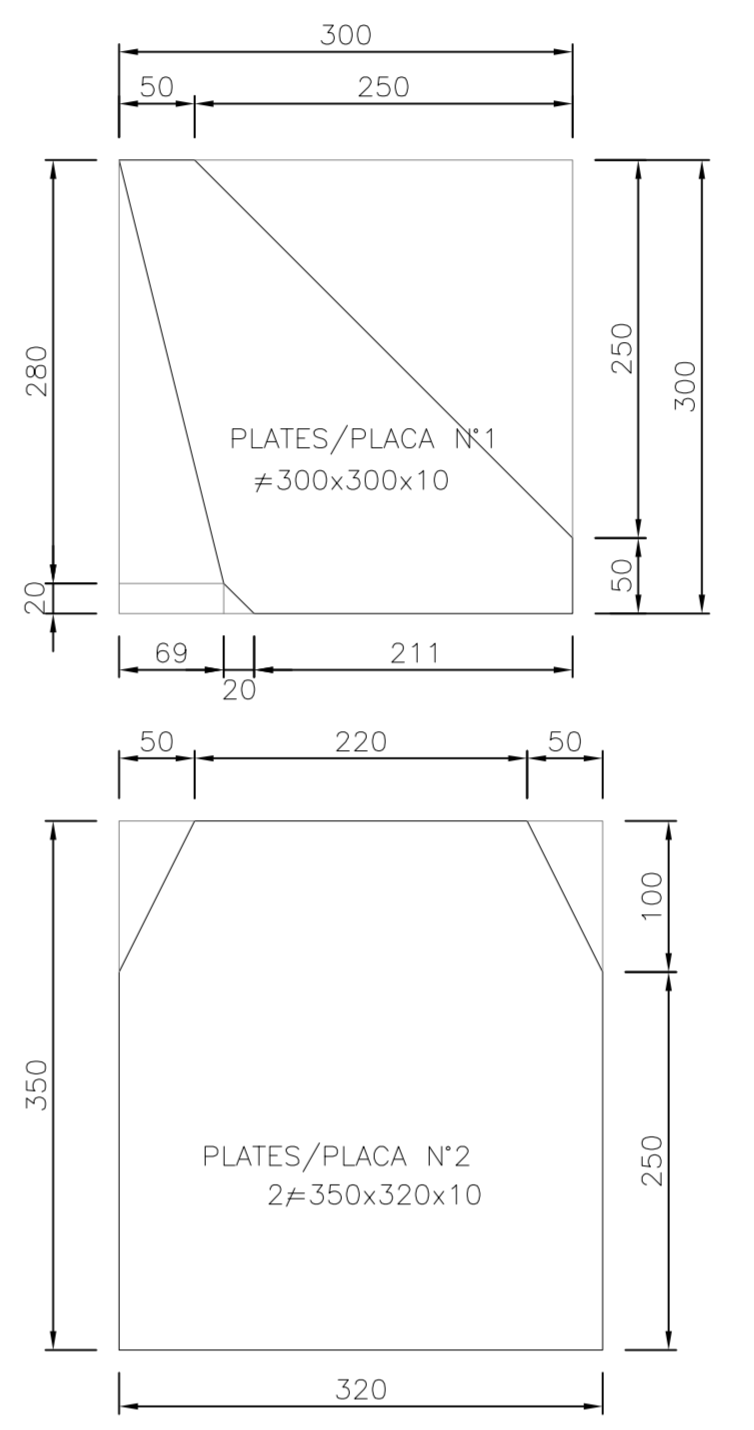

DETAIL "2"
DETALIU "2"
Scale/Scara 1:5

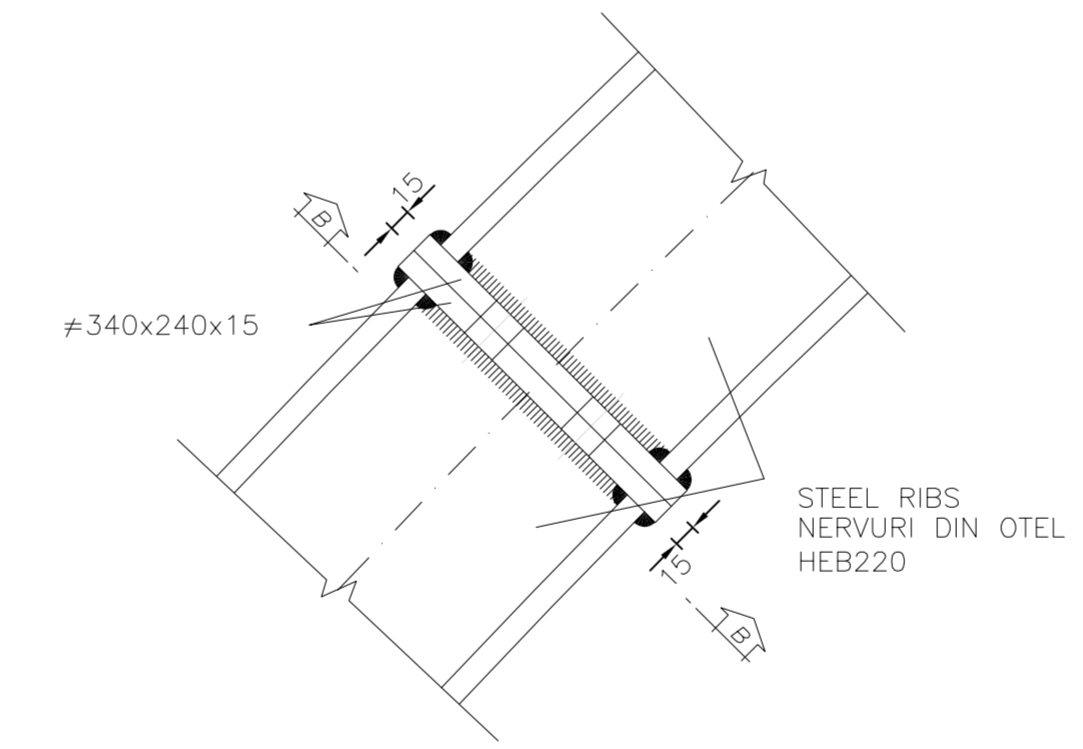

SECTION C-C
SECTIUNEA C-C
Scale/Scara 1:5

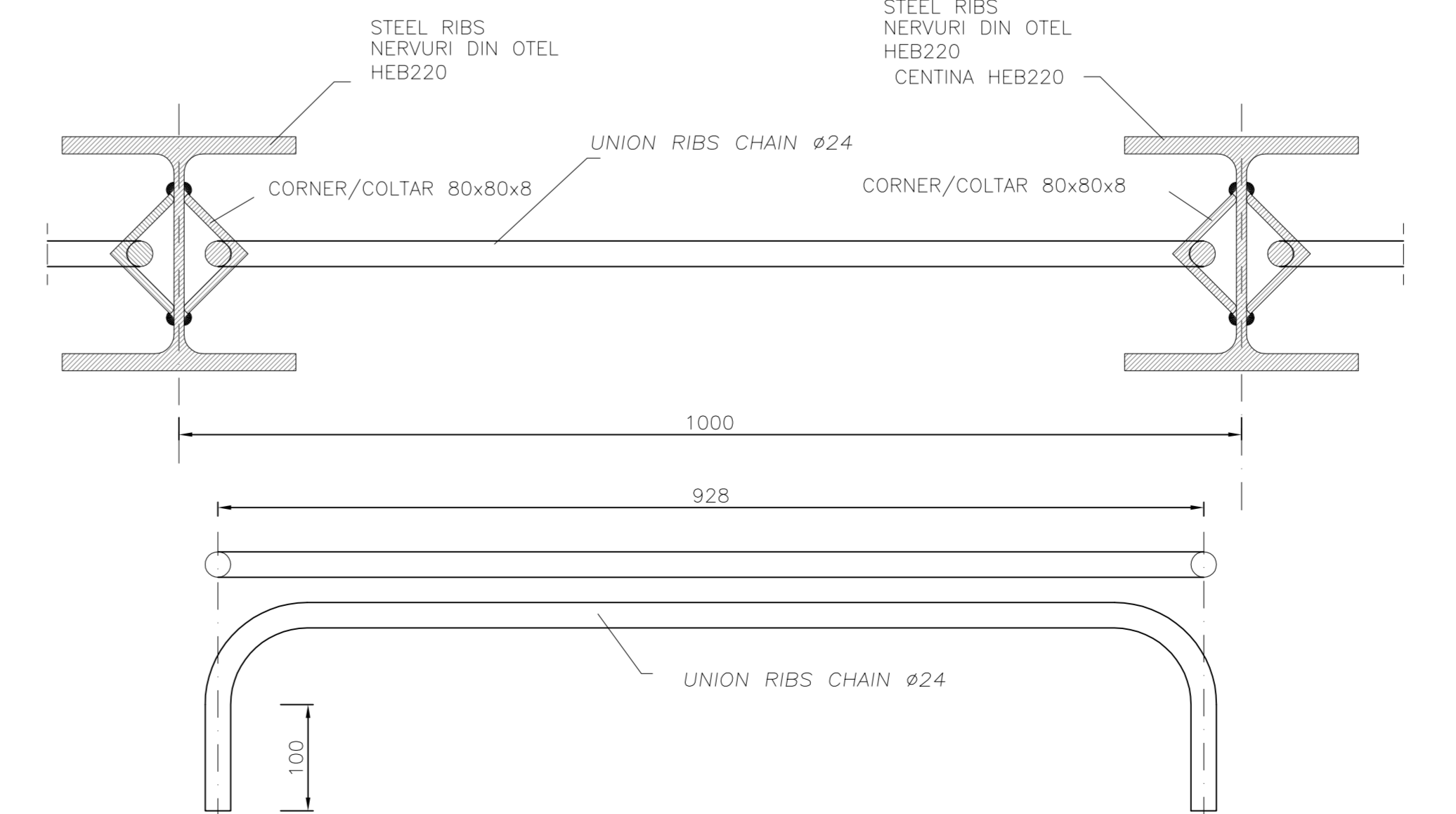

STEEL RIB HEB 220
NERVURI DIN OTEL HEB 220
Scale/Scara 1:100

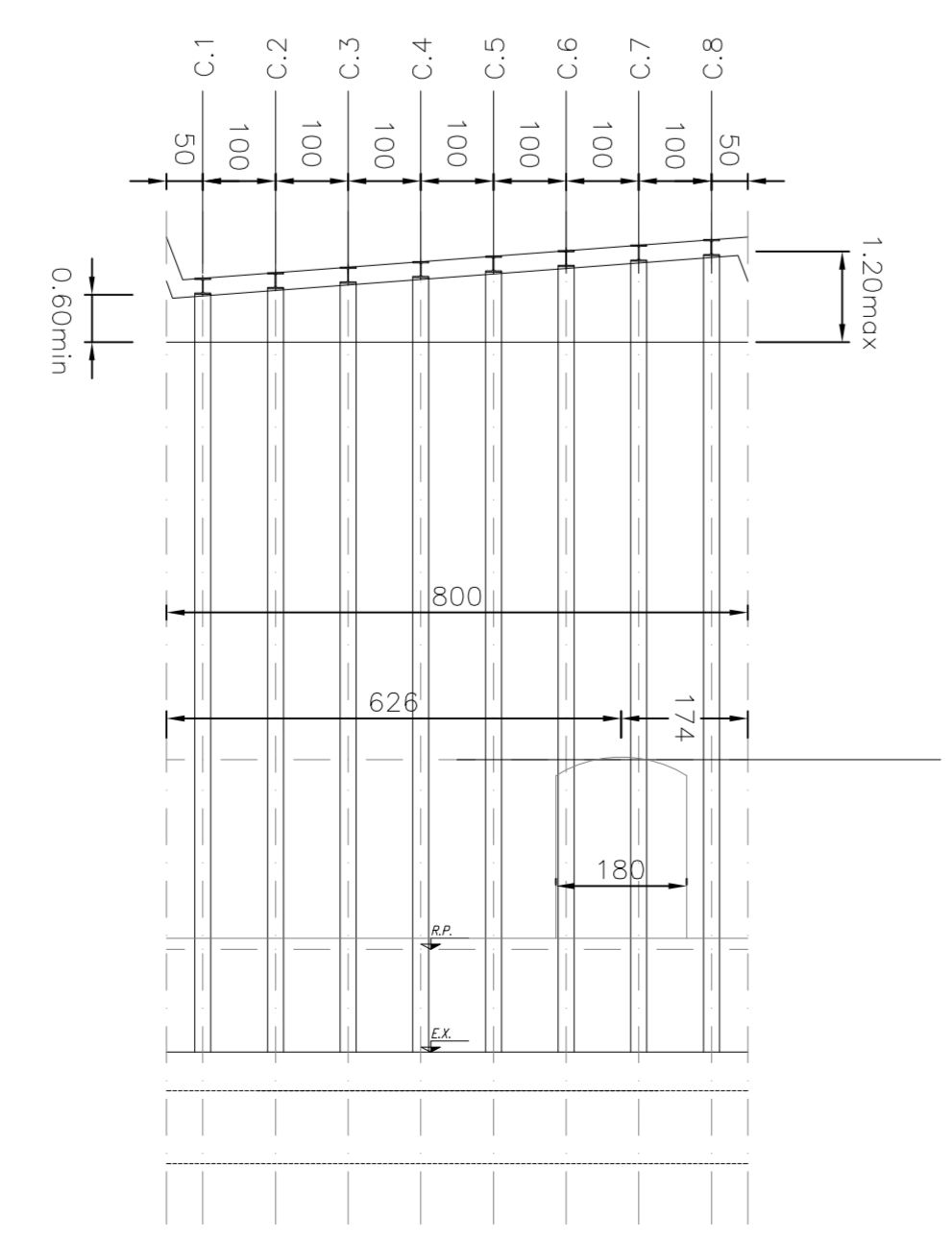

DETALIU "3"
Scale/Scara 1:5

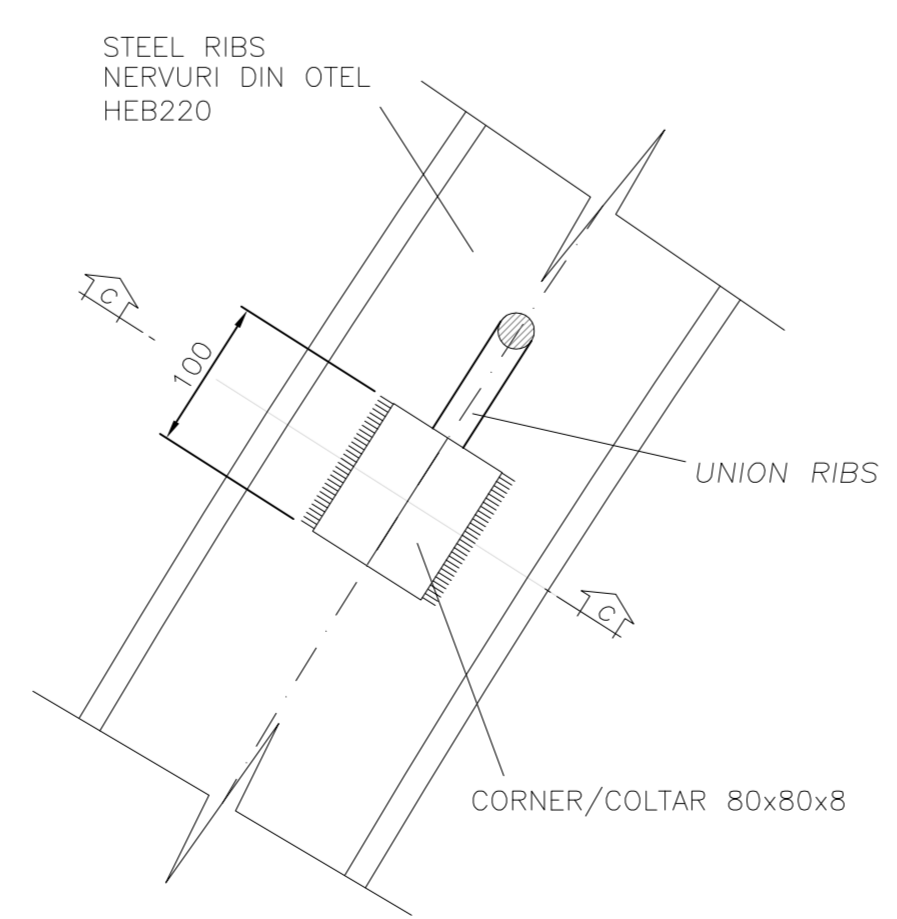

RIBS	①								②			TOT.	L.A	L.1	L.2
	R.1	ALFA 1	SV.101	R.2	ALFA 2	SV.B	R.3	ALFA 3	SV.C						
TYPE "1"	7230	44.30°	5590	11180	7230	45.46°	5737	22230	8.53°	3310	9047	6984	7230	10547	
TYPE "2"	7306	44.30°	5648	11296	7306	45.47°	5797	22306	8.50°	3310	9107	7060	7306	10623	
TYPE "3"	7381	44.30°	5707	11414	7381	45.47°	5858	22381	8.47°	3310	9168	7137	7381	10699	
TYPE "4"	7457	44.30°	5766	11532	7457	45.47°	5918	22457	8.44°	3310	9228	7214	7457	10775	
TYPE "5"	7533	44.30°	5824	11648	7533	45.47°	5978	22533	8.42°	3309	9287	7290	7533	10850	
TYPE "6"	7609	44.30°	5883	11766	7609	45.47°	6039	22609	8.38°	3309	9348	7367	7609	10926	
TYPE "7"	7684	44.30°	5941	11882	7684	45.48°	6099	22684	8.36°	3309	9408	7444	7684	11002	
TYPE "8"	7760	44.30°	6000	12000	7760	45.48°	6160	22760	8.33°	3309	9469	7520	7760	11078	

MATERIAL TABLE

RIBS, PLATE, STIFFENING, BRACKET, CORNER:	
S	S 275
f _{lim}	= 430 MPa
f _{ym}	= 275 MPa
CHAINS:	
- B450C controlled by establishment	
- Weldable	

TABELUL DE MATERIALE

NERVURA DE OTEL, SECTIUNEA CUPLATE, CADRU DE RIGIDIZARE, UNGHURI:	
S	S 275
f _{lim}	= 430 MPa
f _{ym}	= 275 MPa
LANȚI:	
- B450C controlat de catre unitate	
- Sudabil	

LEGEND

RP	=	REFERENCE PLANE
EX	=	EXCAVATIONS PLANE
PC	=	CENTERS PLANE

D					
C					
B					
A					
Index	Date	Modificari	Proiectant	Aprobare	Proiectant
Index	Date	Modificari	Design	Approved	Approved

GUVERNUL ROMANIEI ROMANIAN GOVERNMENT **PROIECT FINANȚAT DE UNIUNEA EUROPEANA EUROPEAN UNION FINANCED PROJECT**

CFR **C.N.C.F. "C.F.R." - S.A.**

CLIENT / CLIENT

ITALFER **Scop Wilson** **OBERMEYER PLANEN - BRUNNEN** **TECNIC Consulting Engineers**

CONSULTANT / CONSULTANT			Date	Semnatura
Aprobare	Șef proiect	R. Liuzza		
Aprobare	Proiect manager			
Aprobare	Coordonator Sețiune 1	C. Gambelli		
Aprobare	Coordonator Sețiune 1			
Verificat	Tunel Expert	C. Gambelli		
Verificat	Tunel Expert			
Elaborat	Proiectant	C. Gambelli		
Elaborat	Design			

SUBCONSULTANT / SUBCONSULTANT

Aprobare	Responsabil Subconsultant		
Aprobare	Subconsultant		
Intocmit	Proiectant		
Elaborat	Design		

Reabilitarea liniei de cale ferată Braşov - Simeria, parte componentă a coridorului IV Pan European, pentru circulația trenurilor cu viteză maximă de 160 km/h. Secțiunea 1 Braşov - Sighisoara **Project/Project 2004/RO/16/PA/002**

Rehabilitation of the railway line Braşov - Simeria, component Part of the IV Pan-European Corridor, for the trains circulation with maximum speed of 160 km/h. Section 1 Braşov - Sighisoara **Faza / Phase: P.Th. / T.D.**

Denumire desen / Drawing Title: **ARCHITA 2 TUNNEL NATURAL TUNNEL**
Section type "C3" with and without niches - Steel ribs 2 of 2
Secțiunea tip "C3" cu și fara nise - Nervuri din oțel 2 din 2

Codificare / Codification System Scara / Scale: variat / various LOT Nr. / No. 004 0